

PAGE INDEX

2	INSTALLATION
2	• Packaging
2	• Transport fittings
3	• Levelling
3	• Water connection
3	• Water drainage
4	• Electrical connection
4	DETERGENT DRAWER
4	CONTROL PANEL
5	FEATURES
5	• Quick Wash button
5	• Rinse plus
5	• Anti creasing
5	• Spin speed selection
5	• Rinse and hold
5	• Wash programme selector
5	• Door
6	HELPFUL HINTS
6	OPERATING THE MACHINE
6	• Sorting the laundry
6	• Loading the machine
7	• Washing
8	OPERATING NOTES
8	• On / Off
8	• Safety lock
8	• Unloading the machine
9	• Auxiliary function selection
9	• Programme progress display
9	• Adding additional laundry
9	• Time display
9	• Programme cancelling
10	WASH PROGRAMME GUIDE
11	CARE AND MAINTENANCE
11	• Detergent dispenser
11	• Siphon
11	• Cleaning the pump filter
11	• General cleaning
12	• The water intake filters
12	• Hoses
12	• Drum
12	OWNER'S RESPONSIBILITY
13	PROBLEM WASHING CHECK LIST
13	TROUBLE SHOOTING
15	INTERNATIONAL SYMBOLS
16	SERVICE CENTRES
17	WARRANTY
20	TECHNICAL SPECIFICATIONS



You can rely on Defy

OWNER'S MANUAL

Maximaid 720m

Maximaid 720w

**ELECTRONIC
AUTOMATIC WASHING MCHINE**

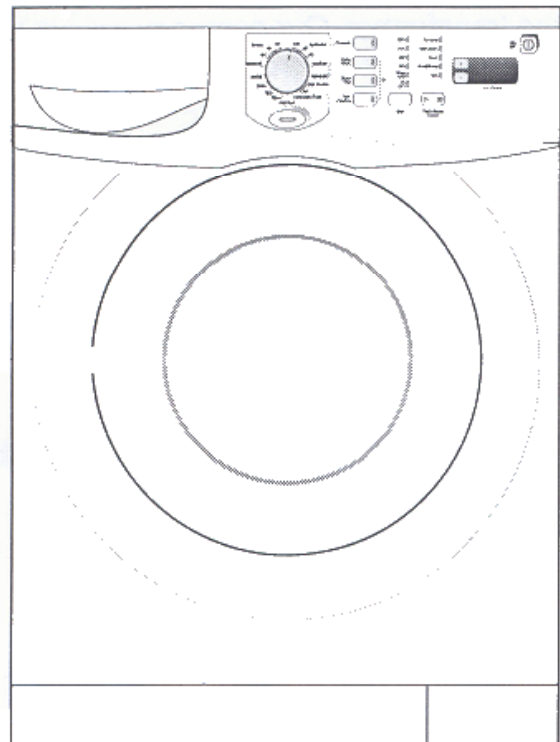

www.defy.co.za

Thank you for choosing Defy

You are now the proud owner of one of the finest and most modern washing machines that today's technology can produce. You and your Maximaid are going to make a great team together. But first it will pay if you really get to know each other. This book will tell you all you need to know about your machine, what it will do and how to do it. Please read all the instructions carefully before operating the machine.

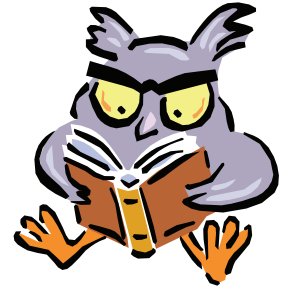

Installation

Packaging

All packaging must be removed from the machine.

Transport fittings

The wash drum is secured during transport to prevent damage.

Before using the machine, remove the transport fittings as follows:

1. Using a suitable spanner, loosen the four transport bolts (C) by turning them in an anti-clockwise direction until the bolts can be partially withdrawn.
2. Remove the bolts and the rubber bushes by pulling outwards. An up and down action together with a little dishwashing liquid will ease the removal.
3. Insert the plastic plugs (P) supplied with the machine into the holes vacated by the transport fittings.

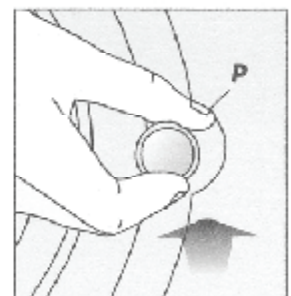
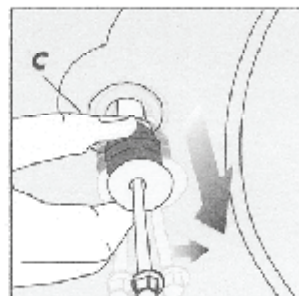
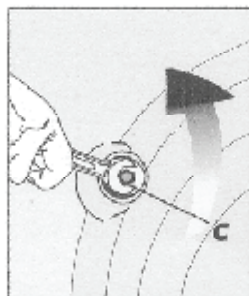
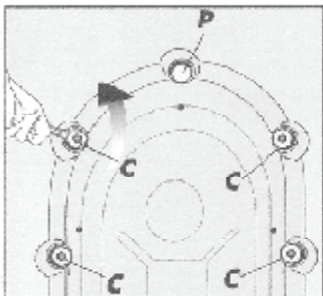

Note:

To prevent damage, the machine should be transported with the transport fittings securely in place.

Note:

Never place the machine on a carpet. This could prevent air circulation and cause electrical components in the machine to overheat.

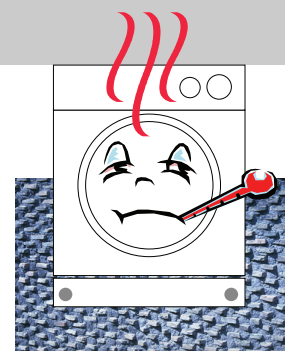

Levelling

1. The machine must stand firmly on the floor. Any instability will negatively affect its performance.
2. The machine has two adjustable feet at the front.
3. To level the machine, loosen the plastic lock nuts on the adjustable feet.
4. Rotate the feet until the machine stands firm and level.
5. Tighten the lock nuts firmly.
6. Caution : Never remove the lock nuts and feet from the machine.

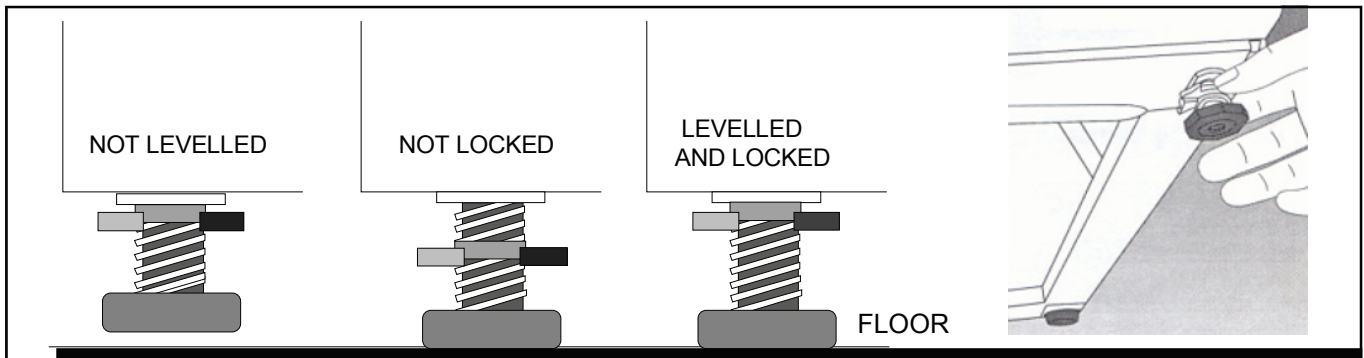

Connecting to the cold water supply

1. The water supply should deliver 8 to 80 litres per minute.
2. Sealing washers are supplied and these should be fitted at either end of the inlet hose.
3. Secure the angled end of the inlet hose to the water inlet at the rear of the machine and the straight end to a 3/4 inch BSP cold water tap.
4. Tighten both connections, open the tap and check for leaks.
5. We recommend that the tap be closed when the machine is not in use.

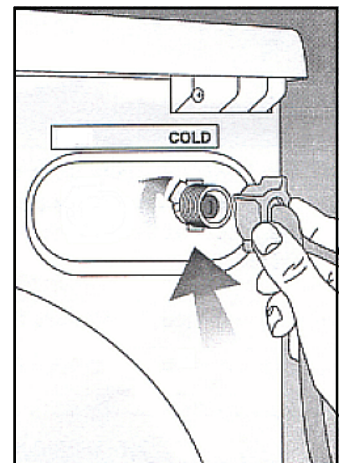

Water drainage

Draining into a dedicated outlet pipe (A)

1. The outlet pipe must have an inside diameter of at least 40 mm.
2. The end of the pipe must be positioned between 400 mm. and 1000 mm. above floor level.
3. Secure the hooked end of the drain hose into the outlet pipe.

Draining into a sink or bath (B)

1. The drain hose may be hooked over the edge of a sink or bath in such a way that the end can not be immersed in the collected waste water.
2. The outlet end of the hose must be between 400 mm. and 1000 mm. above floor level.

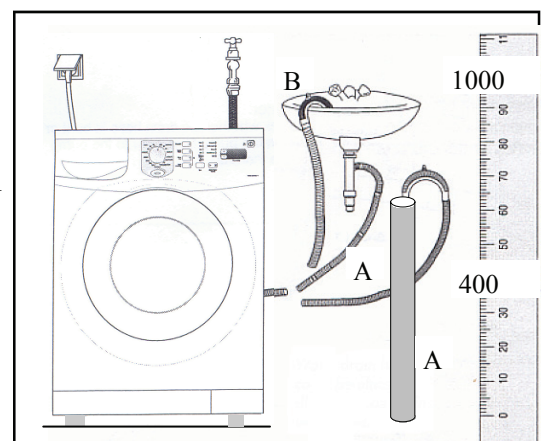

Please note: The outlet hose must be kept free of kinks or restrictions as these will hinder the operation of the machine.

Electrical connection

1. The power cord must be connected to a 15 amp earthed wall socket
2. Do not connect the machine through a double adaptor. It requires a dedicated power point
3. If the power cord should ever need replacing, use only a genuine cord (Type 'X') available from the nearest Defy Service Centre.

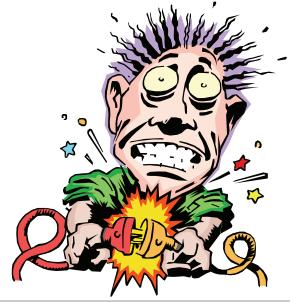

The appliance must be earthed and the manufacturer and seller do not accept responsibility for any damage due to incorrect electrical connection.

The detergent drawer

1. Open the drawer.
2. Place detergent and softener in the appropriate compartment of the dispenser drawer, in accordance with the instructions on the manufacturer's pack
3. Detergent and additives will automatically be released at the appropriate time during the wash cycle.

NOTE:

Use only low foam detergents specifically designed for front loading washing machines.

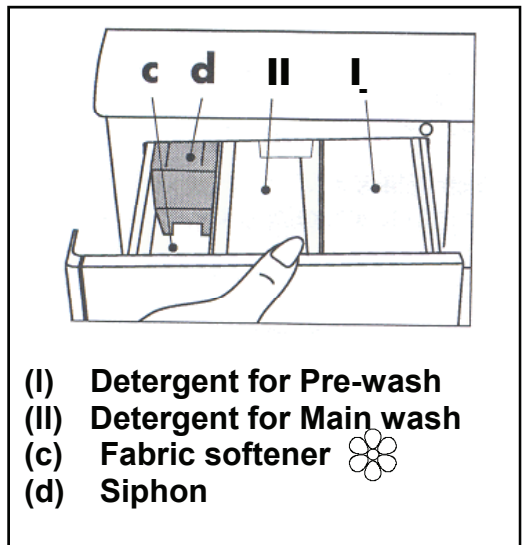

The control panel

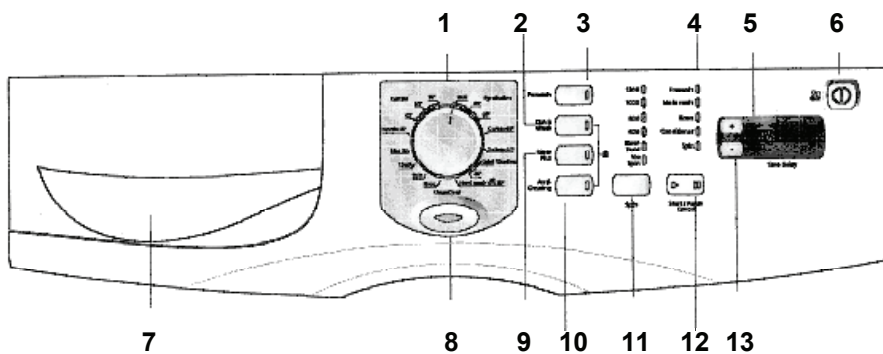

- | | |
|-------------------------------|-----------------------------------|
| 1. Programme selection knob | 7. Detergent drawer |
| 2. Quick wash | 8. Door open button |
| 3. Prewash | 9. Rinse plus |
| 4. Programme progress display | 10. Anti creasing |
| 5. Remaining time display | 11. Spin speed selection |
| 6. On / Off button | 12. Start / Pause / Cancel button |
| | 13. Time delay adjustment button. |

Features

Quick Wash button

Selecting this feature will shorten the wash time for lightly soiled fabrics. Quick wash may be used for cotton and synthetic programmes at temperatures below 60°C.

Rinse Plus

Selecting this feature will add an extra rinse to the wash cycle. This is particularly useful for removing any residual detergent from absorbent fabrics.

Anti Creasing

Fewer articles of clothing should be loaded when selecting this function. Which enables special wash and spinning profiles to minimise creasing and wrinkles. This significantly reduces the amount of ironing required afterwards.

Spin speed selection

The desired spin speed may be selected up to a maximum of 1200 rpm. If you do not require any spinning, select the NO SPIN option.

Rinse and Hold

Selecting this feature will stop the machine during the final rinse cycle with water in the tub. This prevents drip-dry, permanent press and wool articles from creasing caused by waiting in a 'dry' machine before being removed. To complete the programme, press the START / PAUSE / CANCEL button, select the desired spin speed and press the START / PAUSE / CANCEL button once more.

Detergent dispenser

The detergent dispenser has 3 compartments. (see page 4).

Use only low foam detergents specifically designed for front loading automatic washing machines. Dose as per the manufacturer's recommendations on the detergent pack. Dosage may vary according to wash load, dirt and water hardness.

Wash programme selector.

Turn the knob to select the desired programme.

Door

Open the door by pushing the DOOR OPEN button.

Close the door by pushing firmly until it clicks into place.

Note:

The door locks during the wash cycle.

Switch the machine off and allow 1 to 2 minutes for the safety lock to disengage.

Thereafter the door may be opened.

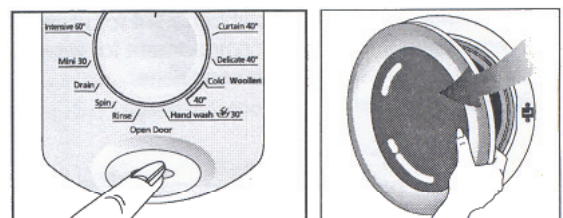

Helpful hints

- Sort washing by material type.
- Adhere to garment label washing instructions.
- Fasten zips to prevent them snagging other articles.
- Mend loose seams and tears before washing.
- Secure all loose buttons.
- Empty all pockets of coins and loose objects.
- Secure or remove brassiere wires.
- Wash small articles such as socks, handkerchiefs and delicate underwear in a wash bag or pillow slip. This will prevent tangling.
- Treat any stains before washing.
- Test fabrics for colourfastness before washing.
- Wash new denim separately as colours may run.
- Wash new bulky articles such as quilts and sleeping bags individually. For best results use the WOOL programme.
- Do not wash articles which have been soaked in paint, petrol, thinners, or other flammable liquids.
- Do not wash rubberised articles such as rain coats and training shoes.



Operating the machine

Sorting the laundry

Sort the laundry in one of the following groups:

1. White cotton and linen as well as robust colourfast fabrics.
2. Synthetics and synthetic blends as well as non colourfast fabrics.
3. Delicate fabrics such as silks and rayon.
4. Wool.

Loading the machine

- It is important not to overload the machine as this will prevent it from washing properly. You should be able to fit a hand between the top of the drum and the wash load in the drum.

Operating the machine continued

Washing

Plug the machine in and switch on at the wall socket.

Open the water tap.

Check that the drain hose is in position and is free of kinks.

1. Press the ON/OFF button.
2. Press the DOOR OPEN button.
3. Open the door.
4. Load washing into the machine, distributing it evenly and loosely in the drum. DO NOT EXCEED THE MAXIMUM WASH LOAD AS DETAILED IN THE WASH GUIDE (page 10).
5. Close the door.
6. Rotate and set the programme selection knob in to the desired programme. (see the wash guide on page 10).
7. Select the desired spin speed.
8. Select the desired auxiliary functions.
9. Add detergents and additives to the relevant compartments in the detergent drawer.
10. Close the detergent drawer.
11. Push the power START / PAUSE / CANCEL button.

The start / pause indicator light will glow and the machine will commence with the selected wash cycle.

You may monitor the progress of the wash cycle by observing the Programme progress display. - Main wash - Rinse- Conditioner- Spin

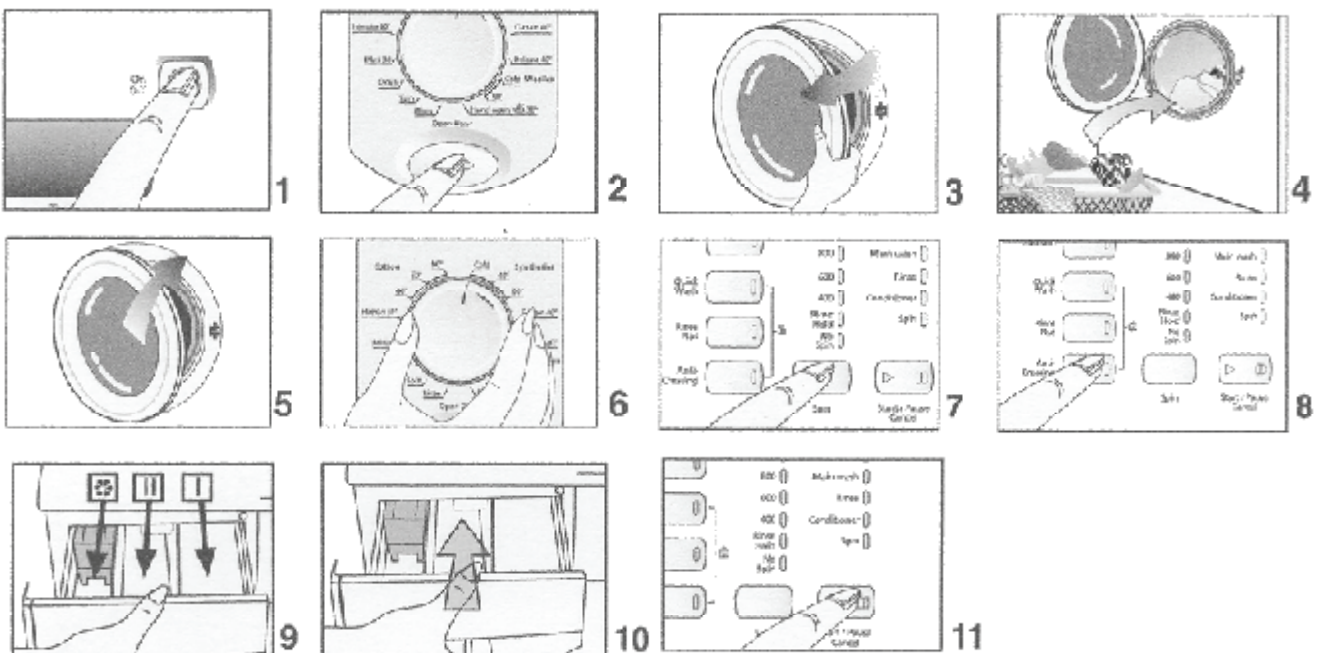

Operational notes

On / Off

- After pressing the On/Off button, the machine is ready to accept the desired programme, spin speed and auxiliary programmes. The DOOR OPEN light will glow, indicating that the door may be opened. The duration of the selected programme may be observed in the display window. To switch the machine off, press the On/Off button once more.
- **Pressing the On/Off button does not start a washing cycle. To do this, the Start/Pause button must be pressed.**

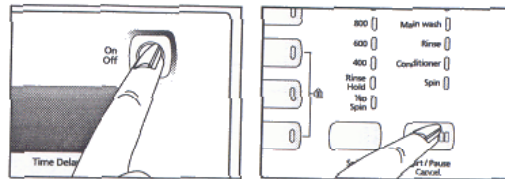

Safety lock

- To prevent unauthorised operation and programme changes, you may activate the SAFETY LOCK by pressing and holding both the second and fourth auxiliary function buttons simultaneously for three seconds after the machine starts washing.
- The PREWASH indicator light will commence blinking, showing that the safety lock has engaged.
- Only the ON / Off button will be operational after the safety lock has been activated de-activate the safety lock, press and hold the same two auxiliary function buttons for three seconds.

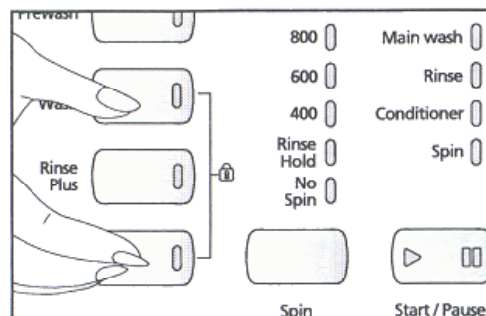

Unloading the machine

- At the completion of the wash cycle all the lights on the Programme progress display will glow.
- 1-2 min remaining time (for the door lock to disengage) will show in the display window. After 1-2 min the DOOR OPEN light will glow.
- Press the ON / OFF button and close the tap.
- Open the door and remove the wash load.
- Gently rotate the drum by hand to check if all the laundry has been removed
- Leave the door slightly ajar to assist with drying and to prevent unpleasant odours from forming.

Operational notes continued

Auxiliary function selection.

- The machine will restrict certain selections and make it impossible to select all the auxiliary functions in a single wash programme. For example, if the COTTON programme is selected, the QUICK WASH and PREWASH can not be selected at the same time.

Programme progress display

- The progress of the wash cycle may be monitored by observing the lights of the PROGRESS DISPLAY.
- The lights will glow sequentially until all the lights are on at the completion of the cycle.

Adding laundry

- Provided the water intake level is not too high, it is possible to stop the machine to add additional laundry.
- Press the START / PAUSE / CANCEL button.
- The door open indicator lights up after 1-2 minutes. Open the door and add the additional laundry.
- Close the door and press the START / PAUSE / CANCEL button once more for the machine to continue with the selected programme.
- **If the door open indicator light does not glow after two minutes, the water level is too high to add more laundry. Press the START / PAUSE / CANCEL button and allow the programme to continue.**

Time display

- The starting time of any programme may be delayed by using the time delay buttons. The delay time may be set at intervals of 30 minutes.
- On the display, the delayed time is added to the duration of the programme. For example : If the programme duration is 2 hours and 16 minutes and you wish to delay the start by 2 hours then the display will show 4 hours and 16minutes.
- After the delay time is set, press the START / PAUSE / CANCEL button.

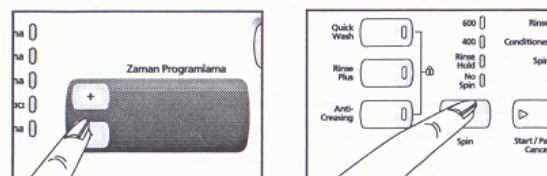

Programme cancelling *before the machine has started.*

- Press and hold the START / PAUSE / CANCEL button for 3 seconds.
- Set a new programme and press the START / PAUSE / CANCEL button once more.

Programme cancelling *after the machine has started.*

- Press and hold the START / PAUSE / CANCEL button for 3 seconds.
- Water will drain from the machine. The progress display will move to Spin
- The door may be opened after the DOOR OPEN light glows.

Wash programme guide

Depending on water, textile and ambient conditions, the values given may deviate from the standards as tested in laboratory conditions.

Programme	Fabric type	Programme description	Max load (kg)	Duration (min)	Water consumption (litre)	Energy consumption (kwh)	Pre-Wash	Quick wash	Rinse plus	Rinse Hold	Anti creasing Capacity	Detergent dispenser
Cotton 90	Heavily soiled fabrics made from cotton or linen, heat resistant.	Pre-wash / 3 Rinses / 3 Intermediate spins / Final spin.	7	139	55	2.26	●	●	●	●	● 2.5kg	I + II
Cotton 60	Normally soiled fabrics made from cotton or linen, heat resistant.	Main wash / 3 Rinses / 3 Intermediate spins / Final spin.	7	140	49	1.19	●	●	●	●	● 2.5kg	II
Cotton 40	Lightly soiled fabrics made from cotton or linen, non - colour fast.	Main wash / 3 Rinses / 3 Intermediate spins / Final spin.	7	142	49	0.50	●	●	●	●	● 2.5kg	II
Intensive 60	Heavily soiled fabrics made from cotton or linen, heat resistant.	Main wash / 4 Rinses / 4 Intermediate spins / Final spin.	7	175	70	1.35			●	●	● 2.5kg	II
Synthetics 60	Normally soiled fabrics made from cotton / synthetics blended, heat resistant.	Main wash / 3 Rinses / 3 Intermediate spins / Final spin.	3	103	50	1.02	●	●	●	●	● 1.5kg	II
Synthetics 40	Lightly soiled, easy care fabrics made from cotton, synthetics, blended, non - colourfast.	Main wash / 3 Rinses / 3 Intermediate spins / Final spin.	3	100	50	0.50	●	●	●	●	● 1.5kg	II
Synthetics Cold	Very lightly soiled, easy care fabrics made from cotton, synthetics, blended, non - colourfast.	Main wash / 3 Rinses / 3 Intermediate spins / Final spin.	3	85	50	0.21	●	●	●	●	● 1.5kg	II
Curtain 40	Special programme for curtains.	Pre-wash / Main wash / Special final spin profile for anti - creasing	2	115	65	0.55	●		●	●	● 2.0kg	I + II
Delicate 40	Sensitive, easy care fabrics made from cotton synthetics or blended fabrics.	Main wash / 3 Rinses / No intermediate spins / Final spin.	2	62	60	0.35			●	●	● 2.0kg	II
Woolen 40	Hand wash marked, easy care, blended fabrics.	Main wash / 3 Rinses / 1 intermediate spin / Final spin.	1.5	55	50	0.35			●	●		II
Woolen Cold	Hand wash marked, wool and easy care, blended fabrics.	Main wash / 3 Rinses / 1 intermediate spin / Final spin.	1.5	48	50	0.04			●	●		II
Handwash 30	Special programme for hand wash marked wool and silk.	Main wash / 2 Rinses / No intermediate spin / Final spin.	1	40	40	0.15						II
Mini 30	Lightly soiled smaller load.	Main wash / 2 Rinses / Final spin.	2.5	30	50	0.15						II
Rinse	Rinsing.	3 Rinses / 2 intermediate spins / Final spin in cotton profile.	7	23	15	0.12						---
Spin	Spinning.	Final spin in cotton profile.	7	19	---	0.1						---
Drain	Draining.	Drain	---	2	---	---						---

Care and maintenance

Detergent Dispenser

To remove residual detergent, pull the dispenser drawer outward, press on the marked area of the siphon, and pull the drawer free.

Wash the dispenser and the housing in water before re-inserting the dispenser.

Siphon

To prevent clogging, the siphon (the coloured component in the dispenser) should be cleaned after every 30—40 washes.

Grasp the edges and pull the siphon free.

Clean away any residual softener and carefully re-fit the siphon.

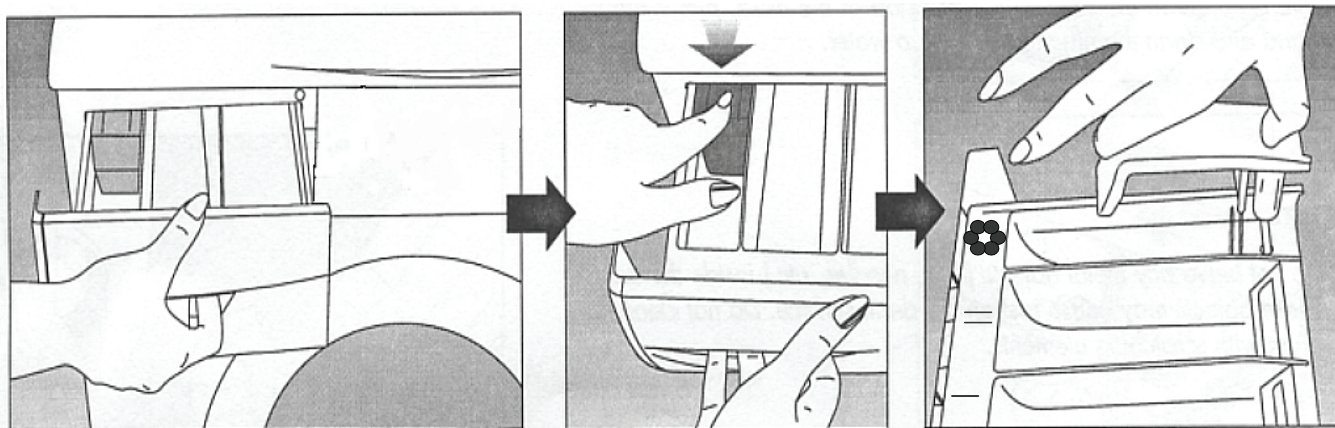

Cleaning the pump filter

- A filter prevents foreign objects from entering and damaging the pump. This filter should be cleaned after every 30-40 washes.
- First disconnect the machine from the power supply.
- Press on the marked area of the filter cover to open it.
- Remove the small coloured plug from the drain hose and empty the drain water into a suitable receptacle placed on the floor below the hose. When all the drain water has discharged, replace the plug.
- Unscrew and remove the filter. Some residual water may leak onto the filter cover.
- Remove any debris and clean the filter before replacing it
- Mop up any spillage and close the filter cover.

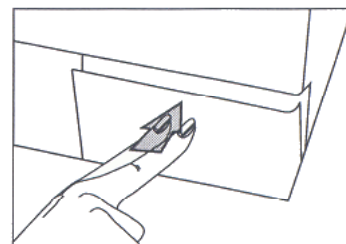
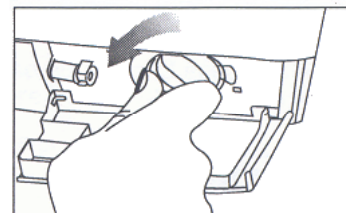
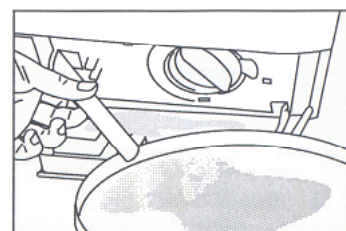
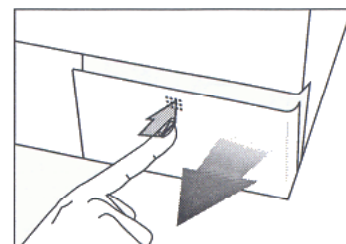

General Cleaning

On no account use benzene or other solvents to clean the cabinet, door or rubber of the machine.

A damp cloth will normally suffice.

If desired, a good wax polish may be used on the painted parts of the cabinet.

Care and maintenance

The water intake filter

- Water intake filters are located at the machine inlet valve and at the tap end of the inlet hose. These filters prevent dirt from entering the machine and should be cleaned periodically. (every 30 to 40 washes.)
- Close the tap and disconnect the inlet hose.
- Clean the filters with a bristle brush .
- If the filter is very dirty it may have to be pried loose with a pair of pliers.

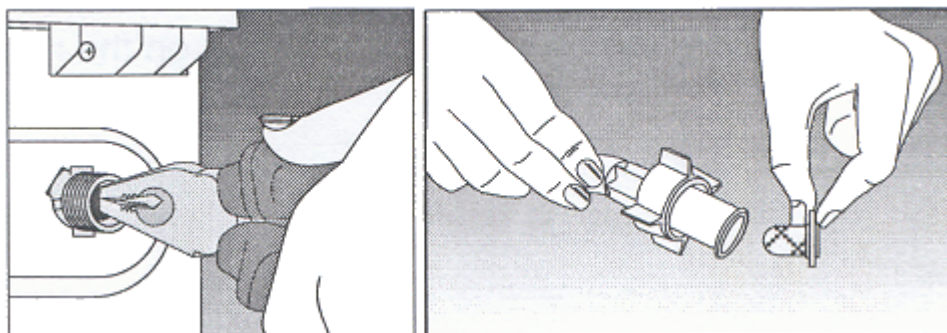

Hoses

- Periodically inspect the hoses for cracks or deterioration.
- Worn hoses should be replaced and are available from the nearest Defy Service Centre.

Owner's responsibility

Since the following are not factory faults, they are the owner's responsibility.

- Damage to exterior finish.
- Breakage of glass and other components..
- Damage through improper installation.
- Damage caused through improper use of the appliance.
- Damage caused by moving or transporting the appliance..

Problem washing—Check list

Greasy stains on washing.

- Use more detergent if washing is heavily soiled.
- Use both prewash and main wash programmes.
- Check that the machine is not overloaded.

Grey, dirty looking washing.

- Use more detergent if the washing is heavily soiled or if the machine is located in a hard water area.
- Use prewash and main wash programmes.
- Check that the machine is not overloaded.

Poor wash results

- Read the instruction book carefully
- Follow the manufacturer's instructions on the detergent pack.
- Sort out fabric types and separate natural from synthetic fabrics.
- Select the appropriate wash programme.
- Use fabric softeners for extra softness.
- Check that the machine is not overloaded.

Discolouring

- This could be caused by natural body oils or iron deposits in the water supply.
- Select the correct programme at the correct temperature.
- Use the correct detergent dosage.
- Wash the garment to the manufacturer's directions.
- Check that the machine is not overloaded.

Trouble shooting

If you experience a problem with the machine, please check the following before calling a Service technician. It may seem obvious, but you may be charged for a service call, even during the warranty period, if no fault is found.

Foam is expelled from the detergent dispenser.

Check:

- That detergent is suitable for front loading automatic washing machines. If the detergent is suitable, try using less.

The machine drains as it fills.

Check:

- That the outlet hose is fitted as described on page 3 of this manual.

Trouble shooting (continued)

The machine will not work at all.

Check:

- House fuses or circuit breakers.
- Wall socket (plug in another appliance to check)
- That the door is closed properly.
- That the water tap is open.
- That a programme has been selected.
- That the ON/ Off button has been pressed in.

The machine does not drain or spin.

Check:

- That the drain hose is not kinked or obstructed.
- That the outlet pipe or sink is not blocked.
- That the pump filter has been cleaned.

The machine does not fill with water.

Check:

- That the water tap is open.
- That the drain hose end is at least 400 mm. above floor level.
- That the inlet hose is not kinked and that the filters are clean.
- That there is a water supply to the tap.
- That the door is closed.

The machine vibrates or is excessively noisy.

Check:

- Whether anything has fallen between the wall and the machine.
- That the machine stands level and that the feet are locked.
- That the transport brackets and all packaging has been removed.
- That there is a clearance of at least 50 mm. at the back of the machine.
- That the laundry is evenly distributed in the drum.

The door will not open

Check:

- That the machine is switched off at the ON/OFF switch.
- That the safety lock has disengaged (wait at least two minutes)

The machine leaks water

Check:

- That the inlet and outlet hoses are secured .
- That the pump filter cap is securely screwed in.

International fabric care labels



**Recommended
washing temperature**

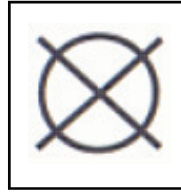

No dry cleaning



Bleach can be used

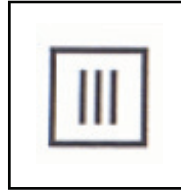

No spin



Do not use bleach

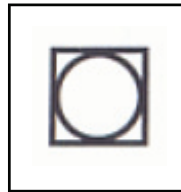

**May be washed in
centrifugal machine**



Wash by hand only

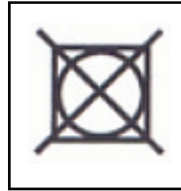

**Do not wash in centrifugal
machine**

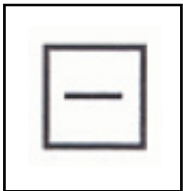

Dry on horizontal surface



Line dry



Do not wash



Ironing is permitted



Dry clean

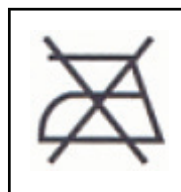

Do not iron



Chemicals can be used

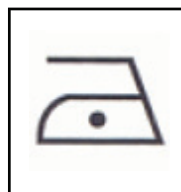

**Use a warm iron only
NOT HOT**

Service Centres

If you have followed the instructions and still have a problem, contact the nearest Defy Service Centre. They will be able to advise you on any aspect of the product or send a qualified technician to repair it.

BLOEMFONTEIN 160 Long Street, Hilton,
Bloemfontein 9301.
Tel. 051 400 3900
Bloemfontein.Service@defy.co.za

CAPE TOWN 5A Marconi Rd.
Montague Gardens, 7441.
Tel. 021 551 8314
CapeTown.Service@defy.co.za

DURBAN 35 Intersite Avenue,
Umgeni Business Park, Durban 4051.
Tel. 031 268 3300
Durban.Service@defy.co.za

EAST LONDON 16 Bowls Rd. Arcadia,
East London 5201.
Tel. 043 743 7100
EastLondon.Service@defy.co.za

JOHANNESBURG Cnr. Mimetes & Kruger Sts. Denver ext.12
Commercial Head Office,
Administration, Distribution, National Groups,
Tel. Sales, Contracts and Credit.
Johannesburg. 2094.
Tel. 011 621 0200 or 011 621 0300
Gauteng.Service@defy.co.za

POLOKWANE 87 Nelson Mandela Drive.
Superbia 0699.
Tel. 0152 92 1166 / 7 / 8 / 9.
Polokwane.Service@defy.co.za

PORT ELIZABETH 112 Patterson Road,
North End, Port Elizabeth 6001.
Tel. 041 401 6400
PortElizabeth.Service@defy.co.za

PRETORIA. Block A1 Old Mutual Industrial Park.
Cnr. D.F.Malan Drive & Moot Str.
Hermanstad. 0082.
Tel. 012 377 8300
Pretoria.Service@defy.co.za

**OTHER AREAS ARE SERVICED BY OVER 200 AUTHORISED SERVICE AGENTS.
PLEASE CONSULT THE NEAREST REGIONAL DEFY SERVICE CENTRE FOR DETAILS**

Warranty

This certificate is issued by DEFY APPLIANCES LIMITED manufacturers of Defy and Ocean products, hereinafter the Company, to the original purchaser only, of the appliance described on the certificate and shall constitute the only warranty given in respect of this appliance.

The Company warrants to the original purchaser that for a period of **TWO YEARS** from date of purchase the appliance is free from defect under normal domestic use, both in workmanship and material, subject to the following conditions.

1. Repair or replacement of any part of this appliance, found by the Company to be defective, shall be at the election of the Company. The Company reserves the right to effect such service through any of its Service Divisions or Authorised Service Dealers. The cost of such service shall be borne by the Company in full, provided that the appliance is located no further than 50 km. from a Company Service Centre or an Authorised Service Dealer. Where the appliance is located beyond the 50 km. radius, the purchaser shall be liable for the standard travelling charges, as determined by the Company.

CARRY IN SERVICE Microwave ovens, Compact cookers and small appliances are repaired in our service centres and are not collected from the customers home. Faulty units should be delivered to the purchasing dealer or to the nearest Company Service Centre for warranty repairs.

2. Vitreous enamelware, fuses and lamps are specifically excluded from these warranties. It is an express condition of these warranties that the purchaser takes due care and attention in the use and maintenance of the appliance. Abuse, misuse in conflict with operating instructions, connection to incorrect voltages and subjection to commercial use shall release the Company from its obligations.

3. This warranty shall become void and cease to operate if the appliance is dismantled by, or any repairs to the appliance are effected by any persons not duly authorised by the Company, or if substitute parts not approved by the Company are used in the appliance, or if the serial number of the appliance is removed.

4. The Company shall not be responsible for damages resulting from fire, flood, civil disturbances or any Act of God. The Company shall not, in terms of these warranties be responsible nor held liable for any consequential loss or damage of any kind caused by or due to the failure or malfunction of the appliance.

5. The Company shall not be responsible for transportation or other costs other than those incurred within the provisions of Point 1 of this Certificate.

6. These warranties shall not apply to the appliance if it is purchased or used beyond the borders of the Republic of South Africa, Namibia, Botswana, Swaziland and Lesotho.

7. Where service is requested under warranty and no fault or defect can be found by the Company, all costs incurred will be for the purchaser's account.

8. This Certificate as well as your invoice will serve as proof of purchase. For the purpose of warranty, it will be essential to produce this Certificate and invoice. Failure to do so, will render the purchaser liable for service costs.

**KEEP THIS CERTIFICATE AND SALES INVOICE AS PROOF OF
PURCHASE FOR WARRANTY PURPOSES.**

Notes

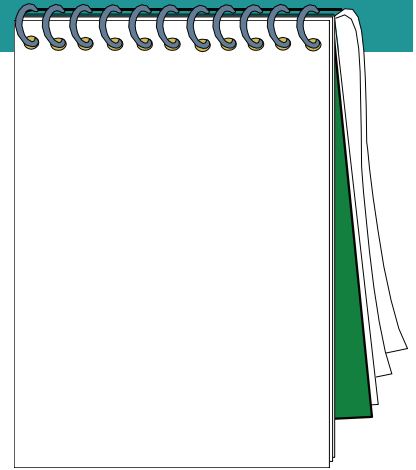

Notes

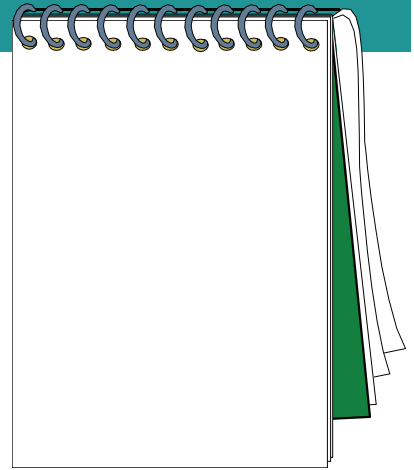

TECHNICAL SPECIFICATION

Maximaid 720

Height	850 mm.
Width	600 mm.
Depth	590 mm.
Net weight	76 kg.
Power requirement	220-230 V, 50 Hz.
Nominal current	10 A
Total power	2400 W
Washing speed	52 rev/min Max.
Spin speed	1200 rev/min



You can rely on Defy

Top lid
Detergent dispenser
Control panel
Door
Pump cover
Kick panel

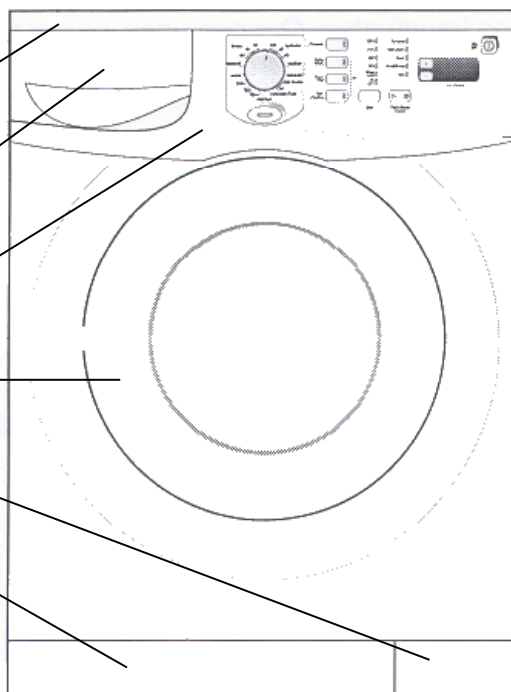

The Manufacturer strives for continuous Improvements. For this reason, the text and illustrations in this book are subject to change without notice.

This washing machine is designed for domestic use only.

Free Manuals Download Website

<http://myh66.com>

<http://usermanuals.us>

<http://www.somanuals.com>

<http://www.4manuals.cc>

<http://www.manual-lib.com>

<http://www.404manual.com>

<http://www.luxmanual.com>

<http://aubethermostatmanual.com>

Golf course search by state

<http://golfingnear.com>

Email search by domain

<http://emailbydomain.com>

Auto manuals search

<http://auto.somanuals.com>

TV manuals search

<http://tv.somanuals.com>