

SMT Power Inductor (MOLDING TYPE)

MPO13X Type

Features

- RoHS compliant.
- Low profile, high current SMD type.
- Frequency range up to 1MHz.
- Lowest DCR/ μ H, in this package size.
- Low buzz noise due to its gap-less structure.

Applications

- Notebook/Desktop/Server/Video Card applications.
- High current POL converters.
- Low profile, high current power supplies.
- Battery powered devices.
- Ideal for power source circuits, DC-DC converter.
- DC-AC inverters inductor application.

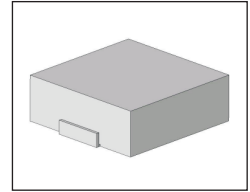

Mechanical Dimension:

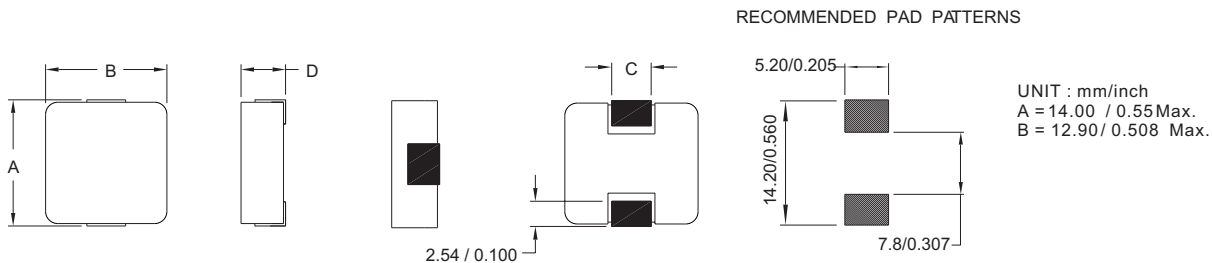

Electrical Characteristics: At 25°C: 100KHz, 0.25V

PART NO.	Lo ¹ (μ H)	DCR (m Ω) TYP.	DCR (m Ω) MAX.	Isat ¹ (A dc)	Ir ² (A dc)	Dimension "C" mm / inch $\pm 0.5 / \pm 0.02$	Dimension "D" mm / inch MAX
MPO135-R68	0.68 \pm 20%	1.5	1.7	54	34	3.5 / 0.138	5.0 / 0.197
MPO135-R82	0.82 \pm 20%	2.0	2.3	53	31	3.5 / 0.138	5.0 / 0.197
MPO135-1R0	1.00 \pm 20%	2.1	2.5	50	30	3.5 / 0.138	5.0 / 0.197
MPO135-1R5	1.50 \pm 20%	3.4	4.1	48	23	3.0 / 0.118	5.0 / 0.197
MPO135-1R8	1.80 \pm 20%	3.6	4.5	38	20	3.0 / 0.118	5.0 / 0.197
MPO135-2R2	2.20 \pm 20%	4.6	5.5	32	18	2.7 / 0.106	5.0 / 0.197

1. Isat is the DC current which cause the inductance drop approximately 30% of its nominal inductance without current.
2. Ir is the DC current which cause the surface temperature of the part increase approximately than 40°C.



DELTA ELECTRONICS, INC.

(TAOYUAN PLANT CPBG) 252, SAN YING ROAD, KUEISAN INDUSTRIAL ZONE, TAOYUAN SHIEN, 333, TAIWAN, R.O.C.
TEL: 886-3-3591968; FAX: 886-3-3591991
<http://www.deltawww.com>

Free Manuals Download Website

<http://myh66.com>

<http://usermanuals.us>

<http://www.somanuals.com>

<http://www.4manuals.cc>

<http://www.manual-lib.com>

<http://www.404manual.com>

<http://www.luxmanual.com>

<http://aubethermostatmanual.com>

Golf course search by state

<http://golfingnear.com>

Email search by domain

<http://emailbydomain.com>

Auto manuals search

<http://auto.somanuals.com>

TV manuals search

<http://tv.somanuals.com>