

DXDimplex



DXDF20



DXDF20L

DXDF20 & DXDF20L Designer Fan Heaters with Climate Control

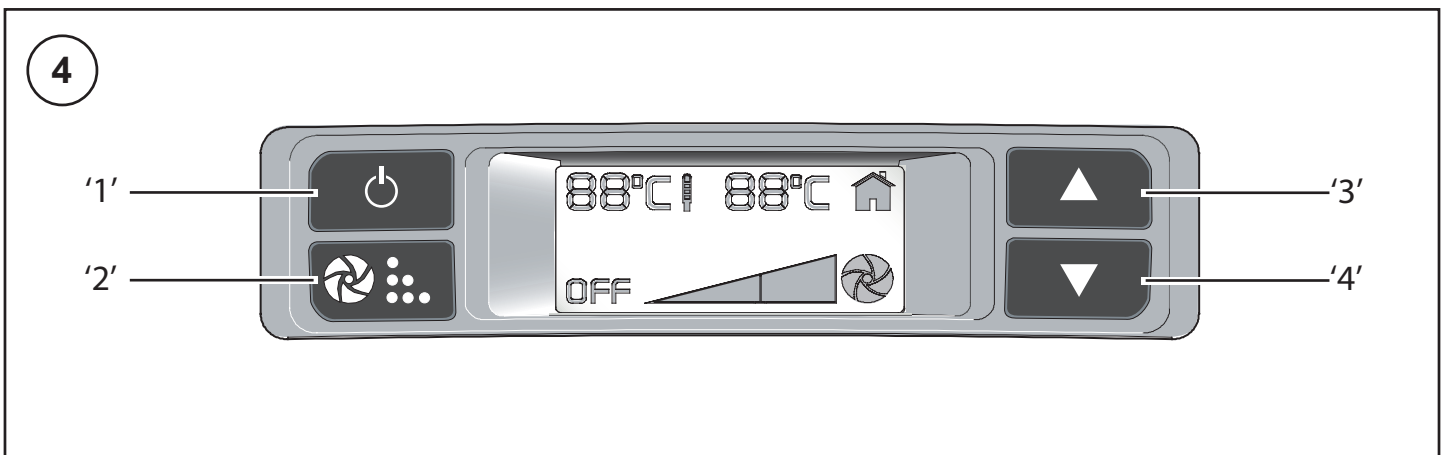
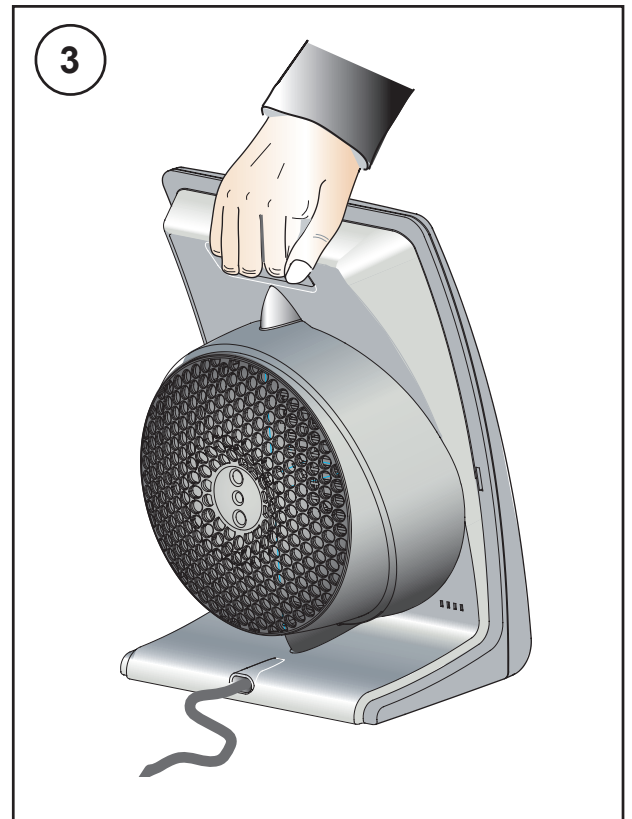
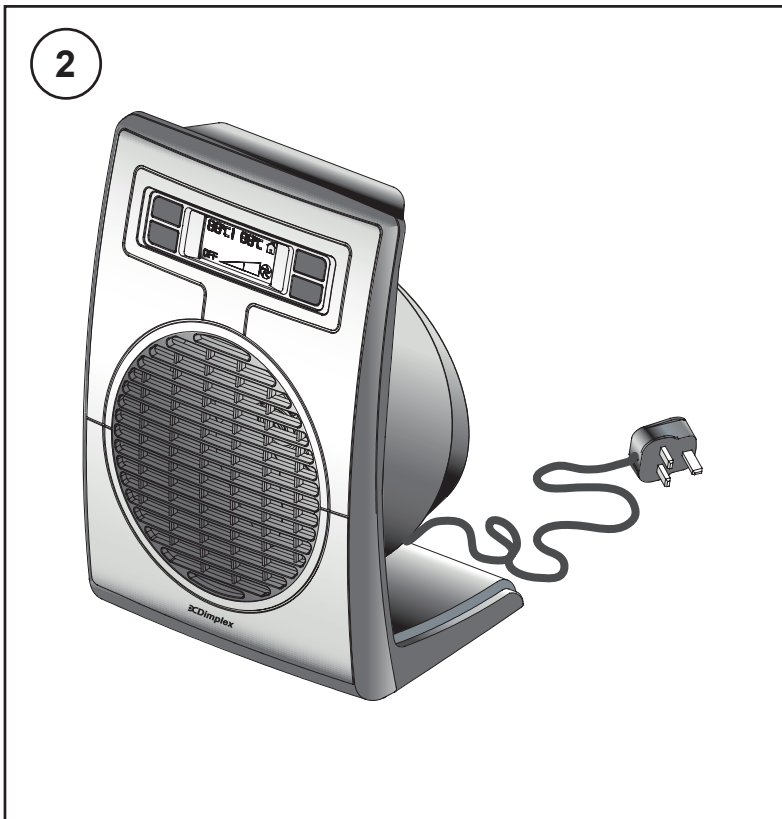
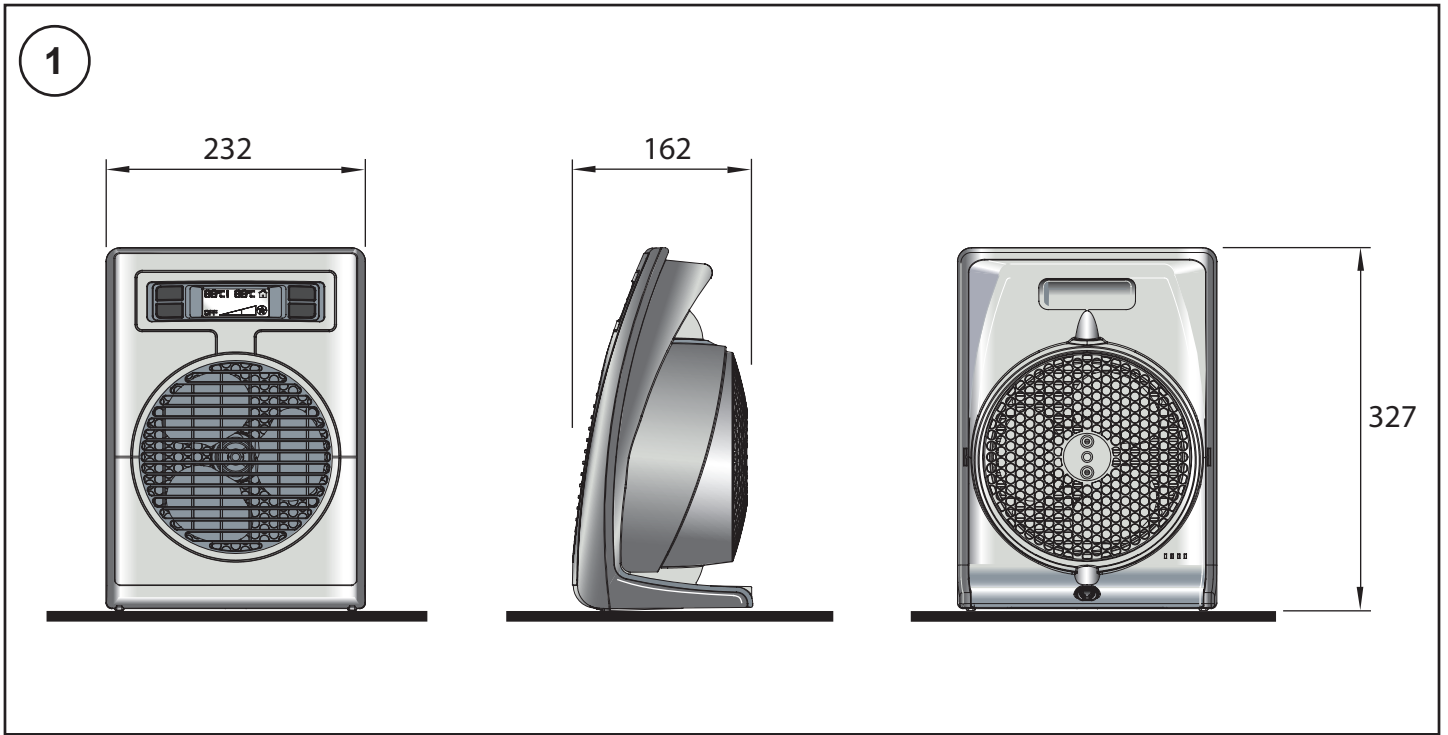

DXDF20 & DXDF20L 2kW Fan Heater

THESE INSTRUCTIONS SHOULD BE READ CAREFULLY AND RETAINED FOR FUTURE REFERENCE

IMPORTANT SAFETY ADVICE

DO NOT use the heater on deep pile carpets or the long hair type of rugs, or less than 750mm away from any overhanging surface. Keep combustible materials such as drapes and other furnishings clear from the front, sides and rear of the heater. Do not use heater to dry your laundry.

DO NOT use the heater in the immediate surroundings of a bath, a shower or a swimming pool.

DO NOT place the heater directly below a fixed socket outlet.

The socket-outlet must be accessible at all times to enable the mains plug to be disconnected as quickly as possible.

DO NOT COVER or obstruct the air inlet and outlet openings in any way.

The heater must be on a flat stable surface when in use.

DO NOT operate the heater with the mains lead overhanging the front outlet grille.

NEVER leave the heater unattended when it is used by or near the aged, infirm person's or children.

THE HEATER CARRIES THE WARNING SYMBOL  INDICATING THAT IT MUST NOT BE COVERED.

The instruction leaflet belongs to the appliance and must be kept in a safe place. If changing owners, the leaflet must be surrendered to the new owner.

IMPORTANT – If the mains lead of this appliance is damaged, it must be replaced by the manufacturer or its service agent or a similarly qualified person in order to avoid a hazard.

WARNING: In order to avoid a hazard due to inadvertent resetting of the thermal cut-out, this appliance must not be supplied through an external switching device, such as a timer, or connected to a circuit that is regularly switched on and off by the utility.

Electrical connection

This heater must be used on an **A.C.**~ supply only and the voltage marked on the heater must correspond to the supply voltage. This heater is fitted with a plug incorporating a 13 amp fuse. When replacing the fuse, a 13 amp fuse approved by ASTA to BS 1362 must be used.

If the plug is not suitable for the socket outlets in your home, the plug must be cut off and an appropriate one fitted. A plug cut off from a mains lead will give a shock hazard if inserted into a 13 amp socket elsewhere in the house. To avoid this, it should be disposed of immediately.

NOTE: The fuse cover of a non-rewirable plug must be refitted when changing the fuse. Should the cover become lost, the plug must not be used until the correct replacement fuse cover is obtained from your supplier or by contacting our customer helpline.

IMPORTANT : The wires in this mains lead are coloured in accordance with the following code :

BLUE: NEUTRAL

BROWN: LIVE

As the colours of the wires in the mains lead may not correspond with the coloured markings in your plug, proceed as follows :

Connect the **BROWN** wire to the terminal marked '**L**' or coloured **RED**. Connect the **BLUE** wire to the terminal marked '**N**' or coloured **BLACK**. **Note :** '**L**' or '**N**' must not be connected to the **EARTH** terminal marked '**E**' or  or coloured **GREEN** or **GREEN AND YELLOW**.

If in doubt, consult your electrician.

General

The heater has a loading of 2kW.

Heat output and temperature control on this appliance are provided using the electronic control. With the unit plugged in, and by pressing the 'STAND-BY' button (see '1' in **Fig. 4**) the heater can be turned on. The appliance is provided with a handle for easy carrying - see **Fig. 3**.

Operation - see Fig. 4

The heat output is electronically controlled, according to the room temperature.

To switch the appliance On/Off press button '1'.

Press button '2' to select Fan only/Low heat/High heat. By pressing this button once Fan only is selected, pressing twice provides Low heat and by pressing three times High heat is selected.

On the display screen (see **Fig. 4**) two temperature readings appear at the top of the screen. The room ambient temperature appears on the right and the desired temperature appears on the left hand side.

Use buttons '3' and '4' to set the desired room temperature when Low or High heat is selected.

The temperature can be set from 5°C to 35°C and this will be shown on the display. When the temperature is reached the heater will automatically switch off. If the ambient temperature drops the heater will come on again automatically. Note the electronic climate control device conserves energy and assists with temperature regulation e.g. if the heater is set to **HIGH** heat and the temperature is set to 28°C, at 27°C the heater will switch to **LOW** heat. Then at 28°C the heater will switch **OFF** completely.

An audible beep can be heard when any button is pressed.

A double beep can be heard when 5° and 35° is selected; the upper and lower limits.

By keeping buttons '3' and '4' pressed down the user can scroll quickly to the desired temperature.

Note: The heater retains it's last setting once the appliance has been switched off or disconnected from the power supply.

Overheat cut-out

The built-in overheat cut-out switches off the appliance automatically in the event of a fault. Disconnect the mains plug from the socket. After a short cooling down phase, the appliance switches into stand-by mode and is ready for use again. If the fault should occur again, see your local dealer.

Cleaning

WARNING : ALWAYS DISCONNECT FROM THE POWER SUPPLY BEFORE CLEANING THE HEATER

Do not use detergents, abrasive cleaning powders or polish of any kind on the heater.

Wipe with a dry cloth to remove dust and a damp cloth (not wet) to clean off stains. Be careful not to allow moisture into the heater.

Ensure that dust or fluff does not accumulate inside the heater as this could lead to overheating of the element. Use a vacuum cleaner to remove any fluff which does accumulate.

Recycling

For electrical products sold within the European Community.



At the end of the electrical products useful life it should not be disposed of with household waste. Please recycle where facilities exist. Check with your Local Authority or retailer for recycling advice in your country.

After Sales Service

Your product is guaranteed for three years from the date of purchase.

Within this period, we undertake to repair or exchange this product free of charge provided it has been installed and operated in accordance with these instructions.

Your rights under this guarantee are additional to your statutory rights, which in turn are not affected by this guarantee.

Should you require after sales service you should contact our customer services help desk on 0870 727 0101. It would assist us if you can quote the model number, series, date of purchase, and nature of the fault at the time of your call. The customer services help desk will also be able to advise you should you need to purchase any spares.

Please do not return a faulty product to us in the first instance as this may result in loss or damage and delay in providing you with a satisfactory service.

Please retain your receipt as proof of purchase.

Glen Dimplex UK Limited
Millbrook House
Grange Drive
Hedge End
Southampton
Hampshire. SO30 2DF

UK customer help line (8.00AM – 6.00PM Mon-Fri; 8.30AM-1.00PM Sat)

Customer Services:	Tel.	0870 7270101
	Fax.	0870 7270102
	e-mail	customer.services@glendimplex.com
Republic of Ireland	Tel.	01 8424833

[c] Glen Dimplex UK Limited

All rights reserved. Material contained in this publication may not be reproduced in whole or in part, without prior permission in writing of Glen Dimplex UK Limited.

Free Manuals Download Website

<http://myh66.com>

<http://usermanuals.us>

<http://www.somanuals.com>

<http://www.4manuals.cc>

<http://www.manual-lib.com>

<http://www.404manual.com>

<http://www.luxmanual.com>

<http://aubethermostatmanual.com>

Golf course search by state

<http://golfingnear.com>

Email search by domain

<http://emailbydomain.com>

Auto manuals search

<http://auto.somanuals.com>

TV manuals search

<http://tv.somanuals.com>