

FlexScan®

L23 & L34

35 cm (13.8 inch) and 38 cm (15 inch) class color LCD Monitors

13.8 inch/15 inch class
Color LCD Monitors



The Next Display Interface

Since the early 1980's, we have been producing quality digital products and incorporating digital technology into our superior, high quality CRT monitors. As we enter a new interface era, EIZO is proud to introduce the L23 and the L34 as our latest offerings in the flat panel market segment.

Both models incorporate our original D³ technology which represents the accumulation of EIZO's expertise in digital and analog display technology, and provides the differentiation that will create a strong impact in the display monitor industry.

D³ (D-cubed) Technology

The EIZO original D³ ASIC (Application Specific Integrated Circuit) greatly improves the control of the brightness level and color reproduction for superior image quality on the L23 and L34.

D³ encompasses EIZO's advanced skill in three key areas of digital display technology: Digital Signal Processing, Digital Image Control and Digital FlexScan.



[D-cubed]

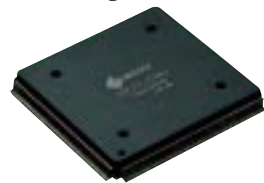

Digital Signal Processing

Automatic Contrast Adjustment

When input signal levels of an LCD monitor are too high or too low, it is difficult to reproduce exact colors. EIZO has incorporated an automatic contrast adjustment function that amplifies the video input for excellent color reproduction.

True Color Capability

The EIZO D³ ASIC incorporates FRC (Frame Rate Control) circuitry which expands the color capabilities beyond the panel's capacity of 260,000 colors to 16 million colors.

Digital Image Control

New Brightness Control

EIZO's customized brightness control uses a microprocessor and an inverter to control the oscillation of the CCFL (Cold Cathode Fluorescent Light) backlight. This system makes it possible for a high brightness level of 200 cd/m² to remain stable with a wide (20 - 100%) adjustment range.

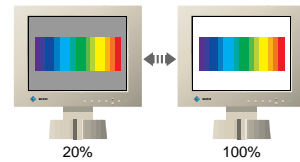

Auto Brightness Control System

To eliminate any brightness fluctuation, the EIZO Auto Brightness Control System directly monitors changes in the surrounding and backlight temperatures and automatically adjusts the divergence to the brightness default setting or the user defined level.

Variable Border Intensity

For maximum viewing comfort, EIZO has incorporated a function that allows the user to change the border intensity level in 64 graduations. So, when using the L23 or L34 in display modes smaller than the panel's capacity, such as 640 × 480 or 800 × 600, the user can reduce the contrast level between the background and the cabinet.

Full Screen Mode

In any application which uses 640 × 480 or 800 × 600 display modes, the EIZO D³ ASIC has a specific interpolation function that allows for these modes to be displayed to almost a full screen. Download from www.Somanuals.com. All Manuals Search And Download.

Digital FlexScan

Auto Adjustment and the EIZO ScreenManager™

To simplify any screen adjustment, EIZO has incorporated an Auto Adjustment function similar to the one found in our CRT monitor range. The D³ ASIC takes a sampling of the computer's timing and calculates the best screen position. If further adjustments are desired, the EIZO ScreenManager can be used to refine the image.

* EIZO has also included a software adjustment program on a floppy disk for fast, convenient setup.

Standard PC Compatible Interface

The L23 and L34 support a wide range of standard analog RGB input signals. These are calculated by the microprocessor and D³ ASIC and are digitally processed to create the perfect image. The L23 and L34 require no special graphics boards or dedicated controllers to drive them and they can be connected with ease in the same manner as a standard CRT monitor.

Multiple Input Signals Supported

The EIZO D³ ASIC automatically adjusts and amplifies the input signal to the best level in order to optimize the screen performance for various kinds of input signals from a resolution of 640 × 480 to 1024 × 768.

Advanced Ergonomic Design

Ergonomic issues have increasingly been important factors in the design of EIZO monitors, and the L23 and L34 incorporate many collective advantage over traditional monitors: a more compact and space-saving design, lighter weight, lower power use, and lower EMI (Electromagnetic Interference) emissions. Additionally, our expertise in the field of making a better working environment has led us to incorporate further quality, usability and safety features.

Image Quality

High contrast, distortion free images are displayed on the anti-glare screens of the L23 and the L34, providing a superior image quality and sharper definition of text for improved viewing characteristics.

Wide Viewing Angle

The L23 and L34 utilize liquid crystal panels which have 140° horizontal, and 110° and 120° vertical wide viewing angles respectively, making the screens visible from a variety of angles.

Wide Angle Adjustment

Both the L23 and L34 are ideal for an office environment where space is limited. The tilt and swivel stand can be rotated up and down and to the left and right, allowing for a wide sphere of adjustment possibilities and viewing comfort.

Dual Inputs and Input Priority Switch

As with most EIZO FlexScan CRT monitors, the L23 and L34 are equipped with dual input connectors and an input priority function. This means that two computers can be simultaneously connected to the L23 or L34 and priority can be given to either computer. Switching between the two computers can be done conveniently using a button on the front panel. Each input can support Plug & Play (VESA DDC 1/2B) independently.

Space-Saving Cable Design

One of the benefits that LCDs offer is their compact, space-saving design. The L23 and L34 occupy only about 40% of the depths of CRTs with the equivalent screen size.

This is most noticeable in their unobtrusive cable hook-up design, making them ideal for an office environment where space is at a premium.



Cable design within the stand

Energy Saving

Newly developed LCD power circuits lower the power consumption of the L23 and L34 to a mere 30 Watts when in regular use. With the built-in PowerManager™ function, power consumption drops to less than 5 Watts when the displays are turned on but not in use. The lower heat emissions lessen the need for office air conditioning and contribute to a reduction in electricity consumption.

Compliance With Global Ergonomic Standards

To add to the superior quality and safety of the L23 and L34, we have complied with the following international certifications:

- TÜV Rheinland/Ergonomie for the control of radiation (MPR II), and
- ISO 9241-3 and -8 for character definition and color uniformity.
- TCO 95 for the control of electromagnetic waves, energy reduction, electrical safety in the work environment, and recyclability.
- CE mark to effect electromagnetic compatibility (EMC) in the crowded office environment.



Safety-Lock Device

The L34 comes equipped with a safety-lock device for security.





Specifications

	L23	L34
LCD Panel	35 cm (13.8") TFT Color LCD Panel	38 cm (15") TFT Color LCD Panel
Dot Pitch	0.273 mm	0.297 mm
Display Color	260,000 colors (16 million colors with FRC Circuitry)	260,000 colors (16 million colors with FRC Circuitry)
Viewing Angle	Horizontal: 140° Vertical: 110°	Horizontal: 140° Vertical: 120°
Scanning Frequency	Horizontal: 30 - 50 kHz Vertical: 55 - 85 kHz (Up to 60 Hz at 1024 × 768 mode)	Horizontal: 30 - 61 kHz Vertical: 50 - 85 kHz (Up to 75 Hz at 1024 × 768 mode)
Input Signals	RGB Analog	RGB Analog
Input Terminal	D-Sub mini 15 pin × 2 (switchable)	D-Sub mini 15 pin × 2 (switchable)
Active Display Size	279.5 mm × 209.6 mm	304.1 mm × 228.1 mm
Viewable Image Size	Diagonal: 349 mm	Diagonal: 380 mm
Recommended Resolution	1024 dots × 768 lines	1024 dots × 768 lines
Plug & Play ¹	VESA DDC 1/2B	VESA DDC 1/2B
Screen Control	ScreenManager™, One Touch Auto Adjustment Function	ScreenManager™, One Touch Auto Adjustment Function
Power Management	VESA DPMS and Swedish NUTEK compliant	VESA DPMS and Swedish NUTEK compliant
Power Consumption	30 W (Typical, Normal Operation)	30 W (Typical, Normal Operation)
Power Save Mode 1	Less than 15 W	Less than 15 W
Mode 2(Off)	Less than 5 W	Less than 5 W
Dimensions	360 mm (W) × 376 mm (H) × 164 mm (D)	397 mm (W) × 397.5 mm (H) × 174.7 mm (D)
Net Weight	5.5 kg	5.5 kg
Safety Standards	TÜV Rheinland/GS, CB, CE Mark	TÜV Rheinland/GS, CB, CE Mark
Ergonomic/Environmental Standards ²	TÜV Rheinland/Ergonomie Geprüft (including ISO 9241-3, ISO 9241-8 and MPR-II), EPA Energy Star Program, TCO 95	TÜV Rheinland/Ergonomie Geprüft (including ISO 9241-3, ISO 9241-8 and MPR-II), EPA Energy Star Program, TCO 95

Dimensions (mm)

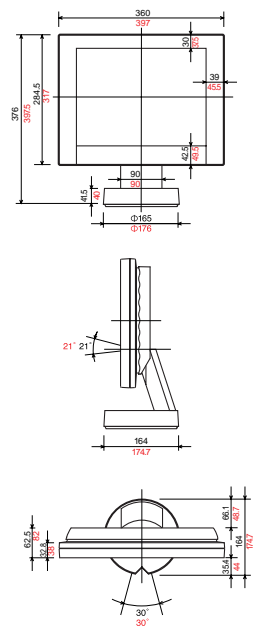

Compatibility with Resolution Standards³

Resolution	Standards	Dot Clock (MHz)	Horizontal Scanning Frequency (kHz)	Vertical Scanning Frequency (Hz)	Full Screen Mode Support	Magnified to Full Screen Mode ⁴	L23	L34
VGA	640×480	25.2	31.5	60	○	×1.5	●	●
VESA	640×480	31.5	37.9	72	○	×1.5	●	●
VESA	640×480	31.5	37.5	75	○	×1.5	●	●
VESA	640×480	36.0	43.3	85	○	×1.5	●	●
VGA	720×400	28.3	31.5	70	○	×1.25	●	●
VESA	800×600	36.0	35.2	56	○	×1.25	●	●
VESA	800×600	40.0	37.9	60	○	×1.25	●	●
VESA	800×600	50.0	48.1	72	○	×1.25	●	●
VESA	800×600	49.5	46.9	75	○	×1.25	●	●
VESA	1024×768	65.0	48.4	60	○	×1	●	●
VESA	1024×768	75.0	56.5	70	○	×1	●	●
VESA	1024×768	78.8	60.0	75	○	×1	●	●
MAC 13" mode	640×480	30.2	35.0	67	—	×1.5	●	●
MAC 16" mode	832×624	57.3	49.7	75	○	—	●	●
MAC	1024×768	65.0	48.4	60	○	×1	●	●
MAC 19" mode	1024×768	80.0	60.0	75	○	×1	●	●

1 Only valid when computer system supports all Plug & Play functions (personal computer, graphics board, Windows 95). For more details, please refer to the Windows 95, personal computer, and graphics board manuals or contact the manufacturers.

2 Some of the Ergonomic/Environmental Standards are now under application.

3 Other resolution standards can be displayed besides those listed in the table above. Some adjustment by the user may be necessary even for the supported resolution standards printed above.

4 The rate by which the resolution must be magnified to achieve a full screen display.

● Liquid crystal panels are made from technology which utilizes extremely high density. Please be aware that there may be missing or illuminating pixels.



EIZO CORPORATION

655 Fukudome, Matto, Ishikawa 924 Japan

Phone : +81 76 277-3310 Fax : +81 76 277-3450

http://www.eizo.co.jp/

Specifications are subject to change without notice.

All product names are trademarks of their respective companies. ErgoCoat, ScreenManager, PowerManager, QuickSet and i-Sound are trademarks, and FlexScan and EIZO are registered trademarks of EIZO CORPORATION.

Chlorine-free

Download from www.Somanuals.com. All Manuals Search And Download.

(970904) Printed in Japan, 9, 1997, 10K

Free Manuals Download Website

<http://myh66.com>

<http://usermanuals.us>

<http://www.somanuals.com>

<http://www.4manuals.cc>

<http://www.manual-lib.com>

<http://www.404manual.com>

<http://www.luxmanual.com>

<http://aubethermostatmanual.com>

Golf course search by state

<http://golfingnear.com>

Email search by domain

<http://emailbydomain.com>

Auto manuals search

<http://auto.somanuals.com>

TV manuals search

<http://tv.somanuals.com>