



FlexScan® L661

46 cm (18.1 inch) TFT LCD Monitor



FlexScan® L661

The L661 blends a sleek, ergonomic look with a feature rich design ideal for financial, banking, office, and medical environments. Utilizing a TFT active matrix panel with scaling and smoothing functions, the L661 offers distortion-free images across its generous 18.1 inch screen.

46 cm (18.1 inch) TFT LCD Monitor

Basic Specifications

The L661 supports a recommended resolution of 1280 × 1024 and a dot pitch of 0.280 mm for detailed display of text and graphics. D³ [D-cubed], EIZO's own ASIC (Application Specific Integrated Circuit), brings high brightness and high contrast, interpolation and signal input control, and distortion free images to the L661.

Expanded and Full Screen Modes

The L661 includes a scaling function so that resolutions lower than the monitor's recommended resolution can now be automatically scaled to an expanded mode to fill most of the screen (4:3 horizontal-vertical ratio) or to a full screen mode (5:4 ratio).

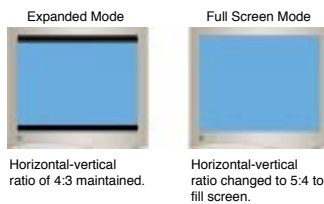

Smoothing Function

Once an image has been scaled, the L661 employs a smoothing function to maximize picture quality. This function allows for adjustment in five gradations from soft to sharp. Softening the image is ideal for removing jagged edges for smooth display of graphics while sharpening it eliminates focus errors for clear representation of text.

Flexible Design

The L661 implements an innovative design to meet the needs of business professionals. The panel can be removed from the base for mounting on an arm or a wall. Dual input connectors allow for the simultaneous connection of two computers to the L661, and toggling between the two is made

simple by pressing a button located on the monitor's front bezel.

Ergonomics and the Environment

EIZO provides a comfortable viewing environment with an ergonomic design that reduces eye fatigue. The L661 meets the most stringent ergonomic standards in the world such as TCO'99 and TÜV Rheinland/Ergonomie Geprüft, and has also obtained the CE Mark.



i-Sound™ Sound Unit

EIZO adds to the user friendliness of the L661 by offering the *i-Sound*, a separately sold speaker unit which attaches seamlessly to the bezel of the L661 without adding to the footprint. The *i-Sound* is equipped with two speakers, two stereo mini-jack cables, and a microphone, all powered directly from the monitor.

Advanced Functions

- Auto contrast level function to automatically adjust the input signal for proper display of color gradations.
- Auto adjustment button to center the displayed image, adjust the clock and phase level, and eliminate the need for preset timings.
- A slot to support Kensington's MicroSaver® security system is included on the panel.
- USB hub with one upstream port and four downstream ports.
- Power unit located inside the panel to eliminate the bulky, space consuming external power units characteristic of many LCDs.
- PowerManager™ and off timer functions to reduce energy consumption to under 3 watts during periods of inactivity.



FlexScan® L661 Specifications

Panel Size	46 cm (18.1 inch)
	TFT Color LCD Panel
Pixel Pitch	0.280 mm × 0.280 mm
Display Colors	16.7 million colors
Viewing Angle	Horizontal: 140 degrees Vertical: 140 degrees
Scanning Frequency	H: 27 - 82 kHz, V: 50 - 85 Hz (Up to 75 Hz at 1280 × 1024)
Brightness	200 cd/m ²
Contrast Ratio	300:1 (typical)
Input Signals	RGB Analog
Input Terminals	D-Sub mini 15 pin × 2 (switchable)
Active Display Size	359 mm × 287 mm
Viewable Image Size	Diagonal: 459 mm
Recommended Resolution	1280 dots × 1024 lines
Plug & Play ¹	VESA DDC 1/2B
Screen Control	ScreenManager® & One Touch Auto Adjustment Function
Power Management System	VESA DPMS, EIZO MPMS ²
Power Consumption	47 W (typical)
Power Save Mode	Less than 3 W
Dimensions	430 mm (W) × 455 mm (H) × 218 mm (D) (with base) 430 mm (W) × 375 mm (H) × 87 mm (D) (panel only)
Net Weight	8.8 kg (with base) 7.2 kg (panel only)
Safety Standards	TÜV Rheinland/GS, CB, CE Mark
Ergonomic/Environmental Standards	TÜV Rheinland/Ergonomie Geprüft (including ISO 9241-3, -7 [Positive/Class I, Negative/Class I], and -8 and MPR-II), EPA ENERGY STAR® Program, Energy 2000, TCO'99
USB Standard ³	USB Standard Rev. 1.1
USB Ports	1 upstream port (for computer or another hub), 4 downstream ports (for peripherals)

¹ Only valid when computer system supports all Plug & Play functions (personal computer, graphics board, Windows® 95/98/2000). For more details, please refer to the Windows 95/98/2000, personal computer, and graphics board manuals or contact the manufacturers.

² EIZO MPMS is a power management system developed by EIZO to replace Swedish NUTEK which was discontinued at the end of 1997.

³ Not all computers, operating systems, or peripherals may be compatible with the USB interface.

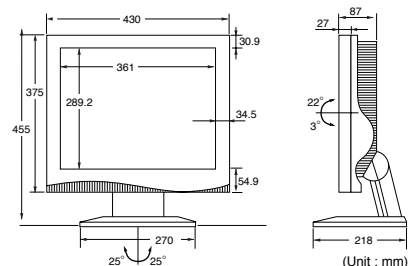

Specifications are subject to change without notice.

ENERGY STAR® is a U.S. registered mark. As an ENERGY STAR® Partner, Eizo Nanao Corporation has determined that this product meets the ENERGY STAR® guidelines for energy efficiency. Copyright © 1999 Eizo Nanao Corporation. All rights reserved. All product names are trademarks of their respective companies. PowerManager, and i-Sound are trademarks, and FlexScan, EIZO, and ScreenManager are registered trademarks of Eizo Nanao Corporation.



EIZO NANAO CORPORATION

655 Fukudome, Matto, Ishikawa 924-8533 Japan

Phone : +81 76 277-3310 Fax : +81 76 277-3450

http://www.eizo.co.jp/

Download from Wwww.Somanuals.com. All Manuals Search And Download.

Free Manuals Download Website

<http://myh66.com>

<http://usermanuals.us>

<http://www.somanuals.com>

<http://www.4manuals.cc>

<http://www.manual-lib.com>

<http://www.404manual.com>

<http://www.luxmanual.com>

<http://aubethermostatmanual.com>

Golf course search by state

<http://golfingnear.com>

Email search by domain

<http://emailbydomain.com>

Auto manuals search

<http://auto.somanuals.com>

TV manuals search

<http://tv.somanuals.com>