

GMG[®]

GLOBAL MACHINERY COMPANY

INSTRUCTION MANUAL

Petrol Lawn Edger



2 YEAR
REPLACEMENT
WARRANTY

30 DAY
SATISFACTION
GUARANTEE

• Melbourne • Perth • Auckland • Hong Kong • Shanghai
• Taipei • New York • Verona • London • Paris

PEDG
050603 ED10 JJ

Contents

Warranty	2
Introduction	3
Description of symbols	3
Specifications	4
Safety instructions	4
Additional safety rules for edgers	5
Contents of carton	6
Unpacking	6
Know your product	7
Assembly	8
Fueling	8
Starting the edger	9
Stopping the edger	9
Running in the engine	9
Cutting depth	9
Edge guide	10
Edging	10
Landscaping / trenching	11
Changing the blade	11
Maintenance	11
Storage and maintenance after use	12
Problems	12

Full 2 Years Home Use Warranty

Whilst every effort is made to ensure your complete satisfaction with this tool, occasionally, due to the mass manufacturing techniques, a tool may not live up to our required level of performance and you may need the assistance of our service department.

This product is warranted for a 2-year period for home domestic use from the date of the original purchase. If found to be defective in materials or workmanship, the tool or the offending faulty component will be replaced free of charge with another of the same item. A small freight charge may apply.

The warranty replacement unit is only made available by returning the tool to the place of purchase with a confirmed register receipt. Proof of purchase is essential. We reserve the right to reject any claim where the purchase cannot be verified.

This warranty does not include damage or defects to the tool caused by or resulting from abuse, accidents, alterations or commercial or business use.

It also does not cover any bonus accessories unless the tool is a GMC Platinum Professional model.

Please ensure that you store your receipt in a safe place.

Conditions apply to the above warranty.

If you need direction of what constitutes a free of charge warranty claim, please review the guide given on the rear of the Receipt Holder. An indication is given as to the types of claim that are permissible, and those that are not.



Dear Customer

If you require any help with your product, whether it is a Warranty claim, spare part or user information, please phone our Help Line for an immediate response. Phone 1300 880 001 in Australia or 0800 445 721 in New Zealand.

Introduction

Your new GMC power tool will more than satisfy your expectations. It has been manufactured under stringent GMC Quality Standards to meet superior performance criteria.

You will find your new tool easy and safe to operate, and, with proper care, it will give you many years of dependable service.

CAUTION. Carefully read through this entire Instruction Manual before using your new GMC Power Tool. Take special care to heed the Cautions and Warnings.

Your GMC power tool has many features that will make your job faster and easier. Safety, performance, and dependability have been given top priority in the development of this tool, making it easy to maintain and operate.

Environmental protection



Recycle unwanted materials instead of disposing of them as waste. All tools, hoses and packaging should be sorted, taken to the local recycling centre and disposed of in an environmentally safe way.

Description of symbols

The rating plate on your tool may show symbols. These represent important information about the product or instructions on its use.



Wear hearing protection.

Wear eye protection.

Wear breathing protection.



N380

Conforms to relevant standards for electromagnetic compatibility.



Warning.



Read these instructions for use carefully.



Choke control

Start position (choke closed).



Run position (choke open).



Use at a distance of at least 15m from other people.



Thrown objects and rotating line can cause severe injury.



Warning. Do not put hands or feet under the cover of the machine when it is running.



Warning. Rotating blades.



Explosive material.



Extremely hot surface. Do not touch a hot muffler, gear box or cylinder, you may get burned. These parts get extremely hot from operation and remain hot for a short time after the unit is turned off.

Specifications

Engine:	26cc, 2 Stroke
Speed:	0 - 2200min ⁻¹
Depth of cut:	10mm, 20mm, 30mm
Size of blade:	180mm
Bore size:	18mm
fuel type:	Unleaded
Fuel mixture:	Unleaded petrol / oil (40:1)
Fuel tank capacity:	700ml
Equivalent Spark plugs:	NGK BM4A CHAMPION CJ14 DENSO W14M-U10 BOSCH WS8E
Sound pressure value:	119db(A)
Weight:	7.5kg

Safety instructions

WARNING. Read and understand all instructions. Failure to follow all instructions listed below may result in electric shock, fire and/or serious injury. The term "power tool" in all of the warnings below refers to your mains-operated (corded) power tool or battery-operated (cordless) power tool.

Save these instructions

Work area

- **Keep work area clean and well lit.** Cluttered and dark areas invite accidents.
- **Do not operate power tools in explosive atmospheres, such as in the presence of flammable liquids, gases, or dust.** Power tools create sparks which may ignite the dust or fumes.
- **Keep children and bystanders away while operating a power tool.** Distractions can cause you to lose control.

Personal safety

- **Stay alert, watch what you are doing and use common sense when operating a power tool.** Do not use a power tool while you are tired or under the influence of drugs, alcohol, or medication. A moment of inattention while operating power tools may result in serious personal injury.
- **Use safety equipment.** Always wear eye protection. Safety equipment such as a dust mask, non-skid safety shoes, hard hat, or hearing protection used for appropriate conditions will reduce personal injuries.
- **Remove any adjusting key or wrench before turning the tool on.** A wrench or a key that is left attached to a rotating part of the power tool may result in personal injury.
- **Do not overreach.** Keep proper footing and balance at all times. This enables better control of the power tool in unexpected situations.
- **Dress properly.** Do not wear loose clothing or jewellery. Keep your hair, clothing and gloves away from moving parts. Loose clothes, jewellery or long hair can be caught in moving parts.
- **If devices are provided for the connection of dust extraction and collection facilities ensure that these are connected and properly used.** Use of these devices can reduce dust-related hazards.

Power tool use and care

- **Do not force the power tool.** Use the correct power tool for your application. The correct power tool will do the job better and safer at the rate for which it was designed.
- **Do not use the power tool if the switch does not turn it on and off.** Any power tool that cannot be controlled with the switch is dangerous and must be repaired.

- **Ensure the tool is switched off completely before making any adjustments, changing accessories, or storing power tools.** Such preventive safety measures reduce the risk of starting the power tool accidentally.
- **Store idle power tools out of the reach of children and do not allow persons unfamiliar with the power tool or these instructions to operate the power tool.** Power tools are dangerous in the hands of untrained users.
- **Maintain power tools.** Check for misalignment or binding of moving parts, breakage of parts and any other condition that may affect the power tool's operation. If damaged, have the power tool repaired before use. Many accidents are caused by poorly maintained power tools.
- **Keep cutting tools sharp and clean.** Properly maintained cutting tools with sharp cutting edges are less likely to bind and are easier to control.
- **Use the power tool, accessories and tool bits etc., in accordance with these instructions and in the manner intended for the particular type of power tool, taking into account the working conditions and the work to be performed.** Use of the power tool for operations different from intended could result in a hazardous situation.
- **Blade fracture.**
- **Catapulting of blade pieces.**
- **Damage to hearing if effective earmuffs are not worn.**
- **Do not use blades that are deformed or cracked.**
- **Do not operate in a hazardous location.** Such areas include where there is a risk of explosion of petrol fumes, leaking gas or explosive dust.
- **Do not operate in a confined area.** Exhaust gases, smoke or fumes could reach dangerous concentrations.
- **Protect your tool.** This edger is NOT WEATHERPROOF and should not be exposed to direct sunlight, high ambient temperature and damp, wet or high humidity conditions.
- **Do not smoke while refuelling.** This is potentially dangerous as it may ignite the fuel and cause an explosion.
- **Take care not to spill fuel.** When refuelling the edger ensure that the motor has been switched off. Prevent the spilling of fuel as this may also ignite with the hot motor. Never refuel whilst the engine running.
- **Be careful where you store the edger.** Store the edger in a dry area away from flammable liquids.
- **Keep your distance.** The edger emits exhaust fumes. Ensure bystanders keep a safe distance.

Service

- **Have your power tool serviced by a qualified repair personnel using only identical replacement parts.** This will ensure that the safety of the power tool is maintained.

Additional safety rules for edgers

Even when the tool is used as prescribed it is not possible to eliminate all residual risk factors. The following hazards may arise in connection with the tool's construction and design:

- **Contact with the blade.**
- **Kickback of the edger due to hidden solid objects.**
- **Never fill fuel tank indoors.** Never fill fuel tank when engine is running or hot. Do not smoke when filling fuel tank.
- **When making any adjustments to the tool always wait for the blade to come to a complete stop and turn off the tool.**
- **Never attempt to unclog the blade chamber by tapping the tool on the ground, this can damage the unit.**

- *Keep hands clear of edge guide and blade when cleaning as these wear to a very sharp point during edging.*
- *Before landscaping or trenching, inspect and ensure there are no exposed or buried cables or pipes or other objects that may create a hazard or interfere with operating the edger.*
- *Set depth to only that required for the job, do not overload. If tool slows, pull back slightly and wait until blade returns to normal speed.*
- *Check damaged parts before further use of the appliance, a guard or other part that is damaged should be carefully checked to determine that it will operate properly and perform it's intended function. Check for alignment of moving parts, binding of moving parts, mounting, and any other conditions that may affect it's operation.*
- *Ensure guards are kept in place.*
- *Always keep blade area clean.*
- *When using the edger, stones, pieces of metal and other objects can be thrown out at high speed by the blade. The tool and guard are designed to reduce the danger. However, the following special precautions should be taken:*
 - *Wear safety glasses or other eye protection, gloves, long pants and suitable footwear.*
 - *Make sure that other people and pets are at least 5 metres away.*
 - *Always stand to left side of main handle.*
 - *Before landscaping or Trenching, check for buried electrical cables.*
 - *To reduce the risk of injury, work going away from nearby solid objects such as walls, steps, stones, trees etc. Use great care when working close to solid objects, and where necessary, do edging or trimming by hand.*

- *Use only blades as recommended.*
- *Do not attempt to free a jammed blade before first switching off the machine.*
- *Let the blade come to rest naturally.*
- *Periodically check that all fixings are properly tightened.*

Contents of carton

The GMC edger is supplied with the following accessories as standard:

- *Blade spanner*
- *Large flange spanner*
- *Spark plug wrench*
- *Auxiliary handle*
- *Auxiliary handle locking knob*
- *Shaft height adjustment knob*
- *This instruction manual*

Unpacking

Due to modern mass production techniques, it is unlikely that your GMC Power Tool is faulty or that a part is missing. If you find anything wrong, do not operate the tool until the parts have been replaced or the fault has been rectified. Failure to do so could result in serious personal injury.

Know your product

1. Lock off button
2. Throttle trigger
3. Ignition switch
4. Auxiliary handle
5. Shaft
6. Edger guide lever
7. Wheel
8. Auxiliary handle lock knob
9. Height adjustment knob
10. Guide wheel
11. Blade cut indicator
12. Fuel tank
13. Recoil starter
14. Primer bulb
15. Spark plug
16. Air filter cover
17. Choke lever
18. Shaft height adjustment knob
19. Air filter cover locking knob



Assembly

Inserting the shaft

Remove the nut from the hole in the base of the edger and insert the shaft. Replace the nut and retighten it.

Telescope handle adjustment

The shaft handle can be set at three different heights.

To set the height for your comfort, slide the tube up to the level required using one of the three holes provided and insert the coach screw. Tighten the shaft height assembly adjustment knob (18).



Attaching the auxiliary handle

To attach the auxiliary handle fit it onto the slot on the main handle.

Adjust it to the most comfortable position and insert the auxiliary handle locking knob (8), securing it firmly.



Fueling

MOTOR FUEL: MIX AT 40:1 ONLY

1. Use fresh unleaded petrol. You must use 100% synthetic oil specifically made for heavily stressed two-stroke engines.
2. Mix the petrol and oil in an approved container. Never mix fuel in the edger.
3. Place the edger upright on the ground or on a sturdy bench and wipe any debris from around the fuel cap.

4. Unscrew the fuel tank cap and pour the mixture into the tank.



5. Be careful not to spill any mixture. If this happens, wipe the spill with a clean rag.
 6. Start the engine at least three metres away from the area where the fuel tank has been filled up in order to avoid any risk of fire.
- Danger of fire and burn injury.
 - Always use extreme care when handling fuel! Fuel is highly flammable.
 - Never attempt to fuel the edger if the fuel system components are damaged or are leaking.
 - Never attempt the refuel the engine while it is running or still warm, allow it to cool before fueling.
 - Never smoke or light any fires near the edger or fuels.
 - Always transport and store fuels in an approved container.
 - Never place flammable material close the the engine muffler.
 - Do not use petrol which contains ethanol or methanol as it may damage the fuel lines and other engine parts.
 - Mix only enough fuel for your immediate needs. If fuel must be stored longer than 30 days, it should first be treated with a stabilizer or similar product.

Starting the edger

Choke control

 Start position (choke closed).

 Run position (choke open).

To start the engine, proceed as follows:

1. Move the ignition switch (3) to the on position marked with an **I**.

2. Press the primer bulb (14) 6 times until there are no air bubbles visible in the fuel discharge line.

Note. This is not necessary if the engine is warm.

3. Push the choke lever (17) up to the start position (the choke is now closed).

Note. Again this is not necessary if the engine is warm.

4. Pull the recoil starter (13) until the engine sounds like it wants to run.

5. Push the choke down to the run position.

6. Pull the recoil starter rapidly until the engine starts.

7. Allow the engine to run for 10 seconds to let it warm up.

8. To increase the engine speed depress the Lock Off button (1) on the side of the handle and squeeze the throttle trigger (2).

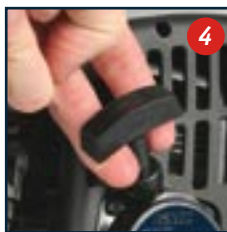
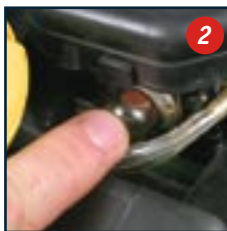

Stopping the edger

Stop the engine by pressing the off button (3) to the off position marked **O**.



Running in the engine

1. During the first ten hours of work, run the engine at a moderate RPM.

2. We advise you in any case not to maintain your engine at a high speed as the different components must settle with each other during the process of running in the engine.

3. It is at the end of the running in period that the engine will reach its maximum power.

4. After the first two hours of work, stop and make sure that all nuts and screws are securely fastened, and tighten them if necessary.

Cutting depth

The cutting depth of the edger can be altered to one of 3 settings 10mm, 20mm and 30mm.

1. To adjust the cutting depth, loosen the Height adjustment knob approx 5-6 full turns, but do not remove.

2. Push the knob fully towards the body of the edger and at the same time move the front wheel arm across to the opposite side of the housing.

3. Raise or lower the arm to the desired position, and then pull the height adjusting knob

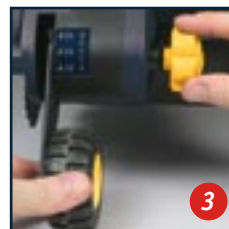
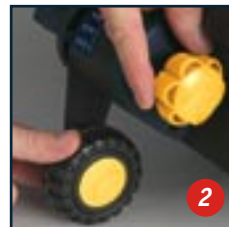

outwards. Rotate the knob in a clockwise direction until all of the slack is taken out of assembly.

4. Check to ensure the front wheel arm has located into one of the pre allocated positions and the head of the bolt securing the front wheel arm is sitting flat on the surface of the wheel arm. Firmly tighten the height adjustment knob.

Edge guide

The edge guide is used when edging is required against a solid material like a paved surface. It is important to ensure the edge guide is used in these conditions as the edge guide will assist in preventing the blade from making direct contact with the paved surface.

To use the edge guide, hold the edge guide control knob (6) and move the knob sideways toward the centre of the edger and then push downwards, ensuring that the guide fits into the allocated slot.

The edge guide control knob should be returned to the upright position to lock the guide in the down position.

To release the edge guide, hold the edge guide control knob and move the knob sideways toward the centre of the edger and then pull upwards to lift the guide.



Edging

1. Before edging check the area and remove all obstacles and objects that could be thrown.
2. Set the cut depth at 20mm and set edge guide to the down position. Blade depth may have to be adjusted to differences in height between hard surfaces and the top of the grass.

3. The guard is fitted with a raised rib section which acts as a blade cut indicator (11). This rib will assist in guiding the operator where the blade will cut. During operation the operator can sight down the rib of the guard to where the edge is to be cut.

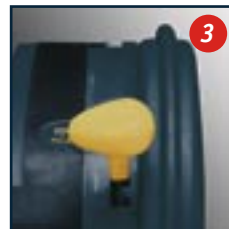

4. Before starting the edger, line up the tool so the edge guide rests against the edge of the paved surface, both rear wheels should be on the paved surface when edging.

Hint: When there is heavy overgrowth of grass over the paved surface it may drag on the guard. An initial cut may be required with the edger on the grass side. This will require lifting up the edger guide and may require reducing the depth of cut.

5. To avoid kickback of edger, tilt the handle down so the blade is above the ground.
6. When starting to edge, run the engine at full throttle and lower the blade gently into the ground, being careful not to hit concrete with the blade.



7. Slowly lift the handle to lower the blade, finding the edge of the paved surface and start edging. Then move tool forward slowly along edge of paved surface, keeping the edge guide pressed lightly against the pavement edge.

For the first edging each season, it's best to move forward slowly because grass is thickest then. Subsequent edging will be completed more rapidly. If the tool slows down, back it up slightly until the blade returns to normal speed. During edging some sparks may be generated from hitting stones, this is normal.

Warning. The unit may become very hot during use. Avoid contact during and immediately after operation.

Landscaping / trenching

Before landscaping or trenching, inspect and ensure there are no exposed or buried cables or pipes or other objects that may create a hazard or interfere with operating the edger. Lift the edge guide lever (6) for all trenching. Set depth to only that required for the job, do not overload, if tool slows, pull back slightly and wait until the blade returns to normal speed.

Changing the Blade

Position the edger on its side with the Blade uppermost. Ensure the surface you are working on is clean and foreign particles (stones etc) cannot enter the air intake slots of the motor housing.

Place the large flange spanner over the outer blade flange.

Fit the blade spanner over the blade lock nut and while holding firmly the spanner on the blade flange, rotate the locking nut in an anti-clockwise direction.

Remove the lock nut completely along with the outer flange and blade.

There is no need to remove the inner flange although on re assembly the area of the inner flange must be free of foreign particles of dirt etc.

To re assemble with the a new blade fit the inner flange on to the spindle, fit the replacement blade and secure the outer flange on to the spindle and blade.

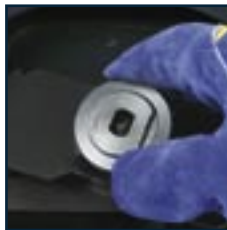

Ensure the assembly is correct and the blade is correctly orientated by checking the diagram below.

With the spanner fitted to the outer flange, fit the locking nut and tighten with the blade spanner in a clockwise direction.

After the blade is secure, rotate the blade by hand to ensure the blade is not making contact with any components of the edger.

Blade wear is expected whenever you use your edger. Blades wear quite quickly when edging along concrete paths. This does not effect the efficiency of the edger and is expected due to the aggressive abrasion of concrete on steel.

Edger blades are not a warranty item! Edger blades are available from your local Hardware store.

Maintenance

WARNING. The engine of the petrol edger must be at a complete stop during assembling, repair and cleaning operations that could be necessary.

Air filter

Accumulated dust in the air filter will reduce engine efficiency. Increase fuel consumption and allow abrasive particles to pass into the engine. Remove the air filter as often as necessary to maintain a clean condition.



- Remove air filter cover (16) by turning the air filter locking knob (19) anti-clockwise and removing the cover as you do carefully remove the Air intake tube so that you can access the filter.

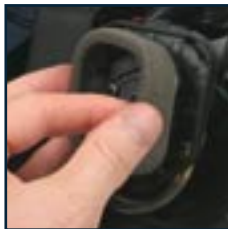

- Light surface dust can readily be removed by tapping the filter.
- Heavy deposits should be washed out in suitable detergent and the filter dried fully before re-installing.

Checking the spark plug

Check the spark plug every 10-15 hours of use.

1. Remove the spark plug cover.
2. Use the spark plug wrench to remove the spark plug, by turning it anti clockwise.

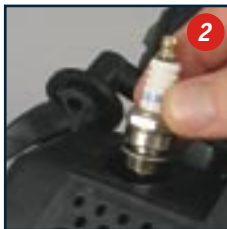

3. Clean and adjust the spark plug gap to 0.6 - 0.7mm. Replace any damaged or visibly worn plug with a worn plug with an equivalent spark plug, including NGK BM4A, CHAMPION CJ14, DENSO W14M-U10, BOSCH WS8E.



4. Install the spark plug finger tight in the cylinder head, then tighten it firmly with the spark plug wrench.

Servicing

- It is recommended once you first use your petrol edger to get it serviced after 15 hours of use.
- From thereafter, service the petrol edger every 2 years.

Storage and maintenance after use

- When you finish working, clean the petrol edger completely, making sure there is no grass or dirt wrapped in the cutting tools, and put it back into its package in order to avoid its hurting you or other people during transport.
- Be aware to not hit or cut the fuel tank if you put it onto the ground.
- Store the petrol edger away from direct sunlight.
- Do not store in a nylon bag as this can encourage the formation of mould.
- At the end of the season, give the petrol edger an overall cleaning and a thorough check.

Whenever the machine is not used for a long period of time, proceed as follows:

- Empty the fuel tank completely.
- Protect all metal engine parts from corrosion by coating them with oil.
- Remove the spark plug, put a few drops of oil into the cylinder and then pull the recoil starter 2 to 3 times in order to distribute the oil evenly. Replace the spark plug.

Problems

Power loss or sudden stopping of the engine

- Check whether the fuel tank is empty.
- The mixture does not reach the carburettor. Clean the fuel filter in the fuel tank.
- There is water in the mixture. Drain and rinse all the fuel system.
- The air filter is dirty. Clean the air filter.
- There are carbon deposits in the cylinder exhaust pipe or the muffler. Clean those or change the muffler.

Bad quality cut

- Overloaded cutting due to grass too thick for engine power.
- Wrapped vegetal material on the cutting tool.

Carefully read the entire Instruction Manual before using this product.

**Before returning this product for a
Warranty Claim or any other reason
Please Call 1300 880 001 (Australia)
or 0800 445 721 (New Zealand)**

**When you make your call, please have
the following information at hand:**

- **GMC Product Type**
- **GMC Product Code**

A GMC Service Engineer will take your call and, in most cases, will be able to solve your problem over the phone.

You are welcome to use this phone-in service to make suggestions or give comments about any GMC product.

With continuing product development changes may have occurred which render the product received slightly different to that shown in this instruction manual. The manufacturer reserves the right to change specifications without notice. Note: Specifications may differ from country to country.



The GMC 777 Helpline operates from 7am to 7pm, 7 days a week (EST). This allows you to contact GMC directly with any queries and technical questions you have regarding our products.

GMC
GLOBAL MACHINERY COMPANY

45-55 South Centre Road
Melbourne Airport
Victoria, Australia 3045
Tel: (03) 8346 1100 Fax: (03) 8346 1200



Save this Manual for future reference.

Free Manuals Download Website

<http://myh66.com>

<http://usermanuals.us>

<http://www.somanuals.com>

<http://www.4manuals.cc>

<http://www.manual-lib.com>

<http://www.404manual.com>

<http://www.luxmanual.com>

<http://aubethermostatmanual.com>

Golf course search by state

<http://golfingnear.com>

Email search by domain

<http://emailbydomain.com>

Auto manuals search

<http://auto.somanuals.com>

TV manuals search

<http://tv.somanuals.com>