

# **GMC**<sup>®</sup>

**GLOBAL MACHINERY COMPANY**

**INSTRUCTION MANUAL**

**245mm**

**Band  
Saw**



**2** YEAR  
REPLACEMENT  
WARRANTY

**30** DAY  
SATISFACTION  
GUARANTEE

• Melbourne • Perth • Auckland • Hong Kong • Shanghai  
• Taipei • New York • Verona • London • Paris

Download from [www.somanuals.com](http://www.somanuals.com). All Manuals Search And Download.

**RBS10**  
MAN RBS10 10/01

# Contents

<b>Warranty</b>	<b>2</b>
<b>Introduction</b>	<b>3</b>
<b>Specifications</b>	<b>3</b>
<b>Safety instructions</b>	<b>3</b>
<b>Additional safety rules for saws</b>	<b>5</b>
<b>Unpacking</b>	<b>6</b>
<b>Assembly</b>	<b>6</b>
<b>Know your product</b>	<b>7</b>
<b>Setting up</b>	<b>8</b>
<b>Operation</b>	<b>10</b>
<b>Maintenance</b>	<b>10</b>

## **Full 2 Years Home Use Warranty**

*Whilst every effort is made to ensure your complete satisfaction with this tool, occasionally, due to the mass manufacturing techniques, a tool may not live up to our required level of performance and you may need the assistance of our service department.*

*This product is warranted for a 2-year period for home domestic use from the date of the original purchase. If found to be defective in materials or workmanship, the tool or the offending faulty component will be replaced free of charge with another of the same item. A small freight charge may apply.*

*The warranty replacement unit is only made available by returning the tool to the place of purchase with a confirmed register receipt. Proof of purchase is essential. We reserve the right to reject any claim where the purchase cannot be verified.*

*This warranty does not include damage or defects to the tool caused by or resulting from abuse, accidents, alterations or commercial or business use.*

*It also does not cover any bonus accessories unless the tool is a GMC Platinum Professional model.*

*Please ensure that you store your receipt in a safe place. Conditions apply to the above warranty.*

*If you need direction of what constitutes a free of charge warranty claim, please review the guide given on the rear of the Receipt Holder. An indication is given as to the types of claim that are permissible, and those that are not.*



## Dear Customer

If you require any help with your product, whether it is a Warranty claim, spare part or user information, please phone our Help Line for an immediate response. Phone 1300 880 001 in Australia or 0800 445 721 in New Zealand.

## Introduction

Your new GMC power tool will more than satisfy your expectations. It has been manufactured under stringent GMC Quality Standards to meet superior performance criteria.

You will find your new tool easy and safe to operate, and, with proper care, it will give you many years of dependable service.

**Caution.** Carefully read through this entire Instruction Manual before using your new GMC Power Tool. Take special care to heed the Cautions and Warnings.

Your GMC power tool has many features that will make your job faster and easier. Safety, performance, and dependability have been given top priority in the development of this tool, making it easy to maintain and operate.

## Environmental protection



Recycle unwanted materials instead of disposing of them as waste. All tools, hoses and packaging should be sorted, taken to the local recycling centre and disposed of in an environmentally safe way.

## Specifications

Nominal voltage:	230 – 240 Vac~ 50 Hz
Wattage:	370W
Band speed:	700m/min
Dimensions:	860 mm x 420 mm x 530 mm
Working table:	340 mm x 335 mm (adjustable between 0 - 45°)
Table height from floor:	370 mm
Width of throat:	245 mm
Max.cutting height:	100 mm
Saw blade length:	1,712 mm
Saw blade width:	10 mm (3 to 12.7mm)
Gross weight:	35kg

## Safety instructions

To use this tool properly, you must observe the safety regulations, the assembly instructions and the operating instructions to be found in this Manual. All persons who use and service the machine have to be acquainted with this Manual and must be informed about its potential hazards. Children and infirm people must not use this tool. Children should be supervised at all times if they are in the area in which the tool is being used. It is also imperative that you observe the accident prevention regulations in force in your area. The same applies for general rules of occupational health and safety.

**WARNING.** When using power tools, basic safety precautions should always be taken to reduce the risk of fire, electric shock and personal injury. Also, please read and heed the advice given in the additional important safety instructions.

1. Keep the work area clean and tidy. Cluttered work areas and benches invite accidents and injury.

2. Consider the environment in which you are working. Do not use power tools in damp or wet locations. Keep the work area well lit. Do not expose power tools to rain and high humidity. Do not use power tools in the presence of flammable liquids or gases.
3. Keep visitors away from the work area. All visitors and onlookers, especially children and infirm persons should be kept well away from where you are working. Do not let others in the vicinity make contact with the tool or extension cord.
4. Store tools safely. When not in use, tools should be stored in a dry, high place or locked up out of the reach of children and infirm persons.
5. Do not force the tool. The tool will do the job better and safer working at the rate for which it was designed.
6. Use the correct tool for the job. Do not force small tools or attachments to do the job best handled by a heavier duty tool. Never use a tool for a purpose other than that for which it was intended.
7. Dress correctly. Do not wear loose clothing or jewelry. They can be caught in moving parts. Rubber gloves and non-slip footwear are recommended when working outdoors. If you have long hair, wear a protective hair covering.
8. Use safety accessories. Safety glasses and earmuffs should always be worn. A face or dust mask is also required.
9. Connect dust extraction equipment. If devices are provided for the connection of dust extraction and collection facilities, ensure that these are connected and properly used.
10. Do not abuse the power cord. Never pull the cord to disconnect the tool from the power point. Keep the cord away from heat, oil and sharp edges.
11. Secure the workpiece. Use clamps or a vice to hold the workpiece. It is safer than using your hand and frees both hands to operate the tool.
12. Do not overreach. Keep your footing secure and balanced at all times.
13. Look after your tools. Keep tools clean and sharp for better and safer performance. Follow the instructions regarding lubrication and accessory changes. Inspect tool cords periodically and, if damaged, have them repaired by an authorised service facility. Inspect extension cords periodically and replace them if damaged. Keep tool handles dry, clean and free from oil and grease.
14. Disconnect idle tools. Switch off the power and disconnect the plug from the power point before servicing, when changing accessories and when the tool is not in use.
15. Remove adjusting keys and wrenches. Form the habit of checking to see that keys and adjusting wrenches are removed from the tool before switching it on.
16. Avoid unintentional starting. Always check that the switch is in the OFF position before plugging in the tool to the power supply. Do not carry a plugged in tool with your finger on the switch.
17. Use outdoor rated extension cords. When a tool is used outdoors, use only extension cords that are intended for outdoor use and are so marked.
18. Stay alert. Watch what you are doing. Use common sense. Do not operate a power tool when you are tired.
19. Check for damaged parts. Before using a tool, check that there are no damaged parts. If a part, such as a guard is damaged, carefully determine if it will operate properly and perform its intended function. Check for alignment of moving parts, binding of moving parts, breakage of parts, proper mounting and any other conditions that may affect the operation of the tool. A guard or other part that is damaged should be properly repaired or replaced by an authorised service facility, unless otherwise indicated in this Instruction Manual. Defective switches must be

replaced by an authorised service facility. Do not use a tool if the switch does not turn the tool on and off correctly.

20. Guard against electric shock. Prevent body contact with grounded objects such as water pipes, radiators, ranges and refrigerator enclosures.
21. Use only approved parts. When servicing, use only identical replacement parts. Use an authorised service facility to fit replacement parts.

**WARNING.** The use of an accessory or attachment, other than those recommended in this Instruction Manual, may present a risk of personal injury.

The tool must be used only for its prescribed purpose. Any use other than those mentioned in this Manual will be considered a case of misuse. The user and not the manufacturer shall be liable for any damage or injury resulting from such cases of misuse.

The manufacturer shall not be liable for any changes made to the tool nor for any damage resulting from such changes.

Even when the tool is used as prescribed it is not possible to eliminate all residual risk factors. The following hazards may arise in connection with the tool's construction and design:

- Damage to the lungs if an effective dust mask is not worn.
- Damage to hearing if effective earmuffs are not worn.
- Contact with the blade
- Kickback of workpiece and parts of workpiece
- Blade fracture
- Harmful emissions of wood dust when the machine is used in closed rooms. Always use supplementary dust extraction
- Do not use blades that are deformed or cracked
- Always remove the plug from the mains socket before making any adjustments or maintenance, including changing the blade.

## **Additional safety rules for saws.**

- Ensure that the lighting is adequate.
- Keep the area free of tripping hazards.
- Do not let anyone under 18 years operate this saw.
- Always stand to one side when operating the saw.
- Never use a cracked or distorted saw blade. Only use sharp blades.
- When cutting round wood, use clamps that prevent the workpiece from turning on the table.
- Never use your hands to remove sawdust, chips or waste close by the saw blade.
- Use only blades as recommended.
- Rags, cloths, cord, string and the like should never be left around the work area.
- Avoid cutting nails. Inspect the workpiece and remove all nails and other foreign objects before beginning sawing.
- Support the work properly.
- Never reach over the blade to remove waste or off cuts.
- Do not attempt to free a jammed blade before first switching off the machine.
- Do not slow or stop a blade with a piece of wood. Let the blade come to rest naturally.
- If you are interrupted when operating the saw, complete the process and switch off before looking up.
- Periodically check that all nuts, bolts and other fixings are properly tightened.
- Do not store materials or equipment above a machine in such a way that they could fall into it.
- Ensure that your work is always on the table. Never attempt to cut anything that is not on the table.

Wear goggles

Wear earmuffs

Wear a breathing mask

## Unpacking

Due to modern mass production techniques, it is unlikely that your GMC Power Tool is faulty or that a part is missing. If you find anything wrong, do not operate the tool until the parts have been replaced or the fault has been rectified. Failure to do so could result in serious personal injury.

## Assembly

The Band Saw is shipped partly disassembled and the saw table and rip fence guide have to be installed prior to use.

1. Remove the rip fence scale from the table.
2. Place the table onto the table trunnion.
3. Fix the table to the trunnion using the 4 hex head bolts and serrated lock washers.
4. Place the table insert into the hole in the centre of the table.
5. Replace the rip fence scale on the table.
6. Adjust the distance between the rip fence guides by raising the rip fence guide handle to unlock it and turning the handle. The distance between the guides needs to be long enough to enable the fence to fit over the table.
7. Position the fence on the table with the guides located in the channels either side of the table.
8. Slide the fence to the desired location and push the rip fence guide handle down to lock the fence in position.
9. If required, assemble the support stand and attach the band saw to this stand.

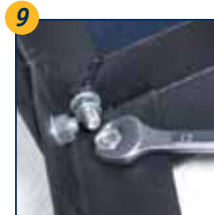
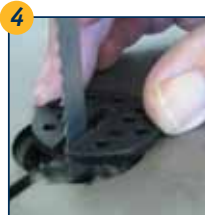
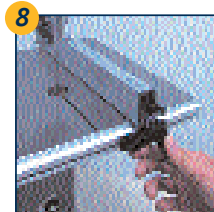
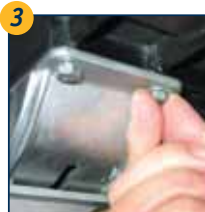
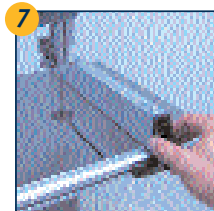
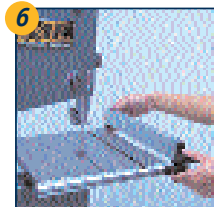

## Know your product

1. Saw blade
2. Upper wheel housing
3. Saw band tensioning knob
4. Lower wheel housing
5. Saw band tensioning knob
6. Motor shaft (not shown)
7. Drive belt (not shown)
8. ON button
9. OFF button
10. Table insert
11. Rip fence
12. Rip fence scale
13. Rip fence guide
14. Rip fence guide handle
15. Table trunnion
16. Table trunnion bracket
17. Table tilt securing knob
18. 90° table tilt adjustable screw stop
19. Dust extraction port
20. Height adjustment knob
21. Blade support head
22. Table
23. Housing lock screws

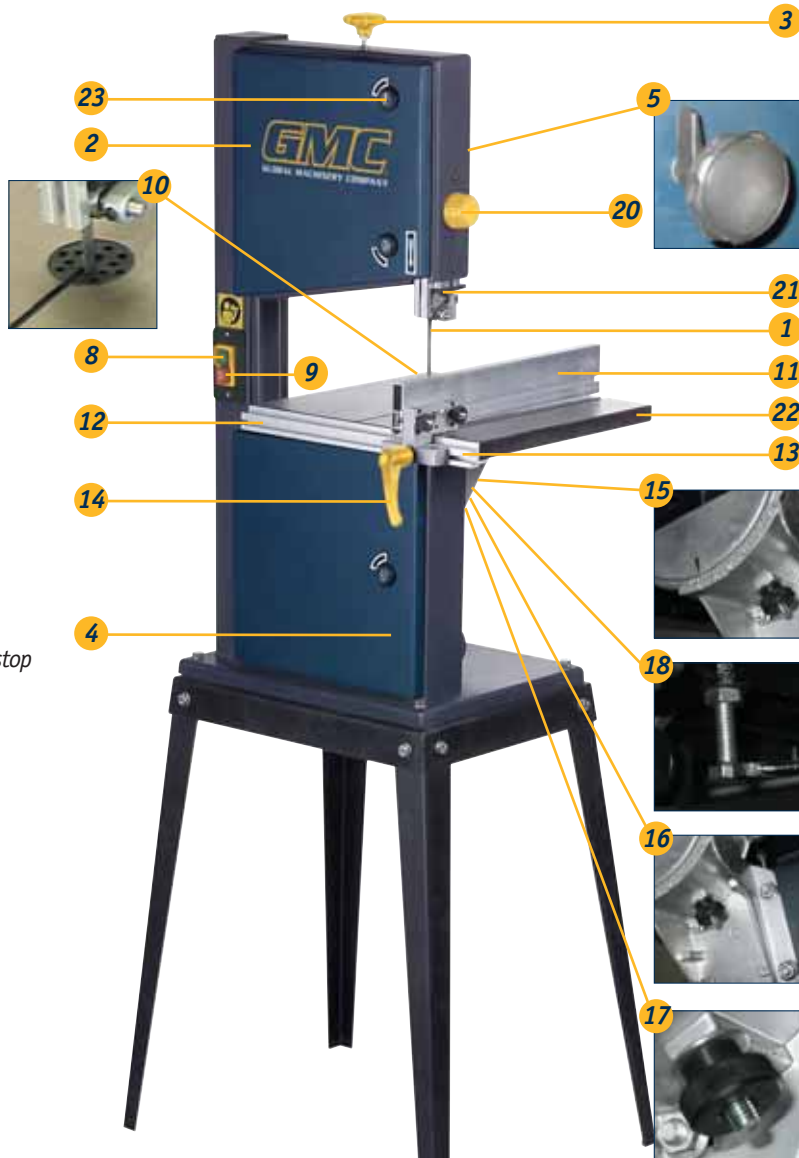

## Setting up

### Centring the table

1. Loosen the screws holding the table trunnion bracket
2. Move the table until the saw blade is positioned in the centre of the table insert
3. Tighten the bracket screws ensuring that the table does not move.



### Setting the table square with the saw blade

1. Loosen the table tilt-securing knob.
2. Adjust the hex headed screw stop on the underside of the table so that the table is at right angles to the saw blade when the screw rests on the lower wheel housing.



### Fixing

1. The Band saw should be stable.
2. Either secure it to the support stand provided or to the floor or to a bench or table.

**Note:** Do not use the saw unless it is firmly fixed and stable.

3. There are four 9 mm fixing holes in the base of the saw.



### Rip fence

The rip fence can be used either side of the blade.

1. Raise the rip fence guide handle to unlock it and turn the handle to increase the distance between the guides so that it can be lifted clear of the table.
2. Position the fence on the other side of the blade with the guides located in the channels either side of the table.
3. Slide the fence to the desired location and push the rip fence guide handle down to lock the fence in position.



### Dust collection

1. Connect dust extraction equipment to the 60 mm diam. dust extraction port.
2. The dust extraction equipment must provide for an airflow rate of at least 20 m/s.



**Caution.** Wood dust and chips in a confined area can give rise to fire or an explosion. Guard against possible ignition sources.



## Changing the saw band

**Warning.** Ensure that the mains plug is removed from the power socket

The saw is supplied with a general-purpose woodcutting blade.

1. To change the blade, first remove the rip fence scale.
2. Slacken the blade tension by rotating anti-clockwise the blade tensioning knob on the top of the upper wheel housing.
3. Open the doors to the upper and lower wheel housings.
4. Remove the old blade and fit the new blade. Tension the blade lightly by rotating clockwise the blade-tensioning knob on the top of the upper wheel housing.
5. Turn the upper wheel by hand to check that the blade is running in the centre of the rubber-lined wheels.
6. To adjust the tracking of the saw band, turn the knob on the rear of the upper wheel housing whilst rotating the upper wheel by hand. Tighten the wingnut after adjusting the knob.
7. Close and secure both doors.
8. Replace the rip fence scale.

**NOTE.** The saw band is tensioned correctly when it runs quietly and without vibrating.



**CAUTION.** Always ensure that the saw is switched off and unplugged from the power supply before making any adjustments.

**WARNING.** Over tightening the band saw will cause premature failure. Under tightening can cause the band to disengage whilst it is in use.

## Adjusting the blade support head

1. Set the bearings of the upper blade guide to within approx. 0.5 mm of the blade. The bearing should turn freely and turn when the saw is in use.
2. Set the rear bearing just clear of the back of the blade.



**Note.** Do not set the bearing too close, as the resulting friction will generate heat, which can have an adverse effect on the bearings and the blade. The bearing should run freely and turn when the saw is in use.

## Setting the cutting height

1. Always set the upper blade guide as close as practical to the work.
2. To adjust the height, turn the knob on the front of the upper wheel housing.



## Saw table tilt

1. To tilt the table, loosen the knob on the underside of the table, tilt the table to the required angle and retighten the knob.

**Note.** It is best to verify the angle of tilt by making a practice cut in a piece of scrap wood, measuring and resetting the angle if necessary.



## Operation

### Switching on and off

1. Connect the plug to the power supply.
2. Depress the ON button.
3. To switch off, depress the OFF button.

### NOTE.

1. The saw must be connected to an earthed outlet and should be operated on a residual current device (RCD) of 30 mA capacity.
2. Extension leads must have a minimum lead cross section of 3 x 0.75 mm (240V).
3. The saw is automatically turned off in the event of a power failure. You will need to press the ON button again to restart the saw (only on some models).

### Using the rip fence

The rip fence allows you to make parallel cuts in a sheet of wood, all at the same width.

**WARNING.** Always ensure that the saw is switched off and unplugged from the power supply before making any adjustments.

1. Adjust the rip fence to the required width and secure it in position with the locking handle.
2. Ensure that the fence rests against the wood along its entire length to give a consistent parallel cut.

### Cutting

#### NOTES.

1. Use only enough pressure to keep the saw cutting. Do not force the cutting. Allow the blade and the saw to do the work.
2. When cutting at an angle ensure that the rip fence is located on the right hand side of the blade.

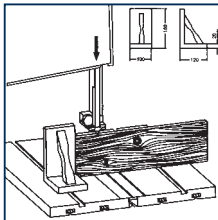

3. When cutting rod, use a jig or fixture to prevent the workpiece from turning.
4. When cutting boards vertically, use a suitable push block to feed the workpiece into the saw.

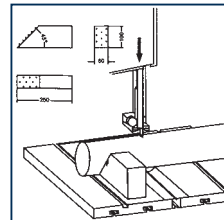

## Maintenance

### Cleaning

**Note.** Always wear eye protection when cleaning the tool.

1. Keep the tool's air vents unclogged and clean at all times.
2. Remove dust and dirt regularly. Cleaning is best done with compressed air or a rag.
3. Re-lubricate all moving parts at regular intervals.
4. Never use caustic agents to clean plastic parts.

**CAUTION.** Do not use cleaning agents to clean the plastic parts of the saw. A mild detergent on a damp cloth is recommended. Water must never come into contact with the saw.

### General inspection

1. Regularly check that all the fixing screws are tight. They may vibrate loose over time.

### Repairs

Call GMC on 1300 880 001

We can advise you as to the best method to repair your tool.

Please do not return the tool to the store where you purchased it without first contacting GMC.

# Carefully read the entire Instruction Manual before using this product.

**Before returning this product for a  
Warranty Claim or any other reason  
Please Call 1300 880 001 (Australia)  
or 0800 445 721 (New Zealand)**

**When you make your call, please have  
the following information at hand:**

- **GMC Product Type**
- **GMC Product Code**

A GMC Service Engineer will take your call and, in most cases, will be able to solve your problem over the phone.

You are welcome to use this phone-in service to make suggestions or give comments about any GMC product.

With continuing product development changes may have occurred which render the product received slightly different to that shown in this instruction manual. The manufacturer reserves the right to change specifications without notice. Note: Specifications may differ from country to country.



**The GMC 777 Helpline operates from 7am to 7pm, 7 days a week (EST). This allows you to contact GMC directly with any queries and technical questions you have regarding our products.**



45-55 South Centre Road  
Melbourne Airport  
Victoria, Australia 3045  
Tel: (03) 8346 1100 Fax: (03) 8346 1200



**Save this Manual for future reference.**

## Free Manuals Download Website

<http://myh66.com>

<http://usermanuals.us>

<http://www.somanuals.com>

<http://www.4manuals.cc>

<http://www.manual-lib.com>

<http://www.404manual.com>

<http://www.luxmanual.com>

<http://aubethermostatmanual.com>

Golf course search by state

<http://golfingnear.com>

Email search by domain

<http://emailbydomain.com>

Auto manuals search

<http://auto.somanuals.com>

TV manuals search

<http://tv.somanuals.com>