

General Product Description

Two-way full-range passive system in a unique slant sided enclosure. Includes dual 8-inch woofers and a 1"/25 mm voice coil compression driver on a 100° x 100° constant-directivity horn. Cloth coverable steel grille.

Applications

The FRi-2082 uses EV's exclusive RMD™ (Ring-Mode Decoupling) to provide outstanding vocal clarity and intelligibility in a cost-effective two-way system. The versatile, compact enclosure features a low profile cabinet design with integral suspension points and a U-bracket (included) to allow horizontal or vertical mounting. The 100° x 100° horn pattern allows broad coverage for near field applications. Five year warranty.

Applications include:

Stadiums	Arenas
Houses of Worship	Discos
Live Music Clubs	Gymnasiums

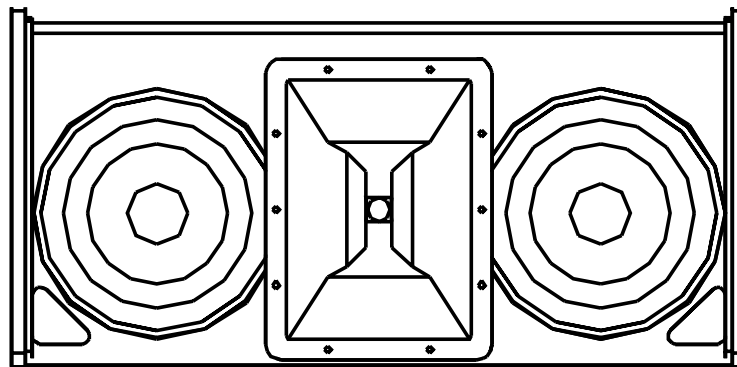

Speaker Description

Part Number	FRi-2082-BLK
LF Section & Components	Dual 8-inch woofers in vented enclosure
HF Section & Components	Compression driver with 1-inch titanium diaphragm on a constant-directivity horn
System Configuration	Two-way, Full range
Powering Configuration	Passive
Recommended High-Pass Frequency (12 dB/octave min.)	50 Hz
Cabinet Type (shape)	Low profile slant design
Enclosure Materials	13-ply plywood
Finish	Black Acrylic
Connectors	One barrier strip
Suspension Hardware	(2) 3/8-16 threaded mounting/suspension points, 1 per side
Grille	Powder-coated perforated 18GA steel
Options	WH-white acrylic finish UN-unfinished

FRi-2082 Speaker System



F R i
S P E A K E R
S Y S T E M S

FRI-2082

Speaker System

Speaker Characteristics

Frequency Response (passive)

-3 dB	70-20,000 Hz
-10 dB	55-16,000 Hz

Axial Sensitivity

(SPL/1 W/1 m) Passive	93 dB
-----------------------	-------

Impedance

8 ohms

Power Handling

Long-term (EIA)	200 watts
Short-term peak	800 watts

Calculated Maximum Output SPL

Peak	122 dB
Long Term	116 dB

Nominal Coverage Angle

Horizontal (-6 dB)	100°
Vertical (-6 dB)	100°

Dimensions

Height	8.75 in. (222 mm)
Width	24.50 in. (62 mm)
Depth	14.0 in. (356 mm)

Weights

Net Weight	40.0 lb (18.2 kg)
Shipping Weight	52.0 lb (23.6 kg)

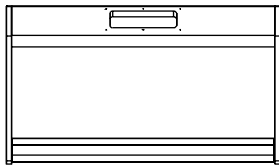

Top View

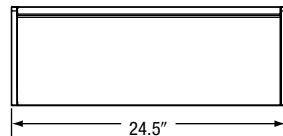

Front View
(with grille)

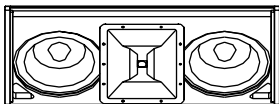

Front View
(with grille removed)

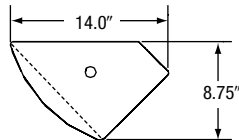

Left Side View

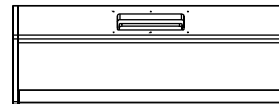

Back View

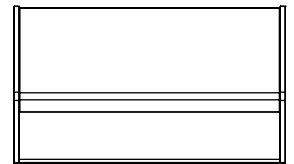

Bottom View

Architects' and Engineers' Specifications

The two-way full range loudspeaker system shall incorporate dual 8-inch LF transducers and a 1"/25 mm voice coil HF compression driver.

The LF driver shall be mounted in a vented enclosure tuned for optimum low-frequency response. The HF driver shall be loaded on constant-directivity horn with a nominal coverage pattern of 100° (h) x 100° (v). An internal passive filter network shall provide acoustical crossover and system equalization.

System frequency response shall be 55 Hz to 16 kHz measured on axis. The loudspeaker shall produce a sound pressure level (SPL) of 93 dB on axis at 1 meter with a power input of 1 watt, and shall be capable of producing a full-power peak output of 122 dB on axis at 1 meter. It shall handle 200 watts of amplifier power long-term (EIA Standard), and shall have a nominal impedance of 8 ohms.

The loudspeaker enclosure shall be 5-sided. It shall be constructed of 13 ply void-free cross-grain-laminated plywood and shall employ extensive internal bracing. It shall be finished in black acrylic paint. Input connectors shall be two at 1 terminal barrier strips. A total of two 3/8-16 threaded mounting/suspension points shall be provided, (with a U-bracket, one per side). The front of the loudspeaker shall be cloth coverable with a powder-coated perforated 18 GA steel grille.

The two-way full range loudspeaker shall be the Electro-Voice model FRI-2082.



EVERYWHERE™

USA	12000 Portland Ave South, Burnsville, MN 55337, Phone: 952-884-4051, FAX: 952-884-0043
Canada	705 Progress Avenue, Unit 46, Scarborough, Ontario, Canada, M1H2X1, Phone: 416-431-4975, 800-881-1685, FAX: 416-431-4588
Germany	Hirschberger Ring 45, D94315, Straubing, Germany, Phone: 49 9421-706 0, Fax: 49 9421-706 287
France	Parc de Courcerin, Allee Lech Walesa, Lognes, 77185 Marne La Vallee, France, Phone: 33/1-6480-0090, FAX: 33/1-6480-4538
Australia	Unit 23, Block C, Slough Business Park, Slough Avenue, Silverwater, N.S.W. 2128, Australia, Phone: 61/2-9648-3455, FAX: 61/2-9648-5585
Hong Kong	Unit E & F, 21/F, Luk Hop Industrial Bldg., 8 Luk Hop St., San PO Kong, Kowloon, Hong Kong, Phone: 852-2351-3628, FAX: 852-2351-3329
Japan	5-3-8 Funabashi, Setagaya-ku, Tokyo, Japan 156-0055, Phone: +81-3-5316-5020, FAX: +81-3-5316-5031
Singapore	3015A Ubi Rd 1, 05-10, Kampong Ubi Industrial Estate, Singapore 408705, Phone: 65-746-8760, FAX: 65-746-1206
Mexico	Av. Parque Chapultepec #66-201, Col. El. Parque Edo. Mex. 53390, Phone: (52) 5358-5434, FAX: (52) 5358-5588
UK	4, The Willows Centre, Willow Lane, Mitcham, Surrey CR4 4NX, UK, Phone: 44 181 640 9600, FAX: 44 181 646 7084
Africa, Mid-East	12000 Portland Ave South, Burnsville, MN 55337, Phone: 952-887-7424, FAX: 952-887-9212
Latin America	12000 Portland Ave South, Burnsville, MN 55337, Phone: 952-887-7491, FAX: 952-887-9212

U.S.A. and Canada only.

For customer orders, contact the Customer Service department at 800/392-3497 Fax: 800/955-6831

For warranty repair or service information, contact the Service Repair department at 800/685-2606

For technical assistance, contact Technical Support at (866)-78AUDIO

Please refer to the Engineering Data Sheet for warranty information.

Specifications subject to change without notice.

www.electrovoice.com • Telex Communications, Inc. • www.telex.com

©Telex Communications, Inc. 2/2001 Part Number 38109-978

Download from Www.Somanuals.com. All Manuals Search And Download.

Free Manuals Download Website

<http://myh66.com>

<http://usermanuals.us>

<http://www.somanuals.com>

<http://www.4manuals.cc>

<http://www.manual-lib.com>

<http://www.404manual.com>

<http://www.luxmanual.com>

<http://aubethermostatmanual.com>

Golf course search by state

<http://golfingnear.com>

Email search by domain

<http://emailbydomain.com>

Auto manuals search

<http://auto.somanuals.com>

TV manuals search

<http://tv.somanuals.com>