

SCP 226 Series

Secondary Control Panels for MLC 226 IP and System 5 IP

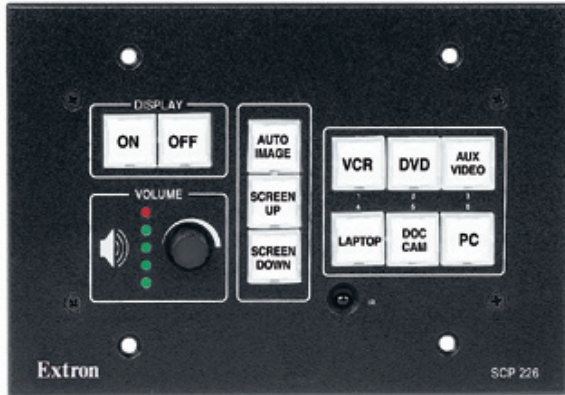

SCP 226 front view



SCP 226 rear view

COMMON FEATURES

- Duplicates the front panel controls of an MLC 226 IP MediaLink™ Controller or System 5 IP Switcher
- Provides second access point to control switching, display power, and audio volume
- Tri-color, backlit, easy-to-label buttons
- IR receiver for IR control
- Versatile mounting options
- Available in black, white, or RAL9010 white
- Optional external universal power supply available, part # 70-055-01 — The SCP 226 can also be powered via an MediaLink Controller or System 5 IP Switcher.
- Optional mud rings available

DESCRIPTION

The Extron **SCP 226** Secondary Control Panel duplicates the MLC 226 IP MediaLink™ Controller's or System 5 IP Switcher's front panel buttons. It offers a second access point within a room to control switching, display, and audio volume. The SCP 226 fits into a three-gang box and mounts in a podium, table, or wall -- making it ideal for secondary remote control by a presenter at a podium. The tri-color, backlit buttons on the SCP 226 can be custom-labeled for easy identification, and are helpful for presenters in low-light environments. The SCP 226 ships with an assortment of button labels. Mud rings are not included.

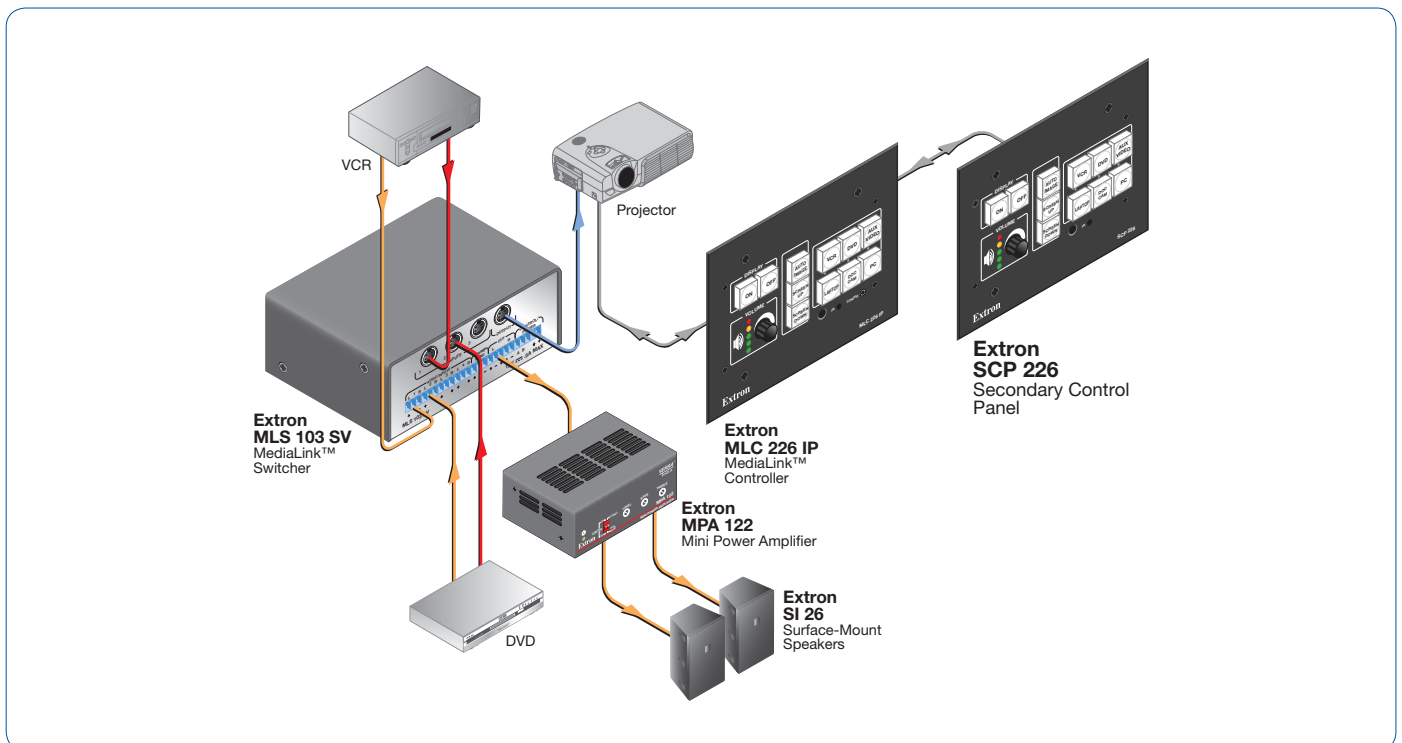

Continued →

SCP 226 Series

SCP 226

Secondary Control Panel for MLC 226 IP and System 5 IP

UNIQUE FEATURES

- Three-gang faceplate

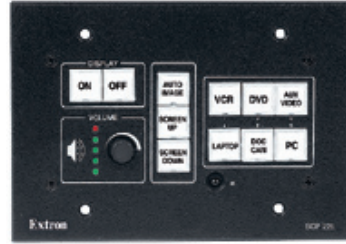

MODEL	VERSION DESCRIPTION	PART #
SCP 226	Black.....	60-671-02
SCP 226	White.....	60-671-03
SCP 226	RAL9010 White.....	60-671-05

SCP 226 AAP

Secondary Control Panel with AAP Opening for MLC 226 IP AAP and System 5 IP

UNIQUE FEATURES

- Five-gang faceplate
- Opening for up to four single space AAP - Architectural Adapter Plates; AAPs sold separately

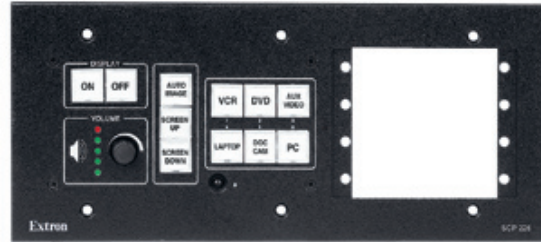

MODEL	VERSION DESCRIPTION	PART #
SCP 226 AAP	Black.....	60-671-12
SCP 226 AAP	White.....	60-671-13
SCP 226 AAP	RAL9010 White.....	60-671-15

SCP 226 L

Secondary Control Panel with Lectern Faceplate for MLC 226 IP L and System 5 IP

UNIQUE FEATURES

- Low profile, 3.2" (8.1 cm) tall faceplate fits into a compact space on a lectern or desk
- Mounts in a rack or wall using an Extron UCM RAAP or UCM 10X8P Universal Controller Mounting Kit; mounts on a desk using an Extron SMB 203 L Lectern Series Mount Box



MODEL	VERSION DESCRIPTION	PART #
SCP 226 L	Black.....	60-671-32
SCP 226 L	White.....	60-671-33
SCP 226 L	RAL9010 White.....	60-671-35

SCP 226

Secondary Control Panel for MLC 226 IP and System 5 IP - No Faceplate

UNIQUE FEATURES

- No faceplate for custom installations
- For use with any of the MLM 226 Series mounting options



MODEL	VERSION DESCRIPTION	PART #
SCP 226	Controller Only.....	60-671-00

Continued →

SCP 226 Series

SCP 226 Series Accessories

OPTIONAL ACCESSORIES	MODEL DESCRIPTION	PAGE	PART #
MLC 226 IP	Enhanced MediaLink™ Controller with IP Link®	page 390	60-600-02
EPS 1210 B	Extron Desktop Power Supply - 12VDC, 2A	page 694	70-055-01
MR 300	Three-Gang Mud Ring	page 821	70-519-32
MR 500	Five-Gang Mud Ring	page 821	70-519-52
MLM 226 L	Replacement Lectern Mounting Kit for the MLC 226 IP L and SCP 226 L	page 408	70-342-02
MLM 226 5GWP	Five-Gang Replacement Wall Mounting Kit for the MLC 226 IP	page 407	70-377-02
SMB 103	Three-Gang Surface Mounting Box	page 824	60-641-02
SMB 105	Five-Gang Surface Mounting Box	page 824	60-643-02

SPECIFICATIONS

CONTROL / REMOTE – CONTROL PAD

Serial control port	RS-232, via a 3.5 mm captive screw connector, 3 pole
Baud rate and protocol	9600 baud, 8 data bits, 1 stop bit, no parity
Serial control pin configurations	A = TX, B = RX, C = GND
IR remote control	IR 402 (for SCP 226 only, optional) 30° maximum, 40 degrees off axis
Program control	Extron's Simple Instruction Set (SIS™)

GENERAL

Power	Supplied by an Extron MediaLink™ Controller or an external power supply
External power supply (optional)	100 VAC to 240 VAC, 50/60 Hz, external, to 12VDC, 1 A, regulated
Power input requirements	12 VDC, 0.18 A
Temperature / Humidity	Storage: -40 to +158 °F (-40 to +70 °C) / 10% to 90%, noncondensing Operating: +32 to +122 °F (0 to +50 °C) / 10% to 90%, noncondensing
Rack mount	Yes, with an optional faceplate, UCM RAAP, part #70-344-02 or 70-344-03 Also wall or furniture mountable
Enclosure type	Metal
Enclosure dimensions	
Faceplate	
SCP 226	4.5" H x 6.4" W x 0.1" D (11.4 cm H x 16.3 cm W x 0.3 cm D) (3 gang)
SCP 226 AAP	4.5" H x 10.1" W x 0.1" D (11.4 cm H x 25.7 cm W x 0.3 cm D) (5 gang)
SCP 226 L	3.2" H x 6.5" W x 0.1" D (8.1 cm H x 16.5 cm W x 0.3 cm D)
Device	2.7" H x 5.2" W x 0.5" D (6.9 cm H x 13.2 cm W x 1.3 cm D) [Allow at least 1.5" (3.8 cm) depth in the wall or furniture. Depth excludes connectors, knob, and buttons.]
Product weight	0.3 lbs (0.1 kg)
Shipping weight	2 lbs (1 kg)
Vibration	ISTA 1A in carton (International Safe Transit Association)
Listings	UL, CUL
Compliances	CE, FCC Class A, VCCI, AS/NZS, ICES
MTBF	30,000 hours
Warranty	3 years parts and labor

NOTE: All nominal levels are at ±10%. Specifications are subject to change without notice.

Free Manuals Download Website

<http://myh66.com>

<http://usermanuals.us>

<http://www.somanuals.com>

<http://www.4manuals.cc>

<http://www.manual-lib.com>

<http://www.404manual.com>

<http://www.luxmanual.com>

<http://aubethermostatmanual.com>

Golf course search by state

<http://golfingnear.com>

Email search by domain

<http://emailbydomain.com>

Auto manuals search

<http://auto.somanuals.com>

TV manuals search

<http://tv.somanuals.com>