

# Control Panels

Switcher Remote Control Panels — SCP 104 Series

## SCP 104 Series

Secondary Control Panels for MLC 104 IP Plus and System 5 IP



SCP 104 front view



SCP 104 rear view

### COMMON FEATURES

- Duplicates the front panel controls of an MLC 104 IP Plus MediaLink™ Controller or System 5 IP Switcher
- Provides second access point to control switching, display power, and audio volume
- Tri-color, backlit, easy-to-label buttons
- Versatile mounting options
- Available in black, white, or RAL9010 white
- Optional external universal power supply available, part # 70-055-01 — The SCP 104 can also be powered via an MLC - MediaLink Controller or System 5 IP Switcher.
- Optional mud rings available

### DESCRIPTION

The Extron **SCP 104** Secondary Control Panel duplicates the MLC 104 IP Plus MediaLink™ Controller's and System 5 IP Switcher's front panel buttons. It offers a second access point within a room to control switching, display, and audio volume. The SCP 104 fits into a two-gang box and mounts in a podium, table, or wall — making it ideal for secondary remote control by a presenter at a podium. The tri-color, backlit buttons on the SCP 104 can be custom-labeled for easy identification, and are helpful for presenters in low-light environments. The SCP 104 ships with an assortment of button labels. Mud rings are not included.

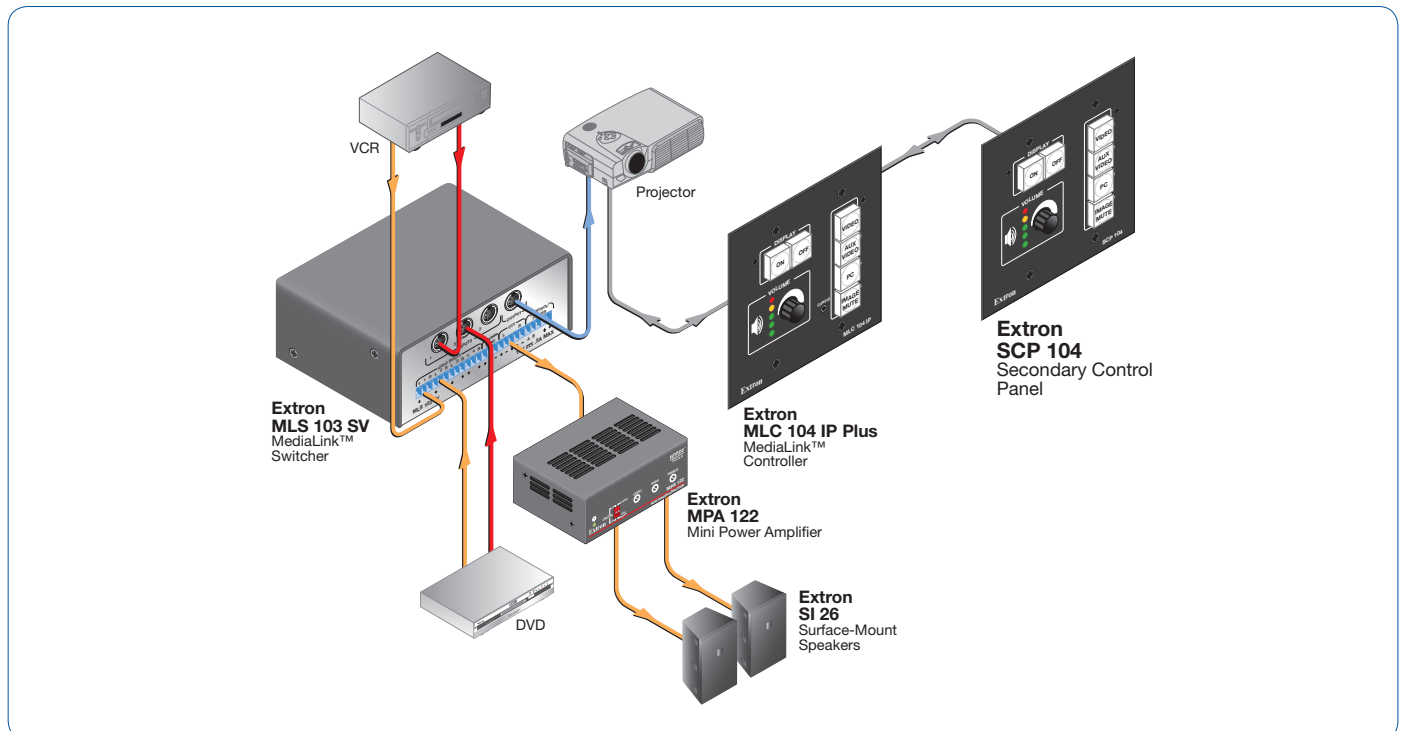

Continued →

## Control Panels (continued)

Switcher Remote Control Panels — SCP 104 Series

### SCP 104

Secondary Control Panels for MLC 104 IP Plus and System 5 IP

#### UNIQUE FEATURES

- Two-gang faceplate



| MODEL   | VERSION DESCRIPTION | PART #    |
|---------|---------------------|-----------|
| SCP 104 | Black.....          | 60-672-02 |
| SCP 104 | White.....          | 60-672-03 |
| SCP 104 | RAL9010 White.....  | 60-672-05 |

### SCP 104 AAP

SCP - Secondary Control Panel with AAP Opening for MLC 104 IP Plus and System 5 IP

#### UNIQUE FEATURES

- Four-gang faceplate
- Opening for up to four single space AAP - Architectural Adapter Plates — AAPs sold separately

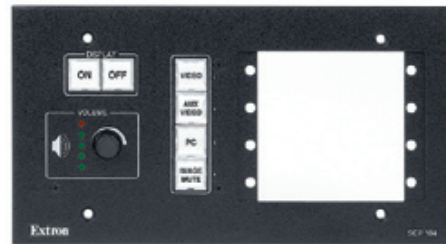

| MODEL       | VERSION DESCRIPTION | PART #    |
|-------------|---------------------|-----------|
| SCP 104 AAP | Black.....          | 60-672-12 |
| SCP 104 AAP | White.....          | 60-672-13 |
| SCP 104 AAP | RAL9010 White.....  | 60-672-15 |

### SCP 104 L

SCP - Secondary Control Panel with Lectern Faceplate for MLC 104 IP Plus and System 5 IP

#### UNIQUE FEATURES

- Low profile, 3.2" (8.1 cm) tall faceplate fits into a compact space on a lectern or desk
- Mounts in a rack or wall using an Extron UCM RAAP or UCM 10X8P Universal Controller Mounting Kit; mounts on a desk using an Extron SMB 203 L Lectern Series Mount Box



| MODEL     | VERSION DESCRIPTION | PART #    |
|-----------|---------------------|-----------|
| SCP 104 L | Black.....          | 60-672-32 |
| SCP 104 L | White.....          | 60-672-33 |
| SCP 104 L | RAL9010 White.....  | 60-672-35 |

### SCP 104

SCP - Secondary Control Panel for MLC 104 IP Plus and System 5 IP - No Faceplate

#### UNIQUE FEATURES

- No faceplate for custom installations
- For use with any of the MLM 104 Series mounting options



| MODEL   | VERSION DESCRIPTION  | PART #    |
|---------|----------------------|-----------|
| SCP 104 | Controller Only..... | 60-672-00 |

# Control Panels (continued)

Switcher Remote Control Panels — SCP 226 Series

## SCP 226 Series

Secondary Control Panels for MLC 226 IP and System 5 IP

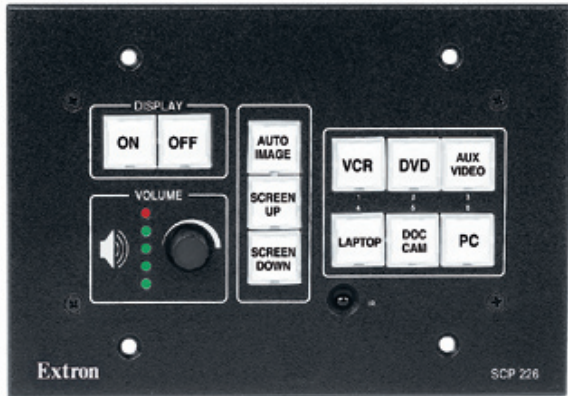

SCP 226 front view



SCP 226 rear view

### COMMON FEATURES

- Duplicates the front panel controls of an MLC 226 IP MediaLink™ Controller or System 5 IP Switcher
- Provides second access point to control switching, display power, and audio volume
- Tri-color, backlit, easy-to-label buttons
- IR receiver for IR control
- Versatile mounting options
- Available in black, white, or RAL9010 white
- Optional external universal power supply available, part # 70-055-01 — The SCP 226 can also be powered via an MLC - MediaLink Controller or System 5 IP Switcher.
- Optional mud rings available

### DESCRIPTION

The Extron **SCP 226** Secondary Control Panel duplicates the MLC 226 IP MediaLink™ Controller's or System 5 IP Switcher's front panel buttons. It offers a second access point within a room to control switching, display, and audio volume. The SCP 226 fits into a three-gang box and mounts in a podium, table, or wall — making it ideal for secondary remote control by a presenter at a podium. The tri-color, backlit buttons on the SCP 226 can be custom-labeled for easy identification, and are helpful for presenters in low-light environments. The SCP 226 ships with an assortment of button labels. Mud rings are not included.

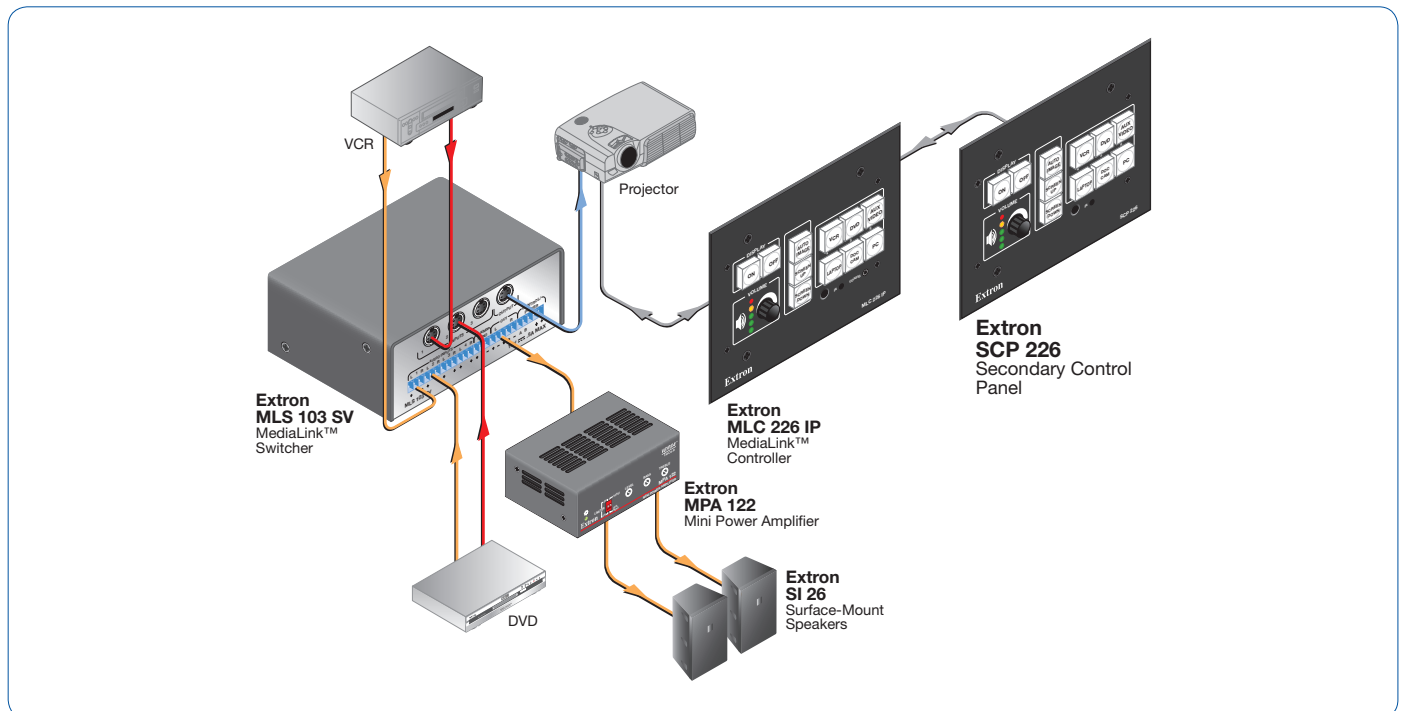

Continued →

# Control Panels (continued)

Switcher Remote Control Panels — SCP 226 Series

## SCP 226

Secondary Control Panel for MLC 226 IP and System 5 IP

### UNIQUE FEATURES

- Three-gang faceplate



| MODEL   | VERSION DESCRIPTION | PART #    |
|---------|---------------------|-----------|
| SCP 226 | Black.....          | 60-671-02 |
| SCP 226 | White.....          | 60-671-03 |
| SCP 226 | RAL9010 White.....  | 60-671-05 |

## SCP 226 AAP

Secondary Control Panel with AAP Opening for MLC 226 IP and System 5 IP

### UNIQUE FEATURES

- Five-gang faceplate
- Opening for up to four single space AAP - Architectural Adapter Plates — AAPs sold separately

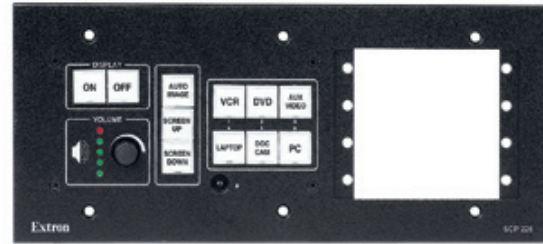

| MODEL       | VERSION DESCRIPTION | PART #    |
|-------------|---------------------|-----------|
| SCP 226 AAP | Black.....          | 60-671-12 |
| SCP 226 AAP | White.....          | 60-671-13 |
| SCP 226 AAP | RAL9010 White.....  | 60-671-15 |

## SCP 226 L

Secondary Control Panel with Lectern Faceplate for MLC 226 IP and System 5 IP

### UNIQUE FEATURES

- Low profile, 3.2" (8.1 cm) tall faceplate fits into a compact space on a lectern or desk
- Mounts in a rack or wall using an Extron UCM RAAP or UCM 10X8P Universal Controller Mounting Kit; mounts on a desk using an Extron SMB 203 L Lectern Series Mount Box



| MODEL     | VERSION DESCRIPTION | PART #    |
|-----------|---------------------|-----------|
| SCP 226 L | Black.....          | 60-671-32 |
| SCP 226 L | White.....          | 60-671-33 |
| SCP 226 L | RAL9010 White.....  | 60-671-35 |

## SCP 226

Secondary Control Panel for MLC 226 IP and System 5 IP  
- No Faceplate

### UNIQUE FEATURES

- No faceplate for custom installations
- For use with any of the MLM 226 Series mounting options



| MODEL   | VERSION DESCRIPTION  | PART #    |
|---------|----------------------|-----------|
| SCP 226 | Controller Only..... | 60-671-00 |

## Control Panels (continued)

### Switcher Remote Control Panels

## SCP 250

### System 7SC Secondary Control Panel

#### DESCRIPTION

The Extron **SCP 250** Secondary Control Panel duplicates the System 7SC switcher's front panel display, input selection, room, and audio adjustment controls. It can also receive IR commands from the IR 701 remote control. The SCP 250 is mountable in a podium, table, or wall, making it ideal for control by a presenter at a podium or executive at a table. Buttons may be conveniently custom-labeled for ease of use. The SCP 250 is available in black, or white, or RAL 9010 white and ships with a three-gang electrical box.



| MODEL   | VERSION DESCRIPTION | PART #    |
|---------|---------------------|-----------|
| SCP 250 | Black .....         | 60-356-02 |
| SCP 250 | White .....         | 60-356-03 |
| SCP 250 | RAL9010 White ..... | 60-356-05 |

## VSW I AAP

### Remote Input and Control Panel AAP - Architectural Adapter Plate for VSW 2VGA A Switcher and SW VGA rs / VGA Ars Series Switchers

#### DESCRIPTION

The **VSW I AAP** is an optional, single space AAP - Architectural Adapter Plate that provides remote input connection and selection for the Extron VSW 2VGA A switcher. In addition, it supports the switcher's looping capability. It is also suitable for use with the SW VGA rs / VGA Ars Series Switchers.

Equipped with a "Show Me" button for input selection, the VSW I AAP also features a female 15-pin HD connector and 3.5 mm stereo audio jack for VGA and stereo audio. It can be mounted into any Extron mounting frame with a single space AAP opening.

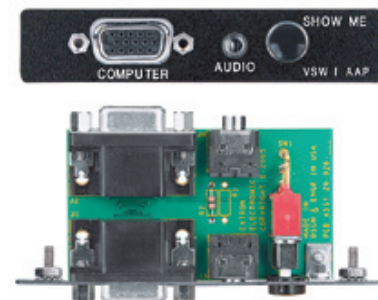

| MODEL     | VERSION DESCRIPTION | PART #    |
|-----------|---------------------|-----------|
| VSW I AAP | Black .....         | 70-529-11 |
| VSW I AAP | White .....         | 70-529-21 |

## CCR 204

### Four-Button Contact Closure Remote

#### DESCRIPTION

The **CCR 204** Four-Button Contact Closure Remote provides input selection for remote control of up to four inputs for any Extron switcher with contact closure. The CCR 204 can be mounted into a table, lectern, or similar flat surface providing convenient control of the attached switcher inputs. The CCR 204 measures 4.0" (10.16 cm) wide by 1.75" (4.4 cm) high. Available in black.



| MODEL   | VERSION DESCRIPTION | PART #    |
|---------|---------------------|-----------|
| CCR 204 | Black .....         | 60-794-02 |

# Control Panels (continued)

## Switcher Remote Control Panels

### CCR 306

#### Six-Button Contact Closure Remote

##### DESCRIPTION

The **CCR 306** Six-Button Contact Closure Remote provides input selection for remote control of up to six inputs for any Extron switcher with contact closure. The CCR 306 can be mounted into a table, lectern, or similar flat surface providing convenient control of the attached switcher inputs. The CCR 306 measures 4.0" (10.16 cm) wide by 1.75" (4.4 cm) high. Available in black.



##### MODEL

##### VERSION DESCRIPTION

##### PART #

| MODEL   | VERSION DESCRIPTION | PART #    |
|---------|---------------------|-----------|
| CCR 306 | Black.....          | 60-795-02 |

### CCR 2BLB **NEW**

#### Two-Button Contact Closure Remote With Customizable Backlit Buttons

##### DESCRIPTION

The **CCR 2BLB** Two-Button Contact Closure Remote With Customizable Backlit Buttons provides input selection for remote control of two inputs for any Extron switcher with contact closure. The CCR 2BLB can be mounted into a table, lectern, or similar flat surface providing convenient control of the attached switcher inputs.

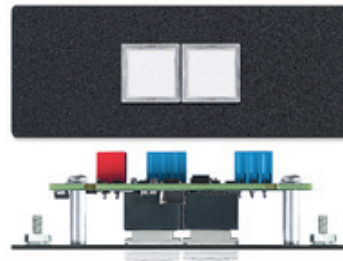

##### MODEL

##### VERSION DESCRIPTION

##### PART #

| MODEL    | VERSION DESCRIPTION | PART #    |
|----------|---------------------|-----------|
| CCR 2BLB | Black.....          | 70-589-02 |
| CCR 2BLB | White.....          | 70-589-03 |

### CCR 4BLB **NEW**

#### Four-Button Contact Closure Remote With Customizable Backlit Buttons

##### DESCRIPTION

The **CCR 4BLB** Four-Button Contact Closure Remote With Customizable Backlit Buttons provides input selection for remote control of two inputs for any Extron switcher with contact closure. The CCR 4BLB can be mounted into a table, lectern, or similar flat surface providing convenient control of the attached switcher inputs.

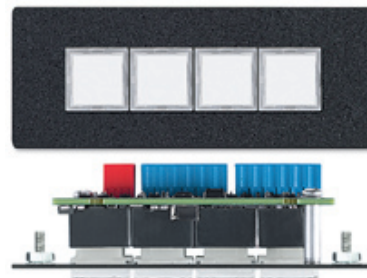

##### MODEL

##### VERSION DESCRIPTION

##### PART #

| MODEL    | VERSION DESCRIPTION | PART #    |
|----------|---------------------|-----------|
| CCR 4BLB | Black.....          | 70-588-02 |
| CCR 4BLB | White.....          | 70-588-03 |

## Control Panels (continued)

### Switcher Remote Control Panels

## KP 6

### Keypad Remote Control

#### DESCRIPTION

The Extron **KP 6** is a keypad remote control designed to switch the inputs on the Extron SW VGA and SW RGBHV Series of switchers, as well as four and six input models of the SW AV Series of switchers, that utilize a 9-pin contact closure connection. A 25-foot (7.5 meters) cable is included to connect the switcher's 9-pin remote control port to the KP 6.



#### MODEL

#### VERSION DESCRIPTION

#### PART #

| MODEL | VERSION DESCRIPTION        | PART #    |
|-------|----------------------------|-----------|
| KP 6  | Keypad Remote Control..... | 60-111-20 |

## UCM 10X8P

### Universal Controller Mounting Plate Kit

#### DESCRIPTION

The Extron **UCM 10X8P** mounting plate kit is designed for use with Extron MLC - MediaLink™ Controllers and SCP - Secondary Control Panels installed in a lectern mount. Available in black, white, and RAL9010 white, the UCM 10X8P is a universal controller mounting plate kit with openings to accommodate up to eight single space AAP - Architectural Adapter Plates. It can be mounted in a wall, desk, or lectern using an external wall box or Hoffman box, model # A-SE10X8X4. MediaLink™ Controllers, Secondary Control Panels, lectern mounts, external wall boxes, and AAPs are sold separately.

Dimensions: 8.25" H x 10.25" W x 0.1" D (21.0 cm H x 26.0 cm W x 0.25 cm D)

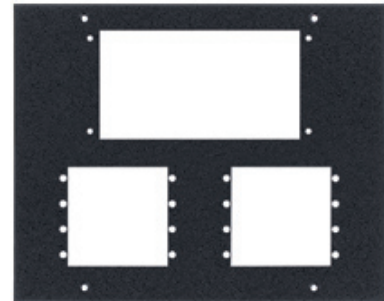

#### MODEL

#### VERSION DESCRIPTION

#### PART #

| MODEL     | VERSION DESCRIPTION | PART #    |
|-----------|---------------------|-----------|
| UCM 10X8P | Black.....          | 70-341-02 |

## Free Manuals Download Website

<http://myh66.com>

<http://usermanuals.us>

<http://www.somanuals.com>

<http://www.4manuals.cc>

<http://www.manual-lib.com>

<http://www.404manual.com>

<http://www.luxmanual.com>

<http://aubethermostatmanual.com>

Golf course search by state

<http://golfingnear.com>

Email search by domain

<http://emailbydomain.com>

Auto manuals search

<http://auto.somanuals.com>

TV manuals search

<http://tv.somanuals.com>