

**SCT 5-40**



## *Drywall Screwdriver*



### ***SERVICE***

***Tool service and maintenance must be performed only by qualified repair personnel.***

***When servicing a tool, only use identical replacement parts available from FEIN.***

Repairs on FEIN Power Tools required the use of special tools (pulling devices and bearing press). Authorized repair centers have trained repair technicians and equipment necessary to perform these repairs. Service or repairs performed by unqualified persons could result in operator injury.

For the location of the repair center near you, please call 1-800-441-9878. Monday thru Friday, 9AM to 5PM EST. Or, look on our web site at [www.feinus.com](http://www.feinus.com) and follow the link to "Authorized Warranty Repair Centers"

**FEIN Power Tools  
1030 Alcon Street  
Pittsburgh, PA 15220**

Phone: 412-922-8886 Fax: 412-922-8767 Toll Free: 1-800-441-9878

November 3, 2006

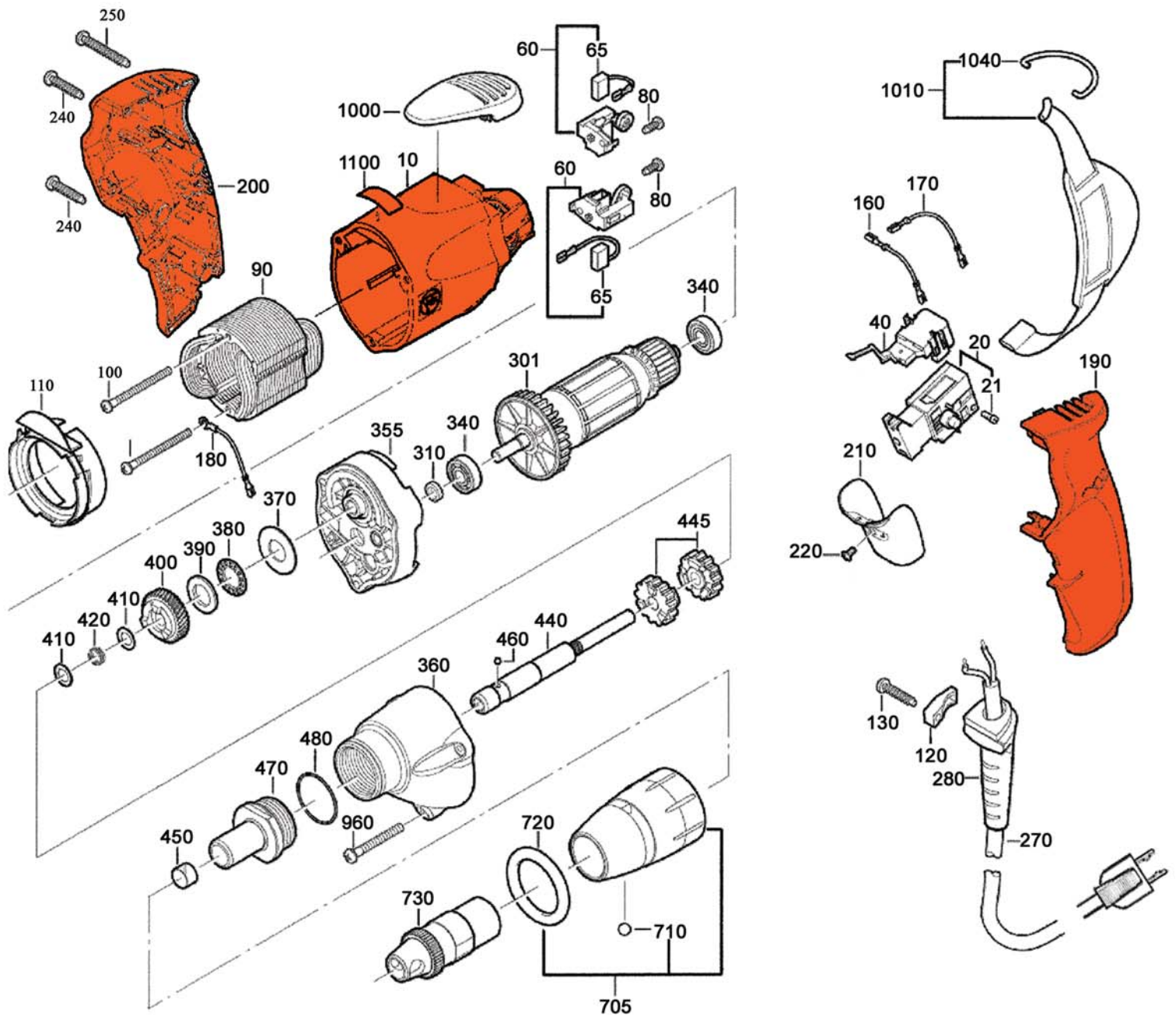

# Drywall Screwdriver

Model: SCT 5-40

**FEIN Power Tools**

**SCT5-40 Parts List**

<u>Item</u>	<u>Item Number</u>	<u>Description</u>	<u>Reqd</u>
10	3-19-01-138-01-1	MOTOR HOUSING	1
20	3-07-01-234-00-2	SWITCH	1
21	4-30-13-052-03-3	SCREW	2
40	3-07-01-249-00-4	SWITCH REPAIR SET	1
60	3-07-12-089-02-3	BRUSH HOLDER	2
65	3-07-11-134-00-5	CARBON BRUSH	2
80	4-30-70-018-00-9	SCREW	2
90	5-1-274-004-11-7	FIELD WITH WINDING	1
100	4-30-70-014-00-0	SCREW	2
110	3-14-28-149-00-8	AIR CONDUCTING RING	1
120	3-24-31-041-00-5	CLAMPING PIECE	1
130	4-30-70-006-00-8	SCREW	1
160	3-07-19-565-01-6	CONNECTION CABLE	1
170	3-07-19-566-01-9	CONNECTION CABLE	1
180	3-07-19-630-01-4	CONNECTION CABLE	1
190	3-12-01-123-00-3	HANDLE LOWER PART	1
200	3-12-01-124-00-1	HANDLE UPPER PART	1
210	3-28-05-191-00-2	SWITCH LEVER	1
220	4-30-66-009-03-8	SCREW	1
240	4-30-16-003-00-9	SCREW	2
250	4-30-70-007-00-2	SCREW	1
270	3-07-06-327-01-7	CABLE ASSEMBLY	1
280	3-14-13-224-00-9	PROTECTIVE SLEEVE	1
301	5-3-274-004-11-9	ARMATURE	1
310	3-26-12-063-00-5	PACKING RING	1
340	4-17-01-001-17-2	BALL BEARING	2
355	3-15-06-367-01-4	INTERM HOUSING	1
360	3-15-08-251-00-2	FRONT HOUSING	1
370	4-17-19-026-00-7	AXIAL DISC	1
380	4-17-15-029-00-9	NEEDLE BEARING	1
390	3-24-08-395-00-0	DISC	1
400	3-36-57-161-00-7	SPUR WHEEL ASSEMBLY	1
410	3-26-24-094-03-2	WASHER	2
420	3-09-01-139-00-7	COMPRESSION SPRING	1
440	3-01-04-131-00-9	TOOL HOLDER	1
445	3-01-02-101-01-3	CAM RING	1
450	3-09-06-025-00-8	RETAINING RING	1
460	4-17-08-014-00-1	BALL	1
470	3-16-03-045-00-5	BUSHING	1
480	4-06-12-093-00-4	O RING	1
705	3-05-05-069-01-1	SLEEVE ASSEMBLY	1
710	4-17-08-019-00-4	BALL	2
720	4-06-12-071-00-9	PACKING RING	1
730	3-21-27-057-00-8	DEPTH STOP	1
960	4-30-72-010-00-9	SCREW	3
1000	3-02-40-257-00-1	CLAMPING PIECE	1
1010	6-39-01-011-05-9	HANDBELT	1
1040	3-02-32-046-00-8	BOW	1

## Free Manuals Download Website

<http://myh66.com>

<http://usermanuals.us>

<http://www.somanuals.com>

<http://www.4manuals.cc>

<http://www.manual-lib.com>

<http://www.404manual.com>

<http://www.luxmanual.com>

<http://aubethermostatmanual.com>

Golf course search by state

<http://golfingnear.com>

Email search by domain

<http://emailbydomain.com>

Auto manuals search

<http://auto.somanuals.com>

TV manuals search

<http://tv.somanuals.com>