

Model 27909 DECT 6.0 Cordless Handset with Answering System & Speakerphone User's Guide

CAUTION: When using telephone equipment, there are basic safety instructions that should always be followed. Refer to the **IMPORTANT SAFETY INSTRUCTIONS** provided with this product and save them for future reference.

IMPORTANT: Because cordless phones operate on electricity, you should have at least one phone in your home that isn't cordless, in case the power in your home goes out.

BEFORE YOU BEGIN

Parts Checklist

Make sure your package includes the items shown here.

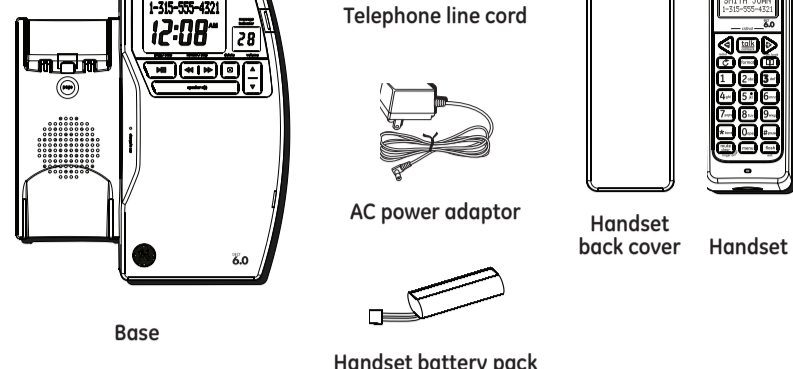

Telephone Jack Requirements

To use this phone, you need an RJ11C type modular telephone jack, which might look like the one pictured here, installed in your home. If you don't have a modular jack, call your local phone company to find out how to get one installed.

Digital Security System

Your cordless phone equipment has a digital security system to protect against false ringing, unauthorized access, and charges to your phone line.

EQUIPMENT APPROVAL INFORMATION

Your telephone equipment is approved for connection to the Public Switched Telephone Network and is in compliance with parts 15 and 68 FCC Rules and Regulations and the Technical Regulations for Telephone Terminal Equipment published by ACTA.

1. Notification to the Local Telephone Company

At the bottom of this equipment is a label indicating, among other information, the US number and Ringer Equivalence Number (REN) for the equipment. You must, upon request, provide this information to your telephone company.

The REN is useful in determining the number of devices you may connect to your telephone line and still have all of these devices ring when your telephone number is called in most but not all areas, the sum of the RENs of all devices connected to your telephone line should not exceed 5. To be certain of the number of devices you may connect to your line as determined by the REN, you should contact your local telephone company.

2. Certain other communications devices may also use the 1.9 GHz frequency for communication, and, if not properly set, these devices may interfere with each other and/or your new telephone. If you are concerned with interference, please refer to the owner's manual for these devices on how to properly set channels to avoid interference. Typical devices that use the 1.9 GHz frequency for communication include wireless audio/video senders, wireless computer networks, multi-line cordless telephone systems, and some long-range cordless telephone systems.

Important Installation Guidelines

- Avoid sources of noise and heat, such as motors, fluorescent lighting, microwave ovens, hearing appliances and direct sunlight.
- Avoid areas of excessive dust, moisture and low temperature.
- Avoid other cordless telephones or personal computers.
- Never install telephone wiring during a lightning storm.
- Never install telephone jacks in wet locations unless the jack is specifically designed for wet locations.
- Never touch un-insulated telephone wires or terminals, unless the telephone line has been disconnected at the network interface.
- Your home has specially wired alarm equipment connected to the telephone line, ensure the installation of this product does not disable your alarm equipment. If you have questions about when to disable alarm equipment, consult your telephone company or a qualified installer.
- Use REN Number is located on the cabinet bottom.

HANDESET LAYOUT

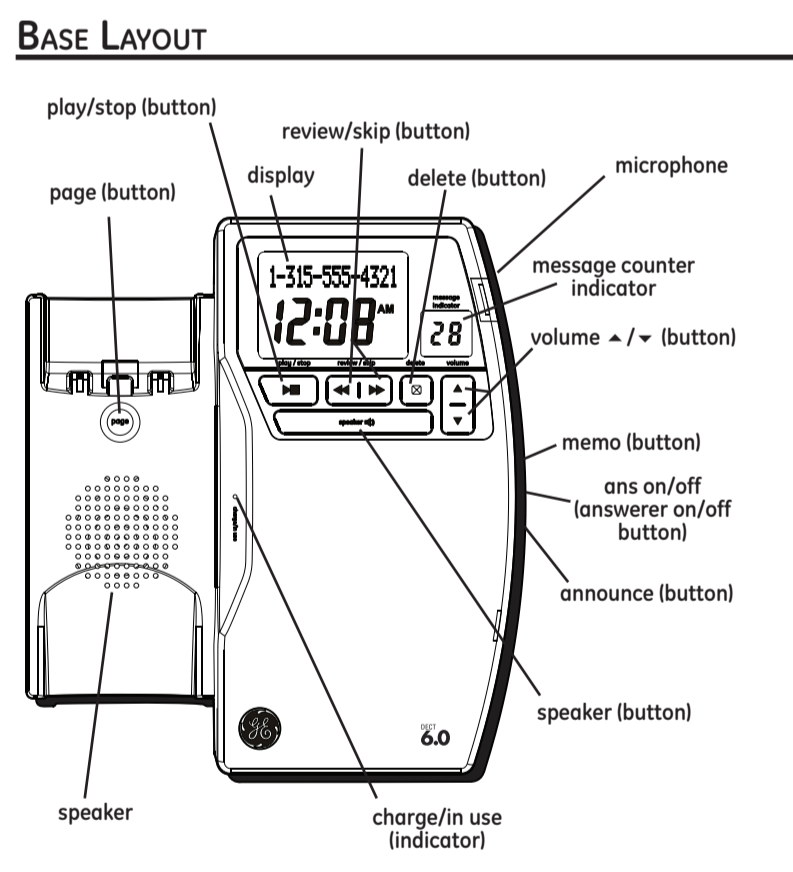
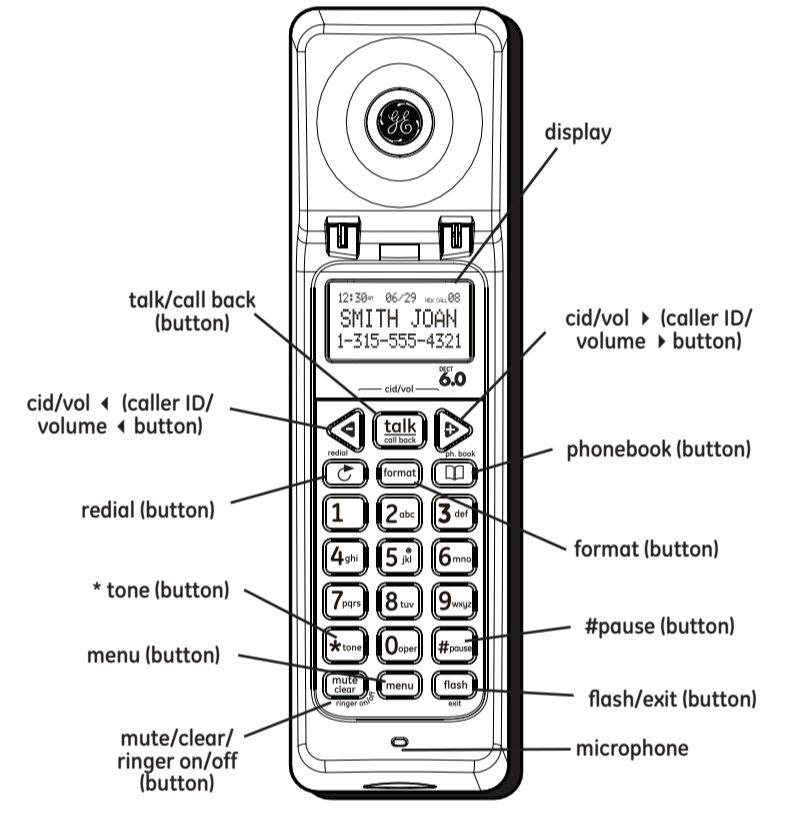

INSTALLING THE PHONE

Installing the Handset Battery

CAUTION: To reduce the risk of fire or personal injury, use only the Thomson Inc. approved Nickel-metal hydride (Ni-MH) battery model 5-2734, that is compatible with this unit.

- Label the battery which is packaged inside a plastic bag and is separate from the handset.
- Locate the battery compartment on the back of the handset.
- Press the battery pack down into the jack inside the compartment.

Note: To ensure proper battery installation, the connector is keyed and can be inserted only one way.

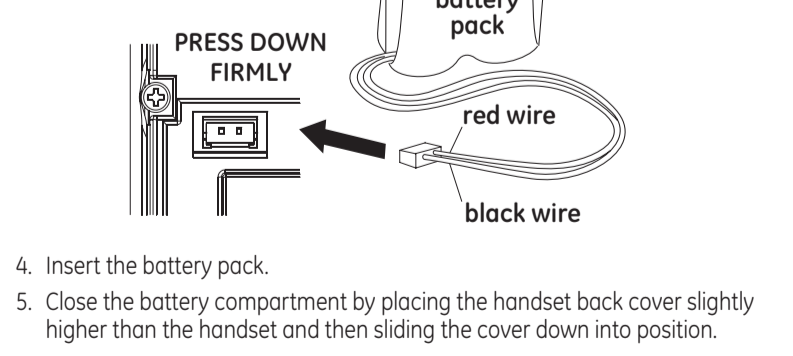

Base Station

- Choose an area near an electrical outlet and a telephone wall jack (RJ11C), and place your cordless telephone on a level surface, such as a desktop or tabletop, or you may mount it on the wall.
- Plug one end of the telephone line cord into the TEL LINE jack on the bottom of the base and the other end into a modular jack.
- Plug the AC power adaptor into the electrical outlet and the DC connector into the jack on the bottom of the base.
- You can stretch out the kick-stand on the bottom of the base for a better viewing angle when placed on desk-top.

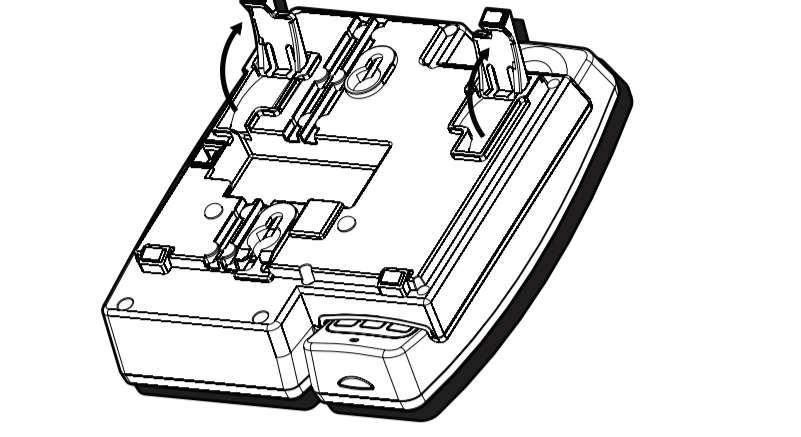

Area Code

The telephone uses the pre-programmed area code to determine the number format to display when a valid Caller ID record is received. The pre-programmed area code is also used for the DiaBack feature.

From the Setup BS Menu:

- Make sure your phone is OFF InT in talk mode.
- Press the menu button to go to the main menu.
- Press cid/vol (V) or (V) button to scroll to **Setup BS**
- Press menu button to confirm and you may program the following items: Area Code, Dial mode and BS Backlight.

Wall Mounting

- Plug the AC power adaptor into the electrical outlet and the DC connector into the jack on the back of the base.
- Plug one end of the straight telephone line cord into the jack on the bottom of the base.
- Close the kick-stands on the bottom of the base unit if you've opened them before.
- Feed the line cord through the groove and plug the end into the modular telephone jack.
- Slip the mounting holes on the bottom of the basal over the wall plate posts and firmly slide the unit down into place.

BS Backlight

From the Setup BS Menu:

- Press the cid/vol (V) or (V) button to scroll to the **BS Backlight** sub-menu.
- Press menu button to enter the menu and use the cid/vol (V) or (V) button to select **On or Off**.
- Press menu button to save your selection.

Date/Time

Note: Time set on handset will be transferred to the base unit

For best results when recording, you should be about one inch from the microphone, and eliminate as much background noise as possible.

1. Make sure the answering system is ON and off. The indicator blinks when you have new messages.

NOTE: The answering system displays "--" when it is off.

VOICE INSTRUCTIONS

If you need additional assistance, while in standby mode, press the review button on the base and follow the voice instructions.

Speaker Volume

Use the volume (V) or (V) buttons to adjust speaker volume on the base to a comfortable level. The maximum speaker volume is 10 and 15 is the maximum.

Recording the Outgoing Announcement

For best results when recording, you should be about one inch from the microphone, and eliminate as much background noise as possible.

- Make sure the answering system is ON and off.
- Press and hold the announce button on the base until the speaker announces "RECORD ANNOUNCEMENT AFTER TONE"
- Begin speaking after you hear the beep.
- Release the announce button when you finish your announcement.

NOTE: If you choose not to record an outgoing announcement, a default announcement plays instead. To return to the default announcement after you have recorded your own outgoing announcement, press the **message counter** button and release it when you hear the beep. Or, press the delete button while the announcement is repeating.

NOTE: The maximum duration allowed for outgoing message is 2 minutes.

PROGRAMMING THE TELEPHONE

Standby Screen

The handset displays the handset name, date, time, signal and battery status. The base displays the current date and time.

NOTE: If the clock is not set, the date and time display will blink. The blinking will stop when you updates the date/time from the Handset menu, or the base receives a call with CID having date and time stamp.

Programming Functions

The system uses a menu structure to give you access to all of the built-in features. You may program the following items in main menu, Intercom, Setup HS, Setup BS, Date/Time, Registration and Answer Machine.

NOTE: If the handset is not registered, or is out of range, Setup BS and Date/Time are not programmable, and Unavailable displays as you try to enter these two menus.

NOTE: During programming, you may press the mute/clear button at any time to exit the sub-menu and return to the main menu, or press flash/exit to exit programming and return to standby screen.

NOTE: If no key is pressed for 60 seconds, the handset will automatically exit programming and return to standby screen.

Handset Setup

- Hold the handset in **OFF InT** in talk mode.
- Press the menu button to go to the main menu.
- Press cid/vol (V) or (V) button to scroll to **Setup HS**
- Press menu button to confirm and you may program the following items: Ring Volume, Tones, Auto Talk, Handset Name and Language.

Language

From the Setup HS Menu:

- Press the cid/vol (V) or (V) button to scroll to the **Language** sub-menu.
- Press menu button to enter the menu.
- Use the cid/vol (V) or (V) button to select **English, Français or Español**. The default setting is English.
- Press the menu button to save your selection.

Ring Volume

There are 4 volume levels for your selection. They are volume 1 to 3 and Ringer off respectively.

From the Setup HS Menu:

- Press the cid/vol (V) or (V) button to scroll to the **Ring Volume** sub-menu.
- Press menu button to enter the menu. Use the cid/vol (V) or (V) button to your selection. The default setting is VOL 3.

Answer Machine

This menu allows you to set the answering system on or off.

From the Answer Machine Menu:

- Press the cid/vol (V) or (V) button to scroll to the **Answer On/Off** sub-menu.
- Press menu button to enter the menu and use the cid/vol (V) or (V) button to register.
- Press menu button to confirm and you may program the following items: Register and Remove Handset.

Register

From the Registration Menu:

- Press the cid/vol (V) or (V) button to scroll to the **Register** sub-menu.
- Press menu button to enter the menu.
- Press the menu button to confirm the deletion. **All deleted** shows in the display.

Deleting All Rec'd Records

- Make sure the phone is OFF InT in talk mode.
- Use the cid/vol (V) or (V) button to scroll to **delete all**.
- Press the menu button.
- Use the cid/vol (V) or (V) button to scroll to **Delete all**.
- Press the menu button.

Flash

If you subscribe to the combined Call Waiting/Call ID service from your local telephone company, you will receive Caller ID information if available. Call Waiting calls. During a phone call, you will hear a beep to indicate another call is waiting on the line and Caller ID information for the waiting call shows on the handset display.

NOTE: If the CID record does not include a name, **Enter name** shows in the display.

NOTE: Press the flash/exit button to return to the standby mode without deleting any CID records.

Intercom Operation

The intercom feature allows you to have a conversation with another registered handset without tying up the telephone line, allowing you to still receive incoming calls.

NOTE: The function is applicable only with additional handsets.

NOTE: The following procedures can ONLY be done with Model 2790X handset.

Handset to Handset Intercom Call

- Make sure the originating phone is OFF InT in talk mode.
- Press the menu button and use the cid/vol (V) or (V) button to scroll to **Intercom**.
- Press the menu button to enter the menu. **INT - NUMBER** shows on the display.
- Use the touch-tone pad to input the number of the handset you want to page. (For example, press 2 to page handset 1.)
- Press the menu button to show the current security code on the display.
- Use the number keys to enter your new 3-digit security code. The default setting is 2 2 3.
- Press menu button to save the setting.

Auto Talk

This option allows you to pick up the handset from base to answer an incoming call, or return to the base to answer the handset.

From the Setup HS Menu:

- Press the cid/vol (V) or (V) button to scroll to the **Auto Talk** sub-menu.
- Press menu button to enter the menu. Use the cid/vol (V) or (V) button to scroll to your selection. The default setting is On.
- Press the menu button to save your selection.

Handset Name

From the Setup HS Menu:

- Press the cid/vol (V) or (V) button to scroll to the **Handset name** sub-menu.
- Press menu button to enter the menu. The default setting is Handset.
- Use the Touch-tone pad to enter a name up to 13 characters. More than one letter is stored in each of the number keys. For example, to enter Bill Smith, press the 2 key twice for the letter B. Press the 4 key 3 times for the letter I. Press the 3 key 3 times for the letter T. Land press the 1 key to insert a space between the first and last name. Press the 4 key 4 times for the letter S. Press the 6 key once for the letter M. Press the 3 key 3 times for the letter T. Press the 8 key for the letter H. Repeat the 4 key twice for the letter H.

NOTE: If you make a mistake, press cid/vol (V) or (V) button to move the cursor forward or backward, then use the mute/clear button to backspace and delete one character at a time.

NOTE: * key is a function key to toggle between the upper case and low case of characters during text edit.

- Press the menu button to save your name. You will hear a confirmation tone on the handset display.

Base Station Setup

- Make sure your phone is OFF InT in talk mode.
- Press the menu button to go to the main menu.
- Press cid/vol (V) or (V) button to scroll to **Setup BS**
- Press menu button to confirm and you may program the following items: Area Code, Dial mode and BS Backlight.

Area Code

The telephone uses the pre-programmed area code to determine the number format to display when a valid Caller ID record is received. The pre-programmed area code is also used for the DiaBack feature.

From the Setup BS Menu:

- Press the cid/vol (V) or (V) button to scroll to the **Area code** sub-menu.
- Press menu button to enter the menu. **Enter area code** shows in the display.
- Use the touch-tone pad to enter your 3-digit area code.
- Press menu button to save the setting.

Dial Mode

From the Setup BS Menu:

- Press the cid/vol (V) or (V) button to scroll to the **Dial mode** sub-menu.
- Press menu button to enter the menu and use the cid/vol (V) or (V) button to select **Tone or Pulse**.
- Press menu button to save your selection.

BS Backlight

From the Setup BS Menu:

- Press the cid/vol (V) or (V) button to scroll to the **BS Backlight** sub-menu.
- Press menu button to enter the menu and use the cid/vol (V) or (V) button to select **On or Off**.
- Press menu button to save your selection.

Date/Time

Note: Time set on handset will be transferred to the base unit

For best results when recording, you should be about one inch from the microphone, and eliminate as much background noise as possible.

- Make sure the phone is OFF InT in talk mode.
- Press the menu button to go to the main menu and use cid/vol (V) or (V) button to scroll to **Date/Time**.
- Press menu button to enter the menu. **Year 2006** shows in the display.
- The Message Indicator lights when the answering system is on and off. The indicator blinks when you have new messages.

Time 12:00 shows in the display. Use the touch-tone pad to enter four digits for current time and use cid/vol (V) or (V) button to toggle between ":" (pm) and "am" time stamp.

- Press menu button to save the setting. Saved shows in the display.

Registration

Note: If you choose not to register, you should be about one inch from the microphone, and eliminate as much background noise as possible.

NOTE: If you choose not to record an outgoing announcement, a default announcement plays instead. To return to the default announcement after you have recorded your own outgoing announcement, press the **message counter** button and release it when you hear the beep. Or, press the delete button while the announcement is repeating.

NOTE: The maximum duration allowed for outgoing message is 2 minutes.

Deleting a Redial Record

- Make sure the phone is OFF InT in talk mode.
- Press the redial button first, then use the cid/vol (V) or (V) button to select the desired redial number.
- Press the menu button.
- Use the cid/vol (V) or (V) button to scroll to **Delete?**
- Press the menu button to delete the record showing in the display. **Confirm?** shows in the display.

Deleting All Redial Records

- Make sure the phone is OFF InT in talk mode.
- Use the cid/vol (V) or (V) button to scroll to **delete all**.
- Press the menu button.
- Use the cid/vol (V) or (V) button to scroll to **Delete all**.
- Press the menu button.

Call Timer

After you press the talk/call back button on the handset, the built-in call timer shows on the display and counts the length of time of the call in minutes and seconds.

Auto Standby

If you place the handset in the cradle while the handset is off the hook (during a call), the call is automatically disconnected.

Ringer On/Off

- Make sure the phone is OFF InT in talk mode.
- Press the mute/clear button to cancel and return to your phone conversation.

Flash

If you subscribe to the combined Call Waiting/Call ID service from your local telephone company, you will receive Caller ID information if available. Call Waiting calls. During a phone call, you will hear a beep to indicate another call is waiting on the line and Caller ID information for the waiting call shows on the handset display.

NOTE: If the CID record does not include a name, **Enter name** shows in the display.

NOTE: Press the flash/exit button to return to the standby mode without deleting any CID records.

Intercom Operation

The intercom feature allows you to have a conversation with another registered handset without tying up the telephone line, allowing you to still receive incoming calls.

NOTE: The function is applicable only with additional handsets.

NOTE: The following procedures can ONLY be done with Model 2790X handset.

Handset to Handset Intercom Call

- Make sure the originating phone is OFF InT in talk mode.
- Press the menu button and use the cid/vol (V) or (V) button to scroll to **Intercom**.
- Press the menu button to enter the menu. **INT - NUMBER** shows on the display.
- Use the touch-tone pad to input the number of the handset you want to page. (For example, press 2 to page handset 1.)
- Press the menu button to show the current security code on the display.
- Use the number keys to enter your new 3-digit security code. The default setting is 2 2 3.
- Press menu button to save the setting.

Telephone Operation

Charge/In Use Indicator on Base

The charge/in use indicator on the base will flash to alert you an incoming call, during paging, or registration. The indicator will remain lit when a handset is in the base charging or when the line is in use.

Making a Call

- Press the talk/call back button. Dial the desired number.
 - OR
 - Dial the number first, then press the talk/call back button.
- When finished, press the talk/call back button or put the handset back into the base cradle to hang up.

NOTE: If you want to delete the pre-dial number you entered, press the mute/clear button until all of the digits are erased.

Answering Calls

- When the phone rings, press the talk/call back button.
 - OR
 - Press the speaker button on the base.
- When finished, press the talk/call back button on handset or the speaker button on base, or put the handset back into the base cradle to hang up.

NOTE: If you have turned the Auto Talk function on, you can pick up the handset from the base to answer the incoming call without pressing any buttons.

NOTE: Adjust the handset volume by pressing the cid/vol (V) or (V) button during a call.

NOTE: If you press the speaker button to answer a call while the handset is not in the base cradle, the call will not end even when you place the handset back into the base cradle during the conversation.

Inserting a Pause in the Dialing Sequence

Press the square button twice to insert a digit in dialing sequence when a pause is required. Only 2 handsets and the base will be allowed in a telephone line conference. When the third handset tries to join the conference, Unavailable will be shown with error beeps. When a handset is in use (in talk mode), the other handsets will be shown as Unavailable in use (in talk mode), the other handsets will be shown as Unavailable in use (in talk mode).

Redial

To quickly redial a number you dialed:

- Make sure the phone is OFF InT in talk mode.
- Press the talk/call back button.
- Press the redial button first, then use the cid/vol (V) or (V) button to select the desired redial number.
- Press the menu button.

NOTE: You may choose from 10 last dialed numbers.

NOTE: Press the menu button. The number dials automatically.

Call Waiting Call ID

Provides you subscribe to Call Waiting Call ID service from your phone company, if you receive an incoming call and you are using the GE multi handset system, a beep indicates the presence of a Call Waiting call on the line. The Call Waiting Call ID information will be displayed and stored in the history of all handsets in the system.

When you hear the call waiting beep in the handset receiver, press the flash/exit button to put the current call on hold and answer the incoming call. Press flash/exit again to return to the original call.

Receiving CID Records

When you receive a call, the Caller ID information is transmitted between the first and second ring. The Caller ID information appears on the display while the phone rings, giving you a chance to monitor information and decide whether or not to answer the call.

Storing CID Records (In CID Memory)

If you are at home or cannot answer your telephone's Caller ID memory stores the data for the 30 most recent calls up to 20 digits and 15 characters for each record you received so you can see who called while you were unavailable. And the display shows **Not in CID Memory** when there are no unanswred calls. When the 31st call is received, the oldest Caller ID record (1st call) is automatically deleted.

Reviewing CID Records

As calls are received and stored, the display is updated to let you know how many calls have been received. To scroll CID records:

- Press the menu button.
- Press the cid/vol (V) or (V) button to scroll to **Save number**.
- Press the menu button.
- Press the menu button to enter edit mode. You may now change the name, if desired. Please refer to section "Handset Name" for name editing method.
- Enter name and press the flash/exit button to save the number.
- Press the menu button to save the setting. Saved shows in the display. Repeat steps 2 through 7 to save other records.

Deleting a Redial Record

- Make sure the phone is OFF InT in talk mode.
- Press the redial button first, then use the cid/vol (V) or (V) button to select the desired redial number.
- Press the menu button.
- Use the cid/vol (V) or (V) button to scroll to **Delete?**
- Press the menu button to delete the record showing in the display. **Confirm?** shows in the display.

Deleting All Redial Records

- Make sure the phone is OFF InT in talk mode.
- Use the cid/vol (V) or (V) button to scroll to **delete all**.
- Press the menu button.
- Use the cid/vol (V) or (V) button to scroll to **Delete all**.
- Press the menu button.

Formatting a CID Number Before Dialing

NOTE: If you are dialing an all have incoming caller's phone number is formatted when it is received, and (b) whether or not the number is pre-programmed your local area code into the set up menu, you may need to adjust the format of the incoming caller's stored phone number before making the call, press the format button to adjust the number, and try again.

Number of digits

Number of digits	Explanation	Example
Eleven digits	long distance code 1" + 3-digit area code + 7-digit telephone number	1-317-888-8888
Ten digits	3-digit area code + 7-digit telephone number	317-888-8888
Seven digits	7-digit telephone number	888-8888

Call Timer

After you press the talk/call back button on the handset, the built-in call timer shows on the display and counts the length of time of the call in minutes and seconds.

Auto Standby

If you place the handset in the cradle while the handset is off the hook (during a call), the call is automatically disconnected.

Ringer On/Off

- Make sure the phone is OFF InT in talk mode.
- Press the mute/clear button to cancel and return to your phone conversation.

Flash

If you subscribe to the combined Call Waiting/Call ID service from your local telephone company, you will receive Caller ID information if available. Call Waiting calls. During a phone call, you will hear a beep to indicate another call is waiting on the line and Caller ID information for the waiting call shows on the handset display.

NOTE: If the CID record does not include a name, **Enter name** shows in the display.

NOTE: Press the flash/exit button to return to the standby mode without deleting any CID records.

Intercom Operation

The intercom feature allows you to have a conversation with another registered handset without tying up the telephone line, allowing you to still receive incoming calls.

NOTE: The function is applicable only with additional handsets.

NOTE: The following procedures can ONLY be done with Model 2790X handset.

Handset to Handset Intercom Call

- Make sure the originating phone is OFF InT in talk mode.
- Press the menu button and use the cid/vol (V) or (V) button to scroll to **Intercom**.
- Press the menu button to enter the menu. **INT - NUMBER** shows on the display.
- Use the touch-tone pad to input the number of the handset you want to page. (For example, press 2 to page handset 1.)
- Press the menu button to show the current security code on the display.
- Use the number keys to enter your new 3-digit security code. The default setting is 2 2 3.
- Press menu button to save the setting.

PHONE BOOK

Each handset can store up to fifty 24-digit numbers with up to 15-character names in memory for quick dialing. The records are stored by alphabetic ascending order.

Adding Phone Book Entries

- Make sure the phone is OFF InT in talk mode.
- Press the menu button.
- Press the menu button and use the cid/vol (V) or (V) button to scroll **Add new**.
- Press the menu button. **Enter number** shows in the display.
- Use the touch-tone pad to input a telephone number.

TIP: Press the #pause button twice to insert a pause in a number if necessary.

Press the menu button. **Enter name** shows in the display. Please refer to section "Handset Name" for name editing method.

- Press the menu button to save.

NOTE: If Memory full shows in the display, you should delete one or more unnecessary records and repeat above steps to continue the call record storage.

Reviewing Phone Book Records

- Make sure the phone is OFF InT in talk mode.
- Press the # book button.
- Press the cid/vol (V) or (V) button to scroll through the records.
 - OR
 - Press the menu keys to go to the name of the records started with the corresponding character.

Deleting a Phone Book Record

- When reviewing the phone book records, use the cid/vol (V) or (V) button or the number keys to scroll to the desired record.
- Press menu button and use the cid/vol (V) or (V) button to scroll to **Edit**.
- Press menu button to enter edit mode. You may now change the number, if desired.
- Press menu button to proceed to name change. You may now change the name, if desired. Please refer to section "Handset Name" for name editing method.
- Press menu button to save.

Deleting a Phone Book Record

- When reviewing the phone book records list, use the cid/vol (V) or (V) button or the number keys to scroll to the desired record.
- Press menu button and use the cid/vol (V) or (V) button to scroll to **Delete?**
- Press menu button. **Confirm?** shows in the display.
- Press menu button to confirm. **Deleted** shows in the display.

Dialing a Phone Book

- Make sure the phone is ON in talk mode by pressing the talk/call back button.
- Press the # book button to access the phone book.
- Use the cid/vol (V) or (V) button or the number keys to scroll to the desired record.
- Press the menu button to dial the number.
 - OR
 - Use the touch-tone pad to dial the number.

Chain Dialing from Phone Book

Use this feature to make calls which require a sequence of numbers, such as a calling card number used for a frequently called long distance number. You can store each part of the dialing sequence such as Long Distance Access Number, Authorization Code, and a frequently called long distance number in the phone book and simply repeat 2 through 4 "Dial a phone book record while in talk mode" to dial them one by one.

ANSWERING SYSTEM OPERATION

This section discusses the buttons and features on the answering system.

Message Indicator

The message counter gives you a numeric display of how many messages you have and some other information of the answering system.

a) A number displayed without flashing -- No new messages. The number is the total number of all messages.

b) A flashing number displayed -- There are new messages. The number is the total number of all new messages.

c) Two bars -- display steadily -- Answerer's off.

d) A flashing on the display -- Answerer's on.

e) CL Flashing on the display -- Clock is not set since power up or after power failure.

f) Six horizontal bars flashing on the display -- MEMO is recording.

g) AL Flashing on the display -- The system is answering an incoming call and recording an incoming call.

h) LA display steady -- The answering system is being accessed remotely.

i) SP display steadily -- Base speaker is turned on.

NOTE: While the messages are playing, the message counter will display the messages in the order they were received.

NOTE: The maximum recording time for each message is 3 minutes.

Messages Playback

The message counter lets you know when you have message(s) or new message(s). To play the messages, press the play/stop button.

While a message is playing, you may do the following:

- Press the play/stop button to stop the message playback.
- Press and release the review

Free Manuals Download Website

<http://myh66.com>

<http://usermanuals.us>

<http://www.somanuals.com>

<http://www.4manuals.cc>

<http://www.manual-lib.com>

<http://www.404manual.com>

<http://www.luxmanual.com>

<http://aubethermostatmanual.com>

Golf course search by state

<http://golfingnear.com>

Email search by domain

<http://emailbydomain.com>

Auto manuals search

<http://auto.somanuals.com>

TV manuals search

<http://tv.somanuals.com>