

# Gateway *LT Series* Quick Guide

## Gateway *LT Series*

Copyright © 2009 All Rights Reserved.  
Gateway *LT Series* Quick Guide  
Original Issue: 04/2009

Series Notebook PC

Model number: \_\_\_\_\_

Serial number: \_\_\_\_\_

Date of purchase: \_\_\_\_\_

Place of purchase: \_\_\_\_\_

# Federal Communications Commission Declaration of Conformity

This device complies with Part 15 of the FCC Rules. Operation is subject to the following two conditions: (1) This device may not cause harmful interference, and (2) This device must accept any interference received, including interference that may cause undesired operation.

The following local manufacturer/importer is responsible for this declaration:

Product name:	Notebook PC
Model number:	ZA8
Machine type:	<i>LT Series</i>
SKU number:	<i>LT Series ("x" = 0 - 9, a - z, or A - Z)</i>
Name of responsible party:	Acer America Corporation
Address of responsible party:	333 West San Carlos St. San Jose, CA 95110 USA
Contact person:	Acer Representative
Tel:	1-254-298-4000
Fax:	1-254-298-4147

Gateway *LT Series*

# CE Declaration of Conformity

**We,**

Acer Incorporated  
8F, 88, Sec. 1, Hsin Tai Wu Rd., Hsichih, Taipei Hsien 221, Taiwan

Contact Person: Mr. Easy Lai

Tel: 886-2-8691-3089 Fax: 886-2-8691-3120

E-mail: [easy\\_lai@acer.com.tw](mailto:easy_lai@acer.com.tw)



Hereby declare that:

Product: Notebook	Trade name: Gateway
Model number: ZA8	Machine type: <i>LT</i>
SKU number: <i>LT Series-xxxxx</i> ("x" = 0 - 9, a - z, or A - Z)	

Is compliant with the essential requirements and other relevant provisions of the following EC directives, and that all the necessary steps have been taken and are in force to assure that production units of the same product will continue comply with the requirements.

EMC Directive 2004/108/EC as attested by conformity with the following harmonized standards:

- EN55022: 2006, AS/NZS CISPR22: 2006, Class B
- EN55024: 1998 + A1: 2001 + A2: 2003
- EN61000-3-2: 2006, Class D
- EN61000-3-3: 1995 + A1: 2001+A2: 2005

Low Voltage Directive 2006/95/EC as attested by conformity with the following harmonized standard:

- EN60950-1: 2001 + A11: 2004

RoHS Directive 2002/95/EC on the Restriction of the Use of certain Hazardous Substances in Electrical and Electronic Equipment

R&TTE Directive 1999/5/EC as attested by conformity with the following harmonized standard:

- Article 3.1(a) Health and Safety
  - EN60950-1:2001 + A11:2004
  - EN50371:2002
- Article 3.1(b) EMC
  - EN301 489-1 V1.6.1
  - EN301 489-3 V1.4.1 (Applicable to non-bluetooth wireless keyboard mouse set).
  - EN301 489-17 V1.2.1
- Article 3.2 Spectrum Usages
  - EN300 440-2 V1.1.2 (Applicable to non-bluetooth wireless keyboard mouse set).
  - EN300 328 V1.7.1
  - EN301 893 V1.4.1 (Applicable to 5GHz high performance RLAN).

Year to begin affixing CE marking 2009.

*Easy Lai*

---

Easy Lai /Manager  
Regulation Center, Acer Inc.

Feb. 20, 2009

---

Date

# Just for starters

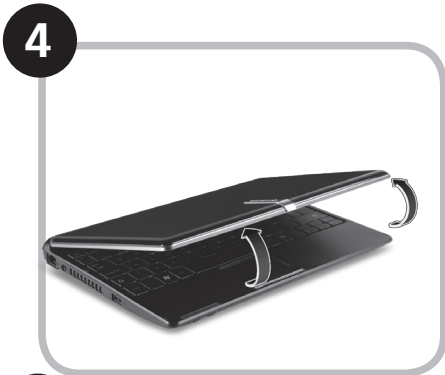
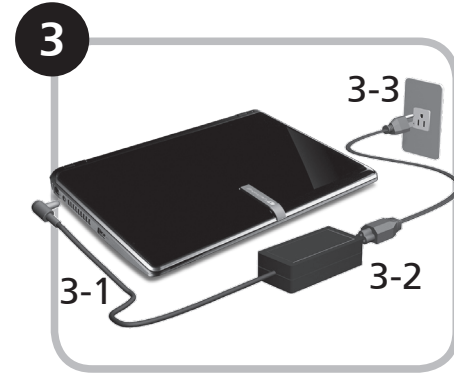
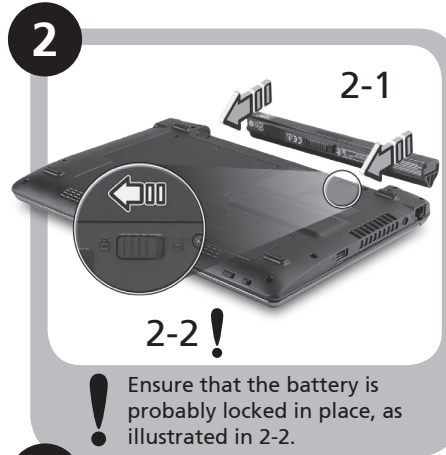
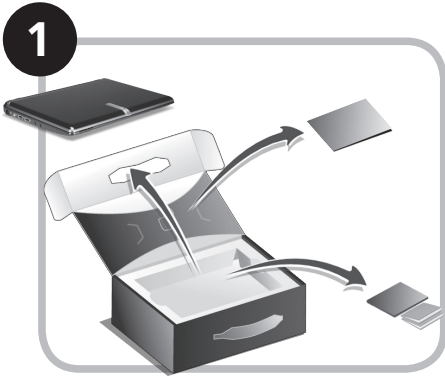

Illustrations are for reference only. Actual product specifications may vary.

# First things first

We would like to thank you for making a Gateway notebook your choice for meeting your mobile computing needs.

## Your guides

To help you use your Gateway notebook, we have designed a set of guides\*:

First off, the Quick Guide helps you get started with setting up your computer.

For more on how your computer can help you to be more productive, please refer to the Gateway System User Guide. This guide contains detailed information on such subjects as system utilities, data recovery, expansion options and troubleshooting. In addition it contains warranty information and the general regulations and safety notices for your notebook. It is available in Portable Document Format (PDF) and comes preloaded on your notebook.



-----  
Note: Viewing the file requires Adobe Reader. If Adobe Reader is not installed on your computer, clicking on GatewaySystem User Guide will run the Adobe Reader setup program first. Follow the instructions on the screen to complete the installation. For instructions on how to use Adobe Reader, access the Help and Support menu.



-----  
**\* IMPORTANT NOTICE:** Please note that the guides mentioned herein, whether in printed or electronic form, are for your reference only and except as provided in the specific warranty information contained in the Gateway System User Guide nothing contained in these guides shall constitute a representation or warranty by Gateway with regard to the product you purchased. Gateway expressly disclaims any liability for errors contained in the guides.

# Network configuration

This guide will help you configure your LAN and wireless network settings to enable you to connect to the Internet.

## Setting up LAN connection

Simply plug in the LAN cable to the Ethernet (RJ-45) port. Please refer to "Left view" on page 10 for the location of the Ethernet port.

## Setting up wireless connection

1. Please turn on the wireless LAN using the switch on the front of your *Gateway LT series*.
2. Click the  icon on your system tray and choose the wireless access point you want to connect to.



## Insert a 3G SIM card (only for certain models)

Remove the battery and carefully insert a 3G SIM card into the 3G SIM card slot. Please refer to "Base view" on page 11 for the location of the 3G SIM card slot.





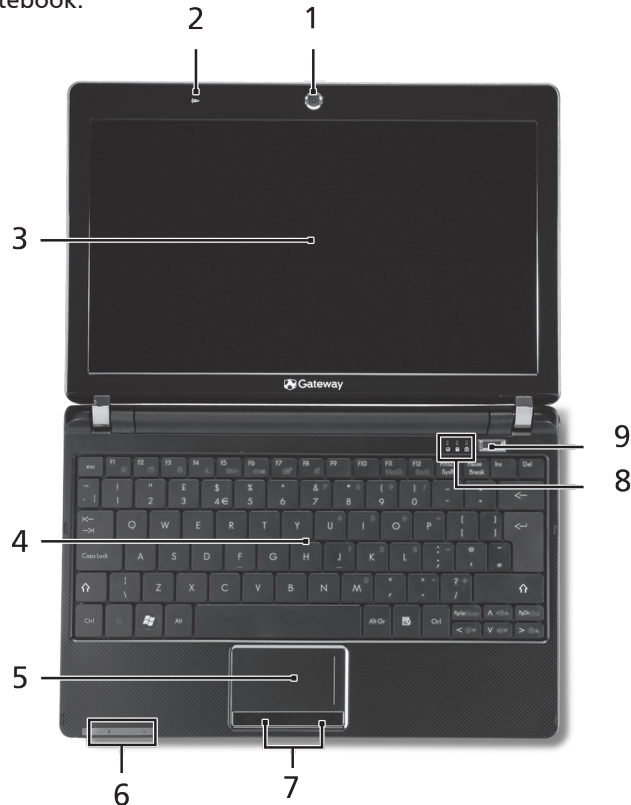

## Your *LT Series* tour

After setting up your computer as illustrated in the Just for Starters section, let us show you around your new Gateway notebook.



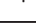

### Top view



#	Icon	Item	Description
1		Webcam	Web camera for video communication
2	⌂	Microphone	Internal microphone for sound recording.
3		Display screen	Also called Liquid-Crystal Display (LCD), displays computer output.
4		Keyboard	For entering data into your computer.
5		Touchpad	Touch-sensitive pointing device which functions like a computer mouse.
6	    	Battery/ Bluetooth/3G/ Wireless LAN communication indicator	Indicates the status of Battery/ Bluetooth/3G/Wireless LAN communication. (only for certain models)
7		Click buttons (left, and right)	The left and right buttons function like the left and right mouse buttons.
8		Status indicators	Light-Emitting Diodes (LED) that light up to show the status of the computer's functions and components.
9		Power button/ indicator	Turns the computer on and off.

## Gateway LT Series







### Closed front view

#	Icon	Item	Description
1		Bluetooth communication switch	Enables/disables the Bluetooth function.
2		3G/Wireless LAN communication switch	Enables/disables the 3G/Wireless LAN function.

### Left view

3		Ethernet (RJ-45) port	Connects to an Ethernet 10/100-based network.
4		DC-in jack	Connects to an AC adapter.
5		USB 2.0 port	Connects to USB 2.0 devices (e.g., USB mouse).

### Right view

6		Multi-in-one card reader	Accepts Secure Digital (SD), MultiMediaCard (MMC), Memory Stick (MS), Memory Stick PRO (MS PRO), xD-Picture Card (xD). Note: Push to remove/install the card. Only one card can operate at any given time.
7		Headphone/speaker/line-out jack	Connects to line-out audio devices (e.g., speakers, headphones).
8		Microphone-in jack	Accepts input from external microphones.
9		USB 2.0 port	Connects to USB 2.0 devices (e.g., USB mouse).
10		Kensington lock slot	Connects to a Kensington-compatible computer security lock.
11		External display (VGA) port	Connects to a display device (e.g., external monitor, LCD projector).

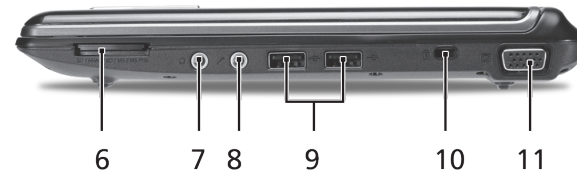
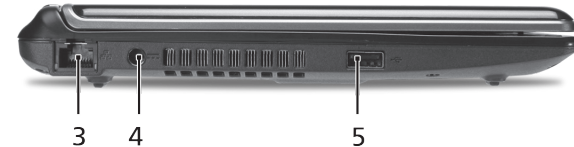

### Rear & Base view

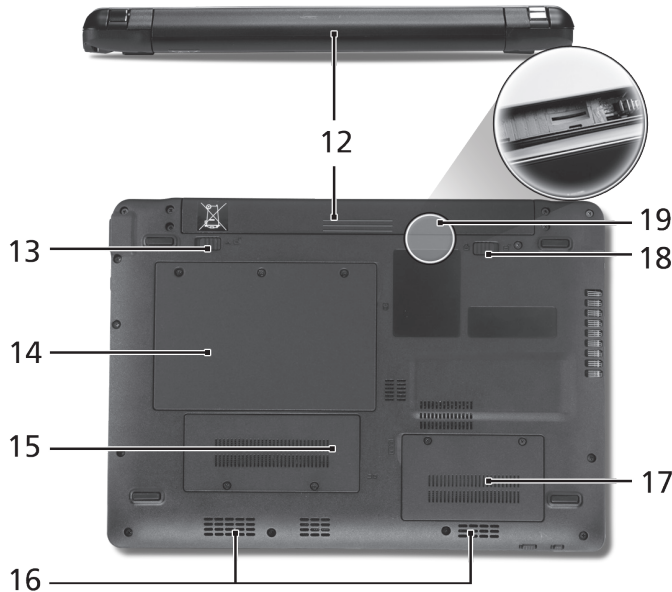

#	Icon	Item	Description
12		Battery bay	Houses the computer's battery pack. Note: The battery shown is for reference only. Your PC may have a different battery, depending on the model purchased.
13		Battery release latch	Releases the battery for removal.
14		Hard disk bay	Houses the computer's hard disk (secured with screws).
15		3G module bay	Houses the computer's 3G communication module.
16		Ventilation slots and/or cooling fan	Enables the computer to stay cool, even after prolonged use. Note: Do not cover or obstruct the opening of the fan.
17		Memory compartment	Houses the computer's main memory.
18		Battery lock	Locks the battery in position.
19		3G SIM card slot	Accepts a 3G SIM card for 3G connectivity. Note: Insert a 3G SIM card to enable 3G communication. The SIM card connectors need to face away from the cover. (Only for certain models)

## *Gamme Gateway LT*

Copyright © 2009 Tous droits réservés.  
Guide rapide de la gamme *Gateway LT*  
Première publication : 04/2009

Ordinateur bloc-notes de la gamme *Gateway LT*

No. de modèle : \_\_\_\_\_

No. de série : \_\_\_\_\_

Date d'achat : \_\_\_\_\_

Lieu d'achat : \_\_\_\_\_

# Federal Communications Commission Declaration of Conformity

This device complies with Part 15 of the FCC Rules. Operation is subject to the following two conditions: (1) This device may not cause harmful interference, and (2) This device must accept any interference received, including interference that may cause undesired operation.

The following local manufacturer/importer is responsible for this declaration:

Product name:	Notebook PC
Model number:	ZA8
Machine type:	<i>LT Series</i>
SKU number:	<i>LT Series ("x" = 0 - 9, a - z, or A - Z)</i>
Name of responsible party:	Acer America Corporation
Address of responsible party:	333 West San Carlos St. San Jose, CA 95110 USA
Contact person:	Acer Representative
Tel:	1-254-298-4000
Fax:	1-254-298-4147

Gamme Gateway LT

# CE Declaration of Conformity

We,

Acer Incorporated  
8F, 88, Sec. 1, Hsin Tai Wu Rd., Hsichih, Taipei Hsien 221, Taiwan

Contact Person: Mr. Easy Lai

Tel: 886-2-8691-3089 Fax: 886-2-8691-3120

E-mail: [easy\\_lai@acer.com.tw](mailto:easy_lai@acer.com.tw)



Hereby declare that:

Product: Notebook	Trade name: Gateway
Model number: ZA8	Machine type: LT
SKU number: <i>LT Series-xxxxx</i> ("x" = 0 - 9, a - z, or A - Z)	

Is compliant with the essential requirements and other relevant provisions of the following EC directives, and that all the necessary steps have been taken and are in force to assure that production units of the same product will continue comply with the requirements.

EMC Directive 2004/108/EC as attested by conformity with the following harmonized standards:

- EN55022: 2006, AS/NZS CISPR22: 2006, Class B
- EN55024: 1998 + A1: 2001 + A2: 2003
- EN61000-3-2: 2006, Class D
- EN61000-3-3: 1995 + A1: 2001+A2: 2005

Low Voltage Directive 2006/95/EC as attested by conformity with the following harmonized standard:

- EN60950-1: 2001 + A11: 2004

RoHS Directive 2002/95/EC on the Restriction of the Use of certain Hazardous Substances in Electrical and Electronic Equipment

R&TTE Directive 1999/5/EC as attested by conformity with the following harmonized standard:

- Article 3.1(a) Health and Safety
  - EN60950-1:2001 + A11:2004
  - EN50371:2002
- Article 3.1(b) EMC
  - EN301 489-1 V1.6.1
  - EN301 489-3 V1.4.1 (Applicable to non-bluetooth wireless keyboard mouse set).
  - EN301 489-17 V1.2.1
- Article 3.2 Spectrum Usages
  - EN300 440-2 V1.1.2 (Applicable to non-bluetooth wireless keyboard mouse set).
  - EN300 328 V1.7.1
  - EN301 893 V1.4.1 (Applicable to 5GHz high performance RLAN).

Year to begin affixing CE marking 2009.

*Easy Lai*

Easy Lai /Manager  
Regulation Center, Acer Inc.

Feb. 20, 2009

Date

## Pour partir du bon pied

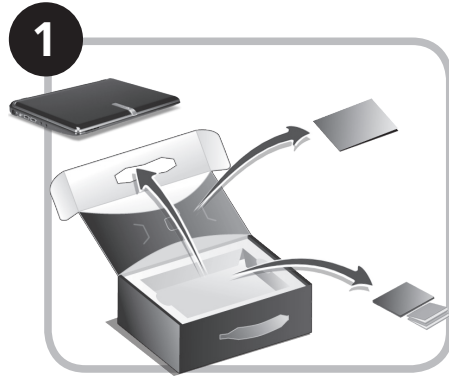

! Assurez que la pile est probablement verrouillée en place, comme illustré à 2-2.

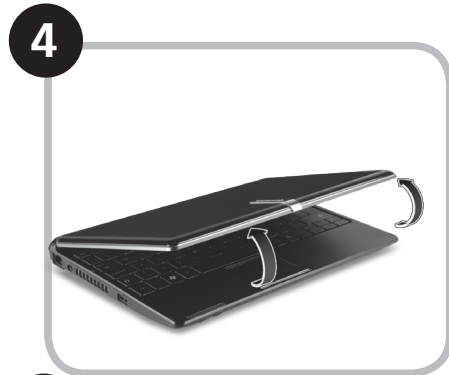
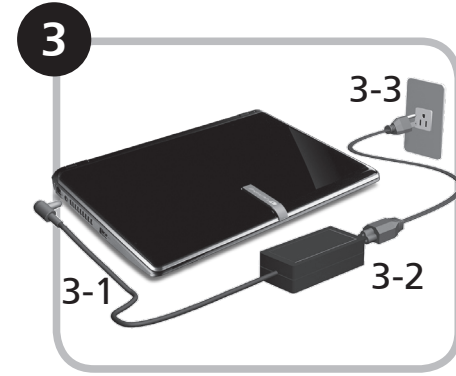

Les illustrations sont pour référence seulement. Les caractéristiques réelles des produits peuvent changer.



## Pour commencer

Nous désirons vous remercier d'avoir fait d'un bloc-notes Gateway votre choix pour répondre à vos besoins informatiques mobiles.

### Vos guides

Pour vous aider à utiliser votre bloc-notes Gateway, nous avons conçu plusieurs guides\* :

Tout d'abord, le Guide rapide vous aide à configurer votre ordinateur.

Pour plus d'information sur l'aide que votre ordinateur peut vous apporter pour être plus productif, veuillez vous reporter au Gateway System User Guide. Ce guide contient des informations détaillées sur des sujets tels que les utilitaires systèmes, la récupération des données, les options d'extension et le dépannage. De plus, il contient des informations de garantie et les réglementations générales et les avis de sécurité pour votre bloc-notes. Il est disponible au format PDF (Portable Document Format) et est préchargé sur votre bloc-notes.



-----  
Remarque : L'affichage du fichier nécessite Adobe Reader. Si Adobe Reader n'est pas installé dans votre ordinateur, le clic sur Gateway System User Guide va exécuter le programme d'installation d'Adobe Reader. Suivez les instructions à l'écran pour terminer l'installation. Pour des instructions sur l'utilisation de Adobe Reader, accédez au menu Aide et Support.



-----  
**\* AVIS IMPORTANT : Veuillez noter que les guides mentionnés ici, que ce soit imprimés ou au format électronique, sont pour votre référence seulement et à l'exception de ce qui est indiqué dans les informations spécifiques à la garantie contenue dans le Gateway System User Guide, rien de ce qui est contenu dans ces guides ne constitue une déclaration ou garantie par Gateway en ce qui concerne le produit que vous avez acheté. Gateway rejette expressément toute responsabilité pour les erreurs contenues dans les guides.**

*Gamme Gateway LT*

## Configuration réseau

Ce guide vous aide à configurer les paramètres de votre réseau local et de votre réseau sans-fil pour pouvoir vous connecter à Internet.

### Configurer la connexion réseau

Branchez simplement le câble réseau dans le port Ethernet RJ-45. Veuillez vous reporter « **Vue gauche** » à la page 10 pour l'emplacement du port Ethernet.

### Configurer la connexion sans-fil

1. Veuillez activer le réseau sans-fil en utilisant le commutateur à l'avant de votre *Gamme Gateway LT*.
2. Cliquez sur l'icône  sur votre barre des tâches et choisissez le point d'accès sans-fil auquel vous souhaitez vous connecter.



### Insérer une carte SIM 3G (seulement pour certains modèles)

Retirez la pile et insérez avec soin une carte SIM 3G dans la fente de carte SIM 3G. Veuillez consulter « **Vue de la base** » à la page 11 pour l'emplacement de la fente de carte SIM 3G.

## Visite guidée de votre ordinateur de la gamme LT

Après avoir configuré votre ordinateur comme illustré la section Pour partir du bon pied, nous allons vous faire explorer votre nouveau bloc-notes Gateway.

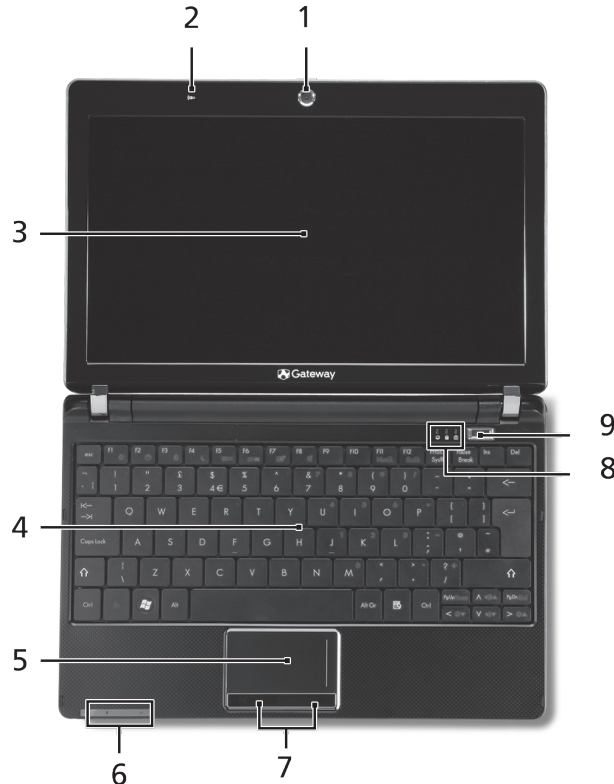



### Vue supérieure



#	Icône	Élément	Description
1		Webcaméra	Webcaméra pour communication vidéo.
2	☞	Microphone	Microphone interne pour l'enregistrement sonore.
3		Écran d'affichage	Également appelé affichage à cristaux liquides (ACL), affiche les données de l'ordinateur.
4		Clavier	Pour l'entrée des informations dans votre ordinateur.
5		Pavé tactile	Périphérique de pointage sensible au touché qui fonctionne comme une souris.
6	🔋 📶 📶 📶	Indicateur de batterie/ Bluetooth/3G/ communication réseau sans fil	Indique l'état de la de communication batterie/ Bluetooth/3G/réseau sans fil (seulement pour certains modèles).
7		Boutons (gauche et droit)	Le bouton gauche et le bouton droit fonctionnent comme le bouton gauche et le bouton droit d'une souris.
8		Indicateurs d'état	Diodes électroluminescentes (DEL) qui s'allume pour indiquer l'état des fonctions et composants de l'ordinateur.
9		Bouton/Indicateur d'alimentation	Met l'ordinateur sous tension et hors tension.

## Gamme Gateway LT









### Vue frontale fermée

#	Icône	Élément	Description
1		Commutateur de communication Bluetooth	Active/désactive la fonction Bluetooth.
2	 	Commutateur de communication 3G/réseau sans fil	Active/désactive la fonction 3G/communication réseau sans fil.

### Vue gauche

3		Port Ethernet RJ-45	Se connecte à un réseau Ethernet 10/100 Base.
4		Prise d'entrée c.c.	Se connecte à l'adaptateur c.a.
5		Port USB 2.0	Se connecte à des périphériques USB 2.0 (p.ex. une souris USB).

### Vue droite

6	   	Lecteur de cartes multiples en un	Accepte une carte mémoire Secure Digital (SD), MultiMediaCard (MMC), Memory Stick (MS), Memory Stick Pro (MS PRO), et xD-Picture (xD). Remarque : Poussez pour retirer/installer la carte. Seule une carte peut fonctionner à un moment donné.
7		Prise de sortie audio/haut-parleurs/casque d'écoute	Se connecte à des périphériques audio en sortie (p.ex. haut-parleurs ou un casque stéréo).
8		Prise d'entrée microphone	Accepte l'entrée des microphones externes.
9		Port USB 2.0	Se connecte à des périphériques USB 2.0 (p.ex. une souris USB).
10		Fente pour cadenas Kensington	Se connecte à un cadenas de sécurité pour ordinateur Kensington.
11		Port d'affichage (VGA) externe	Se connecte à un périphérique d'affichage (p.ex. un moniteur externe, un projecteur ACL).

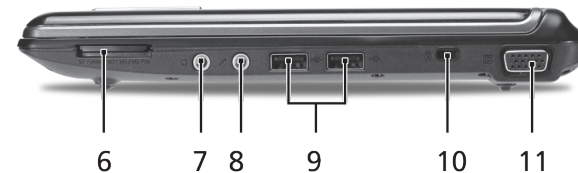
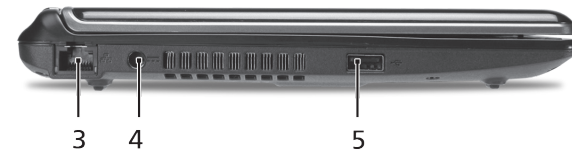

## Vue arrière et Vue de la base

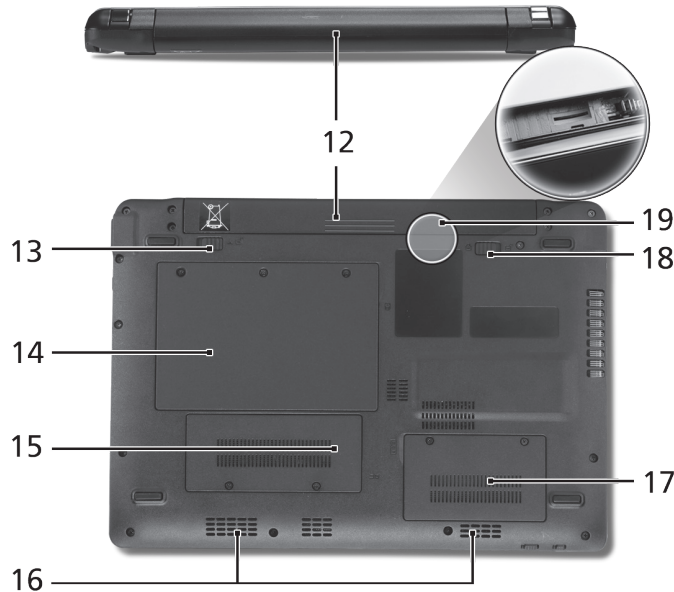

#	Icône Élément	Description
12	Baie de la pile	Contient la pile de l'ordinateur. Remarque : La pile présentée est pour référence seulement. Votre ordinateur peut avoir une pile différente, selon le modèle acheté.
13	Loquet de libération de la pile	Libère la pile pour le retrait.
14	Baie du disque dur	Contient le disque dur de l'ordinateur (fixé avec des vis).
15	Baie du module 3G	Contient le module communication 3G de l'ordinateur.
16	Fentes de ventilation et/ou ventilateur de refroidissement	Permettent à l'ordinateur de rester froid, même après une longue utilisation. Remarque : Ne couvrez pas et ne bloquez pas l'ouverture du ventilateur.
17	Compartiment mémoire	Contient la mémoire principale de l'ordinateur.
18	Verrou de la pile	Verrouille la pile en position.
19	Fente de carte SIM 3G	Accepte une carte SIM 3G pour la connectivité 3G. Remarque : Insérer une carte SIM 3G pour permettre la communication 3G. Les connecteurs de la carte SIM doivent être tournés à l'opposé du couvercle (Seulement pour certains modèles).

## Free Manuals Download Website

<http://myh66.com>

<http://usermanuals.us>

<http://www.somanuals.com>

<http://www.4manuals.cc>

<http://www.manual-lib.com>

<http://www.404manual.com>

<http://www.luxmanual.com>

<http://aubethermostatmanual.com>

Golf course search by state

<http://golfingnear.com>

Email search by domain

<http://emailbydomain.com>

Auto manuals search

<http://auto.somanuals.com>

TV manuals search

<http://tv.somanuals.com>