

Alarm sounds
and siren
for two hours
after tamper
switch is
activated

3
Senses tamper
on control panel

2
Senses alarm
on base

1
Senses alarm
on base

Alerts also detect
heat from fire

UL approved
sensor also detects
flame

Photoelectric sensor
detects smoke

SmartSecurity™
System

Add up to 24 sensors



500 FT. RANGE

Smoke Alarm

for SmartSecurity™ Systems



S N O I L O T O S O T O H E S O D H S S E T I O N S
W I R E L E S S H O U S E H O L D S O L U T I O N S



Smoke Alarm

for SmartSecurity™ Systems



Model No. 78213671041
FOR INDOOR
USE ONLY

SEE INSIDE FLAP FOR COMPLETE INSTRUCTIONS

* Functional range may be adversely affected by one or more of the following factors: weather, radio frequency interference, low transmitter battery and obstructions between the transmitter and receiver.

Questions? Call 1-800-443-4124 or visit us at www.GESmartHome.com

For replacement call 1-800-443-4124.
For servicing, send to: GE Interlogix, Inc., 12345 SW Leveton Dr., Tualatin, OR 97062

Made in USA

DESC: GEWSECMD-D

8-398

8-407

NOTE: For complete installation and programming instructions refer to the Owner's Manual included with your security system kit.

Overview

The Smoke Alarm is wireless and battery powered. Alarm includes a built-in siren for alarm alerts and a visual status light. Alarm works as part of a security/fire alarm system and communicates with control panel.

Under normal (non-alarm) conditions, light flashes once every 9 seconds while alarm monitors surrounding conditions. When alarm detects a smoke or fire condition or a sudden rise in temperature, light changes from flashing to on and built-in siren produces a loud beeping pattern. Alarm also transmits an alarm signal, which panel receives and processes accordingly.

The smoke alarm provides the following features:

- Self-diagnostics—smoke alarm monitors its own sensitivity and operational status.
- Base tamper switch—sends a tamper signal transmission to control panel when smoke alarm is removed from mounting base.
- Integrated fixed 135°F temperature and rate-of-rise heat detector—activates an alarm based on high temperature detected or rapidly rising temperature rate (15° Fahrenheit minimum).

Programming

1. Separate alarm from mounting base by turning alarm counter clockwise about 15 degrees. Alarm should snap off of mounting base.
2. Slide battery cover toward the edge to unstrap it, then lift off.
3. Insert two 3V lithium batteries, following + and - markings in bottom of battery compartment and replace cover.
4. Attach alarm to mounting base by lining up alignment tab on alarm with alignment arrow on mounting base then put alarm on base and turn it clockwise about 15 degrees. Alarm should snap into place.
5. Make sure system is disarmed.
6. Open control panel cover and enter your Master Code.
7. Press **ADD**.
8. Press **Sensor/Remote** button on control panel.
9. Control panel announces "Press button on sensor."
10. Control panel announces "Keychain Remote."
11. Press sensor again or press **DONE** to select.
12. Press **Sensor/Remote** button on control panel repeatedly until you hear desired location name for smoke alarm.
13. Press **DONE** button on control panel twice.
14. Loosen mounting base removal and control panel door open for testing.

Testing

Before mounting, verify that desired alarm location provides good RF communication to control panel. Sensor test should be performed weekly.

1. Press **TEST** on control panel.
2. Press **DONE** on control panel.
3. Take smoke alarm to desired mounting location.
4. Press and hold smoke alarm **Test/Silence** button for 4 seconds. Control panel should announce smoke alarm sensor number and location name, followed by "Activated, status is 'numbers'."
5. Close control panel cover.

Selecting a Location

Selecting a suitable location is critical to the operation of smoke alarms. This equipment should be installed in accordance with the National Fire Protection Associations (NFPA) Standard 72. See figures 3 and 4.

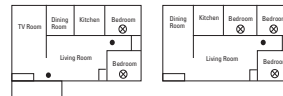

figure 3

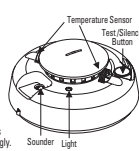

figure 4

A-8-12.1.a Locating Required Smoke Alarms in Existing Construction

The major threat from fire in a family living unit occurs at night when everyone is asleep. The principal threat to persons in sleeping areas comes from fires in the remainder of the unit. Therefore, a smoke alarm(s) is best located between the bedroom area and the rest of the unit. In units with only one bedroom area on one floor, the smoke alarm(s) should be located as shown above. In family living units with more than one bedroom area or with more than one floor, more than one smoke alarm is required as shown above. In addition to smoke alarms outside of the sleeping areas, the installation of a smoke alarm on each additional story of the family living unit, including the basement, is required as shown in figure 4. The living area smoke alarm should be installed in the living room or near the stairway to the upper level, or in both locations. The basement smoke alarm should be installed in close proximity to the stairway leading to the floor above. Where installed on an open-joint ceiling, the alarm should be placed on the bottom of the joists. The alarm should be positioned relative to the stairway to intercept smoke coming from a fire in the basement before the smoke enters the stairway.

A-8-12.1.b Locating Required Smoke Alarms in New Construction

All of the smoke alarms specified in A-8-12.1.a for existing construction are required and, in addition, a smoke alarm is required in each bedroom.

A-8-12.1.c Are More Smoke Alarms Desirable?

The required number of smoke alarms might not provide reliable early warning protection for those areas separated by a door from the areas protected by the required smoke alarms. For this reason, it is recommended that the householder consider the use of additional smoke alarms for those areas for increased protection.

The additional areas include the basement, bedrooms, dining room, furnace room, utility room, and hallways not protected by the required smoke alarms.

The installation of smoke alarms in kitchens, attics (finished or unfinished), or garages is not normally recommended, as these locations occasionally experience conditions that can result in improper operation. Since regulations pertaining to smoke alarm/detector installation vary from state to state, contact the authority having jurisdiction (AHJ). Where public safety is primary, the AHJ may be a federal, state, local, or other regional department or individual such as a fire chief, fire marshal, chief of a fire prevention bureau, labor or health department, building official, electrical inspector, or others having statutory authority. For insurance purposes, contact your insurance company, rating bureau, or other insurance company representative may be the AHJ. In some cases, the property owner or their designated agent assumes the role of the AHJ. At government installations, the commanding officer or department official may be the AHJ.

General Guidelines

- Before mounting alarms, program them into control panel and perform a sensor test from the alarm's intended location, to ensure good RF communication to control panel.
- Locate alarm in environmentally controlled areas where temperature range is between 40° and 100° F (4° and 37.8° C) and humidity is between 0 and 95% noncondensing.
- Locate alarms away from ventilation sources that can prevent smoke from reaching alarm.
- Locate ceiling mounted alarms in center of room or hallway, at least 4 inches (10cm) away from any walls or partitions.
- Locate wall mounted alarms so top of the alarm is 4 to 12 inches (10 to 31cm) below ceiling.
- In rooms with sloped, peaked, or gabled ceilings, locate alarms 3 feet (93cm) down or away from highest point of the ceiling.
- When mounting to suspended ceiling tile, tile must be secured with appropriate fastener to prevent tile removal.

NOTE: Do not mount alarm to the metal runners of suspended ceiling grids. The metal runners can draw the magnetic field away from the tamper switch, causing a false tamper alarm.

The alarm transmits a trouble signal when the alarm is too sensitive.

Call 1-800-443-4124 if this happens.

When to Replace the Batteries

When battery voltage gets low, alarm transmits a low battery signal for control panel to receive. If batteries are not replaced within seven days, the built-in siren emits a short beep or chirp every 45 seconds. Alarm chirps can be silenced for 24 hours by pressing the **Test/Silence** button. Batteries should be replaced as soon as possible.

Replacing the Batteries

1. Remove alarm from mounting base.
2. Remove battery cover.
3. Remove batteries and dispose of them in accordance with your local laws.
4. Insert two new 3V lithium batteries, following + and - markings in the bottom of battery compartment and replace cover.
5. Reattach alarm to mounting base.
6. Test system.

Fire Prevention and Escape

The purpose of an early warning smoke alarm is to detect the presence of fire in its early stages and sound an alarm giving the occupants time to exit the premises safely.

Avail Fire Hazards

Fire detection devices can protect life in all situations. Therefore, safeguards should be taken to avoid potentially dangerous situations as follows:

- Do not smoke in bed.
- Do not leave children home alone.
- Never clean with flammable liquids such as gasoline.
- Properly store materials. Use general good housekeeping techniques to keep your home neat and tidy. A cluttered basement, attic, or other storage area is an open invitation to fire.
- Use combustible materials and electrical appliances carefully and only for their intended uses. Do not overload electrical outlets.
- Do not store explosive and/or fast burning materials in your home.
- Even after proper precautions have been taken, fires can start. Be prepared.

In Case of Fire

- In the event of a fire, you should do the following:
 - Leave immediately. Do not stop to pack or search for valuables.
 - In heavy smoke, hold your breath and stay low, crawl if necessary. The cleanest air is usually near the floor.
 - If you have to go through a closed door, carefully feel the door and door knob to see if undue heat is present. If they seem cool, brace your foot against the bottom of the door with your hip against the door and one hand against the top. Open it slightly. If a rush of hot air is felt, slam the door quickly and latch it. Unvented fire tends to build up considerable pressure. Be sure all members of the household realize and understand this danger.
 - Use your neighbor's phone or a street fire alarm box to call the fire department. The job of extinguishing the fire should be left to the professionals.

Be Prepared

- Practice the following steps to prepare you and your family in the event of a fire:
 - Perform fire drills regularly. Use them to assure recognition of an alarm signal.
 - Draw a floor plan and show two exits from each room. It is important that children be instructed carefully, because they tend to hide in times of crisis.
 - Establish one meeting place outside the home. Insist that everyone meet there during an alarm. This will eliminate the tragedy of someone re-entering the house for a missing member who is actually safe.
 - If you have children and/or physically challenged people residing in your household, use window decals to help emergency personnel identify the sleeping quarters of these individuals.

WARNING!
The alarm cannot provide warnings for fires resulting from:

- explosions
- smoking in bed or other furniture
- ignition of flammable liquids, vapors, or gases
- children playing with matches or fire

Questions? Call 1-800-443-4124 or visit us at www.GESmartHome.com

For replacement call 1-800-443-4124.

For servicing, send to: GE Interlogix, Inc., 12345 SW Leveton Dr., Tualatin, OR 97062

Installation Instructions 466-2045 Rev. A Made in USA

DESC: GEWSECMD-D

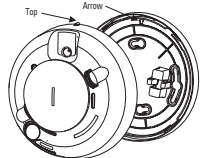

Free Manuals Download Website

<http://myh66.com>

<http://usermanuals.us>

<http://www.somanuals.com>

<http://www.4manuals.cc>

<http://www.manual-lib.com>

<http://www.404manual.com>

<http://www.luxmanual.com>

<http://aubethermostatmanual.com>

Golf course search by state

<http://golfingnear.com>

Email search by domain

<http://emailbydomain.com>

Auto manuals search

<http://auto.somanuals.com>

TV manuals search

<http://tv.somanuals.com>