

ALSO FROM IFB



MICROWAVE OVEN
CAPACITY - 17 to 30 LITERS



CLOTHES DRYER
CAPACITY - 5.5KG



DISHWASHER
CAPACITY - 12 PLACE SETTING

IFB

Advancing the science of washing

ELENA /ELENA EX

IFB

**Customer Care
Dial**

1860 425 5678 - BSNL & MTNL Callers

3900 4321 - Other Callers

or email

customerservice@ifbglobal.com

OPERATING MANUAL

USE ONLY GENUINE IFB SPARES & ACCESSORIES

** Company shall not be responsible for defects arising due to usage of spurious parts and accessories*

IFB Industries Limited, Plot No. IND - 5, Sector - 1, East Calcutta Township, Calcutta - 700 078
Visit us at www.ifbappliances.com

Dear Customer

A warm welcome to the international family of IFB 'tumble wash' technology based washing machine owners.

Your washing machine, is truly going to be your freedom machine. It requires just 30 seconds of your time in loading the fabrics and setting the programme.

Thereafter, you are totally free to do what you please. This washing machine does not need your supervision anymore. This washing machine is modelled on the unique 'tumble wash' concept for superior fabric care and wash performances.

As you read this manual you will understand what this washing machine can do for you.

For any further information, please contact your nearest dealer or IFB's Service Centre.



Chief Executive

SERVICE STATION COPY

MODEL : ELENA / ELENA EX SR. NO. WT ELN B/ WT ELNEX B _____

DEALER'S NAME : _____

CUSTOMER'S NAME : _____

ADDRESS : _____

PIN CODE : _____

TEL. NO. (Resi.) _____ (Off.) _____

E-MAIL : _____

MOTOR SR. NO. : _____

DATE OF PURCHASE : _____

INSTALL THE MACHINE, ONLY IF EARTHING IS PROPER

I OWN THE FOLLOWING PRODUCTS: (Please tick in the box)

COLOUR TV REFRIGERATOR AIR CONDITIONER

DISH WASHER MICROWAVE OVEN CLOTHES DRYER

FRANCHISEE ATTACHED: _____

CONTENTS

KNOW YOUR MACHINE	6
INSTALLATION	7
<input type="checkbox"/> Pre Installation	
<input type="checkbox"/> Unpacking	
<input type="checkbox"/> Setting Up	
<input type="checkbox"/> Water Inlet	
<input type="checkbox"/> Water Outlet	
<input type="checkbox"/> Electrical Connection	
USING YOUR MACHINE	11
<input type="checkbox"/> Control Panel	
<input type="checkbox"/> Environmental protection / conservation issues	
<input type="checkbox"/> Before using your machine for the first time	
<input type="checkbox"/> Automatic Detergent Dispenser Tray	
<input type="checkbox"/> Selector Buttons	
<input type="checkbox"/> Programme Selector Knob	
<input type="checkbox"/> Programme Selection	
<input type="checkbox"/> Programme Selection Chart	
OPERATION	16
<input type="checkbox"/> Sorting of Garments	
<input type="checkbox"/> Loading the Machine	
<input type="checkbox"/> Detergent to be used and Quantity	
<input type="checkbox"/> Treatment of Stains	
<input type="checkbox"/> Wash Load Guide	
<input type="checkbox"/> International Washing Symbols	
<input type="checkbox"/> Programme Run	
<input type="checkbox"/> Switching Off the Machine	
<input type="checkbox"/> Check Points	
MAINTENANCE	22
<input type="checkbox"/> Fluff Filters	
<input type="checkbox"/> Drum	
<input type="checkbox"/> Sieves	
<input type="checkbox"/> Frost Protection	
<input type="checkbox"/> Draining During Emergencies	
FAULT DIAGNOSIS	25
<input type="checkbox"/> Why does it happen?	
SAFETY PRECAUTIONS	26
TECHNICAL DATA	28

KNOW YOUR MACHINE

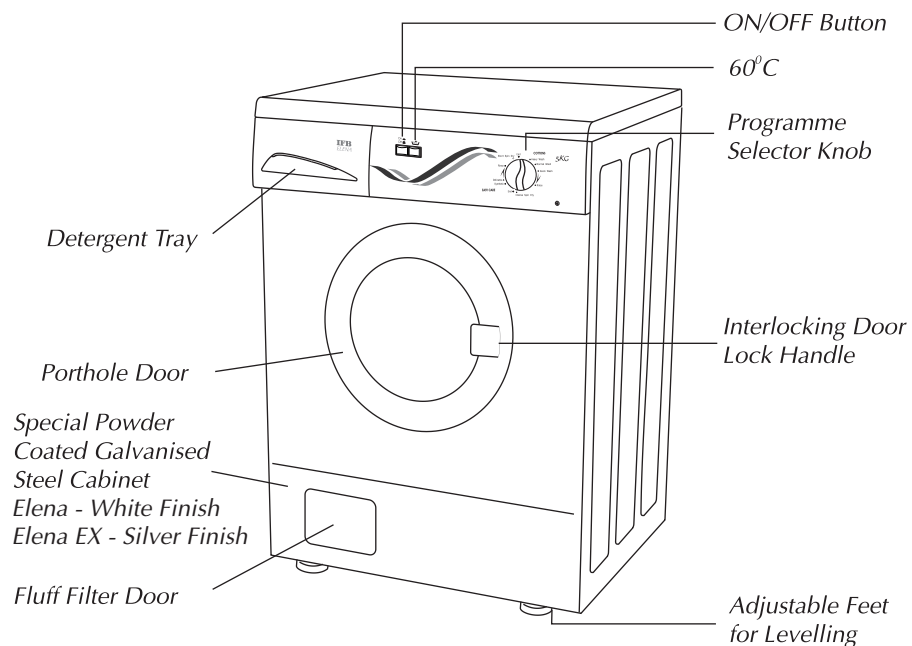

ADVANTAGES OF TUMBLE WASH

- MOST EFFECTIVE CLEANING AS THE CLOTHES PASS THROUGH SOAPY WATER AND ALSO FALL ON SOAP SOLUTION IMPROVING WETTING OF CLOTHES.
- RESEMBLES THE THUMPING AND RUBBING ACTION OF GENTLE HAND WASH.
- USES LESS WATER COMPARED TO TUB TYPE TOP LOADERS.
- LESS WATER MEANS LESS DETERGENT AND ELECTRICITY CONSUMPTION.
- WASHING IS EFFECTIVE BY DETERGENCY, SOAKING, HEATING, TUMBLING AND SQUEEZING.
- GIVES BETTER DRYING EFFECT BY SPINNING.

INSTALLATION REPORT

IFB WASHING MACHINE

Model : _____ Serial No. : _____ Customer's Name : _____
 Address : _____ Tel. No. _____

Installation Check Points

Machine Delivered on : _____ Machine Installed on : _____

1. Any Major transit damage to the machine observed	Yes	No
2. Condition of Earthing/Plug Point (16 Amp. 230V AC with MCB or other automatic short circuit protection devices.)good		
If poor, customer has been advised, to correct the same	Yes	No
3. User Manual Delivered	Yes	No
4. Inform user of need to keep drain hose straight & maximum height of draining.	Yes	No
5. Warranty term explained	Yes	No
6. Machine levelling procedure & importance explained	Yes	No
7. Detergents and bleach recommendation revent DD tray chambers explained	Yes	No
8. Basic wash demo given	Yes	No
9. Trouble shooting explained	Yes	No
10. Check following for proper order :		
a. Inlet Hose	Yes	No
b. DD Tray	Yes	No
c. Ratmesh fitted (If applicable)	Yes	No
d. Drain hose	Yes	No
11. Do's and Don't's explained	Yes	No
12. Display function explained (If applicable)	Yes	No
13. Procedure for cleaning rubber sleeve / coin trap	Yes	No
14. Program selection, Programs & buttons options (other knob) explaind	Yes	No
15. Indicator lamp/Status LED function (if Applicable)	Yes	No
16. Buzzer function (if Applicable)	Yes	No

Installed by : _____ Signature : _____

Customer's response

1. The installation person was courteous & Helpful.	Yes	No
2. I would describe my experience with installation as	Unacceptable Non Satisfactory	Satisfactory Very Satisfactory

I certify that the above information & checks have been done to my satisfaction & I am fully satisfied with the installation of the washing machine.

Customer's Signature _____ Date : _____ Time : _____

Pre Installation

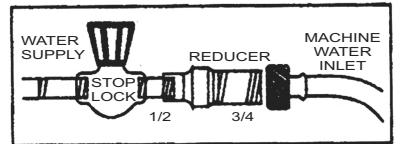
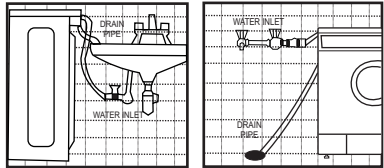
1. It is mandatory to have a 16 amp. 3-pin 230V AC, 50Hz electrical point with a 16 amp. MCB or Automatic short circuit protection device within 1 meter of the machine. Make sure it has proper earthing.
2. Fixed plumbing is recommended for the machine. The water inlet of the machine has a collar with 3/4" parallel internal threads. The water supply point with an external 3/4" parallel thread should be available within 1 meter of the machine's location.
 
3. Two options on the water inlet and drain pipe connection are shown. In case these possibilities do not exist for the drain pipe, please arrange an additional length of pipe.
 
4. Please inform our service centre for installation and demonstration of the machine once the points mentioned above have been completed.

Unpacking

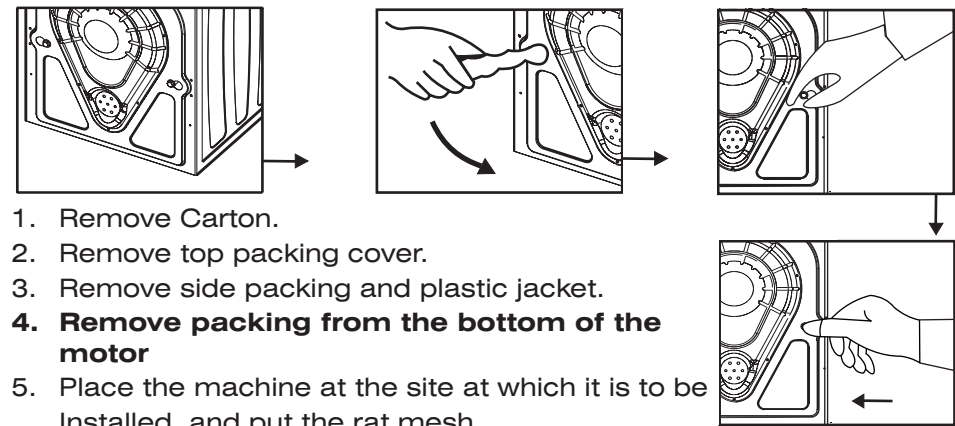

1. Remove Carton.
2. Remove top packing cover.
3. Remove side packing and plastic jacket.
4. **Remove packing from the bottom of the motor**
5. Place the machine at the site at which it is to be Installed, and put the rat mesh.

6. Remove transit bolts.
7. Insert plastic caps provided into holes vacated and press till they click into place.
8. Keep transit bolts carefully. They will be required in case you need to shift the machine again.
9. For shifting and re-installation at a new site, please get in touch with our service personnel.
10. Keep packaging material carefully. It comes handy while shifting residence.
11. PLEASE DO NOT OPERATE THE MACHINE TILL TRANSIT BOLTS HAVE BEEN REMOVED.

Setting Up

The machine should be levelled properly on the floor. However, it can be installed on any suitable platform or trolley, as desired.

Install machine in a room with adequate ventilation. Avoid a room with no windows. The back of the machine should be at least 4 inches (100 mm) away from the wall.

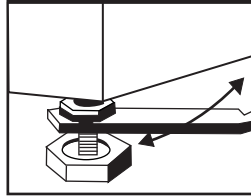

1. Do not place the machine on slanting, uneven, unstable surface.
2. Level the machine by using the adjustable screws provided at the bottom for levelling.
3. Loosen securing nut. Adjust the screw to change level. Tighten securing nut to ensure that screw is locked into place.
- 4. Make sure that the machine rests on all four feet on a level surface, at all times, to avoid vibrations during operation**
5. Machine should be leveled again in case it is moved to a new site.
6. Machine is provided with ventilating openings on the base. Hence it is always recommended to put the machine on the floor after removing the carpet.
7. In countries where there are areas which may be subjected to infestation by cockroaches or other insects etc, pay attention to keep the appliance & surrounding in clean condition at all times any damage which be caused by cockroaches etc will not be covered by the appliance guratantee.

CUSTOMER COPY

MODEL : EIENA / ELENA EX SR. NO WT ELN B/WTELNEX B _____

DEALER'S NAME : _____

CUSTOMER'S NAME : _____

ADDRESS : _____

PIN CODE : _____

TEL. NO. (Resi.) _____ (Off.) _____

E-MAIL : _____

MOTOR SR. NO. : _____

DATE OF PURCHASE : _____

TECHNICAL DATA

Dimensions(DxWxH)	:	56 cm x 60 cm x 85 cm
Weight	:	57 kgs
Capacity	:	5 Kgs of dry clothes (cotton)*
Programmes	:	10 wash care programmes
Selector Buttons	:	On/Off, 60°C.
Spin Speed	:	600 rpm
Heater Rating	:	1.9 kW
Drum	:	Stainless Steel
Temperature Selection	:	60°C
Drain Pump Rating	:	30 W
Water Consumption	:	75 litres for normal wash.
Power Consumption	:	0.25 unit for cold wash
Cotton Wash Programme	:	0.6 - 0.9unit hot wash at 60°C
Connected Load	:	2.35 KW Max.
Programme Duration	:	50 to 115 minutes
Power supply	:	220 - 240 V, Single Phase, 50 Hz
Water Pressure	:	1 bar (1.03 kg/cm ²) - 10 bar (10.3 kg/cm ²)

Specifications are subject to change without prior notice.

*Capacity depends on size, texture and combination of clothes

Depending on water pressure, Water hardness, Water inlet Temperature, Quantity and type of textile, Detergents used, Degree of soiling, Ambient condition, selected additional functions & power supply fluctuations the actual values given on or with the machine can deviate from the declared standard values, as they are tested according to the laboratory conditions

Water Inlet

1. Connect inlet hose to water tap/line.
2. Do not connect machine to a hot water supply.

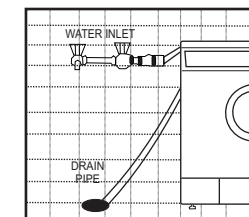

Water Outlet

1. A drain pump is provided in the machine to pump out used water.
2. The end of the outlet should be placed near a drain. If necessary, it can be placed over the edge of a sink at a maximum height of 1 mt. from the floor level.
3. Allow free flow of water from the outlet pipe.

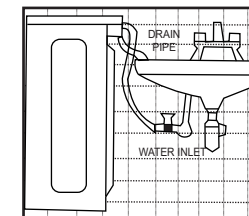

Electrical Connection

- Check that the electrical line take the required load.
- Connect to a 230V, 50Hz single phase AC supply. The appliance must be positioned so that the plug is accessible.
- Machine must be earthed properly before operation. This can be done by using a 3 - pin plug and a properly earthed operated socket of 16 Ampere rating.
- If the supply cord is damaged, it must be replaced by the manufacturer or its service agent or a similarly qualified person in order to avoid a hazard. It should not be stretched when connected to the main socket.

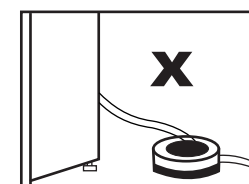
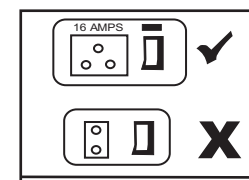

- ❑ Use of extension cord not recommended since it may not be properly earthed.
- ❑ Use ISI marked sockets of reputed make for preventing loose contact of power supply cable.
- ❑ Ensure that there is a firm connection between the 3 PIN PLUG and SOCKET, else it may result in sparking and subsequent failure of 3 pin plug.
- ❑ Ensure that L,N,E is as per the Fig. Shown
- ❑ Washing machine should always be connected to socket with 16 Amps MCB or other automatic short circuit protection devices.

CAUTION :- The producer/Manufacturer declines any responsibility for damage caused by failure to observe this rule. You are therefore advised to check that your household supply has an efficient earth.

- ❑ Avoid the machine coming in contact with floor cleaning chemicals.*
 - ❑ Do not wash or spray water over the switch or control panel.
 - ❑ Do not allow children/pets to play with the machine.
 - ❑ Do not wash shoes or utensils in the machine.
 - ❑ Keep machine away from fire or heat.
 - ❑ IFB will not be responsible if the user uses accessories not manufactured or recommended by IFB.
 - ❑ Take care when draining hot washing solution.
 - ❑ Door always become very hot during washing at higher temperatures. Keep children away from the appliance while it is in use.
- *Exposure can lead to rusting/corrosion.

SPECIAL NOTE

ONLY USE A DETERGENT RECOMMENDED FOR FRONT LOADING WASHING MACHINES. A DETERGENT WHICH FOAMS EXCESSIVELY CAN DAMAGE THE MOTOR AND DETERIORATE THE RINSE QUALITY.

INSTALL MACHINE IN A ROOM WITH ADEQUATE VENTILATION. AVOID A ROOM WITH NO WINDOWS. THE BACK OF THE MACHINE SHOULD BE AT LEAST 4 INCHES (100 mm) AWAY FROM THE WALL.

IF YOU USE A COVER OR TABLE CLOTH ON THE TOP LID, MAKE SURE THAT THE VENTILATION SLOTS AT THE BACK ARE NOT COVERED OR BLOCKED. THIS PRECAUTION WILL PROLONG THE LIFE OF ELECTRICAL AND RUBBER COMPONENTS.

SAFETY PRECAUTIONS

- ❑ Ensure that the machine is properly balanced on four adjustable feet.
- ❑ Ensure that the machine is connected to 3 pin socket with good earth and 16 Amp MCB or other automatic short circuit protection devices.
- ❑ The machine is tested with water during assembly for performance checking. Condensed droplets of water may remain inside the drum. It is advisable to run the machine without wash load in cotton 60 program with detergent for the first time after installation.
- ❑ Servicing should be handled by the Company's authorized personnel only.
- ❑ Check label on garments for determining conditions under which fabrics are to be washed.
- ❑ Use detergent recommended for washing machine.
- ❑ Ensure that the electrical line on which the machine is used can take the required load.
- ❑ Check the inside of drum before loading the clothes.
- ❑ Protect the machine from direct sunlight and do not splash water on it. Clean with a damp cloth.
- ❑ Keep your machine dry to avoid corrosion/rusting. Take special care to wipe the machine after cleaning the Coin trap.
- ❑ The machine should ideally be installed on the floor. It can be installed on any suitable platform or trolley, if desired by the customer.
- ❑ Clean the shell lower and detergent tray periodically by taking out the detergent tray.
- ❑ Do not pull the cord to disconnect the plug. Hold the plug itself/do not insert or remove the plug with damp hand.
- ❑ Do not drag the washing machine to its position. Always lift the or move the machine keeping the wheel's direction in mind.
- ❑ Do not move the washing machine if it contains the wash load or when in operation.
- ❑ Do not install the machine in a damp area or bathroom, with exposure to direct shower*.
- ❑ Do not spill water over the machine*. In case of spillage, wipe dry.

USING YOUR MACHINE

CONTROL PANEL

Let's take a look at the control panel and understand the working of each of its features. Each feature serves a specific purpose in the complete operation of the machine.

ELENA

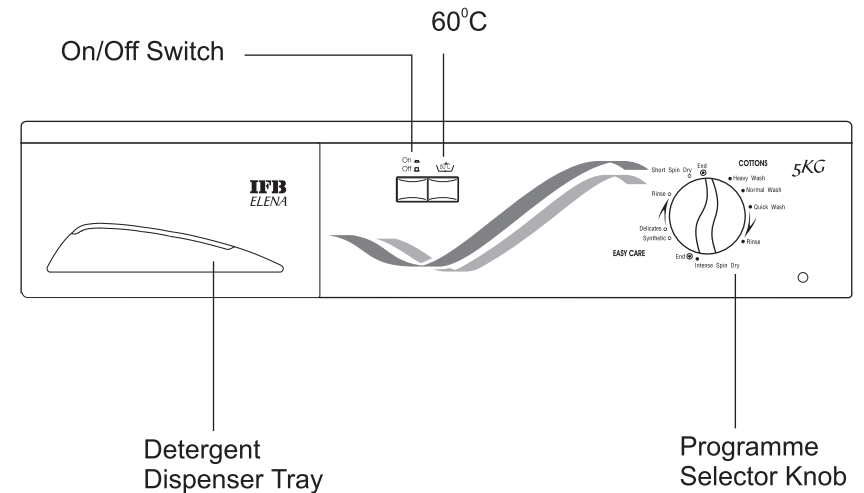

ELENA EX

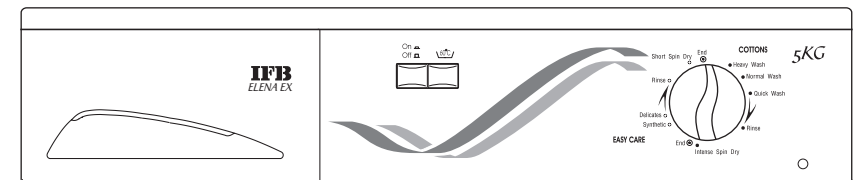

Environmental Protection/ Conservation Issues

Your washing machine uses water, energy and detergent efficiently, thereby protecting the environment and reducing your household costs.

Using your washing machine in an efficient and environmentally friendly manner:

Do not exceed recommended load.

Cottons	5.0kg
Easy-care	2.5kg

Add detergent according to the degree of soiling, amount of laundry and water hardness, and observe the detergent manufacturer's instructions.

Before Using Your Washing Machine For The First Time

Caution

The washing machine must have been installed and connected properly (refer page 7)

Your appliance was tested before leaving the factory. To remove any water left over from testing procedures, the first washing cycle should be carried out without laundry in the machine.

Do not load any laundry.

1. Turn on water tap.
2. Pull out the detergent dispenser up to the end stop.
3. Pour approx. 1 litre of water into chamber II of the detergent dispenser.
4. Pour ½ measuring beaker of detergent into dispenser II.
5. Close the detergent dispenser.
6. Set the temperature to 60° C cottons and start the machine.
7. After the program is over turn OFF the machine.

FAULT DIAGNOSIS

WHY DOES IT HAPPEN?

WATER DOES NOT ENTER MACHINE/DETERGENT NOT BEING FLUSHED INTO DRUM.

- Check water supply
- Porthole door not firmly closed
- Water tap not turned on
- Bent inlet hose
- Sieve on inlet valve clogged

SUDS ESCAPING FROM DETERGENT DISPENSER TRAY. / EXCESSIVE FOAM IN THE DRUM.

- Detergent used is not a washing machine detergent
- Excessive detergent used

WATER LEAKAGE FROM THE MACHINE.

- Inlet/Outlet hose connection loose
- Fluff Filter not screwed on properly
- Inlet hose leaking
- Drain plug not fixed properly onto Drain hose.

MACHINE DOES NOT DRAIN.

- Fluff Filter clogged
- Outlet hose end above 1 mtr. from floor level

MACHINE VIBRATES STRONGLY DURING SPINNING.

- Machine not levelled properly
- Clothes not loaded as instructed
- Water not drained completely

MACHINE DOES NOT START.

- Check position of programme selector knob
- Check water supply
- Porthole door not closed properly

MOTOR NOISE

- It is normal for noises to be heard while motor is running. However wash load, belt tension and motor mounting bolt should be checked for specified limits.

PUMP NOISE

- It is normal for noises to be heard from the pump during the start-up and final stage of draining. However check for fluff filter clogging.

FROST PROTECTION

If the machine is being operated in very cold temperature, all the water should be drained out after use.

- Remove Fluff Filter.
- Locate the drain hose and drain the water.
- Disconnect inlet hose from the tap and drain.

DRAINING DURING EMERGENCIES

In case of a long power failure during a programme run, the water can be drained from the drum through the drain hose

- Allow the water in the machine to cool down sufficiently.
- Locate the drain hose and pull out the drain hose to drain water in a large shallow container.
- Before restarting machine, ensure that drain plug is fixed on drain hose properly and fluff filter water line is filled with water by running the machine without any clothes or detergents.
- Spillage of water can rust the base plate. Draining through drain hose prevents rusting.

Automatic Detergent Dispenser Tray

Designed for automatic dispensing of detergent. The Detergent Dispenser Tray should be filled with detergent before the start of a programme.

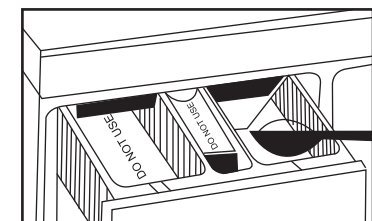

Normal-wash chamber: (Marked-I), to be filled with - detergent during every wash programme. Do not fill detergent in other chambers.

The detergent tray must be pulled out, filled as required and shut before the machine is switched on.

SELECTOR BUTTONS

ON/OFF Button

- To switch ON the machine press button.
- To switch OFF the machine release button.

Heater On Button

- Switches on the heater Temp. selection 60°C
- To be pressed when hot wash is required.

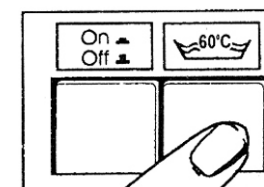
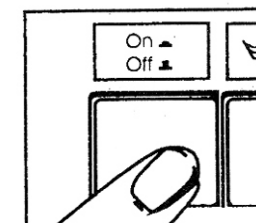

PROGRAMME SELECTOR KNOB

- ❑ To select the right programme as per the fabric being washed and extent of soilage.
- ❑ A choice of 10 programmes is available to wash different kinds/loads of clothes.
- ❑ Programme selection should be done before the machine is switched ON.
- ❑ THE STARTING POINT OF PROGRAMME NEEDS TO BE SELECTED BY SHIFTING THE PROGRAMME SELECTOR KNOB ADJACENT TO PRINTED LETTERS. OPERATING THE MACHINE BEYOND PRINTING ZONE MAY RESULT IN HIGHER CONSUMPTION OF WATER & ELECTRICITY AND WILL NOT IMPROVE WASH QUALITY.
- ❑ After initiating the programme, machine runs through automatically. If for any reason you wish to change the programme switch OFF the machine , then set the desired programme and re-start.
- ❑ KNOB SHOULD BE TURNED ONLY IN CLOCKWISE DIRECTION.

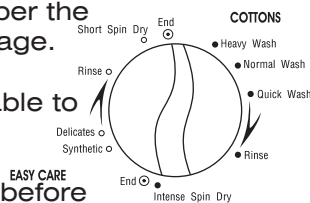

PROGRAMME SELECTION

1. COTTONS

To be used for whites and coloureds of cotton or predominantly of cotton in case of mixed load.

STAGE I: Main wash - Heavy wash / Normal wash / Quick wash

- ❑ Clothes are soaked, tumbled in hot water with detergent for longer duration to remove dirt. During draining dirty water, it is cooled down by adding cold water. Clothes are tumbled to expose more surface, squeezed by spinning to remove dirt inside the fabric.
- ❑ IF CLOTHES ARE NOT VERY DIRTY, THE MAIN WASH CAN BE STARTED BY DIRECTLY SETTING THE PROGRAMME SELECTOR KNOB AT NORMAL OR QUICK WASH TO REDUCE WASHING TIME.

Drum

Rust Stains

Never leave metal items e.g. paper clips, safety pins etc. in the drum as it creates superficial rust marks in drum. If there are any rust stains remove with a non-chlorine agent. Special non-metal sponges (never use steel wool) may also be used.

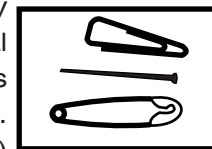

SIEVES

Cleaning of Water Connection Sieves, filter

1. Turn off Taps. Disconnect Power supply to the machine. Unscrew inlet hose from machine as well as from the tap and drain out water from the hose.
2. Pull the sieve out of the magnetic valve with a pair of flat nosed pliers and clean under running water with a brush.
3. Remove the filter mesh from the tap end of the inlet hose and clean under running water with a brush.
4. Fit the filter mesh back to inlet hose.
5. Screw inlet hose back to the machine and the tap. Ensure that both the sieves and filter are in place.
6. Turn on the tap.

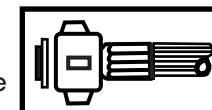
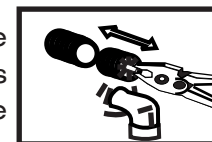

Cleaning of Porthole Door Area:

- ❑ After every wash clean vapour off porthole door.
- ❑ Lift the fold in the rubber gasket under porthole periodically to remove lint and dirt preferably after every wash.

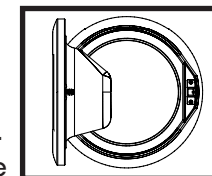

MAINTENANCE

FLUFF FILTER

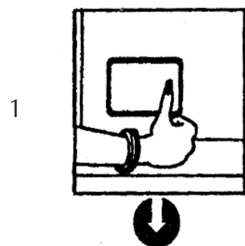

Open door flap by pressing on the right hand. Clean filter under running water

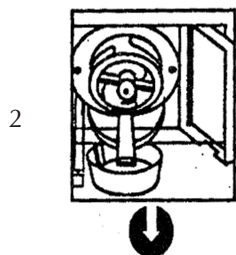
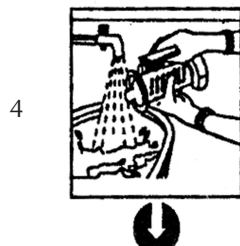

Place shallow container under the tray to collect water that comes out.

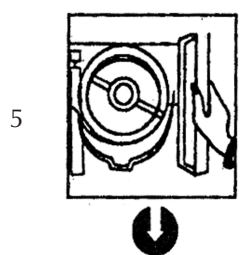

Replace filter and screw on tightly to avoid leakage of water

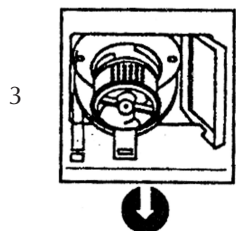

Turn Fluff Filter cover anti-clockwise drain water into container and take out filter

ENSURE THAT THE FLUFF FILTER IS NOT BLOCKED, CLEAN WEEKLY OR AS OFTEN AS REQUIRED. BEFORE USING MACHINE AGAIN RUN THE MACHINE WITHOUT CLOTHES AND DETERGENTS BY SELECTING ANY SHORT WASH PROGRAMME. THIS WILL ENSURE THAT THE FLUFF FILTER LINE GETS FILLED WITH WATER. ALTERNATIVELY POUR TWO MUGS OF WATER (APPROX,

STAGE II : Rinse

- After washing, the rinsing is done automatically four times to remove traces of detergent and dirt from clothes.
- For most efficient rinsing two intermittent short spins are provided.

STAGE III : Intense spin Dry

- Spin drying takes place at 600 rpm for longer duration.

2.Easy Care Programme

To be used for easy care fabrics like polyester blends or predominantly having such fabric in mixed load.

STAGE 1 : Main Wash : synthetic / delicates

- Clothes are soaked, tumbled in hot water with detergent for lesser duration than main wash of Normal wash programme. During draining of dirty water, it is cooled down by adding cold water. Clothes are tumbled to expose more surface, squeezed by spinning to remove dirt.

STAGE II : Rinse

- After washing the rinsing is done automatically three times to remove traces of detergent and dirt from clothes.

STAGE III : Short spin Dry

Spin drying takes place at 600 r.p.m for shorter duration.

Exclusive spin drying programmes : Intense spin Dry / Short spin Dry

- Can be used for spin drying hand washed/wet clothes.
- Turn programme selector knob directly to the spin drying points after loading the clothes.
- Switch ON the machine.

Cool down cycle.

Hot water drained after Main wash cycle can be harmful for people and environment. Hot water is cooled down by taking additional cold water automatically, which also reduces concentration of detergent, thus ensures better rinse quality and eco friendly environment.

Note.

If the load or machine is very much unbalanced the machine in the process of balancing / distributing the load may suddenly stop during spinning or may spin at very low RPM in order to take care of vibration which may occur under such circumstances.

In case electricity / water supply goes off, the machine stops and starts again from the same point, automatically, on resumption of electricity/ water supply.

OPERATION

SORTING OF GARMENTS

- ❑ Machine to be used for machine washable fabrics only (Look for wash symbols given on your garments.)
- ❑ Non-fast coloured should be washed with like colours only .Wash whites separately from colours.
- ❑ Check the pockets for any loose articles like coins, keys, keychains etc. Remove these articles as these can damage the drum/tub.
- ❑ Do not mix clothes that give lint with clothes that attract lint (e.g lint givers-woollens, socks, coarse cotton fabrics etc. Lint takers- synthetic fibres and corduroys).

LOADING THE MACHINE

- ❑ Open the front porthole door, place garments loosely inside drum. For best results load garments one by one ,preferably mix of large and small clothes
- ❑ Turn knitted garments inside out, remove loose hooks, rings and pins found on curtains etc. Or

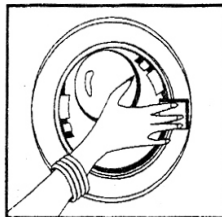
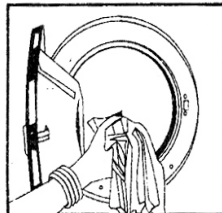

- Tie a knot around them with the garment itself.
- ❑ **Close door and press till you hear a click. Ensure that no cloth is jammed between door and rubber gasket of frame.**
- ❑ For large garments like bed covers and curtains etc. open out the garments and hold from the centre to load.
- ❑ Ensure that volume of load allows the clothes to tumble freely in the drum for best wash results.
- ❑ Over loading the drum will affect wash quality. It can also damage the machine and clothes in the long run.
- ❑ Running the machine under loaded may cause excessive vibration, noise and damage.

PROGRAMME RUN

Note:

- ❑ During the programme run the knob turns automatically in the clockwise direction only.
- ❑ Washing, rinsing and spinning can be seen through the porthole window.
- ❑ At any moment the position of the knob with respect to its start position shows how far the programme has advanced.

SWITCHING OFF THE MACHINE

- ❑ The wash programme automatically completes at the End.
- ❑ To switch the machine OFF Release the ON/OFF Button.
- ❑ Porthole door can be opened only after 90 seconds
- ❑ Remove clothes from inside the machine
- ❑ Leave door slightly ajar to dry out the inside of the machine

CHECK POINTS

Before switching your machine 'ON' check...

- ❑ The machine is connected to a 220V, 50 Hz supply with proper earthing.
- ❑ The water inlet stopcock is fully open.
- ❑ The hoses are not bent or twisted.
- ❑ Dry clothes are loaded into the machine drum, and door is closed firmly with a click.
- ❑ The required amount of detergent is filled in the compartment.
- ❑ After completing the above check points the machine should be switched ON by gently pulling out the programme selector knob.
- ❑ The programme Selector knob is turned to the appropriate programme position in a clockwise direction only.
- ❑ The Fluff Filter is not open.

Ironing

The number of dots indicate the maximum recommended temperature



Max 200° C, 150° C, 110° C,

Non - iron

Dry Cleaning

A circle symbolizes dry cleaning.

- (A)** articles normal for dry cleaning in all solvents.
- (P)** articles normal for dry cleaning in perchloroethylene, white spirit, Solvent 113 and Solvent 11
- (F)** article normal for dry cleaning in fluorocarbon 113 or white spirit.
- (X)** do not dry clean.

Bleaching

A triangle symbolizes bleaching



bleaching

do not bleach

Drying

A rectangle symbolizes drying



suitable for tumble-drying

do not tumble-dry

PROGRAMME SELECTION CHART

Refer detailed Programme Chart given below showing 10 fully automatic wash programmes.

PROGRAMME SELECTION	DETERGENT IN CHAMBER	ADDITIONAL BUTTON		TYPE OF WASHING (Please note wash care labels on garments)	COMPLETE CYCLE TABLE (MINUTES)	MIN WATER CONSUMPTION (LITRES)
		TEMP SELECTION				
1. Heavy wash	Yes	•		Very soiled cotton, whites or boil - proof linen	115	75
2. Normal wash	Yes	•		Normally soiled, non boil- proof baby washing	95	75
3. Quick wash	Yes	•		Cotton fabrics or linen which are colour fast, non boil - proof (2.5 Kg. Max.)	75	75
4. Rinse	-	-		Most efficient rinsing with two intermittent spins	40	65
5. Intense spin Dry	-	-		Pumping out water and spinning for cottons	10	Nil
6. Synthetic	Yes	•		Easy care fabrics of cotton, polyester or polyester blends, very soiled.	60	70
7. Delicates	Yes	•		Easy care fabrics of polyester or polyester blends, normally soiled. (2.0 Kg. Max.)	50	70
8. Synthetic	Yes	•		Synthetic curtains normally soiled	60	70
9. Rinse	-	-		Gentle rinsing without intermittent spin	25	55
10. Short spin Dry	-	-		Pumping out water and short spinning for delicate washing	10	Nil

Note:

Cycle time does not include water filling time.
Water consumption does not include the quantity of water taken during cool down time.

- Button to be pressed if required

The above values are under standard test conditions

DETERGENT TO BE USED AND QUANTITY

- The best washing results will be achieved by using the correct dosage of detergent .
- Use the detergent as per the instructions on the detergent packaging, However the dosage need to be adjusted during usage to avoid effects of inadequate/excess detergent as mentioned below.
- Use liquid detergent dispenser tray (Optional) while using liquid detergent. It is not to be used for powder detergent.
- Pour the liquid detergent into the detergent dispenser tray and place the tray in the main wash chamber (Marked - II) of the detergent dispenser tray before the start of the program.
- The quantity of detergent will depend on
 - a. Quantity of clothes being washed
 - b. Degree of soilage of clothes
 - c. Water hardness
- Hard water and heavily soiled clothes require more, while less soiled clothes requires less then recommended quantity of detergents.
- Do not use dry cleaning agents.
- Frequent use of insufficient detergent will be noticeable as follows:
 - a. Washing appears grey or not properly clean
 - b. Grey/brown stains appear on the clothes
- Excess use of detergent will result in
 - a. Higher environmental pollution
 - b. Generation of too much foam
 - c. Building up of scales
 - d. Poor rinse quality
 - e. Less drying efficiency
 - f. Reduction in life of the Components.

TREATMENT OF STAINS

- Stains need to be treated immediately when they are fresh. Usually stains are categorised as absorbed stains, built-up stains, and compound stains.
- Absorbed stains can be removed by rubbing gently a pad containing a suitable solvent over the stain from outer edge towards center by keeping stained cloth on absorbent fabric.
- Built up and compound stains may be removed by first carefully brushing off stained area. Then rub gently with a pad containing solvent from the back of fabric.
- It is advisable to try out the solvent on hidden part of the garment to verify its effect on cloth.

Wash Load Guide

Sheets Cotton	(D) (S)	1kg 500gms	Pajama/Kurta Shirt Cotton Others	400gms 280gms 200gms	Bedspread Blankets Wool acrylic	3kg 2.0kg 1.5kg
Other than Coton	(D) (S)	650gms 400gms	Blouse: cotton others Sarees: Cotton Synthetics Panties	140gms 100gms 650gms 350gms 60gms	Sweaters(Wool) other heavy weight light weight	400gms 300gms 150gms
Pillow slips: Cotton others		110gms 85gms	Socks: long(2pair) short(2pair)	150gms 85gms	Cotton vests Underslip	100gms 100gms
Bath towels Hand Towels		600gms 260gms	Hankies (6) Napkins(1doz) Lungi/Dhoti	85gms 1.1kgs 200gms	Skits Trousers jeans	200gms 250gms 400gms
Tablecloths: small large		230gms 600gms				
Table Napkins (4)		150gms				

D = Double

S = Single

- The chart indicates the average weight of clothes.
- The recommended weight of your wash should not be exceeded to ensure that your machine gives your clothes an effective wash.

International Washing Symbols

Washing Symbol	Wash Temp Max ^o C	Action
	95, 60, 40	normal
	30	gentle
	Do not machine - wash	handwash
	Do not wash in water	

Free Manuals Download Website

<http://myh66.com>

<http://usermanuals.us>

<http://www.somanuals.com>

<http://www.4manuals.cc>

<http://www.manual-lib.com>

<http://www.404manual.com>

<http://www.luxmanual.com>

<http://aubethermostatmanual.com>

Golf course search by state

<http://golfingnear.com>

Email search by domain

<http://emailbydomain.com>

Auto manuals search

<http://auto.somanuals.com>

TV manuals search

<http://tv.somanuals.com>