



USER'S GUIDE

V:0915-0820-09

IH319B

Home Dock for iPod with CD Player

CONTENTS

WARNINGS AND PRECAUTIONS	2
PRODUCT INFORMATION	4
FEATURES.....	4
IN THE BOX	4
POWER OPTIONS	5
AC/DC ADAPTER.....	5
REMOTE BATTERY	5
PRODUCT STABILITY	5
USING THE BUILT-IN STAND.....	5
OPERATIONS	6
DOCKING AN IPOD	6
PLAYING AN IPOD	6
OPERATIONS	7
PLAYING A CD	7
PROGRAMMING A CD.....	7
OPERATIONS	8
TUNING THE AM/FM RADIO.....	8
SAVING AN AM/FM RADIO STATION TO THE UNIT'S MEMORY	8
USING THE AUXILIARY INPUT	8
OPERATIONS	9
SETTING THE CLOCK.....	9
SETTING THE TIMER.....	9
CONTROLS & CONTROL GLOSSARY	10-15
COMPANY INFORMATION	16
INTERNATIONAL SUPPORT	16
SERVICE INFORMATION.....	16

WARNINGS AND PRECAUTIONS

- **CAUTION:** TO PREVENT ELECTRIC SHOCK, MATCH WIDE BLADE OF PLUG TO WIDE SLOT, FULLY INSERT.
 - **WARNING:** To prevent fire or shock hazards, do not expose this unit to rain or moisture.
 - **CAUTION:** Use of controls or adjustments or performance of procedures other than those specified may result in hazardous radiation exposure.
 - **WARNING:** Changes or modifications to this unit not expressly approved by the party responsible for compliance could void the user's authority to operate the equipment.
 - **WARNING:** Do not place the unit on top of any soft, porous, or sensitive surfaces to avoid damaging the surface. Use a protective barrier between the unit and surface to protect the surface.
 - **WARNING:** Use of this unit near fluorescent lighting may cause interference regarding use of the remote. If the unit is displaying erratic behavior move away from any fluorescent lighting, as it may be the cause.
 - **CAUTION:** Danger of explosion if battery is incorrectly replaced. Replace only with the same or equivalent type.
 - **PRÉCAUTION:** *Danger d'explosion si les piles sont remplacées de façon incorrect. Remplacer les piles seulement par le même type de pile ou l'équivalent.*
 - **WARNING:** There is a danger of explosion if you attempt to charge standard Alkaline batteries in the unit. Only use rechargeable NiMH batteries.
 - **WARNING:** The remote control's button cell battery contains mercury. Do not put in the trash, instead recycle or dispose of as hazardous waste
 - **WARNING:** Lithium ion batteries, like all rechargeable batteries are recyclable and should be recycled or disposed of in normal household waste. Contact your local government for disposal or recycling practices in your area. They should never be incinerated since they might explode.
- Do not mix old and new batteries.
Do not mix alkaline, standard (carbon-zinc), or rechargeable (ni-cad, ni-mh, etc) batteries. Tum que omante, vid pecesim aximei igingultum pubitere comant. Casta,



The lightning flash with arrowhead symbol, within an equilateral triangle, is intended to alert the user to the presence of uninsulated "dangerous voltage" within the product's enclosure that may be of sufficient magnitude to constitute a risk of electric shock to persons.

CAUTION

RISK OF ELECTRIC SHOCK
DO NOT OPEN

WARNING: TO REDUCE THE RISK OF ELECTRIC SHOCK, DO NOT REMOVE COVER (OR BACK). NO USER-SERVICEABLE PARTS INSIDE. REFER SERVICING TO QUALIFIED SERVICE PERSONNEL.



The exclamation point within an equilateral triangle is intended to alert the user to the presence of important operating and maintenance (servicing) instructions in the literature accompanying the appliance.



This product utilizes a Class 1 laser to read Compact Discs. This laser Compact Disc Player is equipped with safety switches to avoid exposure when the CD door is open and the safety interlocks are defeated. Invisible laser radiation is present when the CD Player's lid is open and the system's interlock has failed or been defeated. It is very important that you avoid direct exposure to the laser beam at all times. Please do not attempt to defeat or bypass the safety switches.

IMPORTANT SAFETY INSTRUCTIONS

1. Read these Instructions.
2. Keep these Instructions.
3. Heed all Warnings.
4. Follow all instructions.
5. Do not use this apparatus near water.
6. Clean only with a dry cloth.
7. Do not block any ventilation openings. Install in accordance with the manufacturer's instructions.
8. Do not install near any heat sources such as radiators, heat registers, stoves, or other apparatus (including amplifiers) that produce heat.
9. Do not defeat the safety purpose of the polarized or grounding - type plug. A polarized plug has two blades with one wider than the other. A grounding type plug has two blades and a third grounding prong. The wide blade or the third prong are provided for your safety. When the provided plug does not fit into your outlet, consult an electrician for replacement of the obsolete outlet.
10. Protect the power cord from being walked on or pinched particularly at plugs, convenience receptacles, and the point where they exit from the apparatus.
11. Only use attachments/accessories specified by the manufacturer.
12. Use only with a cart, stand, tripod, bracket, or table specified by the manufacturer, or sold with the apparatus. When a cart is used, use caution when moving the cart/apparatus combination to avoid injury from tip-over.



13. Unplug this apparatus during lightning storms or when unused for long periods of time.
14. Refer all servicing to qualified service personnel. Servicing is required when the apparatus has been damaged in any way, such as power-supply cord or plug is damaged, liquid has been spilled or objects have fallen into the apparatus, the apparatus has been exposed to rain or moisture, does not operate normally, or has been dropped.

Additional Warnings

- The apparatus shall not be exposed to dripping or splashing and that no objects filled with liquids, such as vases, shall be placed on apparatus.
L'appareil ne doit pas être exposé aux écoulements ou aux éclaboussures et aucun objet ne contenant de liquide, tel qu'un vase, ne doit être placé sur l'objet.
- Main plug is used as disconnect device and it should remain readily operable during intended use. In order to disconnect the apparatus from the mains completely, the mains plug should be disconnected from the mains socket outlet completely.
La prise du secteur ne doit pas être obstruée ou doit être facilement accessible pendant son utilisation. Pour être complètement déconnecté de l'alimentation d'entrée, la prise doit être débranchée du secteur.
- Battery shall not be exposed to excessive heat such as sunshine, fire or the like.
Les piles ne doivent pas être exposées à de forte chaleur, tel qu'à la lumière du soleil, au feu ou autres choses de semblable.
- Caution marking is located at the bottom of apparatus.
Les précautions d'emploi sont inscrites en bas de l'appareil.
- The marking information is located at the bottom of apparatus.
Les marquages sont inscrits en bas de l'appareil.

FCC Warnings

NOTE: This equipment has been tested and found to comply with the limits for a Class B digital device, pursuant to Part 15 of the FCC Rules. These limits are designed to provide reasonable protection against harmful interference in a residential installation. This equipment generates, uses, and can radiate radio frequency energy and, if not installed and used in accordance with the instructions, may cause harmful interference to radio communications. However, there is no guarantee that interference will not occur in a particular installation. If this equipment does cause harmful interference to radio or television reception, which can be determined by turning the equipment off and on, the user is encouraged to try to correct the interference by one or more of the following measures:

- Reorient or relocate the receiving antenna.
- Increase the separation between the equipment and receiver.
- Connect the equipment into an outlet on a circuit different from that to which the receiver is connected.
- Consult the dealer or an experienced radio/TV technician for help.

PRODUCT INFORMATION

FEATURES

Dock plays and charges iPod

CD player with motorized CD door: CD, CD-RW

AM/FM stereo radio with digital tuning

Auxiliary input for iPod shuffle and other audio devices

Remote

Programmable CD tracks

Digital volume control

Preset EQ settings

Station memory presets

Last user setting for volume and function

LCD display with white backlight

Digital clock with timer function

Stereo speakers

AC power: AC/DC Adapter

IN THE BOX

IH319B

AC/DC Adapter

Docking Spacers for iPod and iPhone

Documentation

POWER OPTIONS

AC/DC ADAPTER

Use the included AC/DC Adapter to connect the unit to an AC power source.

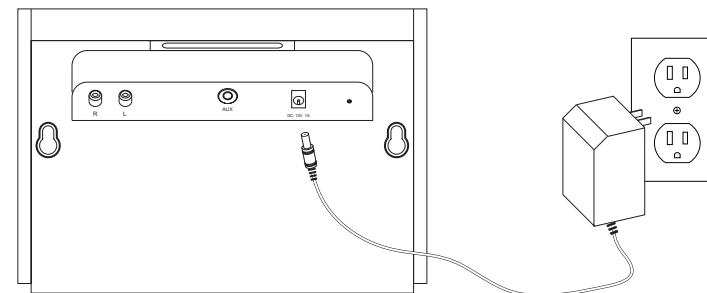

REMOTE BATTERY

Require 1 CR2025 battery, pre-installed.

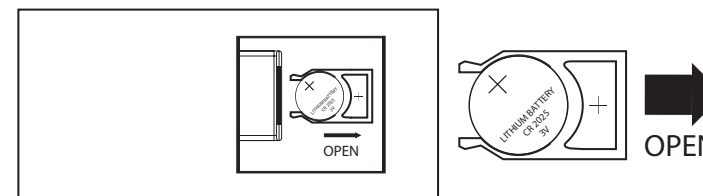

PRODUCT STABILITY

USING THE BUILT-IN STAND

There is a small metal support built into the bottom of the unit. When setting the unit in place, fold out the metal stand to provide support for the unit.

DOCKING AN IPOD

1. Press the **Power Button** to turn the unit on.
2. Press the **Open/Close Button** to open the **Motorized CD/iPod Door**.
3. Dock an iPod onto the **Dock Connector**.
4. Press the **Open/Close Button** to close the **Motorized CD/iPod Door**.

UN-DOCKING AN IPOD

1. Press the **Power Button** to turn the unit on.
2. Press the **Open/Close Button** to open the **Motorized CD/iPod Door**.
3. Press down the **iPod Eject Button** to the left of the iPod inside the dock for iPod. This will lean the iPod out of the dock, making it easier to grab and remove.

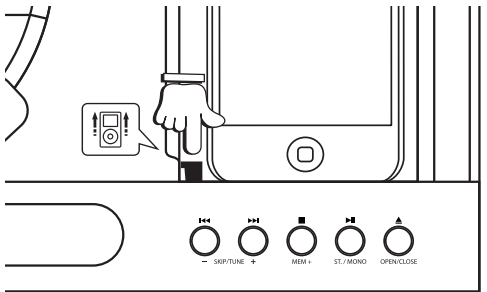
**PLAYING AN IPOD**

1. Dock an iPod onto the unit's **Dock Connector**.
2. Press the **Power Button** to turn the unit on.
3. Press the **Source Button** to switch to iPod Mode.
4. Press the **Play/Pause Button** to begin playing the docked iPod.
 - Press the **Skip/Tune Buttons** to skip between tracks on the docked iPod.
 - Press and hold the **Skip/Tune Buttons** to fast forward and rewind on the current track.
 - Press the **Random Button** on the remote to play the current album or playlist in random order.
 - Press the **Repeat Button** on the remote once to repeat the current track.
 - Press the **Repeat Button** on the remote twice to repeat an entire album or playlist.
 - Press the **iPod Select Button** on the remote to make selections on a docked iPod.

This button works exactly like the select button on an iPod.
 - Press the **Mem+/iPod Menu** on the remote to move back through the menus on a docked iPod.

This button works exactly like the menu button on an iPod.
 - Press the **Menu-** and **Menu+** Buttons to move up and down in any menu on the docked iPod.

PLAYING A CD

1. Press the **Power Button** to turn the unit on.
2. Press the **Open/Close Button** to open the **Motorized CD/iPod Door**.
3. Load a CD into the CD player.
4. Press the **Open/Close Button** to close the **Motorized CD/iPod Door**.
5. Press the **Source Button** to switch the unit to CD Mode. "CD" will appear on the **LCD Display**, indicating that the unit is in *CD Mode*.
 - Press the **Skip/Tune Buttons** to skip between tracks on the loaded CD.
 - Press and hold the **Skip/Tune Buttons** to fast forward and rewind on the current track.
 - Press the **Stop Button** to stop a CD during play.
 - Press the **Intro Button** on the remote to activate *Intro Mode*. When in *Intro Mode*, the unit will play the first 10 seconds of a track and then skip to the next track.
 - Press the **Random Button** on the remote to play the tracks of a loaded CD in random order.
 - Press the **Repeat Button** on the remote once to repeat the current track.
 - Press the **Repeat Button** on the remote twice to repeat an entire album.
6. Press the **Play/Pause Button** to begin playing the loaded CD.

PROGRAMMING A CD

Follow the Steps for Playing a CD.

1. Press the **Stop Button** to stop the CD
2. Press the **Program Button** on the remote.
3. Press the **Skip/Tune Buttons** to select the track you want to play first.
4. Press the **Program Button** on the remote, to save the selected track as the first programmed track.
5. Repeat steps 3 and 4 until the desired tracks have been programmed.

Up to 20 tracks can be programmed at one time.

TUNING THE AM/FM RADIO

1. Press the **Power Button** to turn the unit on.
2. Press the **Source Button** to switch the unit to *Tuner Mode*. "Tuner" will appear on the LCD Display, indicating that the unit is in Tuner Mode.
3. Press the **Source Button** to switch to *AM* or *FM radio mode*.
4. Press the **Skip/Tune Buttons** to tune the AM or FM radio stations.
5. Press and hold the **Skip/Tune Buttons** for 3 seconds to search for a receptive AM or FM radio station.
6. Press the **St./Mono Button** to turn the *FM Stereo Mode* off and on .
7. Adjust the **FM Wire Antenna** to improve FM radio reception. An AM antenna is built into the unit. Adjust the position of the unit to improve AM radio reception.

SAVING AN AM/FM RADIO STATION TO THE UNIT'S MEMORY

1. Tune the AM/FM Radio to the desired station.
2. Press the **Mem/Clk Adj Button**.
3. Press the **Stop/Mem+ Button** to select a memory channel for the current radio station.
4. Press the **Mem/Clk Adj Button**.
5. To cycle through saved radio stations, Press the **Stop/Mem+ Button**.

USING THE AUXILIARY INPUT

1. Connect an MP3 Player or other audio source to the **Auxiliary Input**.
2. Press the **Power Button** to turn the unit on.
3. Press the **Source Button** to switch the unit to *Aux Mode*.

Use the connected device's controls to control the audio playing through the unit.

SETTING THE CLOCK

1. Press the **Power Button** to turn the unit off.
2. The **Power Indicator Light** will illuminate red, indicating that the unit is in Standby Mode.
3. Press the **Mem/Clk Adj Button**.
4. The Hour will begin to blink.
5. Press the **Skip/Tune Buttons** to adjust the hour.
6. Press the **Mem/Clk Adj Button** to set the hour.
7. The Minute will begin to blink.
8. Press the **Skip/Tune Buttons** to adjust the minute.
9. Press the **Mem/Clk Adj Button** to set the minute, and finish setting the clock.

SETTING THE TIMER

1. To set the timer, you must first go through the steps of Setting the Clock.
2. After the clock is set, "Timer" will appear on the LCD Display and the timer hour will begin to blink, indicating that you are now editing the timer.
3. Press the **Skip/Tune Buttons** to adjust the hour.
4. Press the **Mem/Clk Adj Button** to set the hour.
5. The Minute will begin to blink.
6. Press the **Skip/Tune Buttons** to adjust the minute.
7. Press the **Mem/Clk Adj Button** to set the minute, and finish setting the timer.
8. After setting the timer, press and hold the **Mem/Clk Adj Button** to activate the timer. The word "Timer" will appear on the LCD display once the timer is activated.

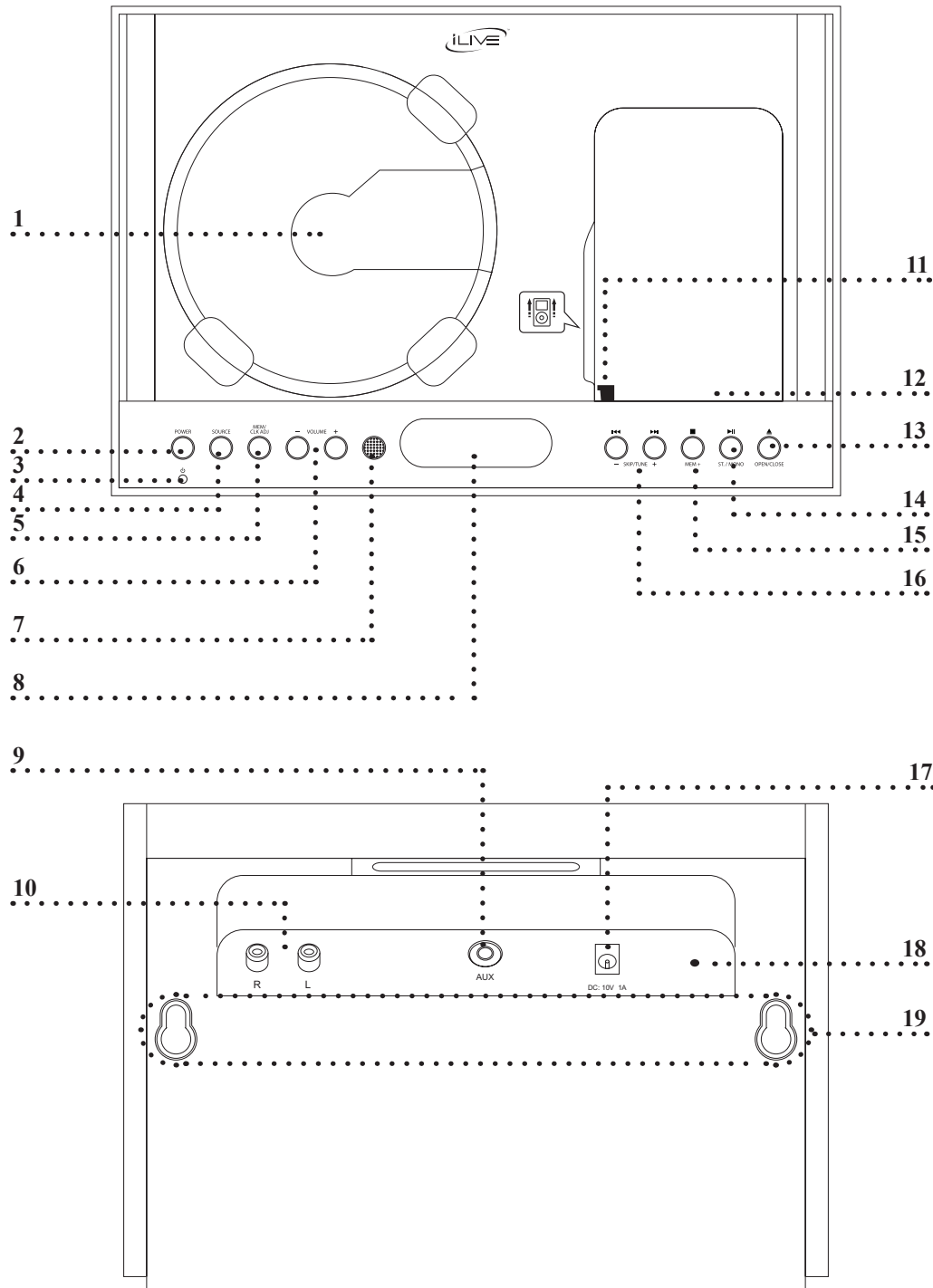

- 01. CD Player**
Use the CD Player to load a CD into the unit.
- 02. Power Button**
Press the Power Button to turn the unit off and on.
- 03. Power Indicator**
The Power Indicator light will illuminate red when the unit is powered off.
- 04. Source Button**
Press the Source Button to switch between CD, Tuner, iPod, and Aux modes.
- 05. Mem/Clk Adj. Buttons**
Press the Memory Button to save an AM or FM radio station to the unit's memory.

Press the Clock Adjust Button to set the unit's clock.
- 06. Volume Buttons**
Press the Volume Buttons to adjust the volume of the unit.
- 07. Infrared Receiver**
The Infrared Receiver receives signals sent from the remote control.
- 08. LCD Display**
- 09. Auxiliary Input**
Use the Auxiliary Input to connect an MP3 player or other audio source to the unit.
- 10. Speaker Connections**
Use the Speaker Connections to connect a set of speakers to the unit.
- 11. iPod Eject Button**
- 12. Dock Connector**
Use the Dock Connector to connect an iPod to the unit.

- 13. Open/Close Buttons**
Press the Open/Close Button to open or close the Motorized CD/iPod Door.
- 14. Play/Pause/St./Mono Button**
Press the Play/Pause Button to play and pause a loaded CD or docked iPod.

Press the St./Mono Button to switch between FM Stereo and FM mono modes.
- 15. Stop/Mem+ Button**
Press the Stop Button to stop a CD during play.

Press the Mem+ Button to cycle through saved radio stations.
- 16. Skip/Tune Button**
Press the Skip Button to skip between tracks on a loaded CD or docked iPod.

Press and hold the Skip Button to search through an individual track on a docked iPod or loaded CD.

Press the Tune Button to tune the AM or FM radio.
- 17. DC Power Input**
Use the DC Power Input to connect the included AC/DC adapter to the unit.
- 18. FM Wire Antenna**
Adjust the FM Wire Antenna to improve FM radio reception.

An AM antenna is built into the unit. Adjust the position of the unit to improve AM radio reception.
- 19. Wall Mount Connections**

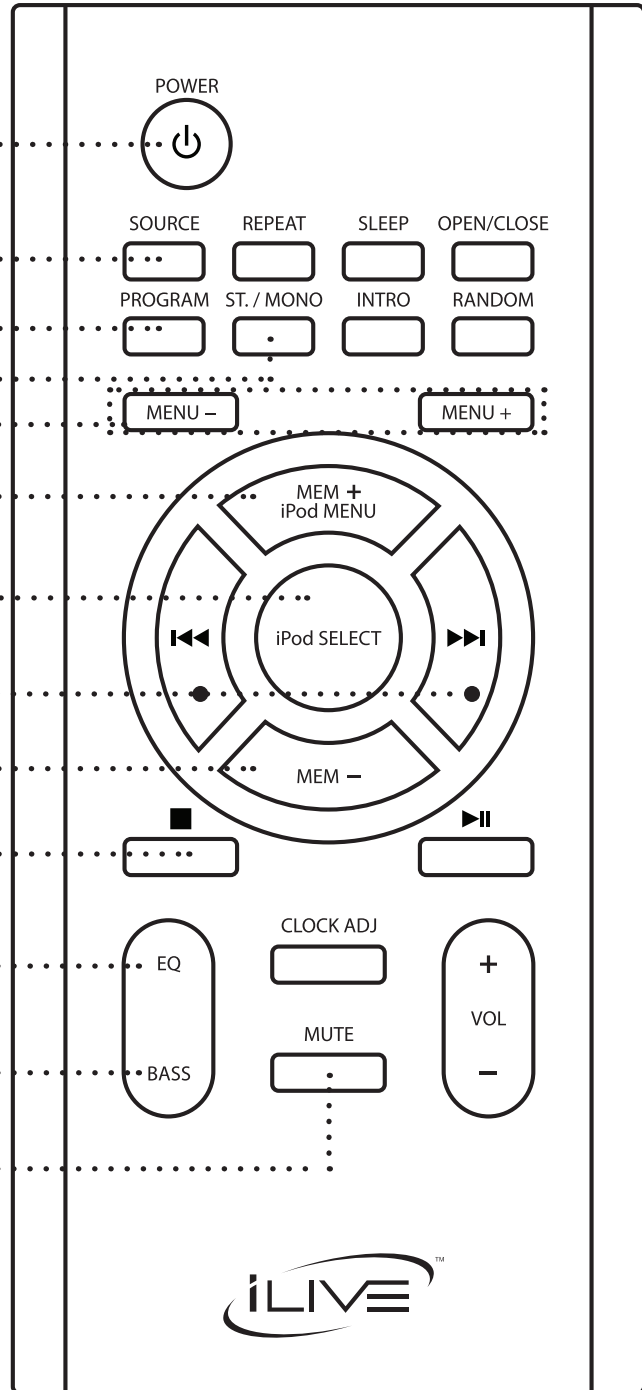

- 20. Power Button**
Press the Power Button to turn the unit off and on.
-
- 21. Source Button**
Press the Source Button to switch between CD, Tuner, iPod, and Aux modes.
-
- 22. Program Button**
Press the Program Button to program a loaded CD.

Press the Program Button to save an AM or FM radio station to the unit's memory.
-
- 23. St./Mono Button**
Press the St./Mono Button to switch between FM Stereo and FM mono modes.
-
- 24. Menu +/- Button**
Press the Menu - and + Buttons to move up and down through an iPod's menus.
-
- 25. Mem+/iPod Menu Button**
Press the Mem+ Button to cycle through radio stations saved to the unit's memory.

Press the iPod Menu Button to move back through previous menus on a docked iPod.
This button works exactly like the menu button on an iPod.
-
- 26. iPod Select Button**
Press the iPod Select Button to make selections on a docked iPod.

This button works exactly like the select button on an iPod.

- 27. Skip/Tune Button**
Press the Skip Button to skip between tracks on a loaded CD or docked iPod.

Press and hold the Skip Button to search through an individual track on a docked iPod or loaded CD.

Press the Tune Button to tune the AM or FM radio.
-
- 28. Mem- Button**
Press the Mem- Button to cycle through saved radio stations.
-
- 29. Stop Button**
Press the Stop Button to stop a CD during play.
-
- 30. EQ Button**
Press the EQ Button to adjust to Classic, Jazz, Rock, or Pop equalizer modes.
-
- 31. Bass Button**
Press the Bass Button to turn the Bass Enhancement on.
-
- 32. Mute Button**
Press the Mute Button to mute the volume.

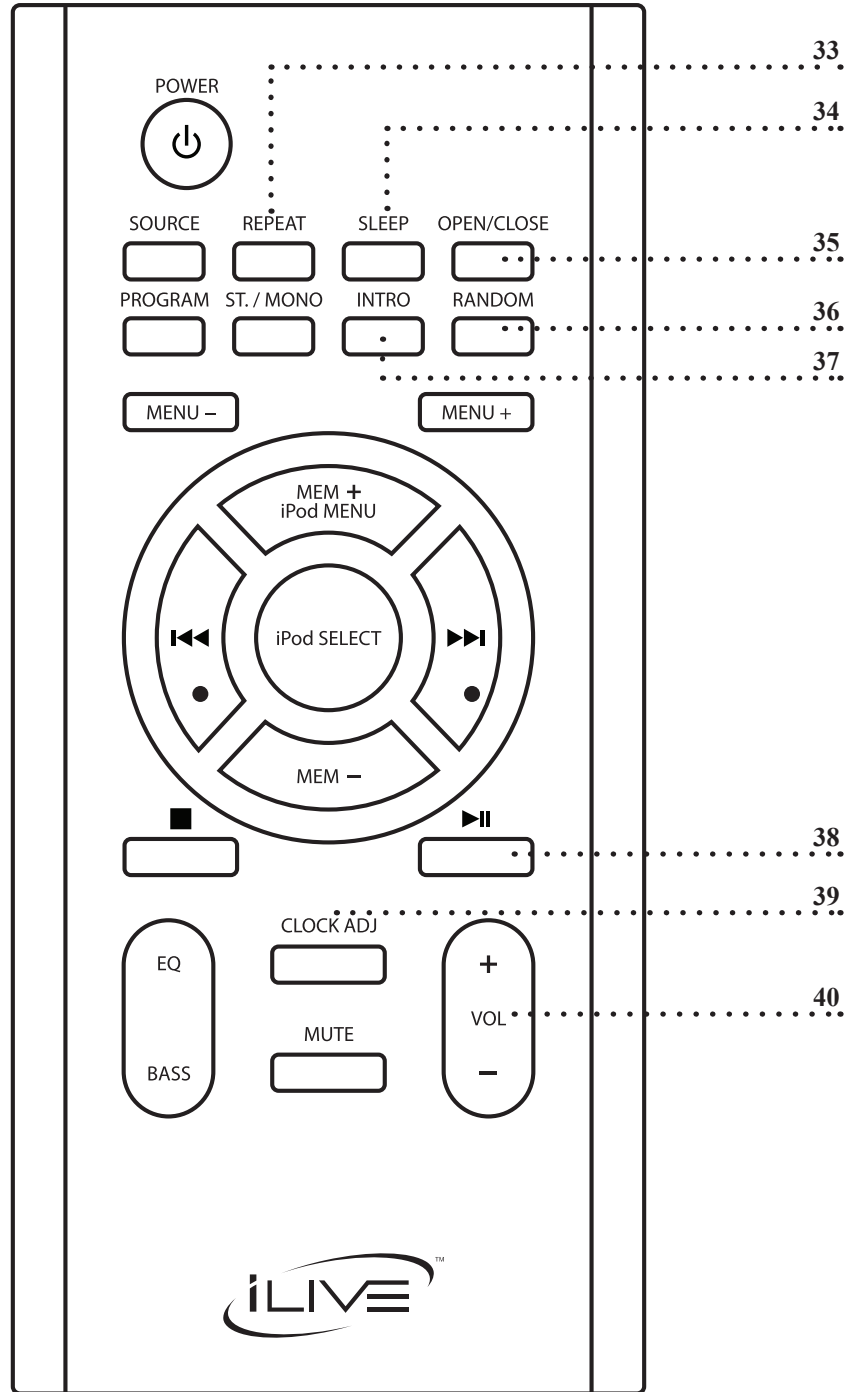

- 33. Repeat Button**
 Press the Repeat Button on the remote once to repeat the current track.
 Press the Repeat Button on the remote twice to repeat an entire album or playlist. Sleep Button.

- 34. Sleep Button**
 Press the Sleep Button consecutively to set the sleep timer between 90 and 10 minutes (in 10 minute increments).

- 35. Open/Close Button**
 Press the Open/Close Button to open or close the Motorized CD/iPod Door.

- 36. Random Button**
 Press the **Random Button** on the remote to play the current album or playlist in random order.

- 37. Intro Button**
 Press the **Intro Button** on the remote to activate *Intro Mode*. When in *Intro Mode*, the unit will play the first 10 seconds of a track and then skip to the next track.

- 38. Play/Pause Button**
 Press the Play/Pause Button to play or pause a CD or iPod.

- 39. Clock Adj Button**
 Press the Clock Adjust Button to set the unit's clock.

- 40. Volume Buttons**
 Press the Volume Buttons to adjust the volume of the unit.

COMPANY INFORMATION

INTERNATIONAL SUPPORT

To download this User's Guide in English, Spanish, or French, visit the support section at www.ilive.net.

Para transferir esta guía de usuario en inglés, español, o francés, visite la sección de la ayuda en www.ilive.net.

Pour télécharger ce guide de l'utilisateur en anglais, espagnol, ou français, visitez la section de soutien chez www.ilive.net.

SERVICE INFORMATION

Address: 2116 Carr Street, St. Louis MO, 63106

Phone: 1-314-621-2881

Fax: 1-314-588-1805

Email: customerservice@ilive.net

Parts Email: partsinfo@dpi-global.com

Website: www.ilive.net

Free Manuals Download Website

<http://myh66.com>

<http://usermanuals.us>

<http://www.somanuals.com>

<http://www.4manuals.cc>

<http://www.manual-lib.com>

<http://www.404manual.com>

<http://www.luxmanual.com>

<http://aubethermostatmanual.com>

Golf course search by state

<http://golfingnear.com>

Email search by domain

<http://emailbydomain.com>

Auto manuals search

<http://auto.somanuals.com>

TV manuals search

<http://tv.somanuals.com>