



# IS3 *IC2807BLK* INSTRUCTION MANUAL



# Warnings and Precautions

---

TO PREVENT FIRE OR SHOCK HAZARDS, DO NOT EXPOSE THIS UNIT TO RAIN OR MOISTURE.



This symbol, located on back or bottom of the unit, is intended to alert the user to the presence of uninsulated “dangerous voltage” within the product’s enclosure that may be of sufficient magnitude to constitute a risk of electric shock to persons.



This symbol, located on back or bottom of the unit, is intended to alert the user to the presence of important operating and maintenance (servicing) instructions in the literature accompanying the appliance.

**CAUTION:** TO PREVENT ELECTRIC SHOCK, MATCH WIDE BLADE OF PLUG TO WIDE SLOT, FULLY INSERT.

To reduce the risk of electric shock, do not remove cover (or back). There are no user-serviceable parts inside. Please refer any servicing to qualified service personnel.

**WARNING:** Changes or modifications to this unit not expressly approved by the party responsible for compliance could void the user’s authority to operate the equipment.

**NOTE:** This equipment has been tested and found to comply with the limits for a Class B digital device, pursuant to Part 15 of the FCC Rules. These limits are designed to provide reasonable protection against harmful interference in a residential installation. This equipment generates, uses, and can radiate radio frequency energy and, if not installed and used in accordance with the instructions, may cause harmful interference to radio communications. However, there is no guarantee that interference will not occur in a particular installation. If this equipment does cause harmful interference to radio or television reception, which can be determined by turning the equipment off and on, the user is encouraged to try to correct the interference by one or more of the following measures:

- Reorient or relocate the receiving antenna.
- Increase the separation between the equipment and receiver.
- Connect the equipment into an outlet on a circuit different from that to which the receiver is connected.
- Consult the dealer or an experienced radio/TV technician for help.

# Features

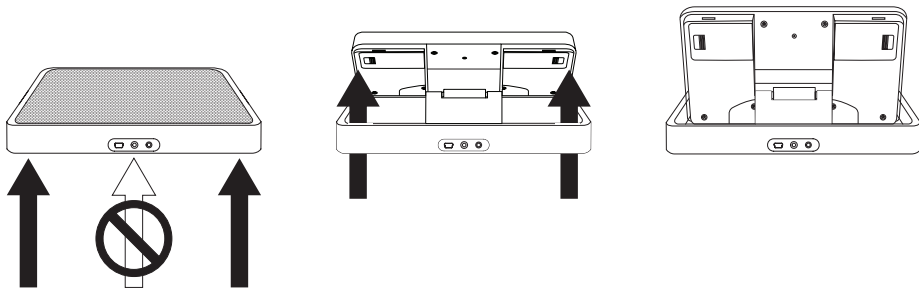
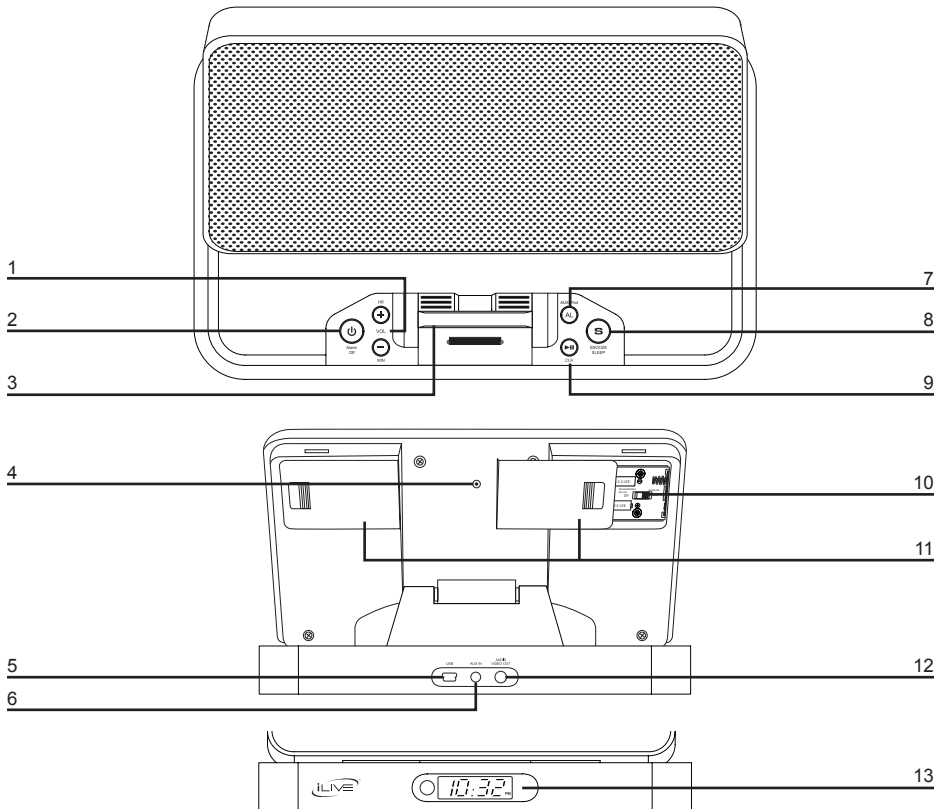

*When un-folding the player, press up on the back corners and not the center. Opening incorrectly and with too much force could damage the player.*

# Features Defined

---

- 1 **VOLUME, HOUR, MIN** Press the (+) button to increase the volume and adjust the hour when setting the clock. Press the (-) button to decrease the volume and adjust the minute when setting the clock.

---

  - 2 **POWER, Alarm Off** Press the POWER button to turn the player on. Press the Alarm Off button to turn the alarm off after it has sounded.

---

  - 3 **Universal iPod Docking Station** This iPod Docking Station adjusts to fit any iPod.

---

  - 4 **DC In (9V)** Plug the AC Adaptor in here to power the player and charge the batteries.

---

  - 5 **Mini-USB** Use the USB port to connect the player to a computer and sync an iPod with iTunes.

---

  - 6 **AUX In** Use the AUX jack to connect an iPod shuffle or other audio devices to the player.

---

  - 7 **AL (alarm), AUX/iPod** With the power off, use the AL button in conjunction with the HOUR and MIN buttons to set the alarm. Press the AUX/iPod button, with the power on, to switch between Aux and iPod modes.

---

  - 8 **S / SNOOZE, SLEEP** Press the S button to set the sleep timer on the player from 90 to 10 minutes, or to snooze the alarm after it has sounded.

---

  - 9 **PLAY/PAUSE, CLK** Press the PLAY/PAUSE button to play or pause an iPod. Use the CLK button in conjunction with the HOUR and MIN buttons to set the clock.

---

  - 10 **Rechargeable NiMH /ALKALINE** Use this switch to set the unit to charge the rechargeable NiMH battery, or to take standard AA Alkaline batteries.

---

  - 11 **Battery Compartment** (4- AA Alkaline Batteries or 4- AA NiMH Batteries, not included) Use and recharge rechargeable AA NiMH batteries inside the player. Adjust the internal toggle switch to ALK when using standard AA Alkaline batteries, and to NiMH when using rechargeable AA NiMH batteries.
-  *There is a danger of explosion if you attempt to charge standard AA batteries in the player.*
- 
- 12 **Audio/Video Out** Use the AV port to output audio and video to an external audio visual device.

---

  - 13 **LCD Display** View the Time, PM Indicator, Aux Indicator, and Alarm Indicator through this Liquid Crystal Display.

# Peripherals

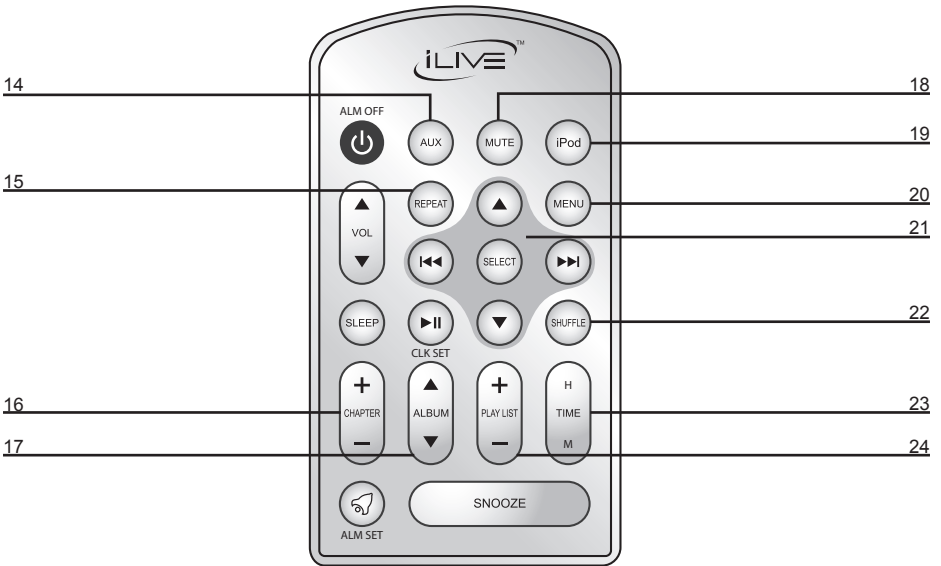

***Danger of explosion if batteries are incorrectly installed. Replace only with the same or equivalent battery. The button cell battery contains mercury. Do not put in the trash, instead recycle or dispose of as hazardous waste.***

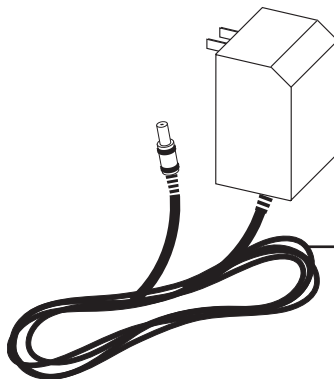

25

# Peripheral Defined

---

- 14 AUX** Press the AUX button to switch the player to AUX mode.
- 
- 15 REPEAT** Press the REPEAT button to set an iPod to repeat one song, or all songs.
- 
- 16 CHAPTER** Press (+) on the CHAPTER button to cycle up through the chapter number, or press (-) on the CHAPTER button to cycle down the chapter number.
- 
- 17 ALBUM** Press up on the ALBUM button to cycle the album number, or press down on the ALBUM button to decrease the album number.
- 
- 18 MUTE** Press the MUTE button to mute the sound on the player.
- 
- 19 iPod** Press the iPod button to switch the player into iPod mode.
- 
- 20 MENU** Press the MENU button to enter the menu on an iPod.
- 
- 21 Navigation Controls/SELECT** Use the Navigation Controls to move through an iPod menu system. Press the SELECT button to select a song, photo, or video on your iPod.
- 
- 22 SHUFFLE** Press the SHUFFLE button to randomly play songs on an iPod.
- 
- 23 TIME** Press the TIME button to cycle up through the hour and minute when setting the clock.
- 
- 24 PLAYLIST** Press up on the PLAYLIST button to cycle up through the playlists on an iPod, or press down on the PLAYLIST button to cycle down through the playlists on an iPod.
- 
- 25 AC Adaptor (120V / 60 Hz)** The detachable AC Cord provides power to the player.
-

# Operations

---

## Setting the Clock

- a. Press the CLK button on the unit.
- b. Press the HR button to cycle up through the hour.
- c. Press the MIN button to cycle up through the minute.
- d. Press the CLK button to set the specified time.

## Setting the Alarm

- a. Press and Hold the AL button on the unit or Alarm Set button on the remote.
- b. Press the HR button to cycle up through the hour.
- c. Press the MIN button to cycle up through the minute.
- d. Press the AL or Alarm Set button to set the specified time.
- e. With the power off, press the AL or Alarm Set button to turn the alarm on to buzzer or iPod.

## Viewing Video or Photos from your iPod on an External Device

- a. Using a video cable (1/8" phono to RCA), connect an external device such as a TV to the Video Out port on the player.
- b. Insert your iPod Video into the player and navigate to either the Photos or Videos on the iPod.
- c. Select either Slideshow Settings in Photos or Video Settings in Videos.
- d. Set the TV Out setting to On.
- e. Press the iPod button on the remote if the player isn't already set to iPod mode.
- f. Make sure your external viewing device is set to the proper mode. You will now be able to control your iPod from the player's control panel and remote, and view your iPod from an external device.

## Connecting Other Audio Devices

- a. With the power on, connect an iPod shuffle or other audio device to the aux-in port on the player via a line-in cord. (line-in cord not included)
- b. Press the iPod/AUX button and set the player to AUX mode.
- c. An iPod shuffle or other audio devices other will now play through the speakers of the player.
  - *You may need to turn the volume on the device up if you use a headphone output.*



## Service Information

---

**Address** 2116 Carr Street, St. Louis MO, 63106

**Phone** 1-314-621-2881

**Fax** 1-314-588-1805

**Email** [customerservice@ilive.net](mailto:customerservice@ilive.net)

**Website** [www.ilive.net](http://www.ilive.net)

---

To download this Instruction Manual in English, Spanish, or French visit the Support section at [www.ilive.net](http://www.ilive.net).

Para descargar este manual de instrucción en inglés, español, o francés visite la sección de la ayuda en [www.ilive.net](http://www.ilive.net).

Pour télécharger ce manuel d'instruction en anglais, espagnol, ou le Français visitez la section de soutien à [www.ilive.net](http://www.ilive.net).



## Free Manuals Download Website

<http://myh66.com>

<http://usermanuals.us>

<http://www.somanuals.com>

<http://www.4manuals.cc>

<http://www.manual-lib.com>

<http://www.404manual.com>

<http://www.luxmanual.com>

<http://aubethermostatmanual.com>

Golf course search by state

<http://golfingnear.com>

Email search by domain

<http://emailbydomain.com>

Auto manuals search

<http://auto.somanuals.com>

TV manuals search

<http://tv.somanuals.com>