



MODEL H8365 1/4 TON HIGH JACK STAND INSTRUCTION SHEET

⚠️ WARNING

To reduce the risk of death, serious personal injury or property damage when using this jack stand, take the following precautions:

- **DO NOT** overload this jack stand beyond the rated capacity of 1/4 ton. The rated load is for an evenly distributed, vertically applied load. Overloading may result in personal injury or property damage.
- This jack should only be used to help stabilize an already lifted vehicle or support hanging auxiliary components, such as a driveline or transmission. It is not designed to support the weight of an entire vehicle.
- **ONLY** use this jack stand on a hard level surface capable of sustaining the load being supported.
- Always make sure that the load point is centered in the saddle and that all three corners of the jack stand base are firmly on the ground.
- **Never** modify or alter this jack stand.
- **Never** release the jack stand when it is supporting a load.
- **DO NOT** over-extend the load. Over extension of the load may cause it to shift and swing.

Introduction

The Model H8365 1/4 ton high jack stand works at heights of 68" to 76 1/2" and supports a load of up to 1/4 ton.

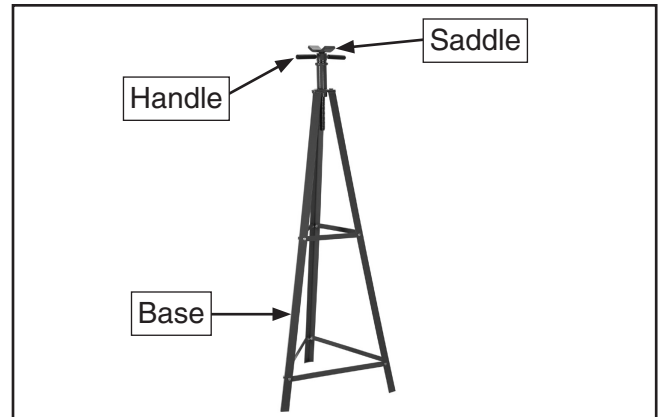

Figure 1. Model H8365.

Assembly

Refer to the **Parts Breakdown** located on the back of this page for assembly.

Operation Instructions

1. Before positioning the jack stand under the load, check to make sure that the vehicle is at an appropriate height and is secure.
2. Extend the post by holding the saddle and rotating the handle (**Figure 1**). Make sure that the saddle is centered under the load point. Do not over-extend the load or the load may shift and swing.
3. Slowly lower the component onto the jack stand, making sure that the load point is still centered and all three corners of the stand base are still on the ground.

To remove the jack stand, secure or remove the component until the jack stand can be lowered and removed. Remove the jack stand while the vehicle is securely supported.

COPYRIGHT © DECEMBER, 2007 BY GRIZZLY INDUSTRIAL, INC., REVISED FEBRUARY, 2008 (JM)

WARNING: NO PORTION OF THIS MANUAL MAY BE REPRODUCED IN ANY SHAPE OR FORM WITHOUT THE WRITTEN APPROVAL OF GRIZZLY INDUSTRIAL, INC.

#JM10211 PRINTED IN CHINA

H8365 Parts Breakdown and Parts List

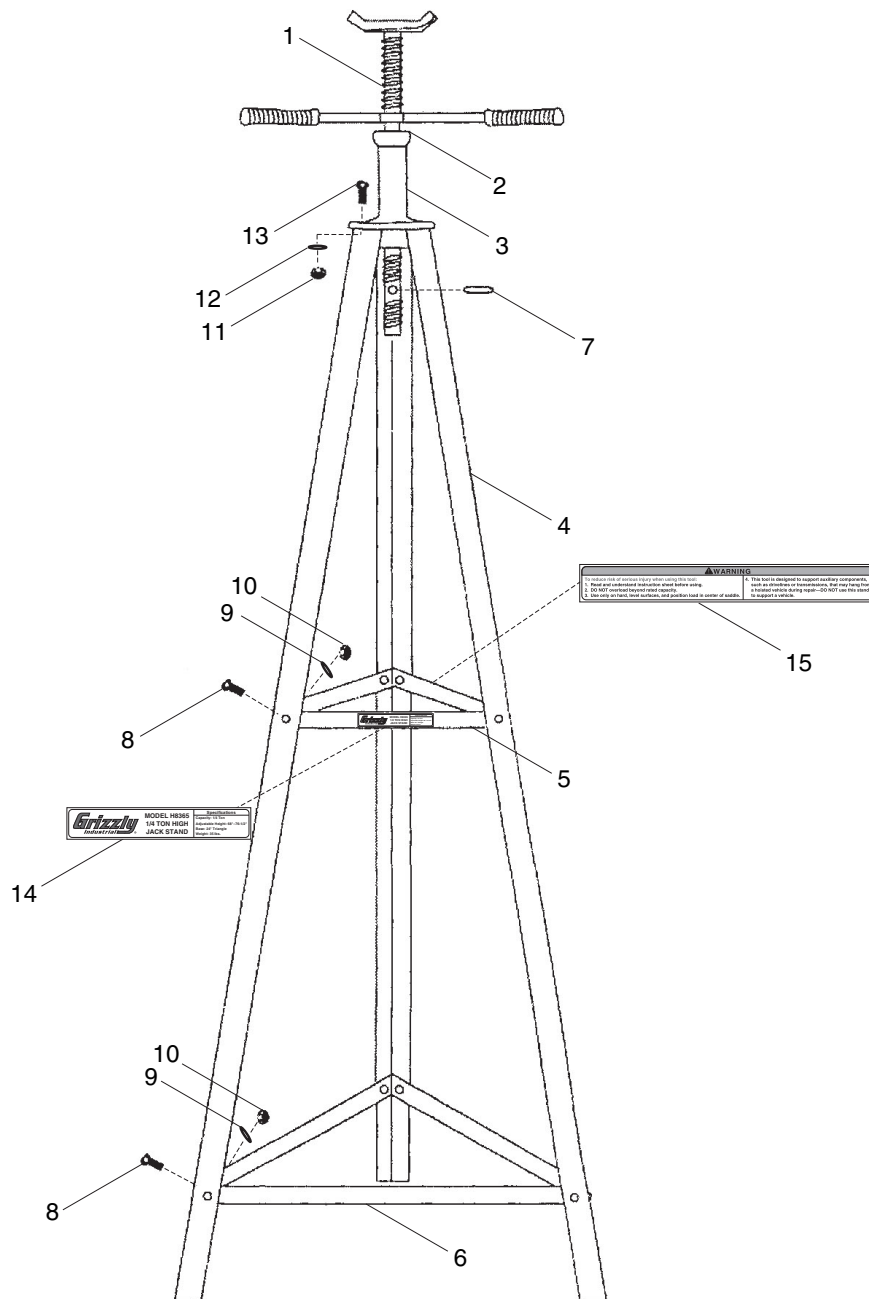

REF	PART #	DESCRIPTION
1	PH8365001	SADDLE ASSEMBLY
2	P51106	THRUST BEARING 51106
3	PH8365003	GUIDE
4	PH8365004	LEG
5	PH8365005	SMALL BRACE
6	PH8365006	LARGE BRACE
7	PH8365007	ROLL PIN 2 X 25
8	PB09M	HEX BOLT M8-1.25 X 20

REF	PART #	DESCRIPTION
9	PW01M	FLAT WASHER 8MM
10	PN03M	HEX NUT M8-1.25
11	PN02M	HEX NUT M10-1.5
12	PW04M	FLAT WASHER 10MM
13	PB01M	HEX BOLT M10-1.5 X 30
14	PH8365014	ID LABEL
15	PH8365015	WARNING LABEL

If you need help with the Model H8365, call our Technical Support line at: (570) 546-9663.

Free Manuals Download Website

<http://myh66.com>

<http://usermanuals.us>

<http://www.somanuals.com>

<http://www.4manuals.cc>

<http://www.manual-lib.com>

<http://www.404manual.com>

<http://www.luxmanual.com>

<http://aubethermostatmanual.com>

Golf course search by state

<http://golfingnear.com>

Email search by domain

<http://emailbydomain.com>

Auto manuals search

<http://auto.somanuals.com>

TV manuals search

<http://tv.somanuals.com>