



MODEL T10043 38" LAWN SWEEPER INSTRUCTION SHEET

Introduction

The Model T10043 38" Lawn Sweeper features four rows of bristle brushes, a large capacity leaf bag that swings up for dumping, adjustable height settings, and a universal hitch for towing behind any riding lawn mower.

Tools Needed for Assembly

- 10, 13, 14mm wrench and/or socket.
- Awl or similar tool.
- Crescent wrench (optional).

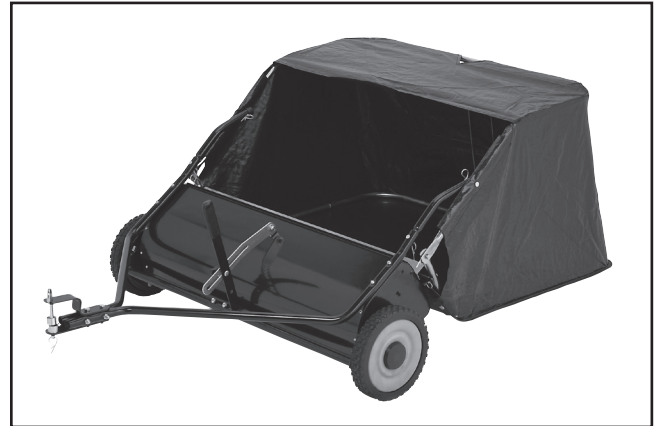

Figure 1. Model T10043 38" Lawn Sweeper.

⚠ CAUTION

To reduce the risk of injury when using this product:

- Read the vehicle and sweeper owner's manuals and know how to operate your vehicle and sweeper before using this sweeper attachment.
- Maximum speed limit while towing this sweeper is 6mph.
- Do not allow children or anyone without proper training to operate the sweeper.
- Do not use sweeper as a trailer for carrying people or animals.
- Keep all hardware tightened to be sure the sweeper is in safe working order.
- Never attach the leaf bag dump rope to any part of your body or clothing. Do not hold onto the rope while towing the sweeper.
- Attach the leaf bag dump rope to the towing vehicle and make sure it is kept away from wheels and rotating parts.
- If an object becomes lodged in the sweeper, do not attempt to remove it while the sweeper brush is moving.
- Only use the hitch for towing the trailer. Do not attempt to use rope or chain for towing.

COPYRIGHT © NOVEMBER, 2007 BY GRIZZLY INDUSTRIAL, INC.
WARNING: NO PORTION OF THIS MANUAL MAY BE REPRODUCED IN ANY SHAPE
OR FORM WITHOUT THE WRITTEN APPROVAL OF GRIZZLY INDUSTRIAL, INC.
#JB10063 PRINTED IN CHINA

Unpacking

After all the parts have been removed from the box, you should have the following items:

Box Contents (Figure 2)		Qty
A.	Leaf Bag (Not Shown).....	1
B.	Sweeper Assembly.....	1
C.	Leaf Bag Dump Rope.....	1
D.	Hitch Tube Set	1

Box Contents (Figure 3)		Qty
E.	Bag Frame Bar.....	1
F.	Support Rods	2
G.	Lower Bag Tubes.....	2
H.	Upper Bag Tubes.....	2
I.	Rear Bag Tubes.....	2
J.	Hitch Spacers.....	2
K.	Rubber Caps.....	2
L.	Height Adjustment Lever.....	1
M.	Height Adjustment Lock Plate.....	1
N.	Flat Hitch Bracket.....	1
O.	Raised Hitch Bracket.....	1
P.	Bag Mounting Tubes.....	2
Q.	L Bracket.....	1

Hardware (Figure 4)		Qty
R.	Hex Bolts M8-1.25 x 65.....	2
S.	Hex Bolts M8-1.25 x 55.....	2
T.	Hex Bolts M8-1.25 x 40.....	2
U.	Hex Bolts M8-1.25 x 16.....	2
V.	Hex Bolts M6-1 x 40.....	4
W.	Lock Nuts M6-1	4
X.	Carriage Bolt M8-1.25 x 20	1
Y.	Lock Nuts M8-1.25	8
Z.	Clevis Pins M6 x 33	4
AA.	Clevis Pins M8 x 50	2
BB.	Clevis Pins M10 x 15	2
CC.	Hairpin Cotter Pins 2mm.....	4
DD.	Hairpin Cotter Pins 3mm.....	5
EE.	Plastic Plugs.....	4
FF.	Fender Washer 8mm	1
GG.	Spacer 15MM x 3.5mm.....	1
HH.	Flat Washer 8mm.....	1
II.	Friction Washers 8mm	2
JJ.	Knob.....	1
KK.	Hitch Pin.....	1

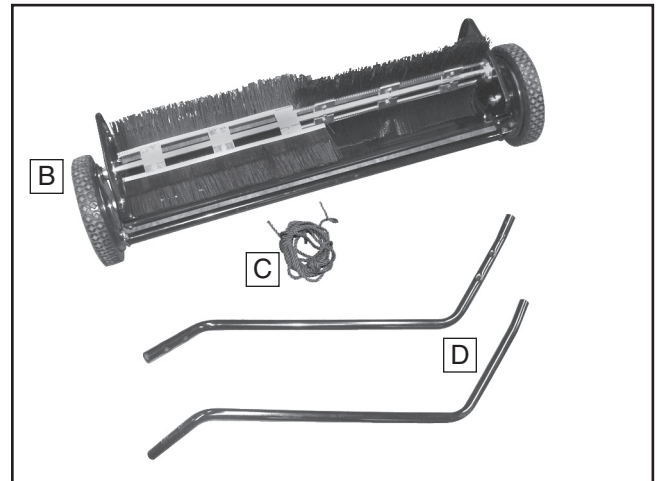

Figure 2. Box contents 1.

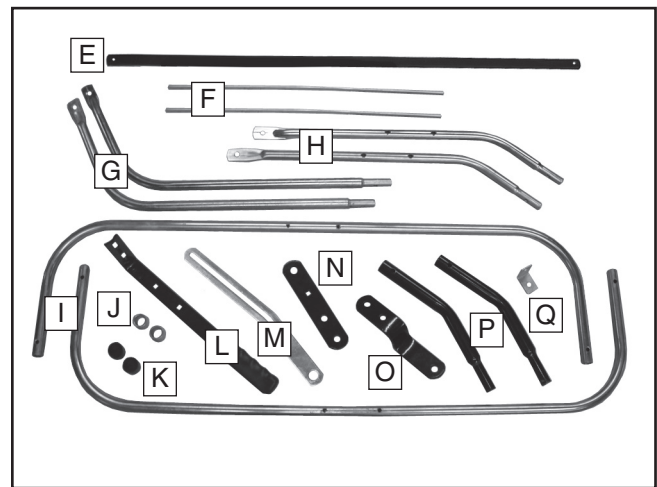

Figure 3. Box contents 2.

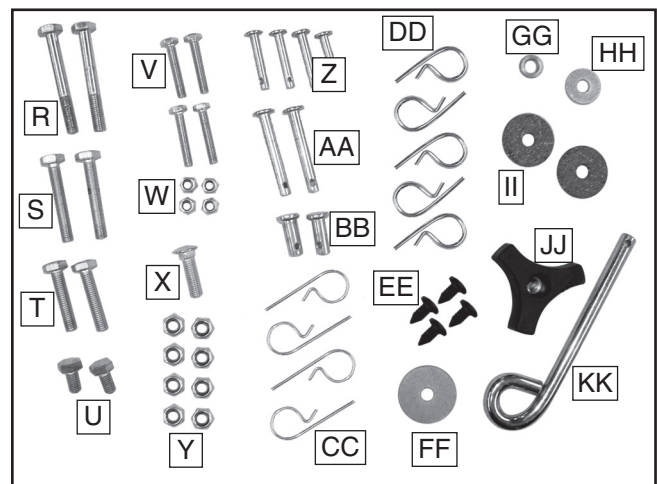

Figure 4. Hardware.

If any nonproprietary parts are missing (e.g. a nut or a washer), we will gladly replace them, or for the sake of expediency, replacements can be obtained at your local hardware store.



Assembly

1. Attach the hitch tubes to the sweeper assembly as shown in **Figure 5**. Do not tighten the hardware at this time. Refer to the inventory figures on **Page 2** for hardware identification.

Note: Make sure the rear ends of the hitch tubes angle slightly upward, as shown in **Figure 5, Detail A**. If they angle downward, this means the left tube is positioned on the right side and vice-versa. Reverse the placement of the hitch tubes, then attach them.

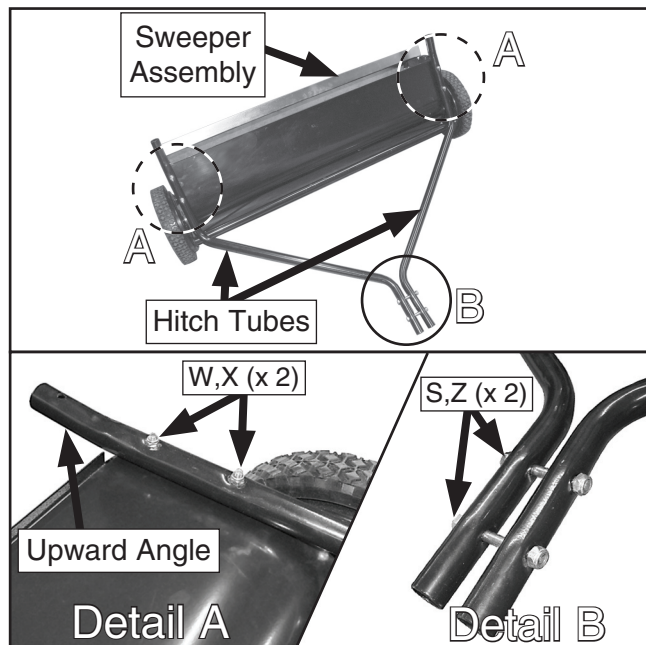

Figure 5. Frame assembly.

2. Measure the height of the hitch on your riding lawn mower.

—If the mower hitch height is less than 11", then assemble the sweeper as shown in **Figure 6**.

—If the mower hitch height is more than 11", then assemble the sweeper as shown in **Figure 7**.

Assemble the hitch using the flat hitch bracket, the raised hitch bracket, the M8-1.25 x 55 hex bolts, and two of the M8-1.25 hex nuts. Be sure the hex bolts fit between the hex bolts from **Step 1** (**Figures 6** and **7**).

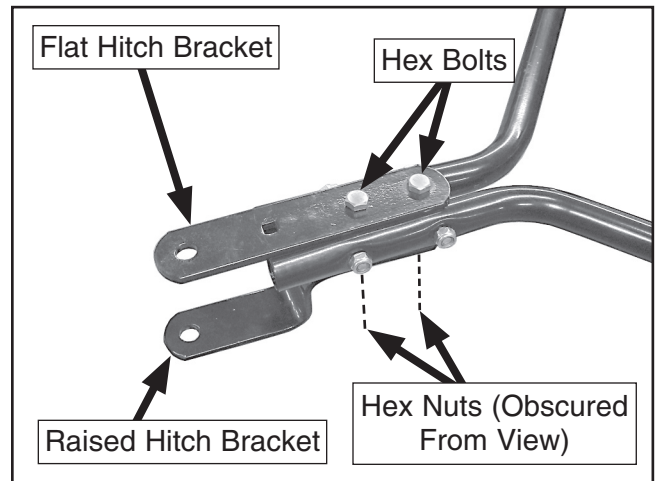

Figure 6. Hitches under 11".

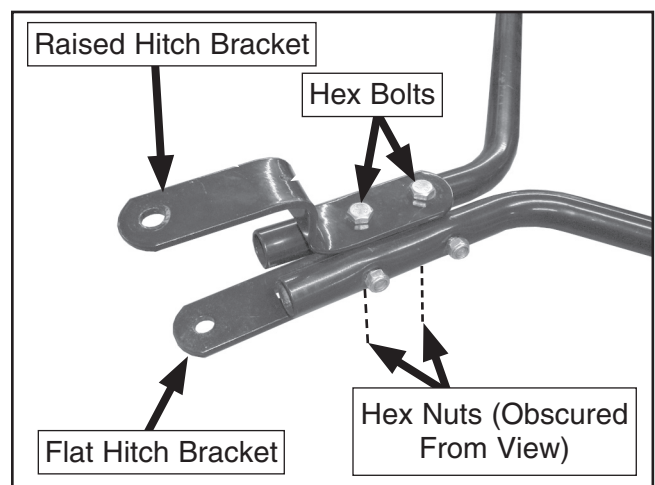

Figure 7. Hitches over 11".

3. Tighten all hardware from **Steps 1** and **2**.
4. Insert the hitch pin and the hitch spacers, and secure them with a 3mm hairpin cotter pin, as shown in **Figure 8**.

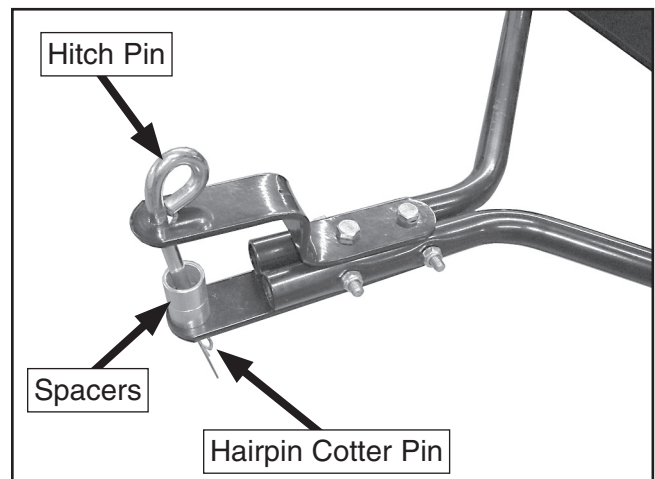

Figure 8. Hitch Pin.

- Assemble the height adjustment lever, as shown in **Figure 9**. Refer to the inventory figures on **Page 2** for hardware identification.

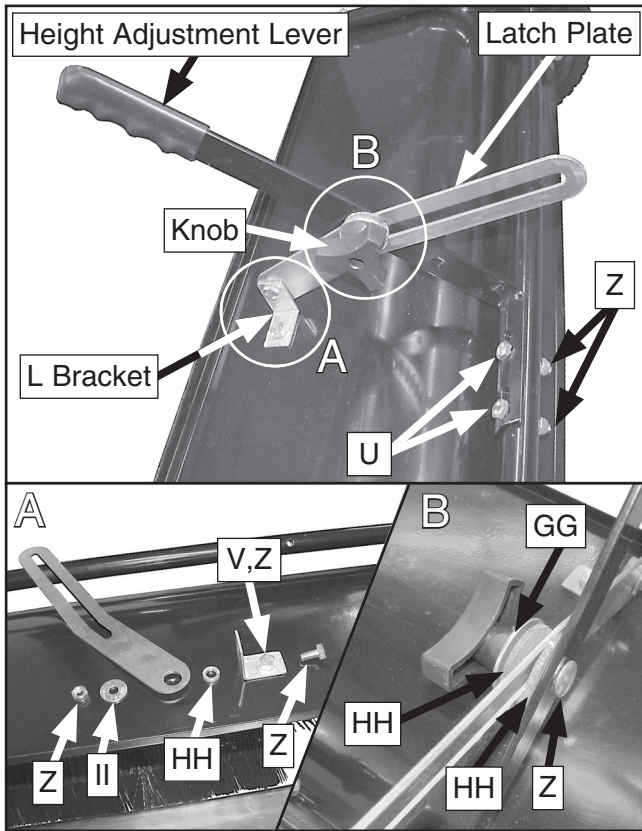

Figure 9. Height adjustment lever.

- Insert one of the rear bag tubes through the loops in the leaf bag. Make sure the holes in the tube are facing down, as shown in **Figure 10**.

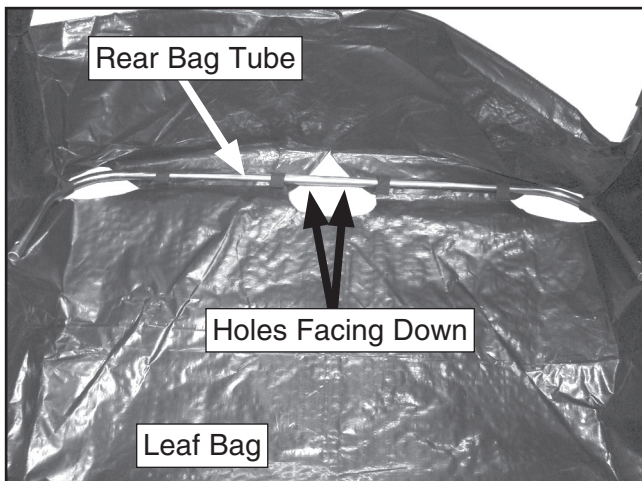

Figure 10. Rear bag tube placement.

- Insert the upper bag tube through the pocket in the leaf bag and into the rear bag tube, then secure it with a plastic plug, as shown in **Figure 11**. Repeat for both sides.

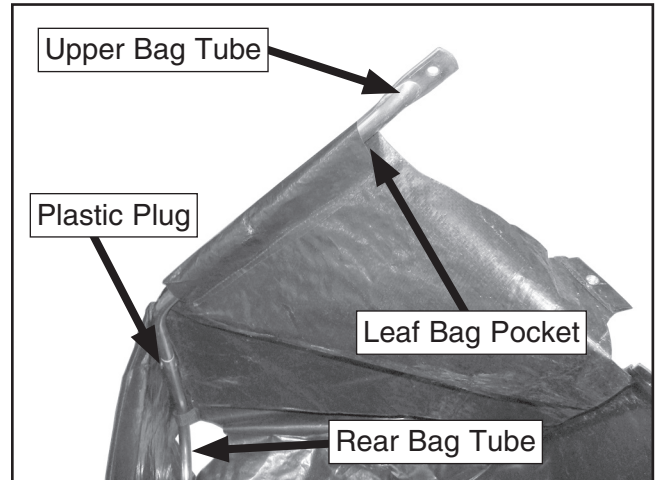

Figure 11. Rear bag tube placement.

- Assemble the lower bag tubes, the remaining rear bag tube, and the remaining plastic plugs, as shown in **Figure 12**. Make sure the holes in the rear bag tube are facing up.

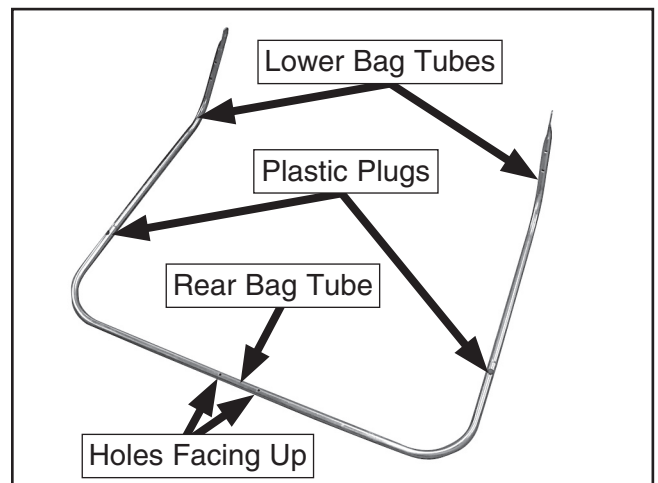

Figure 12. Lower leaf bag frame assembly.

- Place the assembled lower leaf bag frame into the leaf bag and connect it to the upper frame tubes with the M10 x 15 clevis pins and two 3mm hairpin cotter pins, as shown in **Figure 13**. Repeat for both sides.

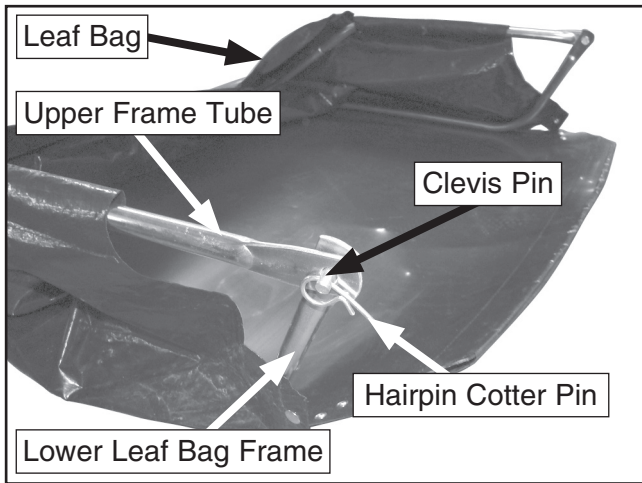

Figure 13. Upper and lower frame connection.

- Connect the snaps, as shown in **Figure 14**, then slide the bag frame bar into the pocket in the leaf bag and secure it with two M6 x 33 clevis pins and two 2mm hairpin cotter pins.

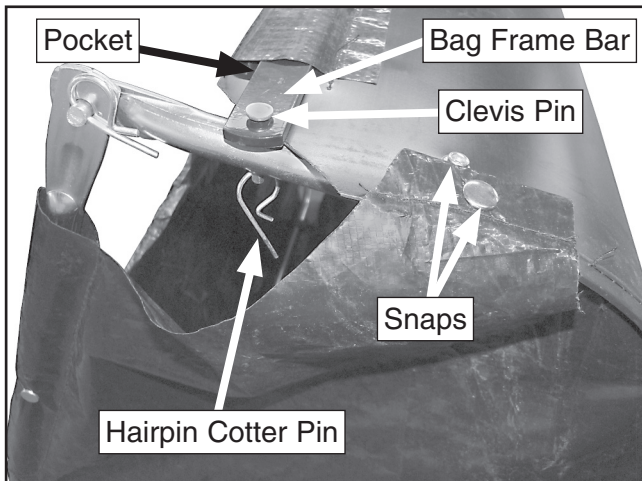

Figure 14. Bag frame bar.

- Insert the two support rods between the upper and lower bag frame assemblies, as shown in **Figure 15**.

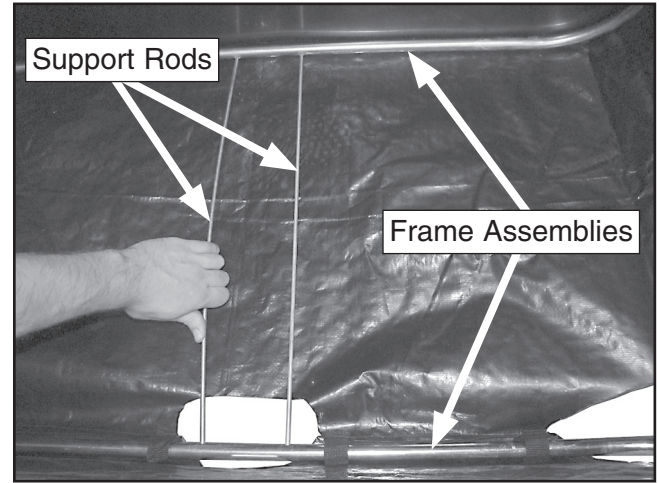

Figure 15. Support rods.

- Feel along the length of the upper bag tube for the hole in the area indicated by the **Figure 16** inset. Puncture the leaf bag using an awl or similar device, as shown. Attach the bag mounting tube to the upper bag tube with an M8 x 50 clevis pin, and secure it with a 3mm hairpin cotter pin. Place a rubber cap over the end of the bag mounting tube, as shown in **Figure 16**. Repeat for both sides.

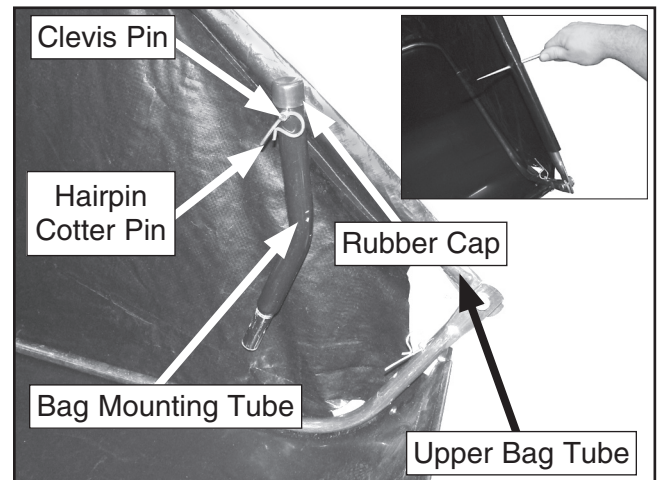

Figure 16. Bag mounting tube.

- Attach the leaf bag assembly to the sweeper assembly using an M6 x 33 clevis pin and a 2mm hairpin cotter pin, as shown in **Figure 17**. Repeat for both sides.

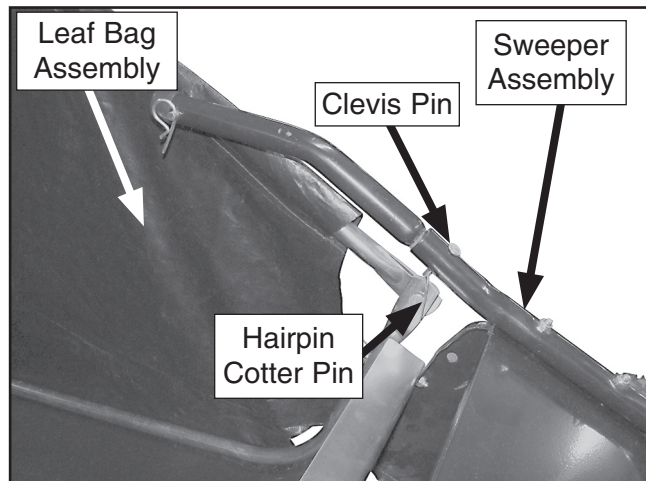

Figure 17. Bag attachment.

- Attach the leaf bag dump rope to the leaf bag frame, as shown in **Figure 18**.

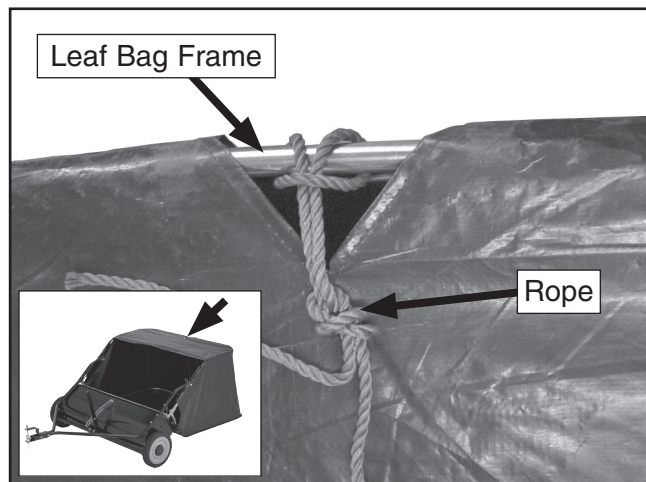

Figure 18. Rope attachment.

⚠ CAUTION

Make sure the leaf bag dump rope is secured to the riding mower during use but does not interfere with the operation of the mower. Additionally, make sure the leaf bag dump rope is not in a position to become entangled in the wheels or brushes of the sweeper. Failure to safely secure the rope during use can damage the sweeper or cause you to lose control of the mower.

Operations

The Model T10043 can be raised or lowered to achieve the optimal sweeping height for different surfaces.

Adjust the position of the brushes so that they extend approximately ½" into the grass.

To adjust the brush height:

- Loosen the height adjustment knob, then reposition the height adjustment lever. When the desired height is reached, tighten the height adjustment knob (**Figure 19**).

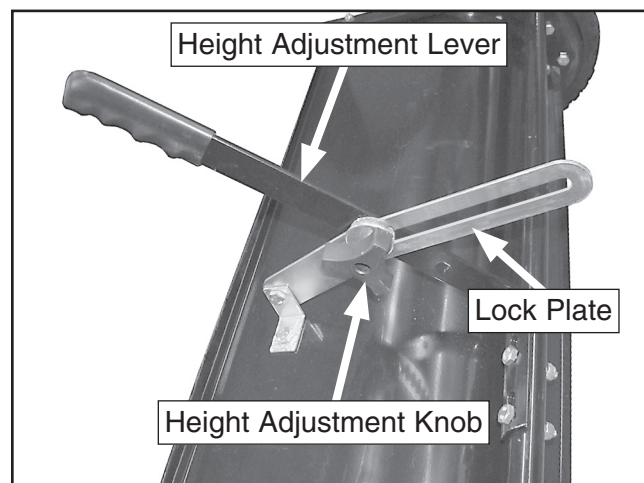

Figure 19. Height Adjustment.

Tips for using the Model T10043 Lawn Sweeper:

- Empty the leaf bag after every use.
- To dump the leaf bag, pull the leaf bag dump rope forward or lift the rear of the leaf bag.
- For best results and ease of use, be sure the height is properly adjusted for both the surface being swept and the hitch height of the mower.
- Follow the maintenance schedule outlined in these instructions to prevent unnecessary wear on your sweeper.



Maintenance

To prevent excessive wear, periodically lubricate the brush shaft bushings, the wheel bushings, and grease the ratchet assemblies in each wheel unit.

To lubricate the bushings:

1. Tilt the sweeper onto its side and apply a few drops of light oil to the brush shaft, as shown in **Figure 20**.

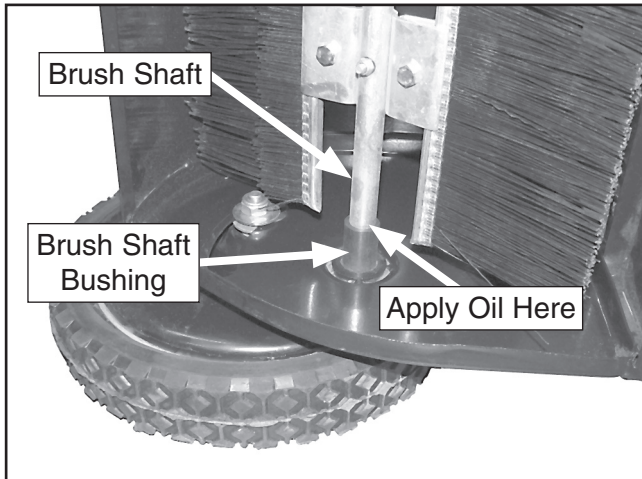

Figure 20 Brush shaft bushing lubrication.

2. With the sweeper still on its side, remove the dust cap on the exposed wheel, then remove the wheel nut and washer, as shown in **Figure 21**.

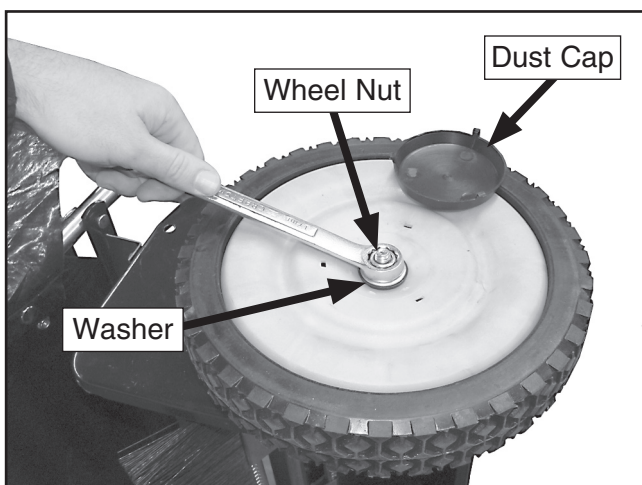

Figure 21. Wheel nut removal.

3. Apply a few drops of light oil to the wheel bushings, as shown in **Figure 22**, and spin the wheel to distribute the oil. Replace the washer, wheel nut, and the dust cap. Flip the sweeper on to the other side and repeat **Steps 1-3** for the other bushings.

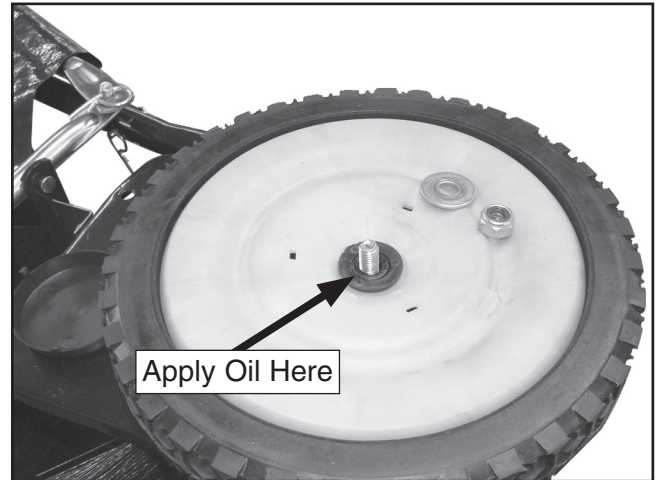

Figure 22. Wheel nut removal.

Every two years, the ratchet assemblies in each wheel should be cleaned and greased.

Note: When performing this procedure, take notes on the position of all washers, spacers, and retaining rings. Work on one side at a time to avoid mixing directional components.

To grease the ratchet assemblies:

1. Remove the dust cover, wheel nut, and washer, as described in **Step 2** of "To Lubricate the Bushings", then remove the wheel (**Figure 23**).

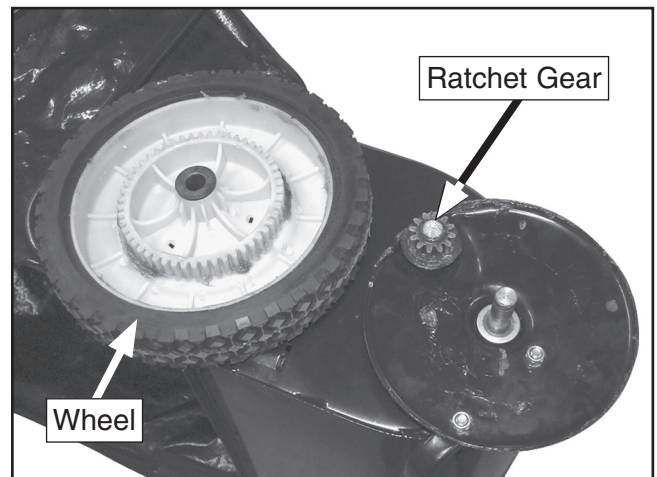

Figure 23. Wheel removed.

2. Remove the retaining clip from the brush shaft, then remove the spacers (**Figure 24**).

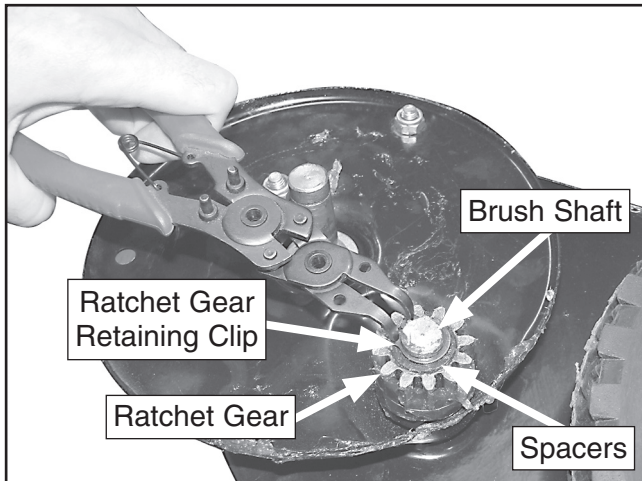

Figure 24. Ratchet gear assembly.

3. Remove the ratchet gear, the spacers on either side of the ratchet gear, and the ratchet pin (**Figure 25**).

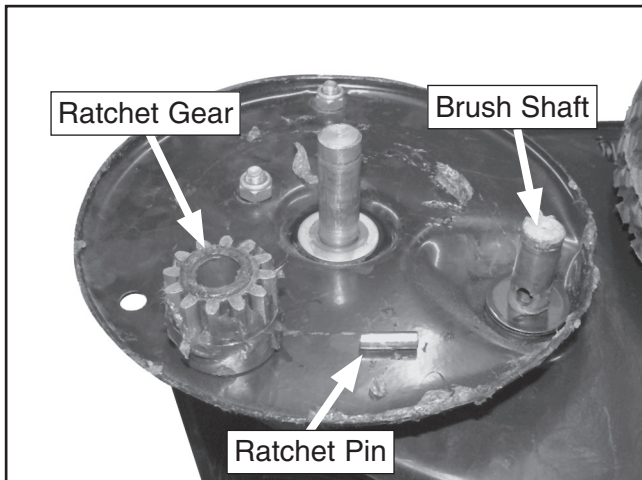

Figure 25. Ratchet gear assembly.

4. Thoroughly clean, then grease the parts using multi-purpose grease. Re-assemble in the reverse order from disassembly.
5. Repeat for the other wheel.

With extensive use, the brushes on the Model T10043 may become worn and require replacement.

To replace the brushes:

1. Tilt the sweeper all the way forward to allow easy access to the brushes. For the sake of simplicity, only replace one brush at a time.
2. Remove the lock nuts and hex bolts indicated in **Figure 26**, and remove the old brushes. It is not necessary to remove the bolts and nuts connecting the brush holder to the brush shaft.

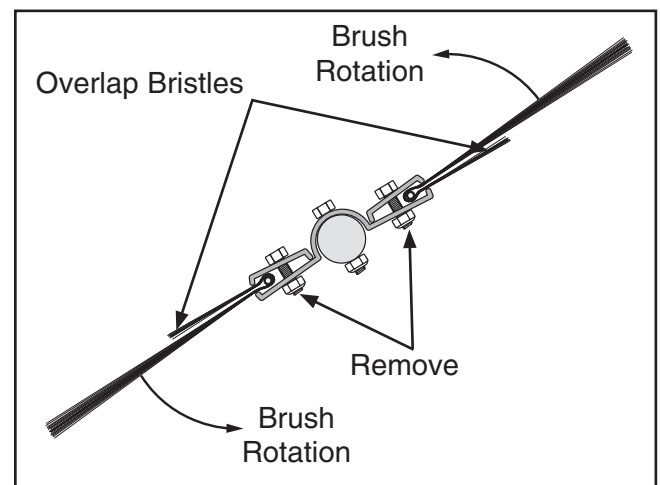
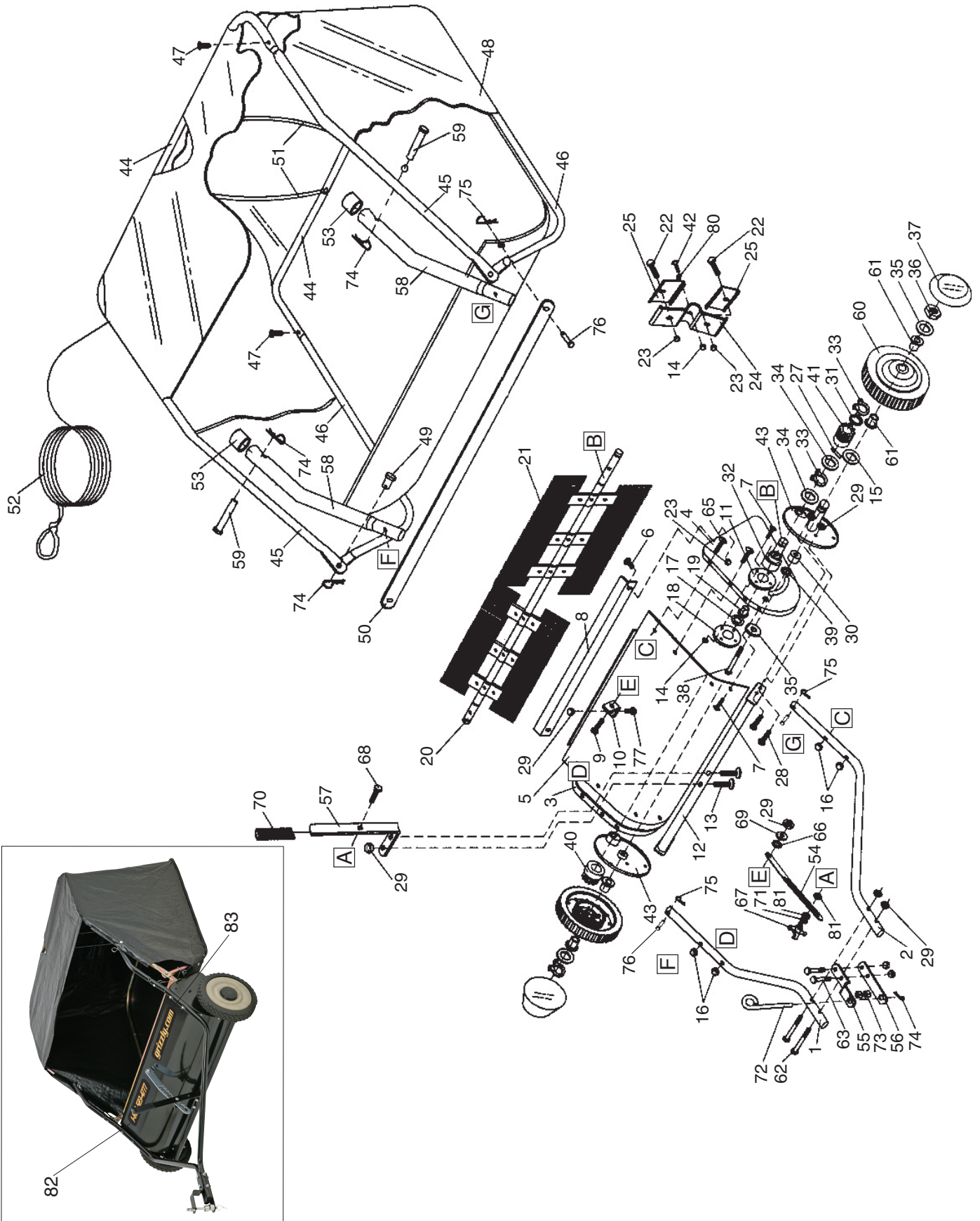

Figure 26. Brush assembly (end view).

3. Install the new brush, making sure the overlap bristles are properly oriented in relationship to the direction of brush rotation, as shown in **Figure 26**. Tighten the hex nuts.

T10043 Parts & Labels Breakdown



T10043 Parts & Labels List

REF	PART #	DESCRIPTION
1	PT10043001	RIGHT HITCH TUBE
2	PT10043002	LEFT HITCH TUBE
3	PT10043003	RIGHT SIDE ENDPLATE
4	PT10043004	LEFT SIDE ENDPLATE
5	PT10043005	SWEEPER BODY
6	PB02M	HEX BOLT M6-1 X 12
7	PS08M	PHLP HD SCR M5-.8 X 12
8	PT10043008	REAR SUPPORT BRACE
9	PB03M	HEX BOLT M8-1.25 X 16
10	PT10043010	ANGLE BRACKET
11	PT10043011	OUTER SHAFT FLANGE
12	PT10043012	HEIGHT ADJUST TUBE ASSEMBLY
13	PB15M	HEX BOLT M8-1.25 X 40
14	PLN02M	LOCK NUT M5-.8
15	PT10043015	WHEEL SPACER
16	PLN03M	LOCK NUT M6-1
17	PT10043017	SPECIAL WASHER
18	PT10043018	INNER SHAFT FLANGE
19	PT10043019	BRUSH SHAFT BUSHING
20	PT10043020	BRUSH SHAFT
21	PT10043021	BRUSH
22	PB08M	HEX BOLT M6-1 X 20
23	PLN03M	LOCK NUT M6-1
24	PT10043024	BRUSH HOLDER
25	PT10043025	BRUSH HOLDER CLAMP
27	PT10043027	RATCHET PIN
28	PB03M	HEX BOLT M8-1.25 X 16
29	PLN04M	LOCK NUT M8-1.25
30	PT10043030	AXLE SPACER
31	PT10043031	OUTER SPACER
32	PT10043032	BUSHING
33	PR05M	EXT RETAINING RING 15MM
34	PT10043034	INNER SPACER
35	PW04M	FLAT WASHER 10MM
36	PLN05M	LOCK NUT M10-1.5
37	PT10043037	WHEEL DUST CAP
38	PT10043038	HEX BOLT M10-1.5 X 85
39	PT10043039	SPACER BUSHING
40	PT10043040	RATCHET GEAR RIGHT
41	PT10043041	RATCHET GEAR LEFT

REF	PART #	DESCRIPTION
42	PB94M	HEX BOLT M5-.8 X 25
43	PT10043043	WHEEL BACKING PLATE
44	PT10043044	REAR BAG TUBE
45	PT10043045	UPPER BAG TUBE
46	PT10043046	LOWER BAG TUBE
47	PT10043047	PLASTIC PLUG
48	PT10043048	LEAF BAG
49	PT10043049	CLEVIS PIN M10 X 15
50	PT10043050	BAG FRAME BAR
51	PT10043051	SUPPORT ROD
52	PT10043052	BASKET ROPE
53	PT10043053	END CAP
54	PT10043054	HEIGHT ADJUST LOCK PLATE
55	PT10043055	RAISED HITCH BRACKET
56	PT10043056	FLAT HITCH BRACKET
57	PT10043057	HEIGHT ADJUST LEVER
58	PT10043058	BAG MOUNTING TUBE
59	PT10043059	CLEVIS PIN M8 X 50
60	PT10043060	WHEEL ASSEMBLY
61	PT10043061	WHEEL BUSHING
62	PB86M	HEX BOLT M8-1.25 X 65
63	PB22M	HEX BOLT M8-1.25 X 50
65	PB52M	HEX BOLT M6-1 X 35
66	PT10043066	SPACER
67	PT10043067	KNOB
68	PCB30M	CARRIAGE BOLT M8-1.25 X 30
69	PW01M	FLAT WASHER 8MM
70	PT10043070	RUBBER GRIP
71	PWF08M	FENDER WASHER 8MM
72	PT10043072	HITCH PIN
73	PT10043073	HITCH SPACER
74	PT10043074	HAIRPIN COTTER PIN 3MM
75	PT10043075	HAIRPIN COTTER PIN 2MM
76	PT10043076	CLEVIS PIN M6 X 33
77	PB03M	HEX BOLT M8-1.25 X 16
80	PTLW17M	INT TOOTH WASHER 5MM
81	PT10043081	FRICTION WASHER 8MM
82	PT10043082	GRIZZLY 1-800 LABEL
83	PT10043083	GRIZZLY.COM LABEL

Free Manuals Download Website

<http://myh66.com>

<http://usermanuals.us>

<http://www.somanuals.com>

<http://www.4manuals.cc>

<http://www.manual-lib.com>

<http://www.404manual.com>

<http://www.luxmanual.com>

<http://aubethermostatmanual.com>

Golf course search by state

<http://golfingnear.com>

Email search by domain

<http://emailbydomain.com>

Auto manuals search

<http://auto.somanuals.com>

TV manuals search

<http://tv.somanuals.com>