

Replacement Parts & Labels

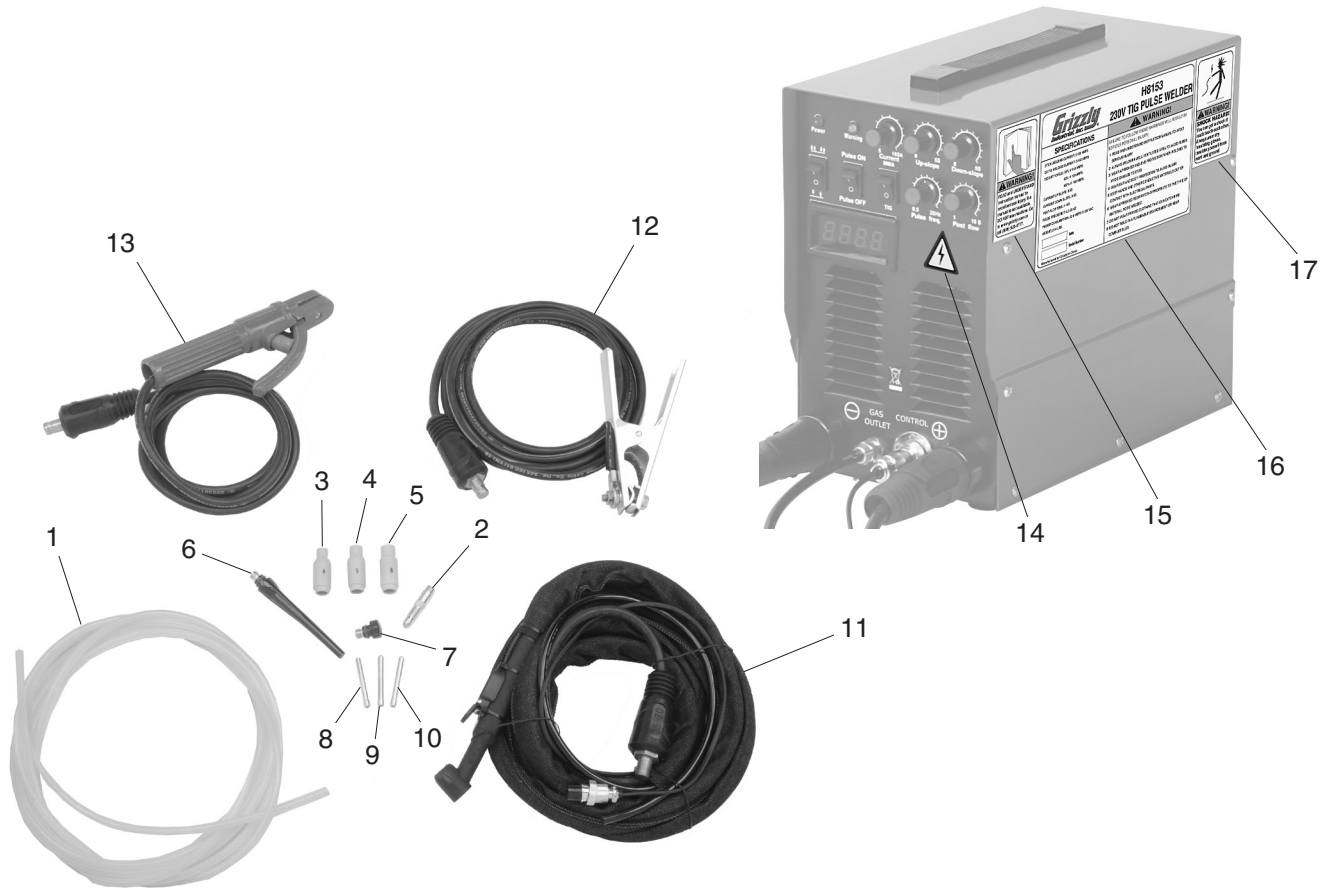

REF	PART #	DESCRIPTION
1	PH8153001	GAS INLET TUBE
2	PH8153002	COLLET BODY
3	PH8153003	GAS NOZZLE #4
4	PH8153004	GAS NOZZLE #5
5	PH8153005	GAS NOZZLE #6
6	PH8153006	LONG COLLET BACKCAP
7	PH8153007	SMALL COLLET BACKCAP
8	PH8153008	COLLET 1.6MM
9	PH8153009	COLLET 1.8MM

REF	PART #	DESCRIPTION
10	PH8153010	COLLET 2MM
11	PH8153011	TIG TORCH & CABLE ASSEMBLY
12	PH8153012	WORK CLAMP & CABLE
13	PH8153013	ELECTRODE CLAMP & CABLE
14	PLABEL-14	ELECTRICITY LABEL
15	PLABEL-12	READ MANUAL LABEL
16	PH8153016	WELDER ID LABEL
17	PH8153017	SHOCK WARNING LABEL

WARNING

Safety labels warn about machine hazards and ways to prevent injury. The owner of this welder **MUST** maintain the original location and readability of the labels on the welder. If any label is removed or becomes unreadable, **REPLACE** that label before using the welder again. Contact Grizzly at (800) 523-4777 or www.grizzly.com to order new labels.



Free Manuals Download Website

<http://myh66.com>

<http://usermanuals.us>

<http://www.somanuals.com>

<http://www.4manuals.cc>

<http://www.manual-lib.com>

<http://www.404manual.com>

<http://www.luxmanual.com>

<http://aubethermostatmanual.com>

Golf course search by state

<http://golfingnear.com>

Email search by domain

<http://emailbydomain.com>

Auto manuals search

<http://auto.somanuals.com>

TV manuals search

<http://tv.somanuals.com>