

Double Drive Fully Automatic Washing Machine
User's manual

Haier

This manual is for
HWM65-828

- Please read this manual carefully before using.
- Retain it for future reference.

Haier

CONTENTS

- Names of the parts... .. 1
- Meaning and description of the symbols... .. 1
- Safety precautions... .. 2
- Installation and adjustment... .. 4
- Preparation before washing... .. 9
- Put in the laundries... .. 10
- Usage of the detergent... .. 10
- Use the operation buttons... .. 11
- Close the top lid... .. 14
- Finish washing... .. 14
- Disposal after washing... .. 15
- Trouble-shooting answer to question... .. 16
- Packing list 17
- Specifications..... 17

Packing list

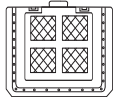
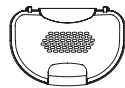
Name	Quantity	Storage position
● User's manual	● One	● Inside the document bag
● Components of the water inlet hose 	● One	● Inside the accessory bag
● Bottom plate 	● One	● Between the upper cushion of the washing machine package and the upper seal of the package carton
● Inner cover component 	● One	● Inside the accessory bag
● Double Drive Full Automatic washing machine	● One	

Specifications

Water level/Water quantity (about)	1/12L、2/15L、3/18L、4/22L、5/25L、6/29L、7/32L、8/35L、9/39L、10/43L、11/47L、12/51L
Water injection pressure	0.03MPa ~ 1.0MPa
Washing / Spinning capacity	6.5kg/6.5kg

Trouble-shooting answer to question

(If there's breakdown, please pull off the power plug before checking) The following phenomena are not breakdowns sometimes. Please confirm again before sending it to repair. If there are real breakdowns, please come to the special maintenance department or after-sale service department of our company. Do not repair it by yourself.

Phenomena	The reason	How to settle
The digitron displays E0.	● The top lid is opened during reserve procedure.	● Close the top lid.
The drainage cannot work, or is too slow. The digitron displays E1.	● Is the drain hose put down? ● Is the drain hose blocked?	● Put down the drain hose. Open and close the top lid once. ● Clean the foreign material. Open and close The top Lid Once.
It stops running in midway. The digitron displays E2.	● The top lid is not closed.	● Close the top lid.
The safety switch acts, and the spinning cannot work. The digitron displays E3.	● Are the laundries put slantingly? ● Is the machine slanting?	● Reorder the laundries. Close the top lid. ● The machine will start running after 10 seconds of being placed horizontally.
The water filling does not work, the digital displays E4.	● Is the water tap opened, or is there water supply failure? ● Is the water inlet valve blocked? ● Is the water pressure too low?	● Open the water tap. Open and close the top lid once. ● Clean the water inlet valve. Open and close the top lid once. ● Open and close the top lid once. Use until the water pressure is normal.
The digitron displays E6.	● The water level sensor is bad.	● Please contact the after-sales service department.
The machine does not act	Not wash	● Is there power failure? ● Is the power plug inserted tightly? ● Is the water level reached preset position?
	Not spin	● Is the power plug inserted tightly? ● Is the top lid closed reliably? ● Are the laundries set flat?
There's abnormal sound inside the machine	● Is the machine slanting? ● Are the laundries put slantingly in spinning? ● Are there any foreign materials?	● Adjust the machine to be even ● Reorder the laundries and close the top lid. ● Remove the foreign materials.
The water tap leaks	● Is the screw of the jointer of water inlet hose loose or awry?	● Fasten the screw of the jointer properly.

Common phenomena

Phenomena	Explanation
● The spinning is intermittent when it starts.	● Balance the laundries to avoid slanting.
● The wash procedure is paused.	● The cloth sensor is checking the cloth, it will add water after 48 seconds.
● Push the PROGRAM button to select SPIN, but it doesn't work.	● The program is setting the drain time. Some time is needed before it starts spinning.
● The pulsator pauses during water inlet in wash and rinse.	● It is to avoid splashing during water inlet.
● There may be some water flowing out of the drain hose in the first use of the machine.	● It is the water remained in the factory inspection of performance.

Names of the parts

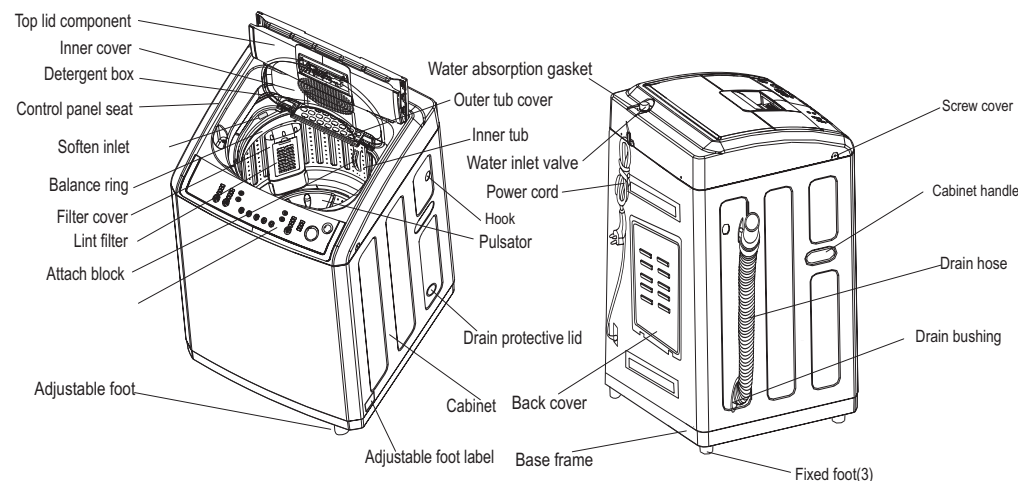

Meaning and description of the symbols

<p>Warning sign</p>	<p>Contents marked with that symbol are related to the safety of the product and the personal safety of the users. Please operate in strict conformity to the contents. otherwise it may cause damage of the machine or injure the personal safety of the user.</p>
<p>Forbidden sign</p>	<p>Contents marked with that symbol are actions forbidden to perform. Performing of those actions may result in damage of the machine or influence the personal safety of the user..</p>

Safety precautions

Please plug the power plug on special receptacle. Be sure to use three-pins power receptacle. Ensure that the earthing prong of the power receptacle is earthed reliably. Use leakage protector if possible.

The washing machine must be positioned so that the plug is accessible. Be sure to pull the plug off and close the water faucet in following cases: power failure, delivering the machine, setting the machine idle or cleaning the machine. Do not plug or pull the power plug with wet hand.

- Do not bend, extend, twist, bind by force. Do not press or nip it with weight.
- Keep the pin of the power plug clean, if the power plug is polluted with dust, please wipe with dry cloth carefully.
- If the power cord or the power plug is bad, to avoid risk it is required to have it replaced by the technicians of our special shop or our customer care agent.

In case the washing machine is installed on ground with carpet, do not block the ventilation hole with carpet.

Do not use water hotter than 50°C.

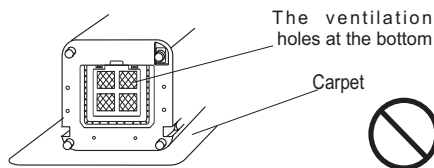

Do not put the machine at damp place like the bathroom. Never wash it with water. Do not put wet laundries on the control panel.

Do not wash water-proof laundries like the raincoat, bike covers etc. to avoid abnormal vibrations in spinning.

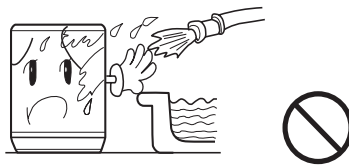

Do not let the machine share one receptacle with other electric appliances. If the plugging into the receptacle is loose, do not use the plug any more.

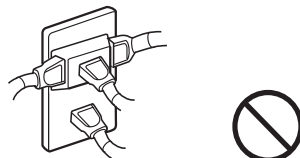

Disposal after washing

- After using, please clean the lint and foreign materials of the lint filter etc. in time. Otherwise it may influence your using the machine.
- Please first pull off the power plug from the receptacle before cleaning.

Clean the detergent box and set it on the control panel seat.

1. The method of dismantle: Push it up aslant and gently.
2. The method of install: install it upwards and aslant and push it in.

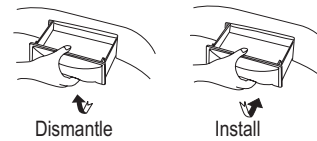

- The lint filter must be used during washing.
- It must be cleaned in time after each using.

Lint filter:

1. Push down the spring piece of the top lint filter to make the claws out of the filter cover, and then pull out the lint filter to get it down. (figure1)
2. Pull the back of the lint filter, and then you can get down it off the front cover of the lint filter. (figure2)
3. Sweep the rubbish in the lint filter.
4. Put the back of the lint filter into the front cover.
5. Put the lint filter into filter cover, and make it tight.
6. Make sure the lint filter well installed, or it can influence your use.

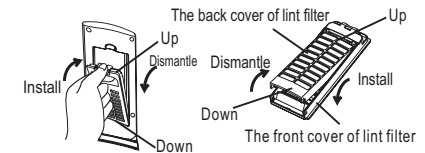

Figure 1

Figure 2

The filter screen of the water inlet valve is likely to be blocked by foreign materials and influence the water inlet. Please clean it with brush every two months.

If the cabinet is dirty, wipe it with wet cloth

- Do not flush it directly with water.
- Wipe it with neutral detergent.
- Do not wipe it with thinner, petrol, alcohol etc.

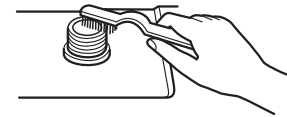

1. After washing, close the water faucet. (If needed, you can dismantle the water inlet hose).
2. Do not store water in the washing machine for a long period. Drain the water completely after each using.
3. Be sure to pull off the power plug before maintenance.
4. Hang up the power cord and drain hose.
5. Wipe off the water drops on the surface of the machine and inside the tub. Open the top lid for some time (about 1 hour), then close the top lid.

- Before washing, please fold up the laundry as needed, then put the laundry into the inner tub, flat and neat.
- These fabrics are not washable:
 1. Fabrics that deform when soaked in water;
 2. Fabrics that shrink, discolor or go through other exterior changes when soaked in water;
 3. Fabrics that lose original texture when soaked in water;
 4. Fabrics that discolor when soaked in water;
 5. Fabrics that have pilling or pressed pile when soaked in water;
 6. Fabrics that is damageable when soaked in water.

- Upon completion of washing, iron the laundry with a steam iron.

Hold the steam iron above the laundry and do not touch the laundry. Reshape the laundry. (As illustrated in Fig 1)



Figure 1

When shrinkage occurs --- Stretch the laundry to its original size and locate it with pins. Use a steam iron to dry the laundry completely. Do not touch the laundry. (As illustrated in Fig 2)



Figure 2

3 Push "SOAK"、"WASH"、"RINSE"、"SPIN" button to select suitable procedure program

- Even there's no water in the tub, a certain period is required before spin starting.
- Separate the laundries that are not colorfast from other laundries in washing.
- The soak procedure can work in cooperation with automatic programs like STANDARD, HEAVY, CHILD, MEMORY GENTLE. There is intermittent pulsator stirring during soak.
- After the machine starts operation, you can only set the program and procedure during washing and soaking. During rinsing, you can only set the spinning time, and can not make setting in other cases.
- During SPEEDY, TUB DRY programs, push the WASH, RINSE, SPIN button the machine has no reaction.

4 Push the "WATER LEVEL" button, select suitable water level

For STANDARD program, the washing machine will execute fuzzy program automatically to detect the cloth. After defection, it can set the water level automatically. To select other water level, first push the "START/PAUSE" button, then push the "WATER LEVEL" button to set the water level.

5 Push the "DELAY" button to select suitable reserve wash program

After switching on the power, the reserve program is set to off mode automatically. If you need to set the washing procedure to be finished at reserved time, please push the DELAY "+ -" button to set the reserve wash program. Refer to reserve button in Page 13 for selection.

- When the DELAY function is activated, the indicator light of the program you have set will be off. The digitron will display remaining delay time(hour).

During reserve procedure, push the "DELAY"+ -" button to display the reserve mode.

- To change the running program or cancel the reserve setting, you need to switch off the power and make new selection.



6 Push the "START/PAUSE" button

Close the top lid

As the top lid opened, the washer will automatically alarm and stop running, exclusively during draining and water filling.

Finish washing

After finishing washing, it'll alarm and switch off power automatically.

Safety precautions

Do not put hand into the rotating tub. It is dangerous even if the rotation speed is slow. Take special care of the children. Keep children away from the washing machine to avoid them climbing on.



Do not decompose, repair or alter the machine by yourself.



Do not put any hot or heavy items (such as the kettle with hot water) on the washing machine.



Do not wash laundries with volatile materials (such as thinner, petrol etc.).



This appliance is not intended for use by persons (including children) with reduced physical, sensory or mental capabilities, or lack of experience and knowledge, unless they have been given supervision or instruction concerning use of the appliance by a person responsible for their safety. Children should be supervised to ensure that they do not play with the appliance.

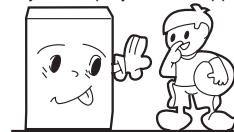

Keep the machine away from direct sunlight and heat source like the heater.



- Please keep the lint filter in good condition, and install it to proper position during washing. If the lint filter is lost or damaged, please contact the customer care agent of our company.



- To protect your laundries and washing machine, please take out all of the coins, buttons, sand, hairpin and other foreign materials before washing.



- Please check if the water faucet is open, and if the connection of the water inlet pipe is proper.
- It is suggested to use foamless washing powder.
- To change the direction of drain pipe, please contact the customer care agent of our company.
- Please don't use the washer in the environment below 0°C; if the washer has been stored below 0°C, please be sure to ensure the washer is placed under the room temperature for 2-4 hours and then use otherwise the washing effects may be lowered or the washer may be damaged.

Installation and adjustment

Please install and adjust the machine according to the requirement of the manual. It is very important to your security and correct operating the machine.

Install the inner cover component

1. Open the top lid of the washing machine.
2. Put the inner cover component on the outer tub cover, aiming the inner cover shaft to the installation hole of the corresponding outer tub cover shaft groove.
3. Firstly insert the inner cover shaft of one side into the corresponding outer tub cover shaft groove, then push the another inner cover shaft into the corresponding outer tub cover shaft groove. Please install to designated position to guarantee there are no dropping or abnormal sound in opening and closing of the inner cover, and the operation shall be smooth. Do not dismount the inner cover component after washing.

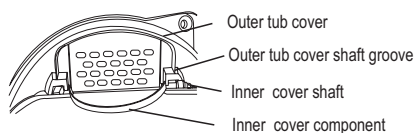

Figure 1

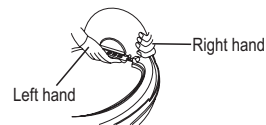
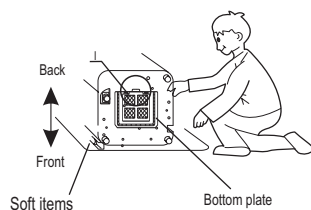

Figure 2

Install the bottom plate

After you open the package, please lean the washing machine gently down on soft items (like the towel cloth, blanket, etc.). Install the bottom plate to the bottom of the machine, then lift the machine up gently. See to the figure:



Two claws at the bottom cover shall be inserted in two bar-shaped holes in the stand. Make sure the claws are firmly in place.

Section I enlarging

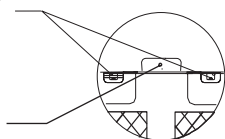

Fasten the bottom plate to base frame with one screw

I DELAY "+ -" button

- Push down the "+ -" to select the reserve time(2h-24h).
- Push the "+ -" button can display the reserve state.

J "SOAK" button



- Press the "SOAK" button to select soak procedure.
- Press the "SOAK" button, the light flashes then press SET "+ -" to select the desired soak time from the STANDARD, HEAVY,CHILD, MEMORY programs(0,10, 20,30,40 minutes).
- For GENTLE program, press "SOAK" button, then press SET "+ -" button can change the process, can not change time.
- The button is unavailable from the SPEEDY, WOOL and TUB DRY programs.

K Reserve, remain time digitron

- It displays "--" during detecting.
- It displays remained reserve time (hour).
- It displays abnormal symbol in abnormal situation.(See to Page16)

L "RESERVE WATER" button



- You can choose "RESERVE WATER" function to keep the after rinsing water.
- Washing machine will keep the after rinsing water once finish rinsing in tub about 4 hours, and buzzer every 15 minutes.(For example, if you choose "SECOND RINSE", the machine only keep the after second rinsing water.
- If you choose "FIRST RINSE" and "SECOND RINSE" together, the machine will keep the after first and second rinsing water)
- Press "START/PAUSE" button or open and close the top lid one time to collect the after rinsing water, then the machine will go on for next program.
- If you don't collect the after rinsing water within 4 hours, the machine will drain automatically, then go on for next program.

M SET "+ -" button

- Refer to the description of operation button

◆ Steps of using the operation buttons and description of each step

1.Push "POWER" button to switch on the power

It has the special power resume function. In the case of power failure or the power plug is loose during running, the machine can save the running program, and resume the program after the power supply is recovered. You do not need to set the program again.

2.Push "PROGRAM" button to select suitable full-auto program

- After the power is switched on, "STANDARD" is automatically set. To select other full-auto programs, please push the "PROGRAM" button till the corresponding indicator is on. Refer to the "PROGRAM" button on Page 11. E.g. Set to "SPEEDY" program for small quantity of laundries with light soil.
- When a standard cycle is selected, the fuzzy program is run. The water level and the washing time can be selected according to be texture and volume of the laundry. The washing cycle is automatically controlled.

WASH	D "WASH" button
	<ul style="list-style-type: none"> ● Press the "WASH" button to select wash procedure. ● Press the "WASH" button, the light flashes then press SET "+ -" to select the desired wash time from the STANDARD, HEAVY, CHILD, MEMORY programs (0-25mins) . ● Press SET "+ -" button can change the process ,can not change time from the GENTLE and WOOL programs. ● The button is unavailable from the SPEEDY and TUB DRY programs.

SPIN	E "SPIN" button
	<ul style="list-style-type: none"> ● Press the "SPIN" button to select spin procedure. ● Press the "SPIN" button, the light flashes then press SET "+ -" to select the desired spin time from the STANDARD, HEAVY, CHILD, MEMORY programs (0-9mins) . ● The button is unavailable from the SPEEDY and TUB DRY programs. ● Press "SPIN" button ,then press SET "+ -" button can change the process,can not change time from the GENTLE and WOOL programs.

WATER LEVEL	F "WATER LEVEL" button
	<ul style="list-style-type: none"> ● The washing machine can detect the laundries automatically. After detection, it will set the water level to suitable value among 4, 6, 8, 10 and 12 automatically. During the STANDARD program, You can also set water level by yourself. After the machine is started, it will not set water level automatically. You shall push the "START/PAUSE" button to make new setting. ● If there's water inside the tub, the machine cannot detect the laundries and will display water level 6 .If wet laundries are put in, it may display water level 12. You must set suitable water level by yourself. ● During operation of SOAK, WASH and RINSE programs, you can push down the WATER LEVEL button to add water. When you release the button, or it reaches the overflow water level, the machine will stop adding water. ● The water level decided may be different from actual value because of the different moisture level of the laundries. ● If SPEEDY program is selected, it will display water level 3 . It will display water level 4 when it rinses. ● When STANDARD, MEMORY, HEAVY, CHILD and GENTLE programs , the rinse water value will be one level higher than the wash water value. (Except 12 water value and when the rinse water value is selected by yourself). ● Under the wool program, only the 6 to 12 water level can be selected.

AIR DRY	G "AIR DRY" button
	<ul style="list-style-type: none"> ● Push the "AIR DRY" button to select air dry procedure. The program is chosen (0.5h, 1.0h, 2.0h). ● It can dry the inner tub and the outer tub when 0.5h, 1.0h are selected , which can avoid growing mildew on the outer tub and the inner tub. ● 2.0h can dry laundries , the max drying capacity of the fibre laundries is 1.5 kg. ● "AIR DRY" program can not be reserved.

RINSE	H "RINSE" button
	<ul style="list-style-type: none"> ● Press the "RINSE" button to select rinse procedure. ● Press the "RINSE" button, the light flashes then press SET "+ -" to select the desired rinse times from the STANDARD, HEAVY, CHILD, MEMORY programs (0.1, 2.3). ● For GENTLE, WOOL programs, press "RINSE" button , then press SET "+ -" button can change the process ,can not change time. ● The button is unavailable from the SPEEDY and TUB DRY programs.

Adjust the Installation position

The largest allowable slope of the shank base of the machine is 2°. The slanting or rough ground will result in unstable running or stoppage of the machine. Please adjust it with following methods:

- Confirm it's horizontal:
Hang the lead line to check if it is horizontal.

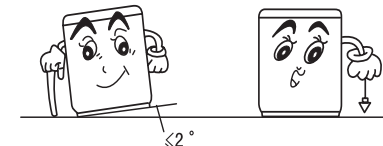

- Adjust the adjustable foot:
1. To twist the adjustable leg, please first lift up the side of the foot slightly, loosen the adjustable nut, and twist the foot.
2. After adjustment, fasten the nut.

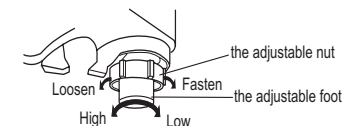

Usage of the drain hose

The drainage shall be smooth with the drain hose.

1. The height of the drain hose shall be less than 10cm, or the drainage will not be smooth, and cost such long time that the machine may stop at mid way.
2. Do not step on or press the drain hose.

4. If extra drain hose is needed, please make separate purchase. The inner diameter of the extra hose shall not less than 30mm, and the length shall not exceed 1.5m.



3. If the drain hose is too long, cut it at mid point. To make smooth drainage, cut the front end of the hose slantingly.

5. If the extra hose is too long, cut it either at A or at B.



How to change the direction of the drain hose

1. Dismantle the rear cover of the washing machine.
2. Put down the drain hose. Take off the drain hose frame as indicated in Figure 1. Take the drain hose into the cabinet, then nip the drain fixing clamp to make it deviated from the clip, the other hand is used to put down the drain bushing, as indicated in Figure 2,3.
3. Dismantle the drain outlet protecting cover at the other side, (the way is the same as the drain bushing), then install the drain bushing, as indicated in Figure 4.
4. Extend the drain hose from the other side. Fix the drain hose with drain hose frame onto the cabinet, as indicated in Figure 5.
5. Install the drain outlet protecting cover to the other side, as indicated in Figure 6.

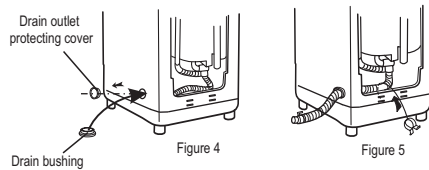
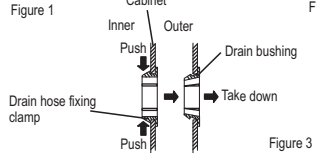
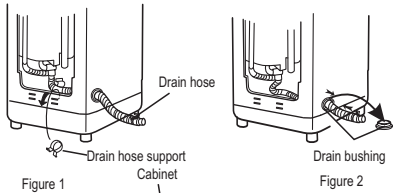

5. Install the drain outlet protecting cover to the other side, as indicated in Figure 6.

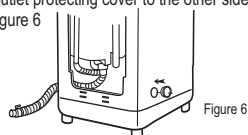

Remarks: In order to make sure of the correct of installation, it is suggested to change the direction of the drain hose with our company serviceman.

Use the operation buttons

◆ Description of operation button

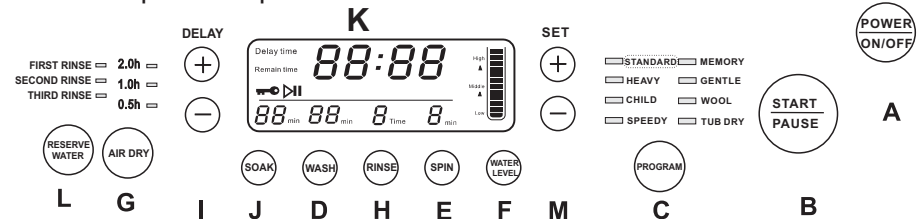

Indicator mode and meaning

- Off
- ⏸ : Flashing, indicating the running program
- On, indicating the program about to run or the selection mode

Child lock function

- The function is intended for children safety and preventing the washing program from accidental changes by children.
- Push and hold the WATER LEVEL button and SPIN button, then push down the POWER ON/ OFF button. The digitron displays "🔒". You can continue setting desired washing procedures. After setting, push down the START/PAUSE button. The child lock function is activated, all of the buttons are locked and cannot make selection.
- Release the child lock function :push down WATER LEVEL button and SPIN button at the same time for more 2 seconds. After a beep sound, the child lock function is released.

A "POWER" button

- Push the "POWER" button to switch on the power.
- Under power-on mode, push it to switch off the power.
- Push the "POWER" button to switch on the power. If the "START/PAUSE" button is not pushed, the machine will switch off the power automatically after 5 minutes.

B "START/PAUSE" button

- After the power is switched on, press it to start the machine.
- During working, push it to pause.
- During pause, push this button to restart and go on working.

C "PROGRAM" button

Program	Application	Program	Application
STANDARD	Standard saving washing for normal laundries	MEMORY	The common wash, the washing machine will set to MEMORY program including "wash ,rinse ,spin , water level "automatically last time
HEAVY	Washing the relatively big and thick laundries	GENTLE	Washing the cotton textiles
CHILD	Washing the children' clothes ,the default program contains soak function	WOOL	Washing for the woollen laundries, under 2.5kg
SPEEDY	Quick washing for normal laundries, under 1.5kg	TUB DRY	Avoid growing mildew on the outer tub and the inner tub

Put in the laundries



- The capacity of washing of the machine refer to the largest weight of the standard laundries under dry condition that can be washed in one time. Laundries quantity in one washing cycle shall be lower than the standard capacity.
- The thickness ,size , type of the cloth will influence the actual washing capacity. It is suitable to put in reasonable amount of laundries and the laundries can be turned round in washing for one time washing.
- Do not select " 4" water level for laundries less than 1.0kg ,so as to avoid splashing of water.

Usage of detergent

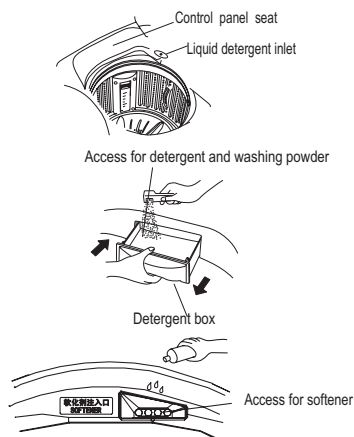

How to use the softner

- The usage and dose of the softener as per the specifications of softener.
 - Before washing put the softener into the hole directly as indicated in the left figure, The softener will put into the washer when the last rinsing.
 - Refer to the following list for the usage of the detergent:selection of the water level,water quantity and dosage of detergent
 - After the softener is put in, please don't place for a long time otherwise softener may solidify and cause flowing not smooth.
- Remark: Do not use softener if rinse times is not two.

How to use the washing powder

- It is suggested to add washing powder into the box directly under fuzzy program and reserve program.
- Dissolve directly inside the washing machine: (not applicable for fuzzy and reserve program)
 - 1.Add some water(select " 1 " water level).
 - 2.Add washing powder. Run for about 30s to fully dissolve the power.Then push the"START/PAUSE" button.
 - 3.Put in laundries. Select suitable water level. Push the "START/PAUSE"button again.
- Quick dissolving of washing powder:
 - 1.Prepare warm water of 30°C and container.
 2. Add washing powder while stirring to dissolve it completely.
- Please add suitable washing powder as per the laundries quantity, the set water level and water quantity.
- If you select "Speedy" program, it is suggested to use liquid detergent instead of washing powder to guarantee the washing effect.
- It is not recommended to use rich-foam washing powder.
- Washing powder with poor quality or long-time storage may get caked. Please clean the detergent box duly in usage.

How to use the whitener

- Add water to decided level. Dilute the whitener with container, and then pour it into the liquid whitener inlet slowly.
- Laundries with color or pattern is not colorfast, thus not applicable.
- The whitener shall not touch laundries directly.
- See to the manual of whitener for the usage and dosage.
- For whitener in powder, dissolve it before use.

Install the water inlet hose

Confirm the water faucet

Water faucet,suitable

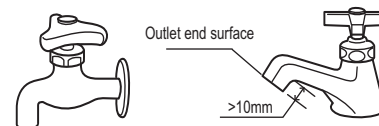

It is required that the front end shall be longer than 10mm.
The exit end face of the faucet shall be flat and smooth. If not please file it to avoid leakage.

Water faucet,not suitable

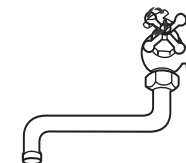

Connection between the water inlet hose jointer and the water faucet

- 1.Press the lower end of the lock lever and push down the slider. Take off the water inlet hose jointer from the water inlet hose component. See to Figure 1.
2. Loosen the screw till the water faucet can be accessed. Put the jointer of the water inlet hose on the faucet. See to Figure 2. (If the faucet is too large and the jointer can not be set on the water faucet, please loosen the four screws and take out the bushing in the jointer. The front end of the faucet must be smooth, otherwise it may leak water. See to Figure 3.)

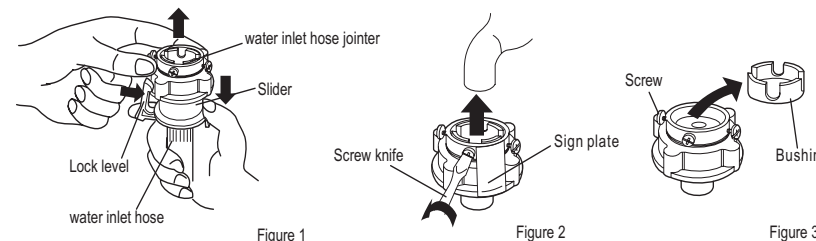

- 3.Fasten the four screws evenly. See to Figure 4.
- 4.Take off the nameplate. Twist the fastening nut as per the indication of the figure to seal up the exit end face of the faucet. See to Figure 5.

Remark: Before installation, the threading is 4mm above the upper surface of the nut.
After installation, the threading is 2mm above the upper surface of the nut. See to figure 6.

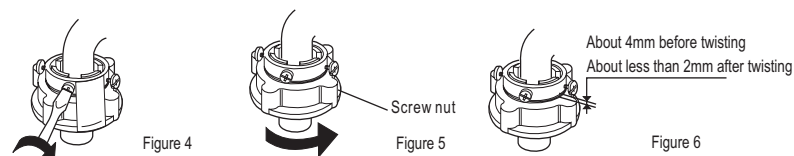

Connection between the water inlet hose and the washer

1. Do not take off the water absorption cushion. Please check if the cushion is dropped or damaged before each usage. If it happens please contact our after-sale department immediately.

2. Put the nut of the water inlet hose on the valve jointer.

3. Fasten the nut. Swing it gently to confirm if it's suitable.

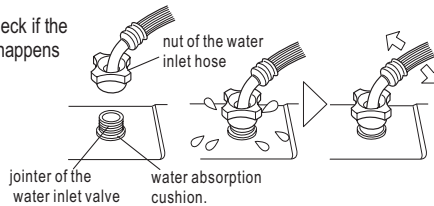

The new hose-sets supplied with the appliance are to be used and that old hose-sets should not be reused.

Connection between the jointer of the water inlet hose and the water inlet hose

1. Push down the slider. Insert the water inlet hose into the jointer.

2. Hang the lock lever to the jointer. Release the slider till a click sound is heard.

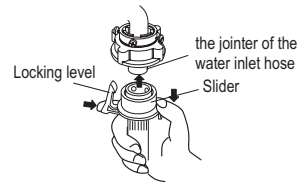

Check the connection between the jointer of the water inlet hose and the water faucet

1. Swing the hose gently to confirm if it is fastened stable.
2. After installation, open the faucet to check if it leaks.
3. Do not bend the hose with overstrain.

4. Before each usage please check if the connection between the jointer of the water inlet hose and the water faucet, and the installation of the water inlet hose are firm, so as to prevent dropping from improper installation position.

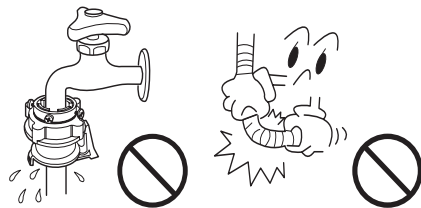

Dismantle the water inlet hose

1. Close the water faucet.

2. Press the locking lever. Push down the slider. Then pull of the water inlet hose.

If the machine is used frequently, the jointer of the water inlet hose can be kept on the faucet to prevent damaging the fixing screw.

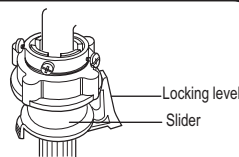

Preparation before washing



Preparation before washing

1. Connect the water inlet hose.
2. Confirm that the washing machine is earthed reliably. Then insert the power plug into the receptacle. Do not connect the earth terminal to the gas pipe and tap water pipe.
3. Put down the drain hose.



4. Slanting or uneven ground may result in unstable working or abnormal noise. Please make the machine stand horizontally.

Pay attention to followings before washing the laundries

Confirm if there's special requirement for the laundries.

Clear the pocket. Take out the coins, sand, hairpins etc.

Fasten the buttons and zippers.

The quantity of the laundries shall not exceed the rated value. The big laundries like the jeans shall be put in loosely.

When the pulsator is running, the buttons of the laundries may cause noise. For the sake of discretion, please put the laundries with buttons into other laundries.



- a. Check if the laundries are applicable for washing with machine.
- b. Divide the laundries with unfast color from other laundries.
- c. Put those laundries difficult to absorb water into water with hand.
- d. For those laundries with heavy soil, please first remove the dirt like mud or dust. For the parts with heavy soil, please apply detergent in advance, which can make it easier to remove the soil.
- e. For those laundries that may get lint ball and those with long fur, turn it over before putting in.
- f. Do not put those laundries polluted by chemicals directly into the washing machine.
- g. For those small laundries and those may get twisting or worn, and woollen/fur laundries, please put them into mesh bag for washing.

Free Manuals Download Website

<http://myh66.com>

<http://usermanuals.us>

<http://www.somanuals.com>

<http://www.4manuals.cc>

<http://www.manual-lib.com>

<http://www.404manual.com>

<http://www.luxmanual.com>

<http://aubethermostatmanual.com>

Golf course search by state

<http://golfingnear.com>

Email search by domain

<http://emailbydomain.com>

Auto manuals search

<http://auto.somanuals.com>

TV manuals search

<http://tv.somanuals.com>