

Haier

Haier Washing Machine

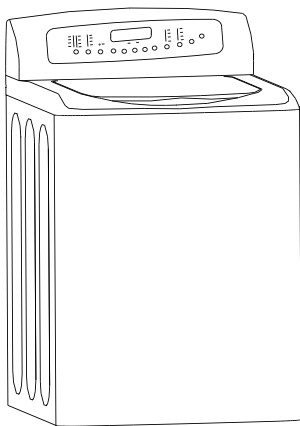

HWM90DD

IMPORTANT SAFETY INSTRUCTIONS

Warning - To reduce the risk of fire, electric shock, or injury when using your appliance, follow basic precautions, including the following:

1. Read all instructions before using the appliance.
2. Use this appliance only for its intended purpose as described in this user and care guide.
3. Use only detergents or softeners recommended for use in this appliance and keep them out of the reach of children.
4. This appliance must be properly installed in accordance with the installation instructions before it is used.
5. Never unplug your appliance by pulling on the power cord. Always grasp the plug firmly and pull straight out from the outlet.
6. Replace worn power cords, loose plugs and power outlets immediately.
7. Unplug your appliance before cleaning or before making any repairs.
8. Do not operate your appliance in the presence of explosive fumes.
9. Do not use hot water that exceeds 60°C in temperature.
10. Do not use this appliance to wash clothes soaked, spotted or washed in gasoline, dry cleaning solvents or any other explosive or flammable substances that could ignite and explode.
11. Clothes or rags used to clean flammable or explosive materials should not be washed in this appliance till all traces of this material has been removed, to avoid an accident.
12. Do not add or mix any flammable or explosive substances to the wash.
13. Do not try to remove clothes while the tub is moving. Let it come to a complete stop.
14. The lid must be closed when bowl is spinning.
15. Do not operate your appliance when parts are missing or broken.

16. Do not use this appliance for commercial clothes washing.
17. Do not operate this appliance unless all enclosure panels are properly in place.
18. Do not tamper with controls.
19. The appliance is not instruct for use of young children of infirm persons without supervision. Young children should be supervised to ensure that they do not play with the appliance.
20. This appliance must be connected to a proper electrical outlet with the correct electrical supply.
21. Do not repair or replace any part of the appliance or attempt any servicing unless specifically recommended in the user-repair instructions. Make sure that you understand and have the skills to carry out.
22. To reduce the risk of electric shock or fire, do not use extension cords or adapters to connect the unit to electrical power source.
23. If the washing machine is connected to a cord extension set or electrical portable outlet device, make sure it is not in a position where it is subject to splashing or ingress of moisture.
24. Ensure carpet does not obstruct the opening in the bases.
25. Use the new hose provided. The old hose should not be reused.

TABLE OF CONTENTS

	PAGE
IMPORTANT SAFETY INSTRUCTIONS	1-2
OPERATING INSTRUCTIONS	4
Parts and Features.....	4
Operations.....	5
Normal Operating Sounds.....	8
Lint Filter	9
Install the linner cover.....	9
CARE AND CLEANING GUIDE	10
Cleaning and Maintenance.....	10
Moving & Vacationing	10
Storage of Your Washer in Cold Environment.....	11
TROUBLE SHOOTING	12
INSTALLATION INSTRUCTIONS	14
Tools and Materials Required.....	14
Unpacking Your Washer.....	15
Leveling Your Washer.....	15
Steps for Installation.....	16
ELECTRICAL REQUIREMENTS	18
Power Interruptions.....	18
SPECIFICATION	Back Cover

OPERATING INSTRUCTIONS

Parts and Features

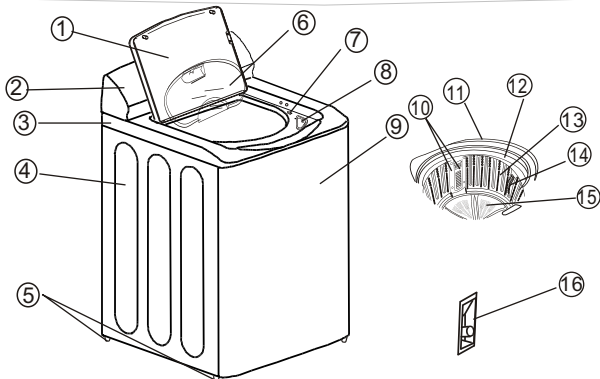
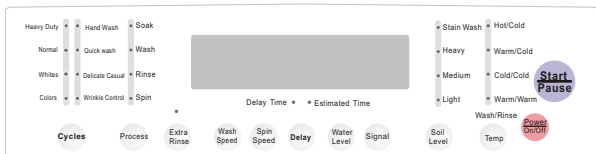

① Top lid

② Control panel

③ Control panel seat

④ Cabinet

⑤ Leveling legs

⑥ Inner cover

⑦ Door switch

⑧ Bleach injection inlet

⑨ Front door

⑩ Filter, Filter Cover

⑪ Outer tub cover

⑫ Balance ring

⑬ Inner tub

⑭ Paddle

⑮ Pulsator

⑯ Drain hose joint

Operations

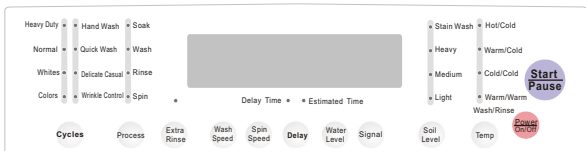

Delay

- When not activated, the display shows cycle remaining time through the wash process.
- When delay is selected the indicator light will display a minimum delay of 2 hours. Push button once for every additional 1 hour delay for up to 24 hours. Number of hours will reduce until program starts.

Cycles

- Heavy Duty-For washing bigger ,thicker and heavier dirty laundries.
- Normal- For washing cottons and linens,Loads that are moderately or heavily soiled.
- Whites-For washing the clothes that is not easy to wash and need good rinse effecton,such as underwear,and children's clothes.
- Colors-For washing color fabrics.
- Hand Wash-To have hand wash effect on clothes.
- Quick Wash-For quick washing of light dirty laundries. It need 24-30 minutes without extra rinse.
- Delicate Casual-For washing of delicate fabrics.
- Wrinkle Control-Helps to reduce wrinkles and easy ironing.

Process

This is to select washing process.

- Soak will not work in the Cycles:Hand Wash,Quick Wash, Delicate Casual and Wrinkle Control.

- Water level indicator will shut off if only Spin is selected.

Extra Rinse

- Once a program is selected, press this button to have an extra rinse. The washer will add an extra rinse.

Wash Speed/Spin Speed

- For selecting the speed of washing or spinning .

Water level

- Water levels may be set at the beginning of the wash or at pause.
- During Soak, Wash or Rinse press this button to manually replenish water. Release to stop. Function automatically is inactive when water reaches the overflow protection level.

Signal

- Signal volume can be adjusted softer, louder or off.

Soil Level

- According to clothes soil level, press this button to change washing time.
- Wash cycle increases 2 minutes for every soil level.

Temp

- To select inlet water temperature for wash and rinse.

Power On/Off

- Push the “Power On/Off” button to switch the machine on or off.

Start/Pause

- Once washer is powered and selections are chosen, push this button once to start washing.
- While unit is working, push this button once to pause it.
- If unit is in Pause mode, push this button once to resume operation.

Delay Start and Estimated Time Indicator

- Indicates remaining minutes when cycle is in progress.

- Indicates remaining hours during delay process.
- Indicates fault codes or conditions that are not normal.

Loading the Washer:

- Load each item loosely.
- Separate the white and colored clothes. Separate heavy clothes from light clothes.
- Carefully check all pockets and cuffs for small items. They can easily slide in to the tub and may damage the tub.
- Pre-treat all stains and heavily soiled areas for best results.
- Do not overload your washer.
- When loading wet items, keep water level high enough so items can float easily in the water.
- Close the door properly after loading the clothes. If you keep the lid up, the washer will not start.

Proper Use of Detergent:

- It is good washing practice to add the detergent to the water before you add the clothes so that the detergent can work effectively on your clothes.

Notes: You can use less or more detergent depending on the size of the load, water type in your living area, whether it is soft or hard and whether the clothes are heavily soiled or lightly soiled.

Bleach Dispenser:

- Bleach dispenser is located on front corner under the loading door.
- Pour in recommended amount of bleach into dispenser during the first wash fill.

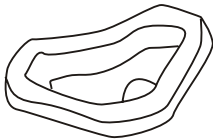

Note: Use only liquid bleach in dispenser.

- Warning:**
- Be careful not to spill undiluted bleach on the washer cabinet or your clothes. As it is a strong chemical, it may damage some of your clothes or the finish of the washer if not properly diluted.
 - Use the manufacturer's chart, on product container for recommended use of liquid or powder bleach.

Softener inlet

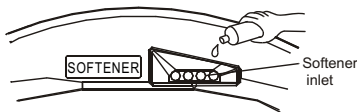

- Please follow softener instructions for dose usage.
- Before washing put the softener into the filling entrance (can be found on the balancing ring by rotating the inner tub, as illustrated in the drawing).
- Try to avoid adding softener in, if you do not intend to wash immediately. The softener may harden and may cause a poor flow.
- Please do not use softener in the following cases: Selected rinsing times more than two; Choosing rinse/spin two-in-one program.

Normal Operating Sounds

The following sounds are normally heard during the operation of the washer:

- **Tumbling sounds:** This is normal as the heavy wet clothes in the washer are continuously being tossed around.
- **Air rushing noise:** This happens when the wash tub spins at very high spinning speed.
- **Wash and Rinse cycles going on and off** will also make clicking sounds.

Lint Filter

- The lint filter must be used during washing.
- It must be cleaned after each wash.

- 1 Take off the lint filter.
- 2 Clean out the lint in the filter.
- 3 Install the lint filter.

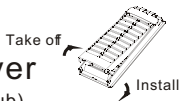
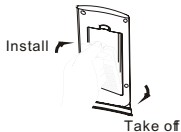

Install the inner cover

(To prevent water spillage from tub)

1. Open the top lid of the washing machine.
2. Put the inner cover component on the outer tub cover, lining up the inner cover shaft to the installation hole of the corresponding outer tub cover shaft groove.
3. Firstly insert the inner cover shaft of one side into the corresponding outer tub cover shaft groove, then push the other inner cover shaft into the corresponding outer tub cover shaft groove. Please install in the designated position to guarantee there is no abnormal sound in opening and closing of the inner cover, and the operation shall be smooth. Do not remove the inner cover component after washing.

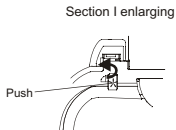
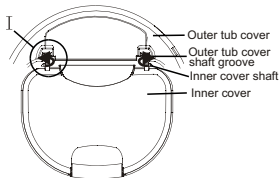

CARE AND CLEANING GUIDE

Warning: Always unplug your washer to avoid electric shock before cleaning. Ignoring this warning may result in injury. Before using cleaning products, always read and follow manufacturer warnings to avoid personal injury or product damage.

Cleaning and Maintenance

- Use only damp or sudsy cloth for cleaning control panel.
- To avoid any kind of damage to cabinet finish, wipe washer cabinet as needed. If you spill liquid/powdered softener bleach or detergent on the cabinet, wipe cabinet immediately because it can damage the finish.
- Do not use any abrasive, harsh chemicals, ammonia, chlorine bleach, concentrated detergent, solvents or metal scouring pads. Some of these chemicals may dissolve, damage and/or discolor your washer.
- Remove pins or other sharp objects from clothes to prevent scratching of interior parts.
- Leave lid open after you are done washing to allow inside of washer to dry and prevent bad odors.

Moving & Vacationing

- Turn off water supply faucet's and disconnect hoses. Drain water from all hoses. This will prevent from damaging due to water leakage if the hoses accidentally get ruptured or they become loose.
- Disconnect electrical plug.
- Dry inner wash tub. If moving washer disconnect drain hose.
- Turn the leveling legs clockwise all the way in.
- Move and store your washer in upright position only
- To prevent mold or mildew, leave lid open so moisture inside machine can evaporate.

Storage of Your Washer

- The washer must be stored at room temperature.
- If you just got delivery of a washer when outside temperature is below freezing, do not operate until washer has warmed to room temperature.
- Do not install or operate your washer where room temperature is below freezing.

TROUBLE SHOOTING

Washer does not operate:

- Check if unit is plugged in. The plug may have come loose.
- Check if the electrical wall receptacle is of proper voltage.
- Check if the circuit breaker needs to be reset or if the fuse need to be replaced.
- Check if the washer is overloaded :load may need to be re-balanced and clothes may need to be redistributed.
- Check if the lid is open. You may have to close the lid properly
- The washer pauses in some cycles. This is normal in delicate or hand-wash cycle which has short period of time. You will not hear washer operation for a short period of time . When the soak time is over, it will start automatically.

Problems with water:

- Not enough water coming out: Water faucet may need to be turned on fully water . Hoses may be tangled or wrinkled up. Straighten out hoses. Check water level selection, it may need to be readjusted.
- Water temperature is incorrect: Check your water heater temperature. Hot water needs to be at a temperature of at least 120 F-140 F(49 C -60° C).Check to make sure the inlet hoses are properly connected. (E.g. Hot to hot & cold to cold)
- Water leaks: This is due to not properly installing drain hose or fill hoses. Your home drain may be clogged . You may need to tighten hoses, check the plumbing or call a plumber.
- Water will not drain: This is due to not installing your drain hose properly. Check the position of the drain hose. In order to drain properly, make sure that top of drain outlet is less than 5 ft. (1.5 m) above the floor.

Washer is making noise:

- Washer may need to be reinstalled. (Check washer installation section)

- Washer load may need to be re-balanced, as the load may be uneven.
- Coins, loose change, buttons or other heavy objects could make noise(read Operating Guide-Normal Operating Sounds).
- Squealing sound: Due to overloaded wash tub.
- Vibration Noise: Due to not leveling washer properly on the floor and uneven distribution of clothes in the tub.

Problems with clothes:

- Clothes are too wrinkled: this is due to improper sorting, overloading and washing in too hot water repeatedly. Avoid overloading and resort your load. Do not mix heavy clothes such as work clothes with light clothes such as blouses, light shirts and delicate items. You may need to wash in warm or cold water
- Have soap residue: detergent may not be dissolving in water. Check water temperature or you need to add detergent as wash tub is being filled with water.
- Spots or stains on your clothes: this is due to incorrect use of fabric softener. You may need to read proper instructions on the container and follow proper directions when using the softener.
- Clothes are grayed or yellowed: this is due to not pouring enough detergent for large loads. You may have to add more detergent to the load.
- Clothes are ripped & have holes/excessive wear & tear: this is due to sharp objects such as pins and belt buckles left in pockets. You will need to remove small loose sharp objects. Fasten belts, zippers, metal snaps etc. Check if you are using undiluted bleach. Never add undiluted bleach to wash.

Note:

Trouble Codes	Reason
E0	Top lid not closed during delay start sequence
E1	Blockage of drain hose
E2	Top lid not closed during wash operation
E4	The water inlet time exceeds the preset time (30minutes)
E7	The communication is bad
F2	The protection of water overflow

INSTALLATION INSTRUCTIONS

Tools and Materials Required

You will need to have following tools to help you with the installation of your washer:

- Pliers
- Wrench
- Tape Measure
- Gloves
- Level

Accessories Supplied	Quantity
1. Hot & Cold inlet hoses	2
2. Drain Hose Hook	1
3. Pipe Hoop	1
4. Inner Tub Cover	1
5. Outer Drain Hose	1

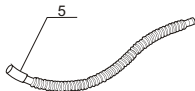
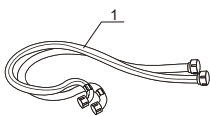

Unpacking Your Washer

- Remove all packing materials. This includes the foam base and all adhesive tape holding the washer accessories inside and outside
- Open the top lid to remove the styrofoam drum brace. Pull to remove.
- Before using this washing machine, please remove this shipping bar by pulling handle and dispose it properly, otherwise the washing machine will be damaged.

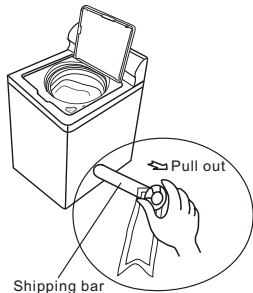

Leveling Your Washer

- Your washer has 4 leveling legs; which are located on the bottom corners. After properly placing your washer in its final position, you can level your washer.
- Leveling legs can be adjusted by turning them counter clockwise to raise your washer or turning them clockwise to lower your washer.

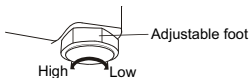

Warning: Leveling of washer is very important to prevent vibration during spin.

Steps for Installation

- Select a away suitable location for the washer on a hard even surface from direct sunlight or heat source e.g. radiators, base board heaters, cooking appliances etc. Any floor unevenness should be corrected with the leveling legs located on the bottom corners of the washer. The washer must be placed at room temperature. You must not place washer where the temperature is at below freezing.

Installing Your Washer:

Read through these instructions carefully before installation.

1. Connect the hot and cold water inlet hoses to the hot and cold water faucet.
2. Connect the other end to the corresponding washer inlet located at the back of machine.

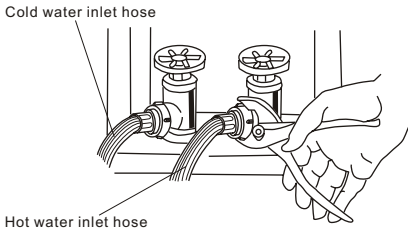

Note: You may have to use pliers to tighten the coupling. Do not over tighten because you may cause damage to the valve.

You should use the new hose-sets supplied with the washer. Old hose-sets should not be reused.

4. Install the drain hose to the side of the washer using the drain hose clamp provided. The drain hose must be placed into a drain pipe or sink at least 1 1/2 inches in diameter. Use the goose neck to the hose in place. To avoid possible water back up, the drain hose must reach a minimum height of 1000mm and a maximum height of 1500mm.

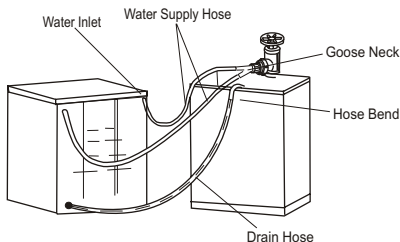

5. Plug the washer into a regular 220-240Volt/50Hz, 10Amps outlet.

Note : Carefully inspect all around the machine and at the back for any leaks, and tighten any loose connections.

Caution: If, after completing these steps, you are unsure that unit is properly installed, contact a qualified installer. To ensure that your washer is properly installed, it is recommended that it be installed by a certified installer.

ELECTRICAL REQUIREMENTS

Grounding Instructions

This appliance must be grounded. In the event of an electrical short circuit, grounding reduces the risk of electric shock by providing an escape wire for the electric current. This appliance is equipped with a cord having a grounding wire with a grounded plug. The plug must be inserted into an outlet that is properly installed and grounded.



Improper use of the plug can result in a risk of electric shock. Consult a qualified electrician or service person if the grounding instructions are not completely understood or if doubt exists as to whether the appliance is properly grounded.

Wiring Requirements:

The washer must be plugged into at least 10AMP 220-240 VOL, T 50 HZ GROUNDED OUTLET.

Note: Where a standard two-prong outlet is encountered, it is the personal responsibility and obligation of the consumer to have it replaced with a properly grounded three-prong outlet.

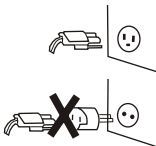

Extension Cords:

We do not recommend that you use an extension cord.

Power Interruptions

Occasionally there may be power interruptions due to thunderstorms or other causes. Remove the power cord from AC outlet when a power outage occurs. When power has been restored re-plug power cord to AC outlet. If outage is for a prolonged period, clean washer before using it again.

SPECIFICATION

Rated voltage • frequency	220-240V~ • 50Hz
Rated washing / spinning capacity	9.0kg
Spin speed max	700rpm
Water level/Water quantity (about L)	1/28 2/36 3/49 4/54 5/61 6/67 7/73 8/79 9/89 10/95
Max water consumption	About 122L(Normal program)
Injection pressure	0.03MPa-1.0MPa
Weight(approx)	79kg

Free Manuals Download Website

<http://myh66.com>

<http://usermanuals.us>

<http://www.somanuals.com>

<http://www.4manuals.cc>

<http://www.manual-lib.com>

<http://www.404manual.com>

<http://www.luxmanual.com>

<http://aubethermostatmanual.com>

Golf course search by state

<http://golfingnear.com>

Email search by domain

<http://emailbydomain.com>

Auto manuals search

<http://auto.somanuals.com>

TV manuals search

<http://tv.somanuals.com>