

**Fuzzy Computerized Automatic
Washing Machine**

User's manual

Haier



This manual is for
XQB55-10H

- Special number:0030506875
- Please read this manual carefully before using.
- Retain it for future reference.

Haier

Downloaded from www.Somanuals.com. All Manuals Search And Download.

Contents

Names of the parts.....	1
Safety precautions	2
Installation and adjustment	4
Preparation before washing	8
Put in the laundries	9
Usage of the detergent	9
Use the operation buttons	10
Close the top lid	14
Finish washing	14
Disposal after washing	15
Trouble shooting • Answer to questions.....	16
Packing list	17

Description of heating function



1. Heating function can be selected for "Normal", "Jeans", "Gentle" and "Quick" programs, but it's unavailable for "Rinse" process.
2. If heating function is selected, for water levels "1" or "2", it begins to heat after water reaches the set level, and begins to wash when the set temperature is reached; for water levels "3"- "6", it begins to heat upon water reaching level "2", it continues water supply and gently agitates while heating to the set temperature, then it begins normal washing; for water levels above "6", the cycle is: after water reaching level "2", it begins to heat, meanwhile water supply continues until level "6", water supply stops and it continues heating to the set temperature, then it begins to wash while water supply is resuming, (the hot water temperature then is good for detergent active enzyme function and for the clothes to be in an optimum detergent concentration with a good washing effect. The subsequent washing while water supply can facilitate dirt flushing and removing), water supply stops when reaching the set level, then it continues to wash normally. (For high water levels, only the water amount below level "6" can be heated to the set temperature, then it washes and supplements water to the set level)
3. This washing machine provides 3 temperature selections of 20°C, 30°C and 40°C, each ranging as follows:
20°C ± 3°C 30°C ± 3°C 40°C ± 3°C

Names of the parts

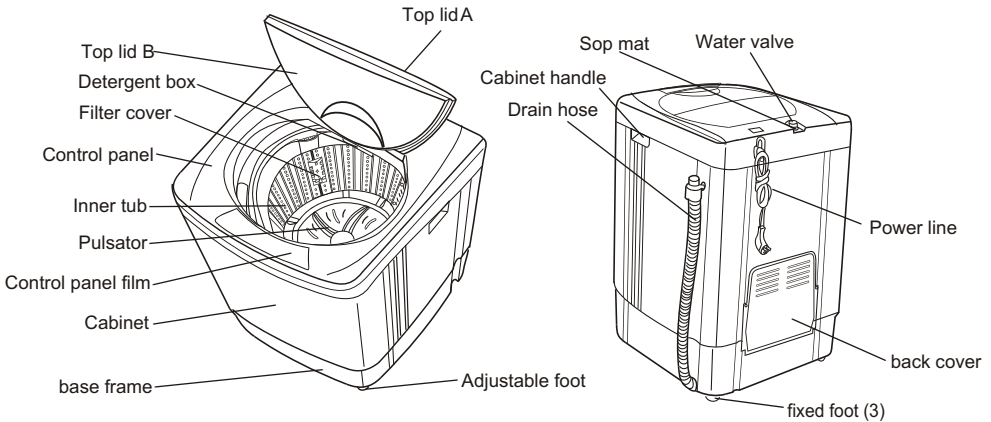
Before Using



Meaning and description of the symbols

<p>Warning sign</p> 	<p>Contents marked with that symbol are related to the safety of the product and the personal safety of the users. Please operate in strict conformity to the contents, otherwise it may cause damage of the machine or injure the personal safety of the user.</p>
<p>Forbidden sign</p> 	<p>Contents marked with that symbol are actions forbidden to perform. Performing of those actions may result in damage of the machine or injure the personal safety of the user.</p>

Safety precautions

Before Using

Please plug the plug on special 220V /10A receptacle. Be sure to use single-phase three pins receptacle. Ensure the earthing prong of the power receptacle is earthed reliably. Use leakage protector if possible.

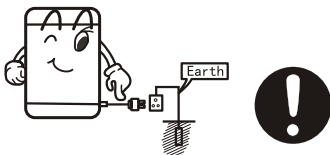

The power cord plug should be convenient to be plugged in or plugged out with hand while the washing machine runs normally. Be sure to pull the plug out and close the water tap when the machine is idle, when moving the machine, or when cleaning the machine. Do not use wet hand to insert or pull out the power plug.



Do not damage the power cord, bend, extend, twist, bind or alter it by force. Do not press or nip it with weight. If the power cord or the power plug is bad, or the power plug becomes flexible, to avoid risk it is required to have it replaced by the technicians of our special shop or the after-sale service department. Keep the pin of the power plug clean, if the power plug is polluted with dust, please wipe with dry cloth carefully.



Do not put the machine at damp place like the bathroom. Never wash it with water. Not put wet laundries on the control panel.

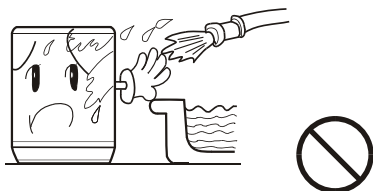

Do not use water hotter above 50°C .



In case the washing machine is installed on ground with carpet, do not block the ventilation hole with carpet.

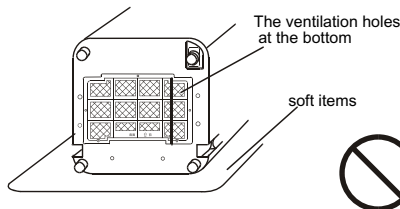

Do not wash water-proof laundries like the raincoat, bike covers etc. to avoid abnormal vibrations in spinning.

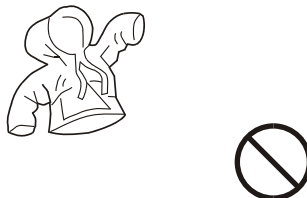

Do not let the machine share one receptacle with other electric appliances. If the power plug is damaged, or the plugging into the receptacle is loose, do not use the plug any more.



Safety precautions

Before Using

Do not stretch hands into the working machine. It is dangerous even if the rotation is slow. Take special care of the children. Do not let the children climb the washing machine.



Do not decompose, repair or alter the machine by yourself.

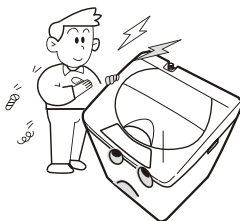

Do not put any hot or heavy items (such as the kettle with hot water) on the washing machine.



Do not wash laundries with volatile materials (such as thinner, petrol etc.)

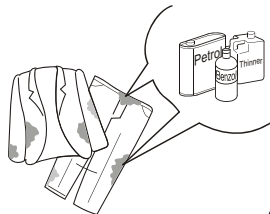

The handicapped or children without care shall not use the machine.

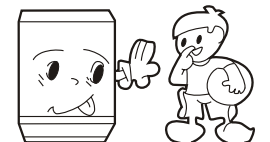

Keep the machine away from direct sunlight and heat source like the heater.

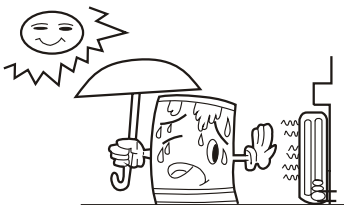

Installation and adjustment

Please install and adjust the machine according to the requirement of the manual. It is very important to your security and correct operating the machine.

Install the lint filter

1. Press downward to assemble.
2. Pull upward to detach.



Install the bottom plate

After you open the package, please lean the washing machine gently down on soft items (like the towel cloth, blanket, etc.). Install the bottom plate to the bottom of the machine with the eight screws by a cross screwdriver, then lift the machine up gently. See to the figure:

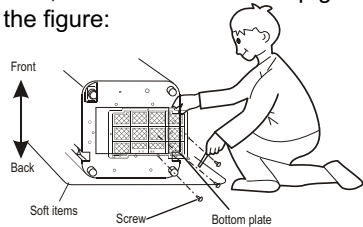

Adjust the installation position

The largest allowed slope of the shank base of the machine is 2° . The slanting or rough ground will result in unstable running or stoppage of the machine. Please adjust it with following methods:

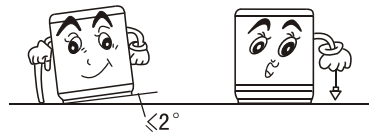

● Adjust the adjustable foot:

1. To twist the adjustable foot, please first lift up the side of the foot slightly, loosen the adjustable nut, and twist the foot.
2. Fasten the nut after adjustment.

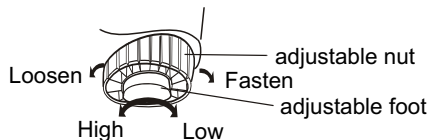

Before Using

How to change the direction of the drain hose

1. Loosen the fastening screw of the back cover to take off the back cover. Be careful not to do it by force to prevent breaking the claw of the back cover. (as indicated in Figure 1)

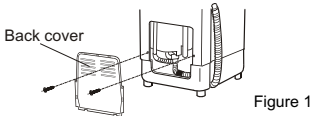

2. Take off the drain hose from the cabinet. Nip the drain hose outlet slightly. Dismantle the drain hose hook. Loosen the fixing screw of the drain hose frame to dismantle the drain hose frame. Pull the drain hose into the cabinet from the left side of the base frame.

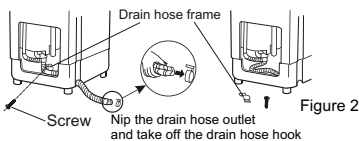

3. Extend the drain hose from the installation hole at the right side of the base frame. Fix the drain hose onto the base frame with the drain hose frame and fasten the screw. Then set the drain hose hook on the drain hose and hang the drain hose on the hanging hole of the cabinet. (As indicated in Figure 3)



4. To install the back cover, first hang the lower beard of the back cover on the cabinet, then push the claws at the two side and the upper end from bottom to top to resume the original setting. Be careful not to do it by force. Then fasten the screw (two points) (as indicated in Figure 4).

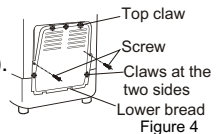

Usage of the drain hose

The drain hose shall drain smoothly

1. The height of the drain hose shall be less than 10cm, or the drainage will not be smooth, and cost such long time that the machine may stop at mid way.
2. Do not trample or press the drain hose.

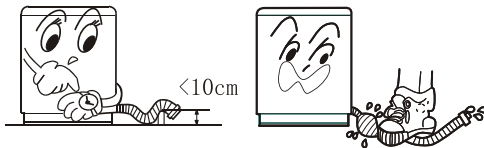

4. If extra drain hose is needed, please make separate purchase. The inner diameter of the extra hose shall not less than 30mm, and the length shall not exceed 1.5m.

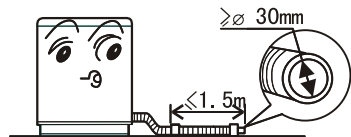

3. If the drain hose is too long, cut it at mid point. To make smooth drainage, cut the front end of the hose slantingly. If the extra hose is too long, cut it either at A or at B point.

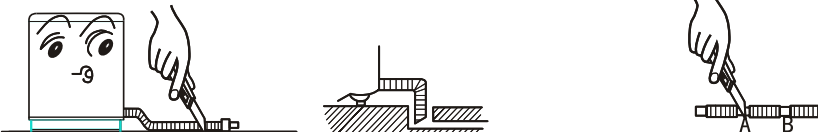

Install the water inlet hose

Confirm the water tap

Water tap, suitable



Outlet end surface

>10mm



Water tap, not suitable

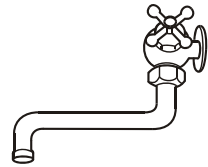

It is required that the front end shall be longer than 10mm.

The outlet end surface of the tap shall be flat and smooth. If not please file it to avoid leakage.

Connection between the water inlet hose jointer and the water tap

1. Use the new water inlet hose provided with the machine to connect to the water faucet. Old hose sets should not be reused.
2. Press the lower end of the lock lever and push down the slider. Take off the water inlet hose jointer from the water inlet hose component. See to Figure 1.
3. Loosen the screw till the water tap can be accessed. Put the jointer of the water inlet hose on the tap. See to Figure 2. (If the tap diameter is too large and the jointer can not be set on the water tap, please loosen the four screws and take out the bushing in the jointer. See to the figure3.)

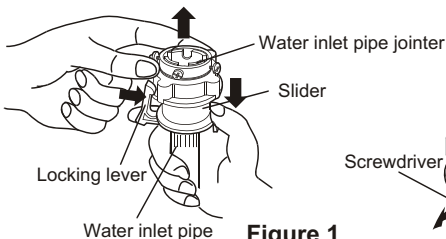

Figure 1

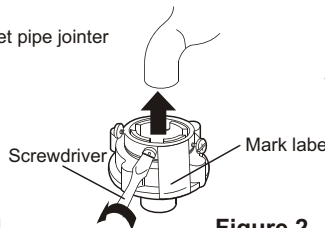

Figure 2

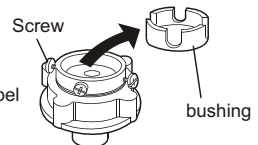

Figure 3

4. Fasten the four screws evenly. See to Figure 4.
5. Take off the nameplate. Twist the fastening nut as per the indication of the figure. See to Figure 5.

Remarks: Before twisting the fastening nut, the thread is 4mm above the upper surface of the nut. After twisting the fastening nut, the thread is 2mm above the upper surface of the nut. See to Figure 6.

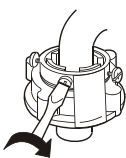

Figure 4

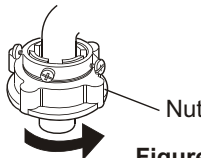
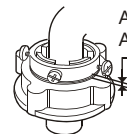

Figure 5



About 4mm before twisting
About below 2mm after twisting

Figure 6

Before Using

Connection between the water inlet hose and the washing machine

1. Do not take off the water absorption cushion. Please check if the cushion is dropped or damaged before each usage. If it happens please contact our after-sale department immediately.
2. Put the nut of the water inlet hose on the valve jointer.
3. Fasten the nut. Swaying it gently to confirm if it's suitable.

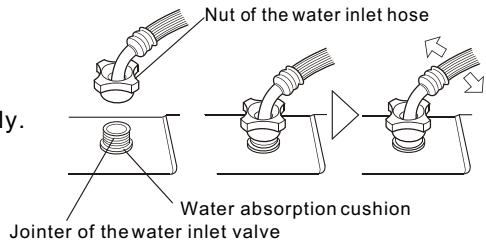

Connection between the jointer of the water inlet hose and the water inlet hose

1. Push down the slider. Insert the water inlet hose into the jointer.
2. Hang the lock lever to the jointer. Release the slider till a click sound is heard.

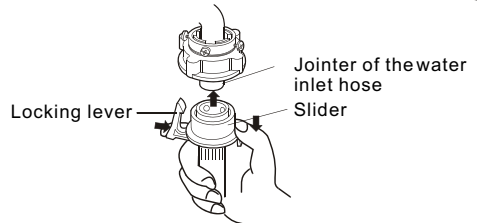

Check the connection between the jointer of the water inlet hose and the water tap

1. Swaying the hose gently to confirm if it is fastened stable.
2. After installation, open the tap to check if it leaks.
3. Do not bend the hose with overstrain.
4. Before each usage please check if the connection between the jointer of the water inlet hose and the water tap, and the installation of the water inlet hose are firm, so as to prevent dropping from improper

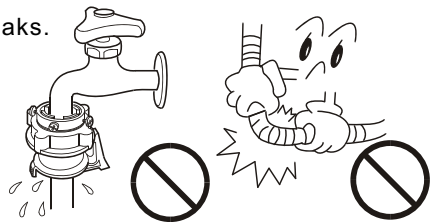

Take down the water inlet hose

1. Close the water tap.
2. Press the locking lever. Push down the slider. Then pull off the water inlet hose. If the machine is used more than once every week, the jointer of the water inlet hose can be kept on the tap to prevent damaging the fixing screw.

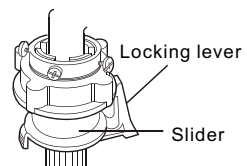

Preparation before washing

Using process





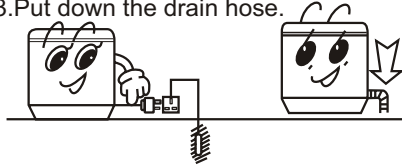

Preparation before washing

1. Connect the water inlet hose and open the water tap .
2. Confirm that the washing machine is earthed reliably . Then insert the power plug into the receptacle. Do not connect the earth terminal to the gas pipe and tap water pipe.
3. Put down the drain hose.



Pay attention to followings before washing the laundries

<p>Confirm if there's special requirement for the laundries.</p>	<p>Clear the pocket. Take out the coins , sand, hairpins etc.</p> 	<p>Fasten the buttons and zippers.</p> 	<p>The quantity of the laundries shall not exceed the rated value. The big laundries like the jeans shall be put in loosely.</p> 	<p>When the pulsator is running , the buttons of the laundries may cause noise. For the sake of discretion, please put the laundries with buttons into other laundries.</p> 
--	---	---	--	--

- a. Please check if the laundries are applicable for washing.
- b. Separate those not colorfast from other laundries.
- c. For laundries not waterabsorbing, please put them into water with hands.
- d. For laundries with much soil, please remove the soil first. You can add detergent on the part with serious soil directly. It is much easier to remove the soil by that mean.
- e. For laundries likely to get lint ball or with long fiber, please first turn the inside out before putting them into the water.
- f. Do not put the laundries polluted with chemicals directly into the washing machine.
- g. For those small laundries ,laundries likely to be twisted or worn, and woolen laundries, please put them into mesh bag before wasing.
- h. Do not select heating function for clothes that should avoid hot water or wear.
- i. In order to prevent the heating band from being entangled, washing of seriously worn or linty clothes should be prohibited.

Put in the laundries

Using process



- The capacity of washing and spinning of the machine refer to the largest weight of the standard laundries under dry condition that can be washed or spinned in one time. One time washing quantity shall be lower than the rated capacity. The largest capacity of this machine is 5.5kg.
- The thickness, size, type of the cloth will influence the actual washing capacity. It is suitable for one time washing to put in reasonable amount of laundries and the laundries can be turned round in washing.
- Do not select "High" water level for laundries less than 1.0kg, so as to avoid splashing of water.
- To wash thin laundries like the stocking, silk etc., please first put them into washing mesh bag (which can be purchased separately) before wash.

Usage of the detergent

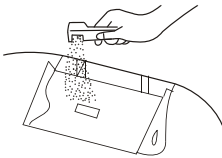

Inlet box of the detergent

How to use the whitener

- Fill water to decided level. Dilute the whitener with container. Pour it slowly into the washing tub.
- Avoid using whitener on laundries with color or pattern as they are prone to lose color.
- The whitener shall not touch the laundries directly.
- Refer to the user's manual for the usage and quantity of the whitener.
- For powder whitener, please dissolve it before use.

How to use the washing powder

- Direct dissolved in the machine
 1. Fill water to "Low" water level.
 2. Add the power. Run for 30 seconds to dissolve it completely.
 3. Put in the laundries. Select suitable water level.
- The instant dissolving of the washing powder:
 1. Prepare warm water of 30°C and a container.
 2. Add the powder while stirring to fully dissolve it.
- Put in the proper quantities detergent according to the water level and the laundries quantities.
- It is suggested not to use high sudsing detergent.
- Washing powder with poor quality or long time storage maybe caked. Please pay attention to cleaning the detergent box in time

Use the operation buttons

Using process

a. Description of the function of the buttons

"PROCEDURE"button

- With it you can select one or several processes of soak, wash, rinse and spin.

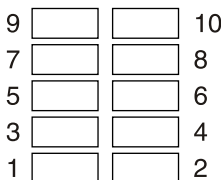

WATER LEVEL SELECTION

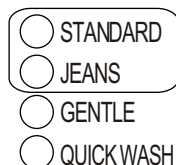

PROGRAM SELECTION



PROCEDURE SELECTION

" WATER LEVEL"button

- The user selects a suitable water level depending on the load.
- If "Quick" wash is selected, water level will indicate "2". After water level reaches "2", it will wash while water filling, and wash normally upon the water level reaching "4".
- After washing for 1 min, pressing "Water level" button will enable supplemental water filling, which will stop automatically upon the water reaching overflow level.

"PROGRAM " button

- You can select from the following four programs.

Program	Standard	Normal wash
	Jeans	Large, thick or heavily soiled laundry
	Gentle	Woolen textiles or underwear
	Quick	10 min quick wash for load below 1 kg

Remarks: After pressing "POWER ON/OFF" to connect power supply, if the washing machine lasts idle more than 10 min, it would automatically shut off the supply.

SURPLUS(MIN)

- To indicate “-” during sensing.
 - To indicate remaining min. During program running.
 - To indicate remaining reserved time (hrs) during reservation period.
- To indicate fault symbols for abnormal conditions (see page 16)

Page 16 

SURPLUS (MIN)

RESERVE (HOURS LATER)

○ 40°C

○ 30°C

○ 20°C

START
PAUSE

"START/PAUSE"button

After the power is switched on, press it to start the machine

- During working, push it to pause working.
- During pause, push this button to restart and continue operation.

"POWER ON/OFF"button

- Press "Power On/Off" button to connect power supply.
- After power is connected, pressing this button will cut off the supply.

POWER
ON/OFF

"RESERVATION/CALEFACTION" button

- Press "RESERVATION/CALEFACTION"button to set scheduling or heating Function.If heating function is selected, the scheduling function is unavailable.
- During machine running, the display indicates the cycle remaining time (in minutes). Press "RESERVATION/CALEFACTION"button, the display will indicate the remaining scheduled time to cycle end (in hours), the decimal point flashes to indicate the scheduled progress.
- Heating function can be selected if keep pressing "RESERVATION/CALEFACTION"Button for more than 2 s. If the temperature indicator is lighted, it means heatingfunction is selected. If keep pressing The"RESERVATION/CALEFACTION"button for more than 2 s, the temperature indicator turns off, and the heating function is cancelled. The initial temperature is about 30°C, and you can select your desired value in 3 s in a switching sequence 30°C →40°C →20°C.
- After the machine starts running, if selection or cancellation of heating function is desired, you should switch off the power and reselect.

RESERVATION
CALEFACTION

b. Operating procedure and explanations for the buttons

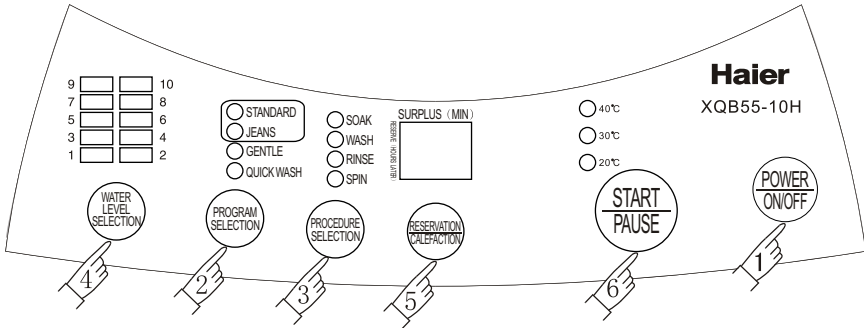

1 Press the "POWER ON/OFF" button to switch on the power supply

- After switching on, the washing machine heating function will be automatically set inactive.
- In order to select heating function, the "RESERVATION/CALEFACTION" button should be pressed for more than 2 s until the heating indicator is lighted, which means the heating function is selected. The initial status is 30°C, and 40°C or 20°C can be selected if you press "RESERVATION/CALEFACTION" button again in 3s.



2 Press the button of "PROGRAM" to select a suitable full-automatic program



After switching on, the "Standard" program will be the default. If other full-automatic program is desired, you can press the button "PROGRAM/RESERVATION" to get the corresponding indicator on. Refer to the "Button of 'PROGRAM/RESERVATION'" paragraph on page 10.

Example: Use the "Quick" program for slightly soiled articles.

Page 10



- When "standard" program is selected, the washing machine will perform full-automatically controlled fuzzy program to set water level, water flow and wash duration according to the cloth nature and weight

3 Press the button of "PROCEDURE SELECTION" to select suitable processes.



After the power is switched on, the washing machine will automatically set a normal program comprising of processes of "Wash, Rinse and Spin". If other program is desired, press the button of "Process" to select one or several process of soak, wash, rinse and spin. Refer to the paragraph "Processes selecting".

Page 10



Attention

- Even there's no water in the tub, the spinning will start after a certain period.
- Do not use soak process for woolen laundries.
- Wash the laundries that are prone to lose colors separately from other laundries. The pulsator will not rotate unless the
- water is filled to selected water level.

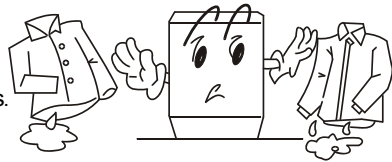

Selection method of the procedure programs

Times of pushing the "select" button	Selected procedure program	Applicable procedure	Contents (the lighted indicators indicate the programs about to run)
0	Wash,rinse,spin	When the common laundries need washing, rinsing and spinning.	Soak ● Wash ○ Rinse ○ Spin ○
1	Wash (the washing liquid remains in the tub)	Repeat using the washing liquid	Soak ● Wash ○ Rinse ● Spin ●
2	Wash,rinse (the rinsing liquid remains in the tub)	The laundry needn't spin to avoid wrinkles	Soak ● Wash ○ Rinse ○ Spin ●
3	Rinse,spin	When the laundries need rinsing and spinning after manual washing	Soak ● Wash ● Rinse ○ Spin ○
4	Spin (spin after drain)	When the laundries need only spinning after manual washing (first drain then spin)	Soak ● Wash ● Rinse ● Spin ○
5	Soak,wash,rinse,spin	If the laundries are very dirty, or the sleeve and collar are dirty, first soak then wash	Soak ○ Wash ○ Rinse ○ Spin ○

- If you push the "PROCEDURE SELECTION" button for 6 times, it will resume the original mode, and it will circulate like that.
- If you select the "QUICK WASH" program, you have to set the full procedure of wash, rinse and spin. The procedure can not be selected.
- If you push the "PROCEDURE SELECTION" button for 6 times, it will resume the original mode, and it will circulate like that.
- If you select the "QUICK WASH" program, you have to set the full procedure of wash, rinse and spin. The procedure can not be selected.

Using process

4 Press the "WATER LEVEL" button to select suitable water level



After switching on the power, press the button "WATER LEVEL" to select a water level according to the load. Please refer to the button "Water level" on page 10.

Page 10



5 Push the "RESERVATION/CALEFACTION" button to select suitable reserve program



After switching on, the washing machine reserved wash program will be automatically set inactive. If you desire a wash cycle to end at a reserved time, you can press the "RESERVATION/CALEFACTION" button to set a reserved wash program. Refer to The button of "RESERVATION/CALEFACTION" on page 11.

• Confirm the reserve program

Page 11



- When "Reservation" becomes active, the nixietube displays the time to the end of the reserved wash cycle, and the indicator turns on.
- To change the running program or cancel the reservation, you should cut off the supply and reselect.



the washing will finish about 18 hours later

• Confirm the heating function

- Keep pressing the "RESERVATION/CALEFACTION" button for more than 2 s, the heating indicator turns on (red).
- Keep pressing the "RESERVATION/CALEFACTION" button for more than 2 s again, the heating indicator turns off and heating function is cancelled.
- After the machine starts running, if selection or cancellation of heating function is desired, you should switch off the power and reselect.

6 Press the "start/pause" button



Close the top lid

Except water filling (excluding heating function) and draining process, if the top lid is opened, the machine will stop running and alarm.

Finish washing

The washing machine cuts off the power supply automatically when wash cycle ends.

Disposal after washing

Using process

- After using, please clean the lint and foreign materials of the lint filter etc. in time. Otherwise it may influence your using the machine.
- Please first pull off the power plug from the receptacle before cleaning.

- The lint filter must be used during washing.
- It must be cleaned in time after each using.

1. Take off the lint filter
Put hand at the indicated position.
Push down to take it off. (See to Figure 1)



Figure 1

2. Clean the lint
Put it in water and clean while it is still wet.(See to Figure 2)

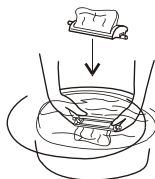

Figure 2

3. Install the lint filter
After cleaning, insert the bottom of the lint filter (marked with "down side") into the filter frame , then push the upper part of the filter in (marked with " up side ").
(See to Figure 3)



Figure 3

The filter screen of the water inlet valve is likely to be blocked by foreign materials and influence the water inlet. Please clean it

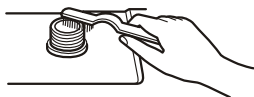

If the cabinet is dirty, wipe it with wet cloth

- Do not flush it directly with water.
- Wipe it with neutral detergent.
- Do not wipe it with thinner, petrol, alcohol etc.

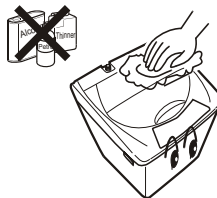



- 1.After washing, close the water faucet. (If needed, you can dismantle the water inlet hose).
- 2.Do not store water in the washing machine for a long period. Drain the water completely after each using.
- 3.Be sure to pull off the power plug before maintenance.
- 4.Hang up the power cord and drain hose.
- 5.Wipe off the water drops on the surface of the machine and inside the tub. Open the top lid for some time (about 1 hour), then close the top lid.

Trouble shooting • Answer to question

(If there's breakdown, please pull off the power plug before checking) The following phenomena are not breakdowns sometimes. Please confirm again before sending it to repair. If there are real breakdowns, please come to the special maintenance department or after-sale service department of our company. Do not repair it by yourself.

Phenomena		The reason	How to settle
Buzzing upon reservation starts, Nixie tube indicates "E0"		<ul style="list-style-type: none"> ● The top lid is not closed 	<ul style="list-style-type: none"> ● Close the top lid
No or slow drain, nixie tube indicates "E1", buzzing.		<ul style="list-style-type: none"> ● Is the drain hose put down? ● Is the drain hose blocked by foreign material? 	<ul style="list-style-type: none"> ● Put down the drain hose. Open and close the top lid once. ● Clean the foreign material. Open and close the top lid once.
Running pauses during spin, nixie tube indicates "E2", buzzing		<ul style="list-style-type: none"> ● The top cover leaves open 	<ul style="list-style-type: none"> ● Close the top lid
Safety switch actuates, not spin, (after self-correction twice), nixie tube displays "E3", buzzing		<ul style="list-style-type: none"> ● Are the laundries put slantingly? ● Is the machine slanting? 	<ul style="list-style-type: none"> ● Re-order the laundries. Close the top lid. Level the machine in right position. ● Open and close the top lid once.
No or slow water filling (not reaching the level in 15 min), nixie tube indicates "E4", buzzing		<ul style="list-style-type: none"> ● The water tap is not open ● The water inlet valve is blocked ● The water pressure is too low and the current is too small 	<ul style="list-style-type: none"> ● Open the water tap. Push the "Start/Pause" button. ● Clean the water inlet valve. Push the "Start/Pause" button. ● Wait for the normal water pressure Before use.
Poor or no waterfall flow		<ul style="list-style-type: none"> ● If the nozzle is choked with foreign bodies 	<ul style="list-style-type: none"> ● Remove the foreign bodies
The machine does not act	Not wash	<ul style="list-style-type: none"> ● Is there power failure? ● Is the power plug loose? ● Does the water level arrive at the set water level? 	<ul style="list-style-type: none"> ● Use it when the power is on. ● Insert the power plug tightly. ● Affusion to the set water level.
	Not spin	<ul style="list-style-type: none"> ● Is the power plug loose? ● Is the top lid closed? ● Are the laundries put orderly? 	<ul style="list-style-type: none"> ● Insert the power plug tightly. ● Close the top lid ● Put the laundries orderly.
There's abnormal sound inside the machine		<ul style="list-style-type: none"> ● Is the machine slanting? ● Are the laundries slanting in spinning? 	<ul style="list-style-type: none"> ● Level the machine properly. ● Re-order the laundries.
The water faucet leaks		<ul style="list-style-type: none"> ● Is the jointer screw of the water inlet hose is loose or twisted awry? 	<ul style="list-style-type: none"> ● Fasten the jointer screw properly.

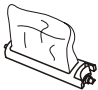
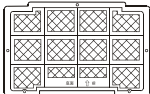
Packing list

Name	Quantity	Storage position
<ul style="list-style-type: none"> ● User's manual 	<ul style="list-style-type: none"> ● One 	<ul style="list-style-type: none"> ● Inside the document bag
<ul style="list-style-type: none"> ● Components of the water inlet hose 	<ul style="list-style-type: none"> ● One 	<ul style="list-style-type: none"> ● Inside the accessory bag
<ul style="list-style-type: none"> ● Lint filter 	<ul style="list-style-type: none"> ● One 	<ul style="list-style-type: none"> ● Inside the document bag
<ul style="list-style-type: none"> ● Bottom plate 	<ul style="list-style-type: none"> ● One 	<ul style="list-style-type: none"> ● Between the upper cushion of the washing machine package and the upper seal of the package carton
<ul style="list-style-type: none"> ● Tapping screws 	<ul style="list-style-type: none"> ● Five 	<ul style="list-style-type: none"> ● Inside the document bag
<ul style="list-style-type: none"> ● Automatic washing machine 	<ul style="list-style-type: none"> ● One 	

Specification

Water level/Water quantity (about)	1/13L、2/16L、3/22L、4/27L、5/30L、6/33L、7/36L、8/39L、9/42L、10/46L
Water inlet pressure	0.03MPa-0.78MPa
Rated washing / spinning capacity(kg)	5.5 (weight of standard dry cloth)

Free Manuals Download Website

<http://myh66.com>

<http://usermanuals.us>

<http://www.somanuals.com>

<http://www.4manuals.cc>

<http://www.manual-lib.com>

<http://www.404manual.com>

<http://www.luxmanual.com>

<http://aubethermostatmanual.com>

Golf course search by state

<http://golfingnear.com>

Email search by domain

<http://emailbydomain.com>

Auto manuals search

<http://auto.somanuals.com>

TV manuals search

<http://tv.somanuals.com>