

Haier

Automatic Drum Washing Machine

MODEL XQG60-QFQ1000

Operating Instructions

Contents

Names of washing machine parts.....	1
Reading before using.....	2-4
Unpacking levelling and positioning.....	5-7
Close up look.....	8-9
Preparation.....	10
Washing method.....	11
Practical know-how.....	12-13
Flushing and maintenance.....	14-15
Common queries.....	16

Names of the Parts

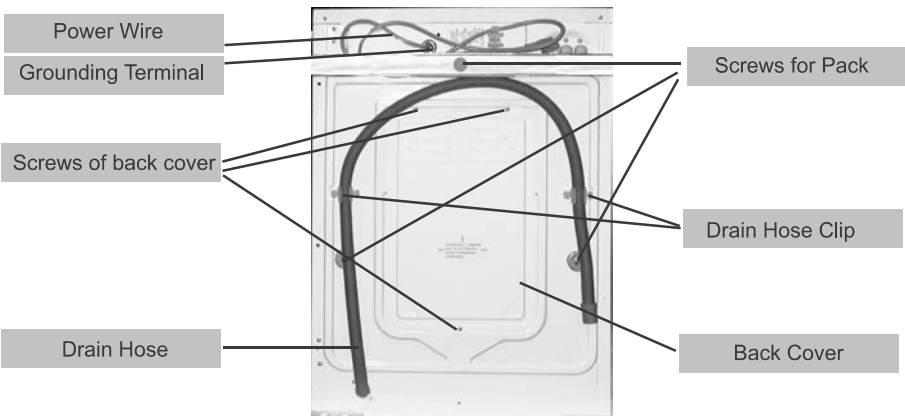
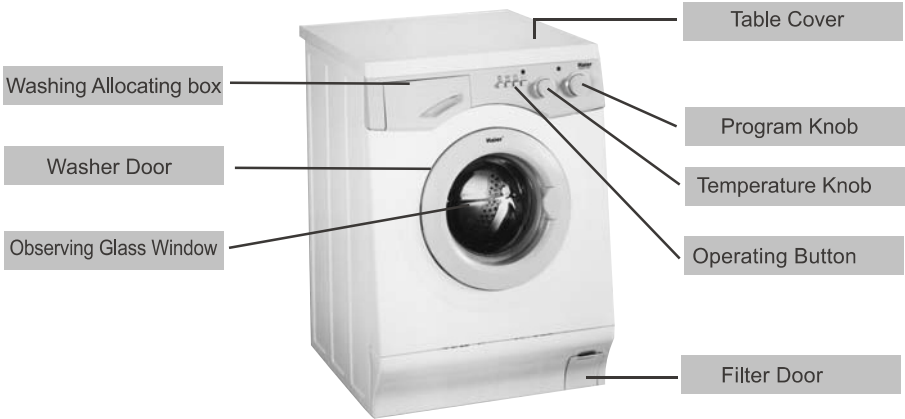

Dear Users:

Thank you for choosing a Haier product. Please read the manual and carefully operate according to the procedures described.

Please read before using

Please read the documents enclosed carefully before you install and operate. The advice mentioned is for your safety.

Safety:

- 1.The grounding terminal of the outlet should be firmly grounded.
- 2.Don't pull the plug out by the power cord, be sure to pull plug out by the socket.
- 3.Avoid using a point let. If the supply cord is damaged, it must be replaced by the manufacturer or its service agent or a similarly qualified person in order to avoid a hazard.
- 4.Please do not touch the washing machine if there is water on your hands or your feet.
- 5.Do not wash articles that have been previously cleaned in, washed in, soaked in, or spotted with gasoline, dry-cleaning solvents, other flammable, or explosive substances as they give off vapors that could ignite or explode.
- 6.Under certain conditions, hydrogen gas may be produced in a hot water system that has not been used for 2 weeks or more. **HYDROGEN GAS IS EXPLOSIVE.** If the hot water system has not been used for such a period, before using a washing machine, turn on all hot water faucets and let the water flow from each for several minutes. This will release any accumulated hydrogen gas. As the gas is flammable do not smoke or use an open flame during this time.
- 7.Don't let kids approach the running washer because the washer door is hot when heating. When the hot water is draining, please be carefully as water is hot. The washer is not intended for use by young children or infirm persons without supervision. Young children should be supervised to ensure that they do not play with the washer.

8. Destroy the carton, don't let lids play with the plastic bag and other packing materials after the washer is unpacked.
9. Don't touch the door's inner in case it is hot ,(when opening the door during heating and drying).

The installation

1. The machine can't be installed outside. It must be placed far from any heat source and the sun, in case it damages the plastic and rubber. If the machine is wet, it must be allowed to dry before it can be used.
2. Do not place the machine on carpet as this may obstruct the ventilation opening.
3. During installation, do not stand on washer wires.
4. The washer should be connected to the water mains using new hose-sets. Old hose-sets should not be reused. The hose can't be too long, and its diameter should be the same as the original ones. The height should be between 80-100cm, and can't be immersed in water.
5. If the water pipelines are new or haven't be used for a long time, please let the water out, in case it blocks the filter.
6. The back of the washer should not be tightly against a wall or other furniture.
7. Make sure drain pipelines are fixed firmly.
8. After installation of the washing machine, the power plug should be accessible.

The usage:

1. Because of the changes in the tap water pressure, you should check the pumping pipes, tap, draining pipes and the longer pipes carefully so as to make sure if the junctures are linked tightly before washing.
2. When choosing a washing program, you must turn the program knob clockwise.
3. Don't put any heavy, hot or leaking objects on the washer.
4. When first using the washer let the washer run empty for one program.

5. Do not wash foam rubber or similar objects.
6. There is a program function that soaks the clothes and does not crease them.
7. The selflock equipment is set on the washer door. Don't open the washer door till the machine has been stopped or has been disconnect for 2-3 min, in case the door gets damaged. When there is water in the washer, don't open the machine door.
8. Do not overload the washing machine.
9. The washing machine is designed for use in the home. When washing, please refer to the washing method on the clothes label.
10. Use detergent as directed.
11. Do not put the bleaching powder in the wrong box as it may yellow the clothes.
12. After the washing is finished. Pull out the plug and turn off the tap. Clean the pad's interlining well.
13. When the washer is not in use, please open the machine door slightly to eliminate odours. Do not put plastic or similar material over the washing machine as this will prevent moisture from evaporating.
14. Before washing do up zips, buckles etc. Delicates should be put into a washing bag or pillow case.

Unpacking Levelling and positioning

● Remove the whole Package (fig. 1)

The shock absorption lumps must be removed including the foamy pedestal.

● Check attachments and materials.

Quantity	Name	Loading piping	Key for adjusting feet	Plastic caps against spraying	Certificate of quality	Using instructions	Support for drain hose	Warranty
Model								
XQG60-QFQ1000		2	1	3	1	1	1	1

● Check the accessories and data

The accessories and data are in the plastic bag with the washer.

● Remove the Pack Screws (fig. 2)

Attention: Any transporting, packing and handling of the washing machine should be carried out by a professional.

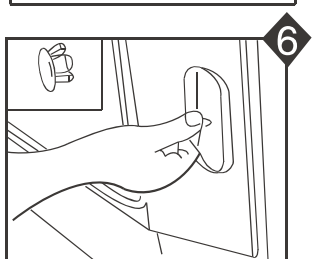
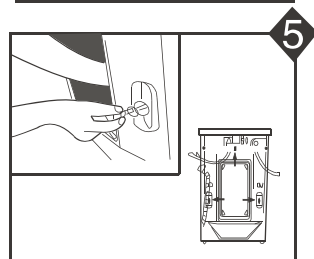
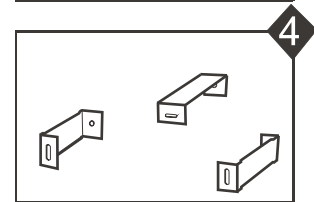
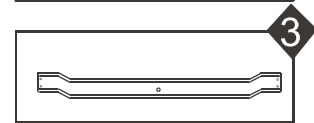
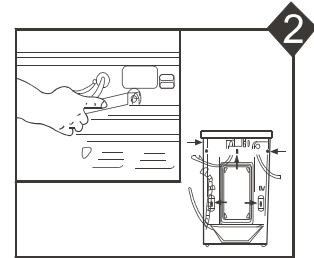
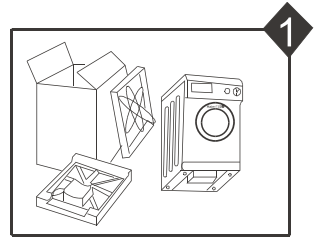

● Adjusting the washing machine

There are adjusting feet under the washer. Before using, adjust the washer horizontally (fig. 7)

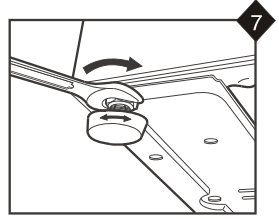

Draining hoses

● The draining hose must be between 80-100cm high(fig.8). Use the joint clips on the back of the machine to fix the soft pipe on the back of washer.

● If the washer is far from the water source, the hose can't be longer than 5m, the diameter of longer hose shall be the same as the original hose.

● Utilize the support to install the water pipe. (fig.9)

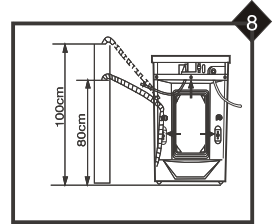

Attention: the draining nozzle should not be submerged in water.

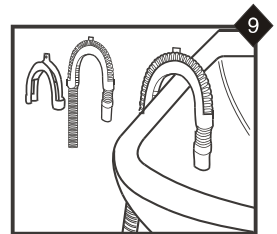

The grounded cord:

- When the washer is being used, it must grounded well.

Cover:

- Take out the cover on the top plate in the carton box, unload the four rubber feet, screw bolt at the bottom of the machine, make the machine incline, and then make the four holes in the cover and the four holes at the bottom of the machine aligned, finally fix the rubber feet.(as shown in picture)

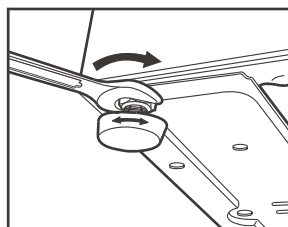
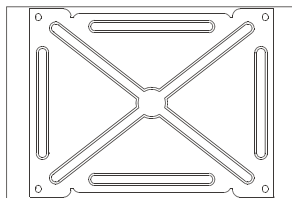

Close up

● Washing Program Knob

Turn the knob clockwise to get the required program.

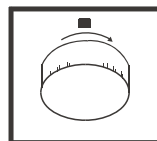

● Washing Temperature Knob

The Washing temperature can be adjusted between 30-90°C by turning this knob. When the knob is on "30", it means cold wash.

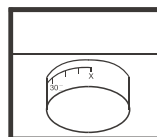

● Detergent dispenser

Open the detergent dispenser and you will see three compartments; 1,2, and 3. Each of these are for different washing agents.

- 1: The pre-washing detergent
- 2: The washing detergent
- 3: The softener essence etc.

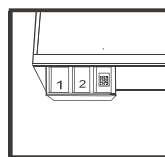

Close up

● Power Button

Push the button down, the washer connects to the electricity automatically. Push the button again to turn off.

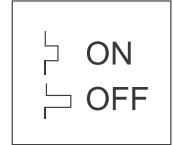

● Power light

The power light glows red when there is electricity to the water.

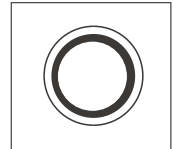

● Speed- button

Push the button down, to reduce spin speed from 1000r/min to 600r/min during a strong washing mode and a medium washing mode.

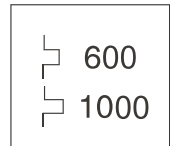

● Half washing key

This reduces the water consumption during the washing program. This should be used when there is a small load of washing when you use this function, decrease the amount of detergents.

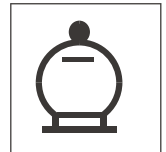

● Soak

For the synthetics cycle and the wool cycle, release the button, the anti-crease function will be skipped and automatically enter into the next step. Push the button down and the anti-crease function will work again.



● Door lock light

When this warning light is on, the door is locked.

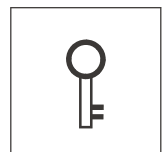

Preparation

1. Power Resource: Connect the power resource
2. Connecting the water resource: Open the tap, the water should be clean.
Open the tap to check the joints between the tap and pumping hose, check if there is a leak.
3. Separate clothes according to the type of material and degree of dirtiness.
 - The clothes' types: Cotton, Chemical Fiber, Silk.
 - Separate white and coloured clothes.
 - Put delicate clothes in a washing machine bag.
 - Do up zip, buckles etc.
 - Items such as sheets should be placed loosely in the washing machine.
 - Turn shirts inside out.

4. Detergent

Open the allocated box, and put in the detergent. Before putting the detergent in compartment 1, be sure that compartment 4 (bleaching powder) is taken out of the compartment 1. If you want to use bleach you cannot use the pre-washing program. If you want to use the pre-washing program, then you must get compartment 4 out, and then put the detergent into compartment 1.

5. The best washing load

Clothes type	Non-fading clothes	Soft fabric	Wool fabric	Textile
Biggest load	6kg	2kg	1kg	2.5kg

Washing Method

1. Loading of clothes

Open the machine door, and place the clothes evenly into the washing machine and close the door.

2. Adding detergent

Take out the detergent distribution box and add adequate detergent, softener, bleaching agent into the corresponding compartments as required and then close the box slightly.

3. Set the washing program

To get the best washing result, the best program-setting mode is chosen according to the type of clothes. The set modes are printed on the handle of the detergent distribution box. Turn the program knob clockwise to set the mode.

Note:

- (1) Before setting the mode, make sure the power switch is turned OFF.
- (2) When choosing the program of medium or soft wash, go to the spin dry/drain, before program clothes will be soaked, if you need to take out the items, please choose the draining program manually. If other clothes need to be spin dried, manually switch the program to spin dry. If you are washing wool or chemical fabrics, take them out of the washing machine immediately after the wash is finished. The clothes will become wrinkled if you do not do this.

4. Choose function key

Choose function keys according to your washing need (refer to Page 8) .

5. Washing

Press down the power key, the machine will operate to the set program.

6. The program has finished

When the program chosen is finished, the machine will stop operating automatically, after 2 minutes press the power key and open the door, take out the clothes, and close the faucet.

Practical know-how

● How to save water during washing

1. Wash the clothes collectively
2. The actual load of clothes should not exceed the rated one.
3. The detergent added should be appropriate.
4. Prewash the dirtiest pieces before washing with other clothes.
5. For less dirty clothes, reduce the amount of the detergent.

● How to use detergents

The 3 compartments marked 1,2,3 should be used as follows:

- 1: Prewash detergent.
- 2: Wash Detergent
- 3: Conditioner, starch, scents

remember that it is important to use the right amount of soap powder or liquid for the type of laundry you are washing, the amount of detergent you use depends on a number of factors:

- water hardness: if the water in your area has a high calcium content, we recommend using a anti-limestone additive.
- degree of dirtiness: increase the amount of soap power used in the case of heavily soiled laundry.
- laundry load: the smaller the load the less soap powder you will need to use

The following table will guide you:

Laundry	Compart 1 prewash	Compart 2 normal wash	Compart 3
normally soiled	1/2 measuring cup	1 and 1/2 measuring cup	softeners (see note "3")

when using concentrated detergents, remember to keep to the manufacturer's instructions using only the measuring cups supplied with the packet

Use more detergent in the case of very hard water (more than 21.F), but remember to maintain the proportion between the prewash and wash cycles.

Liquid detergent

Liquid detergents may be used with the washing machine. Use compartment 2 for very dense liquid detergents. Follow the manufacturers instructions when using liquid detergents.

The pre wash cycle may not be used with liquid detergents.

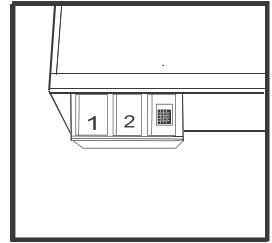

● Wash time

Different types of clothes require different temperatures, functions, washing time, etc. The following table shows the washing time needed with normal water pressure, without heating. It is only for your reference.

Program-setting mode		Approx time (minutes)
strong washing mode-mainly for cotton fabrics	1	12
	2	32
	3	4
	4	28
	5	28
	6	10
	7	12
	●	stop
medium washing mode-mainly for chemical fabrics	A	6
	B	10
	C	18
	D	10
	E	6
	▲	soak
	F	6
	●	stop
soft washing mode-mainly for wool and cashmere	I	8
	II	8
	III	4
	▲	soak
	IV	4
	V	2
	●	stop

Flushing and maintenance

● Flushing

1. Each time after washing, close faucet, open the observing window to prevent moisture and odours. If the machine is not in use for a long time, turn off the power supply, and place the discharge hose as low as possible, Empty the water in the pump to avoid the deterioration of water.
2. When you do any cleaning or maintenance, you should pull out the power plug first. When cleaning the exterior part and rubber parts of the machine, only wipe with a piece of cloth soaked with a small amount of soap water. Do not use solvent or corrosive cleaners.
3. The detergent distribution box should be cleaned regularly. The box is a rotating-axis type. When cleaning, you only need to rotate it to open and then slightly pull up, then drag outward (as illustrated) then rinse with water.
4. Regularly clean the inlet hose connection and the filter to avoid any blockage.

Cleaning and maintenance

● Maintenance for machine when not in use for a long time

If the machine is not in use for a long time, put out the power plug and close the faucet, open the machine door to prevent any odour left in it. Leave the door slightly open when not in use.

● When moving house

Attention: Any transporting, packing and handling of the washing machine, needs to be carried out by professional personnel.

● Clean filter (once a month)

1. Remove the profile as shown in figure 1.
2. Turn and remove the filter in a counter-clockwise direction as shown in figure 2.
3. Clean the filter with water.
4. Mount the filter in a clockwise direction, put the profile back as it was.

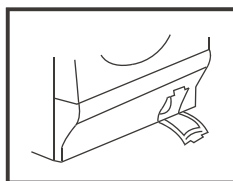
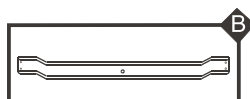
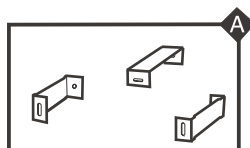
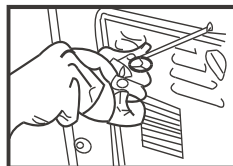
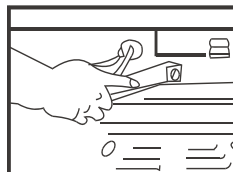
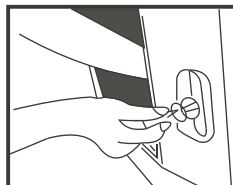
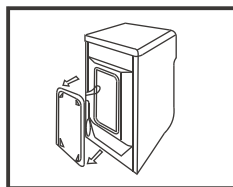

fig.1

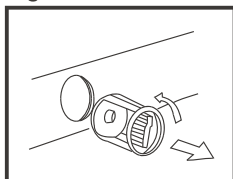

fig.2

Common Queries

● Answers to queries

Not all the following problems are faults, please confirm the following items before maintenance:

Problems	Items to be confirmed
Machine will not start up	Power plug connected to outlet? Electricity is on? Machine door tightly closed? Power button on?
No water in washing machine	Water pressure less than 0.05MPa? Water inlet hose bent or not? Water supply on? Program button in appropriate position? Machine door closed?
Continuous water injection and discharge	The discharge hose end below 80cm?
No water discharged	Discharge hose blocked? Discharge hose end 100cm higher than the ground?
Fierce vibration when spinning	The fix bolts for packing use are all dismantled? Work platform is adjusted level? Load is over the rated 6kg?
Operation stops, program has not finished	Sudden stop to electricity or water? In the normal soaking process?
The washing machine stops for a period during the washing process?	In a state of heating? Note: to ensure washing results, when water temperature is lower than normal temperature, (even though the temperature knob at "" position) the machine will also be heated to normal temperature automatically.

WIRING CIRCUIT(XQG60-QFQ1000)

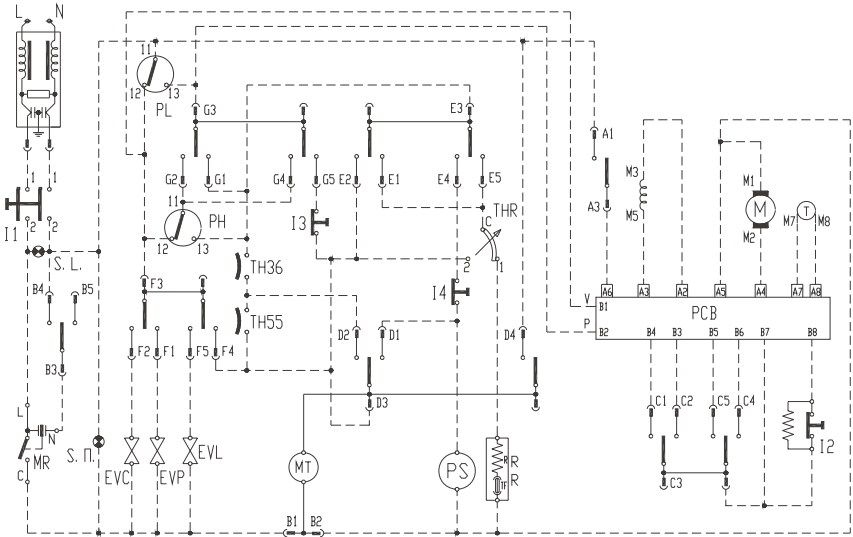

I1=POWER BUTTON

I2=SPEED BUTTON

I3=SOAK BUTTON

I4=ECONOMY BUTTON

L Line

N Neutral

PL Low level pressure switch

PH High level pressure switch

MT Timer motor

THR Adjustable thermostat

MR Thermal lock

PS Drain pump

Free Manuals Download Website

<http://myh66.com>

<http://usermanuals.us>

<http://www.somanuals.com>

<http://www.4manuals.cc>

<http://www.manual-lib.com>

<http://www.404manual.com>

<http://www.luxmanual.com>

<http://aubethermostatmanual.com>

Golf course search by state

<http://golfingnear.com>

Email search by domain

<http://emailbydomain.com>

Auto manuals search

<http://auto.somanuals.com>

TV manuals search

<http://tv.somanuals.com>