

**CENTRAL PNEUMATIC®**

# **AIR FILTER, REGULATOR AND LUBRICATOR**

**Models 92261/  
45009**

## **ASSEMBLY AND OPERATING INSTRUCTIONS**

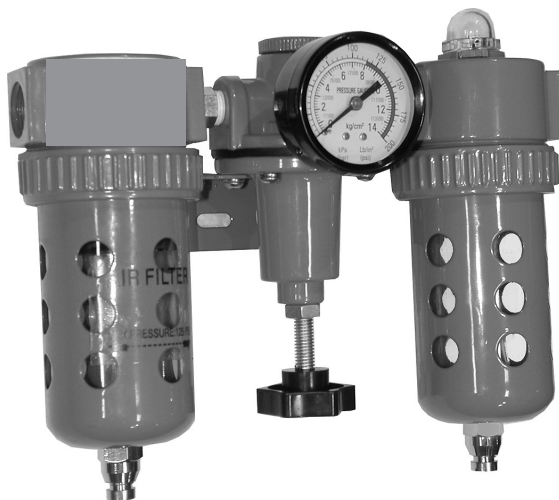

3491 Mission Oaks Blvd., Camarillo, CA 93011  
Visit our Web site at <http://www.harborfreight.com>

Copyright © 2004 by Harbor Freight Tools®. All rights reserved. No portion of this manual or any artwork contained herein may be reproduced in any shape or form without the express written consent of Harbor Freight Tools.

**For technical questions and replacement parts, please call 1-800-444-3353**

## Specifications

Operating Pressure	125 PSI (maximum)
Air Inlet and Outlet Size	(ITEM 45009) $\frac{3}{8}$ inch, 18 NPT
	(ITEM 92261) $\frac{1}{2}$ inch, 20 NPT
Mounting Bracket	2 slots: 0.2 x 0.69 inches; removable
Overall Dimensions	8- $\frac{3}{4}$ x 4- $\frac{5}{8}$ x 7- $\frac{3}{8}$ inches
Weight	2.75 lb.
Filter	Polycarbonate housing; removable; $\frac{7}{8}$ " ~ $\frac{15}{16}$ " ID x 1" OD x $\frac{31}{32}$ " (L)
Features	Adjustable pressure; Pressure Gauge: 0 ~ 200 PSI; 0 ~ 14 Bar; Bleeder drains

## Save This Manual

You will need the manual for the safety warnings and precautions, assembly instructions, operating and maintenance procedures, parts list and diagram. Keep your invoice with this manual. Write the invoice number on the inside of the front cover. Keep the manual and invoice in a safe and dry place for future reference.

## Safety Warnings and Precautions

**WARNING: When using tools, basic safety precautions should always be followed to reduce the risk of personal injury and damage to equipment.**

### Read all instructions before using this tool!

1. **Keep work area clean.** Cluttered areas invite injuries.
2. **Observe work area conditions.** Do not use machines or power tools in damp or wet locations. Don't expose to rain. Keep work area well lighted. Do not use electrically powered tools in the presence of flammable gases or liquids.
3. **Keep children away.** Children must never be allowed in the work area. Do not let them handle machines, tools, or extension cords.
4. **Store idle equipment.** When not in use, tools must be stored in a dry location to inhibit rust. Always lock up tools and keep out of reach of children.
5. **Use the right tool for the job.** Do not attempt to force a small tool or attachment to do the work of a larger industrial tool. There are certain applications for which this tool was designed. It will do the job better and more safely at the rate for which it was intended. Do not modify this tool and do not use this tool for a purpose for which it was not intended.

6. **Do not overreach.** Keep proper footing and balance at all times. Do not reach over or across running machines.
7. **Dress properly.** Do not wear loose clothing or jewelry as they can be caught in moving parts. Protective, electrically nonconductive clothes and nonskid footwear are recommended when working. Wear restrictive hair covering to contain long hair.
8. **Use eye and ear protection.** Always wear ANSI-approved impact safety goggles when using air tools. Wear a full face shield if you are producing metal filings or wood chips. Wear a NIOSH-approved dust mask or respirator when working around metal, wood, and chemical dusts and mists.
9. **Maintain tools with care.** Keep tools sharp and clean for better and safer performance. Follow instructions for lubricating and changing accessories. Inspect tool cords periodically and, if damaged, have them repaired by an authorized technician. The handles must be kept clean, dry, and free from oil and grease at all times.
10. **Disconnect power.** Unplug air compressor (not included) when not in use.
11. **Remove adjusting keys and wrenches.** Check that keys and adjusting wrenches are removed from the tool or machine work surface before plugging it in.
12. **Avoid unintentional starting.** Do not carry any air tool with your finger on the trigger, whether it is plugged in or not.
13. **Stay alert.** Watch what you are doing, use common sense. Do not operate any tool when you are tired.
14. **Check for damaged parts.** Before using any tool, any part that appears damaged should be carefully checked to determine that it will operate properly and perform its intended function. Check for alignment and binding of moving parts; any broken parts or mounting fixtures; and any other condition that may affect proper operation. Any part that is damaged should be properly repaired or replaced by a qualified technician. Do not use any air tool if its switch does not turn On and Off properly.
15. **Replacement parts and accessories.** When servicing, use only identical replacement parts. Use of any other parts will void the warranty.
16. **Do not operate air tools if under the influence of alcohol or drugs.** Read warning labels if taking prescription medicine to determine if your judgment or reflexes are impaired while taking drugs. If there is any doubt, do not operate the tool.
17. **Maintenance.** For your safety, service and maintenance should be performed regularly by a qualified technician.
18. Before using any air tool, read and adhere to all instructions and safety warnings provided in the instruction manual of the tool being used.
19. **Warning:** The brass components of this product contain lead, a chemical known to the State of California to cause birth defects (or other reproductive harm). (California Health & Safety Code § 25249.5, *et seq.*)

**Warning: The warnings, cautions, and instructions discussed in this instruction**

manual cannot cover all possible conditions and situations that may occur. It must be understood by the operator that common sense and caution are factors which cannot be built into this product, but must be supplied by the operator.

## Unpacking

When unpacking, check to make sure all parts are included. Refer to the photo below, and the Parts List and Diagram located at the end of this manual. If any parts are missing or broken, please call Harbor Freight Tools at the number on the cover of this manual.

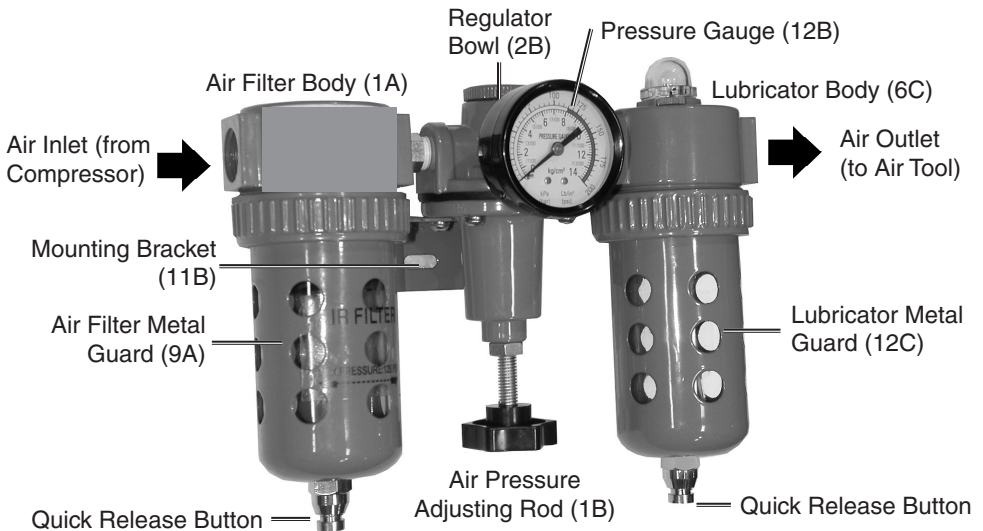

## Assembly

1. Secure the Mounting Bracket (11B) to the Regulator Bowl (2B) if the unit is to be mounted to a flat surface. See photo above.

Use the screws holding the Regulator Bowl to the Regulator Valve (6B). Securely tighten. The Mounting Bracket holes must face to the rear of the unit.

2. Apply pipe thread seal tape to the fitting of the Pressure Gauge (12B).
3. Carefully screw in (clockwise) the Pressure Gauge fitting into the Regulator Valve (6B).

Do not overtighten. Stop turning the Pressure Gauge when the scale is facing up as shown above.

4. Verify that the air Filter Element (4A) is in place on the Filter Body (1A), then place the Plastic Bowl (7A), labeled Air Filter, inside the Metal Guard (9A).
5. Slide the Upper Lid (10A) over the Metal Guard (9A) and place into the Filter Body (1A). Securely tighten the Upper Lid (10A) by turning clockwise.
6. Place the oiler Plastic Bowl (10C), with O-ring (9C), into the Metal Guard (12C).
7. Slide the Upper Lid (13C) over the Metal Guard (12C) and place into the Lubricator Body (6C). Securely tighten the Upper Lid (13C) by turning clockwise.
8. Secure the unit assembly by the Mounting Bracket (11B) to a flat surface using the appropriate hardware (not supplied).
9. Remove the Oil Plug (2C) on top of the Lubricator Body (6C) and add air lubricator oil to the maximum level. Replace Oil Plug.

## Air Connections

**Caution: Avoid injuries. Before connecting this unit to the air compressor, be certain that the air compressor is unplugged from the power source, and all pressure is released from its tank.**

The illustration below shows the general connection for the Air Filter-Regulator and Lubricator.

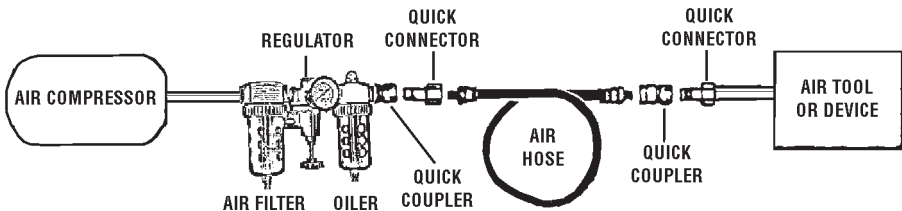

1. Apply pipe thread seal tape to the both ends of a double-sided connector (not supplied), and screw into the air inlet of the Filter Body (1A). Securely tighten.
2. Apply pipe thread seal tape to the both ends of a double-sided connector (not supplied), and screw into the air outlet of the Lubricator Body (6C). Securely tighten.
3. Connect the compressor air output hose or pipe to the air inlet connector (not supplied) on the Filter Body (1A). Quick connectors and couplings (not supplied) may be used for convenience. Use pipe thread seal tape.

4. Connect the air output hose to the air outlet connector (not supplied) on the Lubricator Body (6C). Quick connectors and couplings (not supplied) may be used for convenience. Use pipe thread seal tape.

## Operation

1. Turn on the Compressor and check for air leaks.  
If any are found, turn the Compressor off, drain air from tank, and fix the leak.
2. With the Compressor ON, turn the Air Pressure Adjusting Rod (1B) to adjust the air pressure as read on the Pressure Gauge (12B).
3. Adjust the oil flow by viewing the View Dome (1C) and adjusting the Oil Feed Adjustment Screw (4C) next to it.
4. Under pressure, press the Quick Release Button to expel any accumulated moisture from the Air Filter. Do this daily.

## Maintenance

1. Check oil level in Lubricator Plastic Bowl (10C) daily. Refill if below minimum level.
2. Periodically disassemble the Air Filter and Lubricator assemblies and remove all dirt and debris. Remove air pressure before cleaning.

## Parts List

Part	Description
1A	Filter Body
2A	O-ring
3A	Spiral Baffle
4A	Filter Element
5A	Umbrella Baffle
6A	Screw Rod
7A	Plastic Bowl
8A	Plastic Drain
9A	Metal Guard
10A	Upper Lid
1B	Adjusting Rod
2B	Regulator Bowl
3B	Spring Washer
4B	Spring
5B	Diaphragm
6B	Regulator Valve
7B	Regulator Valve
8B	Spring
9B	O-ring

Part	Description
10B	Pop-up Valve Cap
11B	Mounting Bracket
12B	Pressure Gauge
1C	View Dome
2C	Oil Plug
3C	O-ring
4C	Oil Feed Adjustment Screw
5C	Drip Tube
6C	Lubricator Body
7C	Screw Rod
8C	Coupler
9C	O-ring
10C	Plastic Bowl
11C	Plastic Drain
12C	Metal Guard
13C	Upper Lid
1D	Filter-Regulator Connector
2D	Lubricator-Regulator Connector

**NOTE:** Some parts are listed and shown for illustration purposes only and are not available individually as replacement parts.

## Assembly Drawing

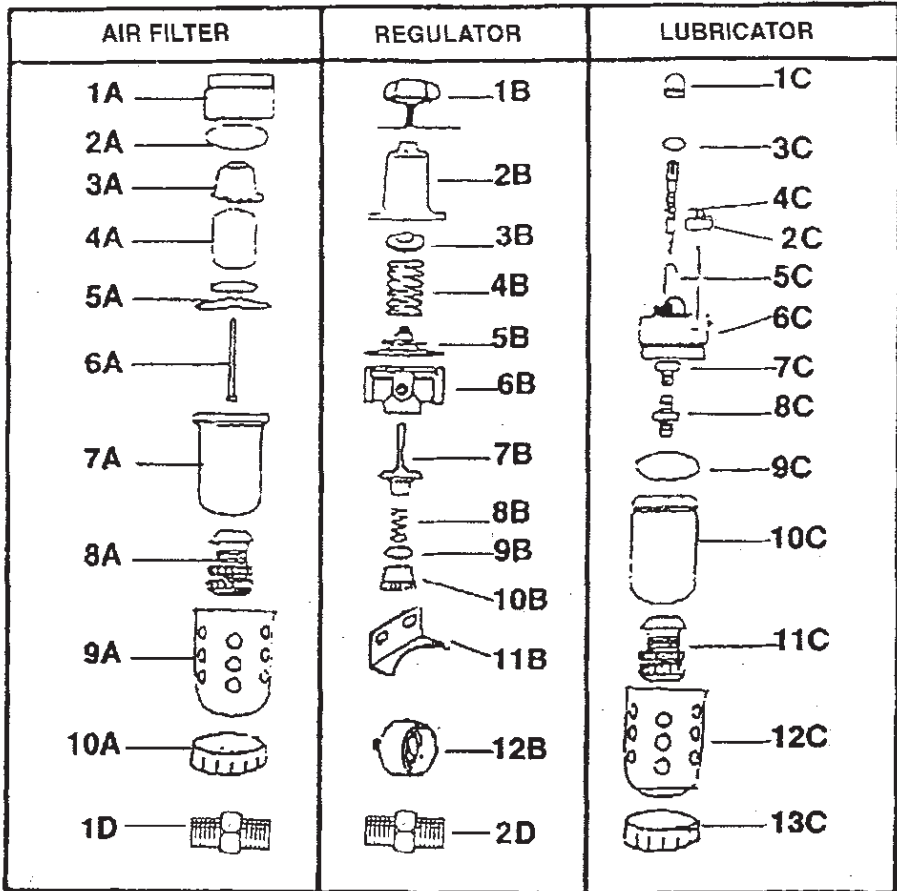

### PLEASE READ THE FOLLOWING CAREFULLY

THE MANUFACTURER AND/OR DISTRIBUTOR HAS PROVIDED THE PARTS DIAGRAM IN THIS MANUAL AS A REFERENCE TOOL ONLY. NEITHER THE MANUFACTURER NOR DISTRIBUTOR MAKES ANY REPRESENTATION OR WARRANTY OF ANY KIND TO THE BUYER THAT HE OR SHE IS QUALIFIED TO MAKE ANY REPAIRS TO THE PRODUCT OR THAT HE OR SHE IS QUALIFIED TO REPLACE ANY PARTS OF THE PRODUCT. IN FACT, THE MANUFACTURER AND/OR DISTRIBUTOR EXPRESSLY STATES THAT ALL REPAIRS AND PARTS REPLACEMENTS SHOULD BE UNDERTAKEN BY CERTIFIED AND LICENSED TECHNICIANS AND NOT BY THE BUYER. THE BUYER ASSUMES ALL RISK AND LIABILITY ARISING OUT OF HIS OR HER REPAIRS TO THE ORIGINAL PRODUCT OR REPLACEMENT PARTS THERETO, OR ARISING OUT OF HIS OR HER INSTALLATION OF REPLACEMENT PARTS THERETO.

## Free Manuals Download Website

<http://myh66.com>

<http://usermanuals.us>

<http://www.somanuals.com>

<http://www.4manuals.cc>

<http://www.manual-lib.com>

<http://www.404manual.com>

<http://www.luxmanual.com>

<http://aubethermostatmanual.com>

Golf course search by state

<http://golfingnear.com>

Email search by domain

<http://emailbydomain.com>

Auto manuals search

<http://auto.somanuals.com>

TV manuals search

<http://tv.somanuals.com>