

*USER & INSTALLATION  
INSTRUCTIONS  
for MODELS  
DF56  
DF55*



---

# Contents...

---

Electricity Supply / Safety Information.....	3	What Can I Wash.....	16
Safety.....	4	Loading your Dishwasher.....	17-18
<i>Installation:</i> .....	5-6	Care & Maintenance.....	19-20
Getting to Know your Appliance.....	7	Troubleshooting.....	21
The Controls.....	8	Important Information.....	22
Programme Guide and Table.....	9-11	Guarantee.....	23
<i>Before Using your Appliance:</i>		After Sales Service.....	24
Adjust the Water Softener.....	12	Key Contacts.....	Back Page
Filling the Special Salt Container.....	13		
Filling the Rinse Aid Container.....	14		
Detergents.....	14-15		

## *Retention of this Instruction Book...*

This Instruction Book must be kept handy for reference as it contains important details on the safe and proper use of the appliance.

If you sell or pass the appliance to someone else, or move house and leave it behind, make sure this Book is also provided so the new owner can become familiar with the appliance and safety warnings.

## *Recycling & Disposal Information...*

As part of our continued commitment to helping the environment, we reserve the right to use quality recycled components to keep down customer costs and minimise material wastage. Please dispose of packaging and old appliances carefully.

To minimise risk of injury to children, remove the door, plug and cut mains cable off flush with the appliance, dispose of separately to ensure that the appliance can no longer be plugged into a mains socket.



---

# Electrical Supply...

---

**WARNING: This appliance must be earthed.**

## Fuses

Your appliance comes fitted with a plug and a 13A fuse. If you need to replace the fuse, only those rated at 13A and ASTA approved to BS1362 should be used. If you lose the fuse cover, a replacement may be obtained from your local authorised Service Centre or Electricity company. Correct replacement is identified by colour coding or the marking on base of plug.

**WARNING: Do not use plug unless fuse cover is fitted.**

## Changing the Plug

Cut off and dispose of the supplied plug if it does not fit your socket.

**WARNING: To avoid a shock hazard do not insert the discarded plug into a socket anywhere else.**

IMPORTANT: WIRES IN THE MAINS LEAD ARE COLOURED IN ACCORDANCE WITH THE FOLLOWING CODE:

Green/Yellow	-	Earth
Blue	-	Neutral
Brown	-	Live

If you change the plug, the colour of wires in the mains lead may not correspond with the terminal markings in the plug, which if not coloured, could be:

EARTH 'E' or   
NEUTRAL 'N'  
LIVE 'L'

## Changing the Mains Lead

A special lead can be ordered from Service UK: 08709 066 066 or Republic of Ireland: 1850 302 220. If you have damaged the existing lead or require a longer one a charge will be made. It is strongly advised that this work is carried out by a qualified electrician.

If the domestic wiring includes a residual current-operated circuit breaker, ensure that it conforms to the latest regulations.

## Safety Information...

### At the time of delivery...

All functions of your dishwasher have been thoroughly tested at the factory. A small number of water marks may have been left as a result, they will disappear when the appliance is used for the first time.

**WARNING: The dishwasher must not be connected to the electricity supply while installation is being carried out.**

- This appliance should only be connected to a 230/240V AC source, via a properly installed earthed socket.
- Use the dishwasher solely in a domestic environment.
- Do not stand or place heavy objects on the door when it is open, this could damage the door or cause the appliance to tip forward.

### If your family includes children...

- Do not allow children to play with the appliance or tamper with the controls.
- Keep detergents and rinse aids away from children. Keep children away from the open door of a dishwasher, there could still be some detergent left inside.



The dishwasher meets all the requirements set out by the regulations in force concerning safety and electrical equipment. Any technical checks should be conducted exclusively by a trained and authorised technician: Repairs carried out by unauthorised persons will invalidate the guarantee, as well as posing a potential hazard to the user.

The manufacturer declines all responsibility for damage to persons or property resulting from failure to observe the above precautions, from tampering with even a single component or from the use of non original spare parts.

---

# Safety...

This manual forms an integral part of the appliance. It must always be kept handy for reference. Read through all the instructions contained in this manual before using the dishwasher.

Installation must be performed by a qualified technician, in compliance with the regulations in force, including the prevention and elimination of radio frequency interference.

- The dishwasher is designed for washing and drying dishes, any other use shall be considered improper. The manufacturer declines all responsibility for uses other than those described above.

The rating plate, featuring the technical data, serial number and markings, is visibly positioned on the inner edge of the door. DO NOT remove the rating plate.

- Separate the various packaging materials and dispose of safely - DO NOT leave discarded packaging material around the home.
- The mains plug must be easily accessible after installation.
- In the event of any damage to the power cord have it replaced by a qualified technician.
- If the dishwasher is installed on a carpeted or covered floor, ensure that the openings on the underside are not obstructed.

**The dishwasher is intended for use by adults.** DO NOT allow children to come near or play with the controls.

Keep children away from detergents and clear of the dishwasher door when open.

Keep all packaging materials away from children.

- DO NOT use solvents such as alcohol or turpentine which may cause an explosion.
- DO NOT load dishes to wash that are soiled with ash, wax or paints.
- DO NOT lean, sit or stand on any part of the dishwasher - this could cause injury and/or damage the appliance.
- DO NOT drink any water residues from inside the dishwasher.

# Installation...

## CONNECT TO A DRAINAGE SYSTEM...

### WARNING

● **Connect your dishwasher drain hose to pipes which connect to the foul drain system, and not to surface water drains.**

### IMPORTANT NOTES

**For the correct operation of your dishwasher, it is essential to comply with the following information.**

### Standpipe

Ensure that the hose is not pushed too far down the standpipe.

If the end of your drain hose is fitted with 'retaining flaps', ensure that they are inserted fully into the standpipe. This will prevent the pipe from jumping out during installation and machine use.

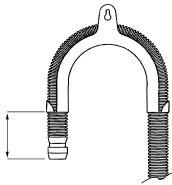

DO NOT position the standpipe near an electrical outlet.

ENSURE that the drain hose is not kinked and it is routed as shown in the diagram.

The standpipe should be connected to:

- A discharge stack-pipe
- An external gully OR
- A sink waste.

The standpipe should have a bore of at least 38mm (1 1/2"). It should be installed as shown, have a trap fitted and must discharge into the same drain system as your household sink.

It must NOT be connected to a surface water drain.

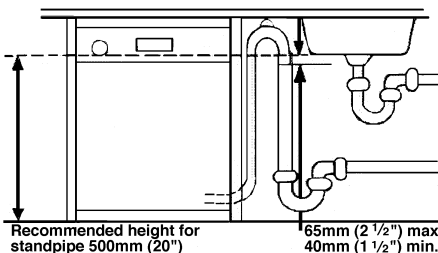

## Sink Waste System

For under sink drainage:

Before connecting the drain hose, remove any internal restrictions - This will prevent a build up of debris which could cause a blockage.

Remove any restrictions from the waste spigot and ensure that the sealing bung is removed. The hose should be routed, such that it is raised to a minimum height of 800mm (3 1/2")

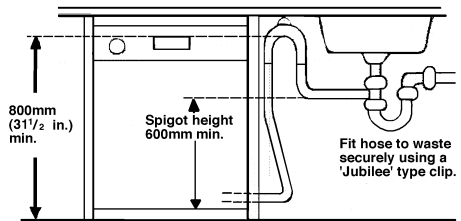

*Note: Ensure the sink outlet pipe has a minimum diameter of 32mm.*

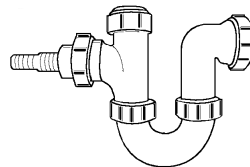

1. Untie the end of the GREY drainage hose from the rear of the appliance.
2. Reposition 'Hooked End Support' as required along GREY drainage hose.
3. If fitting an under sink waste disposal unit, cut out the membrane, bung or blanking plug.
4. Attach the GREY drainage hose to the under sink waste disposal unit securely, using the clip and rubber tube supplied.



**Ensure the drain hose is securely attached, to prevent it coming away while the machine is in use and causing a flood.**

# Installation...

## CONNECT TO THE WATER SUPPLY...

- For your machine to operate correctly it requires water pressures in the range of 6-150 psi (100-1000 KPa). Most cold water supplies will be in this range.  
NOTE: Low water pressure will lead to excessively long fill times or no fill.
- Ensure that the new hose supplied is connected and the old hose is disposed of safely.
- Before connecting hose to the cold water supply ensure the filter gauze is fitted in the filler hose connector.

### WARNING

- Ensure the fill hose is NOT kinked.

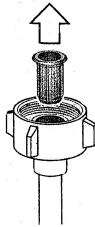

*Note: Do not over tighten the hose connector. Hand tight is sufficient.*

- Tap connections (if applicable) - A range of adapters are available to suit your tap.

### WARNING

- **Do not connect appliance to a single outlet instantaneous water heater or an electric heater.**

**Remember you may be charged for a service call if a problem with your appliance is caused by incorrect installation or misuse.**

## CHECKLIST...

When you have installed your appliance, ensure it is ready to use by following this Check List:

1. Dispose of packaging safely, see 'Recycling Information' on page 2.
2. Position appliance close to electrical/water supply.
3. Connect supplied hose to appliance water supply, confirm water is flowing before connecting to the appliance inlet valve.
4. Untie drainage hose at rear of appliance and connect to either a standpipe or sink waste drainage system see 'Connect to a Drainage System'.
5. Untie mains lead at rear of appliance and plug into electrical supply via a switched socket, see 'Electrical Supply' on page 3.
6. Position appliance, taking care not to kink or damage hose at rear of appliance.
7. Stabilise the appliance by adjusting the feet.
8. Turn on the water supply to the appliance.
9. Switch on at plug socket.

*Your appliance is now ready for use, refer to 'Getting to know your Appliance' on page 7 to familiarise yourself with the appliance.*

---

# Getting to Know your Appliance...

---

*Interior...*

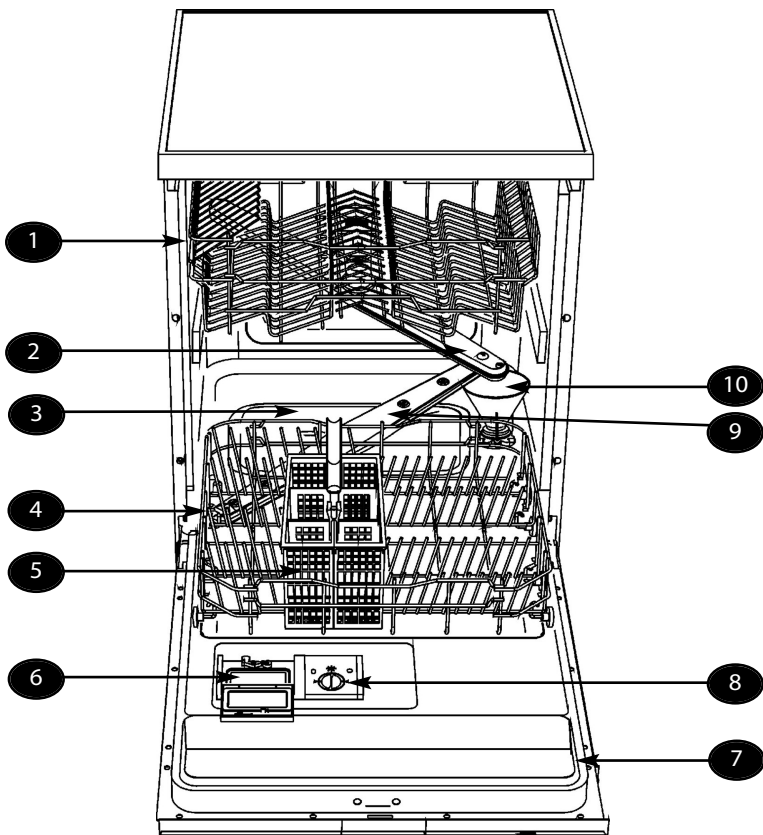

1. Upper Basket
2. Upper Spray Arm.
3. Filters.
4. Lower Basket.
5. Cutlery Rack.

6. Detergent Compartment.
7. Rating Plate.
8. Rinse Aid Container.
9. Lower Spray Arm.
10. Salt Container, with level indicator.

# The Controls...

All the controls are grouped on the front panel.

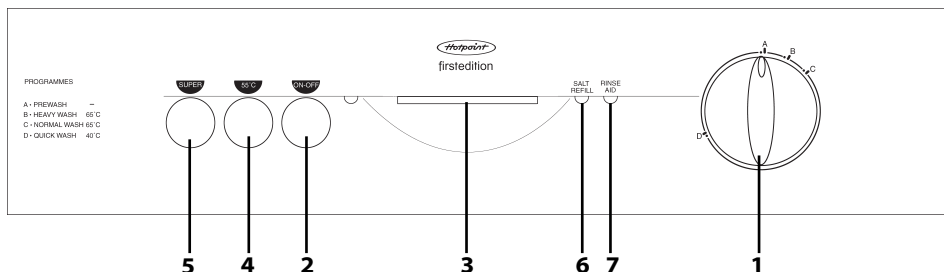

- |   |                            |   |   |
|---|----------------------------|---|---|
| 1 | Washing programme selector | 5 | SUPER button (Model DF56 only)              |
| 2 | On/Off button              | 6 | Salt refill warning light (Model DF56 only) |
| 3 | Recessed door handle       | 7 | Rinse Aid warning light (Model DF56 only)   |
| 4 | ECONOMY 55° button         |   |   |

**WARNING:**  
**CHILDREN SHOULD NOT BE ALLOWED TO PLAY WITH THE APPLIANCE OR TAMPER WITH THE CONTROLS.**



# Programme Guide...

## Before starting a wash programme, make sure that:

- The water supply tap is open.
- The correct amount of detergent has been added to the dispenser.
- The baskets have been loaded correctly.
- The spray arms can rotate freely and without obstruction.
- The dishwasher door is securely closed.

## Setting the Wash Programme and Switching On:

To select the most suitable programme for the dishes to be washed, refer to the PROGRAMME TABLE (see next page). The table shows the most appropriate programme according to item and degree of soiling.

After using the table to identify the most appropriate PROGRAMME SELECTION. Set the selector (1) to the programme of your choice by aligning the pointer with the programme letter.

After loading the dishwasher and choosing the wash programme:

- press the ON/OFF button (2).

## Cancelling the current programme:

To cancel the programme in progress, the programme must be switched off by pressing the ON/OFF button (2).

Turn the wash programme selector to A: Prewash and wait for the dishwasher to start. On completion of the programme, switch off the dishwasher by pressing the ON/OFF button (2).

## TABLE FOR CERTIFICATION BODIES

Reference standard	EN 50242
Reference programme	(*) Selector on 3
Load	12 place settings
Type of detergent	B
Amount of detergent	30g
Rinse aid setting	Depending on the Model 3/4 or 4/6

## Changing the programme:

To cancel the programme in progress, the dishwasher must be switched off by pressing the ON/OFF button (2).

Turn the wash programme selector to the programme required and switch the dishwasher on again by pressing the ON/OFF button (2). The dishwasher will carry out the new programme automatically.



## End of cycle:

At the end of the washing programme the selector will be on one of the STOP markers, depending on the programme carried out. Switch off the dishwasher by pressing the ON/OFF button (2).

# PROGRAMME TABLE

PROGRAMME	PROGRAMME SELECTOR POSITION	ELECTABLE OPTION		WHEN PROGRAMME SHOULD BE USED	PROGRAMME SEQUENCE					AMOUNT OF DETERGENT	DURATION	CONSUMPTION	
		55°C	SUPER (DF56 only)		PREWASH	WASH	COLD RINSE	HOT RINSE	DRYING			Water (litres)	Power (Kwh)
PRE WASH	A	-	-	PREVENT DRIED ON RESIDUE, PRIOR TO A WASH PROGRAMME	COLD	-	-	-	-	-	6 minutes	4	-
INTENSIVE WASH	B	-	✓	VERY HEAVILY SOILED PANS AND DISHES, INCLUDING DRIED ON RESIDUE	45°	65°	2	65°	YES	10 + 25	1 hour 50 minutes	22	1.65
HEAVY WASH	B	-	-	HEAVILY SOILED PANS AND DISHES, INCLUDING DRIED ON RESIDUE	COLD	65°	1	65°	YES	30	1 hour 40 minutes	18	1.45
ECONOMY HEAVY WASH	B	✓	-	NORMALLY SOILED PANS AND DISHES, INCLUDING DRIED ON RESIDUE	COLD	55°	1	65°	YES	30	1 hour 36 minutes	18	1.28
NORMAL WASH	C	-	-	NORMALLY SOILED PANS AND DISHES	-	65°	1	65°	YES	30	1 hour 32 minutes	16	1.4
ECONOMY NORMAL (*)	C	✓	-	SLIGHTLY SOILED PANS AND DISHES	-	55°	1	65°	YES	30	1 hour 30 minutes	16	1.24
QUICK WASH	D	-	-	LIGHTLY SOILED PANS AND DISHES	-	45°	1	65°	YES	25	1 hour	13	1.1

(\*) Reference programme as EN 50242 standard

- Not present (button position   
 ✓/Present (button position )

---

# Programme Guide...

---

## **To save on energy...**

- Always try to run the dishwasher fully loaded.
- Do not wash the dishes in running water.
- Use the washing programme that is most appropriate for each type of load.

## **To cut down on detergent consumption...**

The phosphates contained in dishwasher detergents are harmful to the environment. To avoid using excessive amounts of detergent and to save electricity, observe the following:

- Separate the more delicate items from dishes that are more resistant to aggressive detergents and high temperatures.
- Do not pour the detergent directly onto the dishes.

## **Removing the dishes:**

At the end of the washing programme, wait at least 20 minutes before removing the dishes, to allow them to cool down.

To prevent any water droplets on the upper basket from dripping onto the dishes in the lower basket, it is advisable to unload the lower basket first - and then remove the upper basket.

# Before Using your Appliance...

Before using your Dishwasher you must carry out the following steps to ensure you obtain the best possible wash performance from your appliance.

Follow these 4 steps:

- Adjust the Water Softener.
- Fill the Salt Container.
- Fill the Rinse Aid Container.
- Add detergent.

## ADJUSTING THE WATER SOFTENER...

The dishwasher is equipped with a device for the user to adjust the water softening system, according to the hardness of the water supply. The adjustment selector can be found inside the plastic locking ring located on right hand interior wall. This allows adjustment to 5 settings:

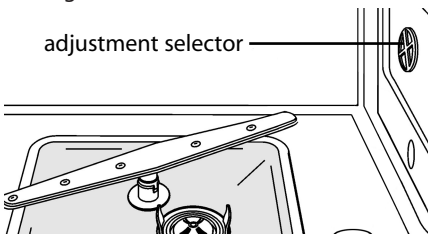

- In order to rinse dishes and glasses satisfactorily, the dishwasher requires soft water i.e containing little or no lime, otherwise water stains are left behind on crockery and glasses etc. If the tap water exceeds a certain level of hardness, it must be softened, ie. decalcified, so that it can be used in the dishwasher.
- The dishwasher is equipped with an automatic softening system which uses a special regenerating salt to reduce the hardness of the water. The dishwasher is factory set for water hardness level **3** (average hardness 41-60° dF - 24-31° dH).
- In order to ensure that the correct amount of salt is being used to regenerate the water softener, the dishwasher is equipped with an electronic device for adjusting the water softening setting. The setting may be adjusted electronically. To set this correctly the hardness of your water needs to be ascertained.

SETTING	WATER HARDNESS
N. 1 NO SALT	0 - 4° dH (0 - 7° dF)
N. 1	5 - 9° dH (8 - 15° dF)
N. 2	10 - 22° dH (16 - 37° dF)
N. 3	23 - 29° dH (38 - 50° dF)
N. 4	30 - 35° dH (51 - 60° dF)
N. 5	36 - 41° dH (61 - 70° dF)

## WATER HARDNESS TABLE:

- Contact your local water board for information on the water hardness for your area.

When using water of medium hardness, the regenerating salt container should be refilled after approximately 20 wash cycles. The salt container can hold approximately 1.7Kg of salt in grains.

## FILLING THE SPECIAL SALT CONTAINER...

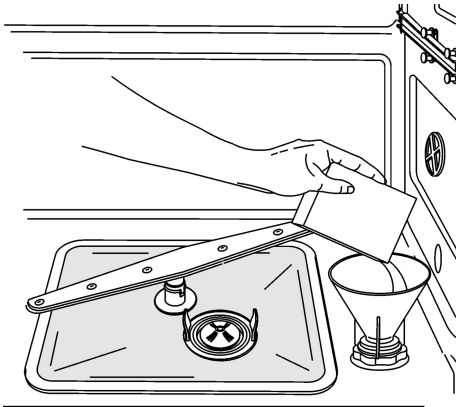

### *Note:*

*Only use recommended Dishwasher salt or granular salt.*

***DO NOT** use everyday table salt, cooking salt or road salt as they contain insoluble substances which could harm the Dishwasher.*

### *How the salt works:*

While washing is taking place, salt is automatically rinsed out of the salt container into the water softener where it dissolves the lime in the water. The dissolved lime is pumped out of the dishwasher. The water softener system is then ready for the next load. This process of regeneration can only function when the salt is dissolved in water.

The container is situated at the bottom of the dishwasher.

You will need to remove the lower basket for access.

- You should fill just before starting the programme.
- Unscrew the lid of the salt container, turning it anti-clockwise to remove. Before using the dishwasher for the first time, pour approximately 1 litre of water into the salt container.
- Use the supplied funnel to fill salt to the top of the container. As you tip in the salt some of the water is displaced and drains away. When you have done this, clean off any remnants of salt from the area around the neck of the container. Always make sure that the cap is replaced securely ensuring that it is not cross-threaded.

### *Information:*

Add salt when required as advised in the chart on the previous page.

Refill the salt container before starting the wash programme.

In this way the excess saline solution will be immediately washed away by the water, the prolonged presence of salt water inside the tank may lead to corrosion.

When using the dishwasher for the first time, in addition to the salt it is also necessary to add ONE litre of water to the container.

### **WARNING:**

**DO NOT** pour detergent into the special Salt Container. This will destroy the water softener.

Each time the salt container is refilled, make sure that the cap is securely closed.

The mixture of water and detergent must never penetrate the salt container, as this would compromise the operation of the regeneration system. In the event of this occurring, the guarantee will be invalidated.

The detergent and rinse aid dispensers are situated on the inner part of the door: the detergent dispenser is on the left and the rinse aid dispenser is on the right.

### FILLING THE RINSE AID CONTAINER...

The purpose of Rinse Aid is to help the dishes dry faster and to prevent formation of water marks on tableware and utensils, and to ensure that glasses are clean and sparkling.

Rinse Aid is consumed during the washing process and needs adding when required.

RINSE AID WARNING LIGHT (*Model DF56*)

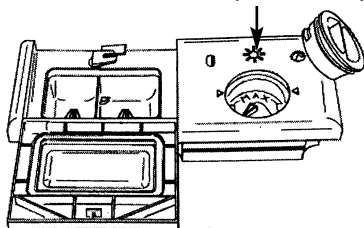

- Open the door. Rotate the rinse aid container cap anticlockwise by  $\frac{1}{4}$  of a turn and remove it.
  - Add the rinse aid until the container is full (approximately 140cc). The level indicator on the side should be completely obscured.
- Refill the rinse aid when the optical level indicator becomes clear again, or when the rinse aid warning light illuminates (*Model DF56 only*).
- Replace the cap, turn clockwise and ensure it is securely closed.
  - Use a cloth to remove any spillage.

#### Important:

Only use rinse aids intended for use in domestic dishwasher's,

### Adjusting the amount of Rinse Aid...

The amount of rinse aid added to the water can be varied by adjusting the control. The rinse aid control has been factory set for medium water hardness.

Do not alter the setting of the rinse aid control unless streaks or water marks are left on the dishes.

To adjust the rinse aid setting, rotate the dispenser cap through a quarter turn in an anti-clockwise direction and remove it. Use a screwdriver to turn the rinse aid control to

the required position. Replace the cap securely turning clockwise.

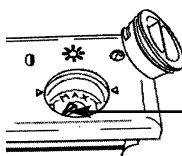

RINSE AID CONTROL

- The amount of rinse aid needs to be increased if the appear dull or you can see circular stains.
- The amount of rinse aid needs to be reduced if the dishes are sticky or you can see whit streaks.

### DETERGENTS...

#### Information about detergents:

You can use any brand of liquid or powder detergent, as well as tablets, that have specifically designed for use in domestic dishwasher's.

DO NOT use normal washing up liquid.

There are three types of dishwasher detergent available:

1. those containing phosphates and chlorine.
2. those containing phosphates but no chlorine.
3. those containing neither phosphates nor chlorine.

When a phosphate-free detergent is used in conjunction with hard water, there is a greater possibility that white marks will be left behind on crockery and glasses etc. These can be avoided by pouring an increased amount of detergent into the dispenser.

Chlorine-free detergents have a reduced bleaching effect. This can mean that tea stains are not completely removed or that plastic items become discoloured.

This can be resolved by:

- selecting a higher temperature programme, or
- increasing the amount of detergent, or
- using a detergent that contains chlorine.

Check detergent packaging labels to determine whether a particular product is suitable for use with silverware.

### Adding the detergent...

With the exception of the Prewash programme, you will need to add detergent before every washing cycle.

To open the detergent dispenser lid, lightly press button 'P'. Add the detergent and close the lid carefully.

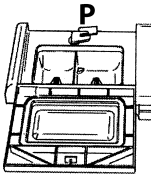

During the washing cycle the dispenser will be opened automatically.

*It is important to use detergent specially designed for domestic dishwashers.*

**We recommend Glist 3 in 1 for use in this (or your new) dishwasher...**

Brilliant cleaning is guaranteed with **Glist 3 in 1**.

**Hotpoint only recommends Glist 3 in 1 Dishwasher tablets to give outstanding cleaning and care.**

It is important to use detergent specially designed for domestic dishwashers. (Always follow the manufacturers instructions.)

**Glist 3 in 1** advanced dishwasher tablets with active enzymes are the ideal way to protect and care for your dishwasher, while getting your dishes sparkling clean.

### Softer Water

Built in salt action softens water, helping to prevent the build up of limescale in the dishwasher and improve the cleaning result\*.

### Cleaner Dishes

With unique active enzymes in the cleaning phase **Glist 3 in 1** breaks down even the hard to shift foodstuffs and grease, leaving the dishes spotless and the dishwasher clean too.

### Sparkling Results

The built-in Glist rinse agent ensures the dishes are free from water marks and smears and even the glasses will come out glistening.

If you have any questions regarding **Glist 3 in 1**, please contact the hotline on 0800 216 730.

\*If you live in an area particularly prone to very hard water (>35°f) Glist and Hotpoint recommend that you continue to keep your dishwasher salt topped up.



---

# What can I Wash...

---

*Items not suitable for the dishwasher:*

- Cutlery and tableware made from wood or part wood-They become faded and unsightly in appearance.
- Avoid washing horn-handled and bronze cutlery in the machine.
- Delicate/decorative glassware and vases, special antique or irreplaceable china - the decorative patterns printed on these objects will not be dishwasher proof.
- Plastic objects that are not resistant to hot water.
- Copper and Pewter utensils.
- Aluminium and silver objects.
- Decorative patterns printed on the surface of crockery, glasses etc.
- Some types of glass can become opaque in appearance after they have been washed too many times in a dishwasher.
- Highly absorbent materials such as, sponges and towels should never be placed in a dishwasher.

*If in any doubt, check with the manufacturer of the China, pan(s) and cutlery on their suitability for dishwasher's.*

***WARNING: Dishes or cutlery that have been soiled by tobacco ash, wax, lubricating grease or paint, should not be put in the dishwasher.***

*Our recommendation:*

In future, only purchase table or kitchen-ware that has been confirmed as being dishwasher proof.



# Loading your Dishwasher...

Your dishwasher is designed to take 12 standard place settings.

There is no one correct method for loading the dishwasher. The upper and lower baskets are designed to give the maximum flexibility possible to cope with the variety of cups, glasses, dishware, pots, pans and utensils - not to mention your oven fittings or teapot, which might be put into the dishwasher.

## Loading

- First remove all coarse food remains which could block the filter or damage the wash pump.
- Arrange all items so that water can drain away, as you would on a draining board.
- Large or heavily soiled items should go in the lower basket. The lower basket plate rack can be folded down to accommodate larger items. The upper basket can be adjusted to allow for large items in the lower basket. Smaller, delicate items (eg. glasses) should go in the top basket.
- Arrange plates so that they are not touching and water can flow freely between them.
- Tall, narrow receptacles should be placed in the centre of the baskets, directly over the spray.
- Long stemmed glasses should lean against the cup rack, not against dishware.
- Cutlery should be distributed at random in the cutlery basket with handles down (except if the handles are very thin and could drop through the basket).
- Long cutlery, such as ladles and knives should be laid horizontally across the filled cutlery basket.
- Pots and pans with baked on areas should first be soaked and then arranged, upside down in the lower basket, so that the water jets can have direct access to the dirty areas.
- After loading check that the upper spray arm is free to rotate by giving it a spin with your hand.

## WARNING:

**ALWAYS CHECK THAT PLASTIC AND WOODEN ITEMS ARE SECURELY PLACED AND ARE WEIGHTED DOWN WITH HEAVIER OBJECTS SO THAT THEY CANNOT BECOME DISLODGED.**

**TAKE EXTRA CARE WHEN LOADING AND UNLOADING SHARP ITEMS SUCH AS KNIVES.**

## LOADING the Upper Basket...

It is recommended to load the upper basket with small or medium sized items such as glasses, small plates, tea or coffee cups, shallow bowls and light objects made from heat resistant plastic. If the upper basket is used in the lowest position, it can also be loaded with serving dishes, provided they are only slightly soiled.

To make full use of the space available the top basket has two plastic grids that can be lifted to make room for tall glasses such as stem glasses.

Load the dishes with the top side facing forwards, cups and concave containers should always be loaded with the opening facing down. The left side of the basket can be loaded with cups and glasses on two levels. In the centre section, plates and saucers can be loaded vertically into the supports provided.

## Upper Basket Loading Examples:

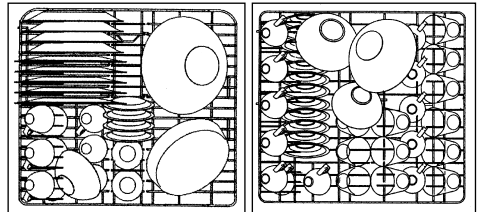

# Loading your Dishwasher...

## ADJUSTING THE UPPER BASKET...

The upper basket can be adjusted in two positions, according to your needs and to allow for the height of dishes in the lower basket.

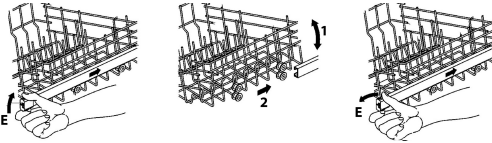

Pull out version:

- Pull the basket out fully.
- Remove the stop 'E' first releasing it as shown.
- Push the guide to free the wheels.
- Lift the basket and insert the lower pair of wheels into the guide, depending on the setting required.
- Return the stop 'E' to its original position.

## LOADING the Lower Basket...

The lower basket receives the full force of the lower spray arm and should therefore be used for the 'toughest' items with a heavier degree of soiling.

All types and combinations of loads are permitted, provided that the dishes, pots and pans are arranged with all the soiled surfaces exposed to the water jets coming from the bottom.

Carefully load flat plates, soup dishes, dessert and serving dishes, positioning them vertically. Pots, pans and their covers must be loaded upside down. When loading soup plates and dessert bowls be sure to leave a gap between them.

Lower Basket Loading Examples:

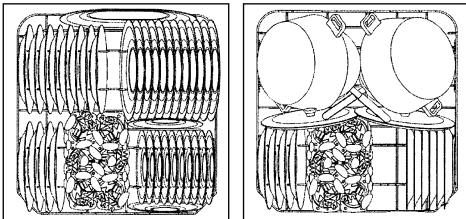

## CUTLERY BASKET...

The cutlery should be arranged in an orderly manner inside the cutlery basket - with handles pointing downwards.

Take care during loading to avoid injury from the knife blades.

The basket is suitable for all types of cutlery, except those long enough to interfere with the upper spray arm.

Ladles, wooden spoons and cooking knives can be placed in the upper basket, making sure that the knife blades do not protrude from the basket.

# Care and Maintenance...

**Before carrying out any work, always disconnect the dishwasher from the electrical power supply.**

Regular inspection and maintenance helps to prevent problems from occurring. You should therefore carefully inspect the inside of your dishwasher from time to time.

## **Overall condition of appliance.**

- Clean the outer surfaces and door lining of the dishwasher regularly using a soft cloth moistened with water or with a detergent which is suitable for painted surfaces. Clean the door gaskets with a damp sponge. **Avoid the use of acidic or abrasive detergents.**
- Periodically (once or twice a year) it is advisable to clean the tank and gaskets, using a soft cloth and water to remove any deposits.
- Check that no grease or scale has accumulated on the inside of the dishwasher.

If you discover any deposits:

- Clean the interior of the dishwasher thoroughly with a detergent solution.

## **Cleaning the Filter Unit.**

The filters prevent large particles of food in the water from reaching the pump. These particles may occasionally block the filters.

- It is advisable to periodically check the centre filter 'C' and if necessary to clean it. To remove the filter, grip the tabs, turn anticlockwise and lift upwards.

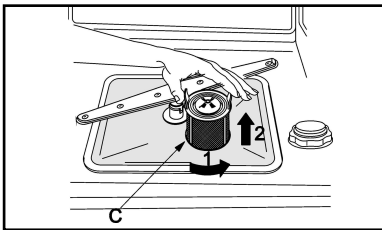

- Push the centre filter 'D' from the underside to remove it from the micro-filter.

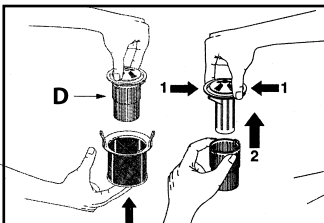

- Separate the two parts which make up the plastic filter by pressing the body of the filter in the position shown by the arrows.
- Remove the centre filter by lifting it upwards.

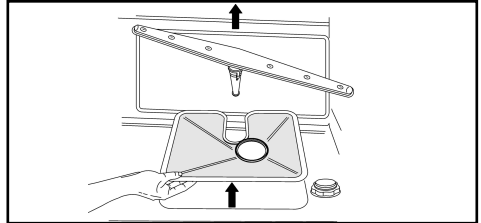

The filters should be cleaned carefully under running water using a stiff brush.

- Carefully replace the filters by following the above instructions in reverse order.

## **Cleaning the Water Intake Filter.**

The water intake filter, located at the outlet of the water supply tap, needs to be cleaned periodically.

Turn OFF the water supply tap, unscrew the water intake hose to remove from the tap. Clean the filter carefully, under running water. Relocate the filter and carefully screw the water intake hose onto the tap.

# Care and Maintenance...

## **Spray arms.**

The spray arms can be easily removed for periodic cleaning of the nozzles, to prevent possible blockage.

- To remove the upper spray arm, unscrew locking ring 'R'.

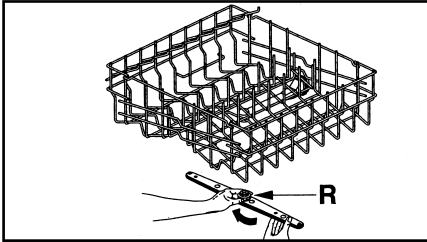

- To remove the lower spray arm, hold centrally and simply lift it up.

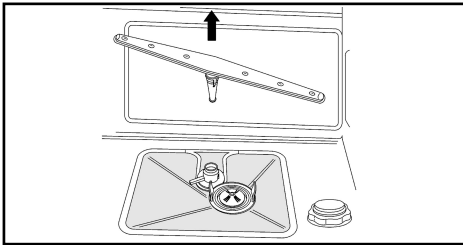

- Clean both spray arms under running water.
- Re-fit the spray arms. Check that spray arms turn freely.

# Troubleshooting...



## Caution

- Do not forget that repairs should only be carried out by a qualified specialist. Improper repairs can lead to considerable equipment damage as well as danger to the user.
- The dishwasher must first be disconnected from the electricity supply before any repairs or other work can be carried out. Switch off at the mains socket and water supply and remove the plug.

## Resolving minor problems yourself.

Experience has shown that you can resolve most problems that arise during normal daily usage yourself, without having to call out a service engineer. Not only does this save costs, but it also means the appliance is available for use again that much sooner. The following list of common occurrences and their remedies should help you identify the causes of most problems.

## Problems...

### ...When the appliance is switched on.

- Appliance does not start:
  - Is the dishwasher plugged in at the electricity socket and switch on?
  - Is there a power failure, check other appliances.
  - Fault with fuse in mains electricity supply.
  - Appliance door not closed properly.
  - Water tap not turned on.
  - Ensure fill hose is not kinked.

### ... If water remains inside the dishwasher, check:

- the drain hose is not kinked.
- the drain syphon is not obstructed.
- the dishwasher filters are not clogged.

### ...If the dishes are not being cleaned properly, check:

- the correct amount of detergent has been added.
- there is regenerating salt in the salt container.
- the dishes are being loaded correctly.
- the selected programme is suitable for the type of dishes and the degree of soiling.
- all filters are clean and positioned correctly.
- the spray arm nozzles are not obstructed.
- there is nothing obstructing the rotation of the spray arms.

### ...If the dishes fail to dry or remain full, check:

- there is rinse aid inside the rinse aid container.
- the rinse aid dispenser setting is correct.
- the detergent being used is of good quality and has not lost its effectiveness (for example, through incorrect storage, with the box left open).

### ...If the dishes show signs of streaking, staining etc. check:

- the rinse aid dispenser setting is not too high.

### ...If there are visible traces of rust inside the tank, check:

- the tank is made of steel and therefore any rust marks are due to external elements (fragments of rust from the tank pipes, pots, cutlery etc.) Special products are commercially available to remove such marks.
- the amount of detergent being used is correct. Certain detergents can be more corrosive than others.
- the cap off the salt container is securely closed and that the water softening setting is correct.

If you have gone through the possibilities in the list above and the problem persists, contact your nearest Service office (see Back Cover).

Switch off at the mains socket and remove the plug. Turn off the water supply.

---

# Important Information...

---

## **Going Away:**

If the appliance is not going to be used for some time carry out the following:

- Run the pre wash programme, twice in succession.
- Switch off at the electrical socket and unplug.
- Turn off the water supply tap, disconnect the intake hose and allow to drain.
- Fill the rinse aid dispenser.
- Leave the door open, to prevent any unpleasant odours inside the dishwasher.

Before using the dishwasher after a long break, plug in and switch on at the electrical socket. Reconnect the intake hose and turn on the water supply tap. Check there are no deposits or rust inside the water pipe, if there are allow water to run from the water supply tap for a few minutes.

## *Disconnecting the Dishwasher...*

When disconnecting the appliance it is important that tasks are carried out in the correct sequence:

- Switch off at the mains and remove the plug from the socket.
- Turn off the water supply.
- Disconnect drain and water intake hose.
- Pull out the appliance, carefully, withdrawing hoses at the same time.

## *Transporting the Dishwasher...*

Drain water from the dishwasher. Secure all loose parts. Only transport in an upright position.

- If not kept upright during transport, any water remaining inside, may seep into the control module and cause subsequent errors with programme functions.



CE marking certifies that this appliance conforms to the following EEC directives:

*Low Voltage Equipment 72/23/EEC  
Electromagnetic Compatibility 89/336/EEC  
and subsequent modifications.*

# Notes...

# Notes...



# Notes...

# Guarantee

## “Satisfaction guaranteed or your money back”

We give you a unique ‘satisfaction guaranteed’ promise - **valid for 90 days** - after you have purchased your product. If there is a technical problem simply call Repair service or visit our web-site at [www.theservicecentre.co.uk](http://www.theservicecentre.co.uk) and where necessary, we will arrange for an engineer to call. If the technical problem is not resolved under this guarantee, **we will replace your machine or, if you prefer, give you your money back.**

All appliances carry a fully inclusive 12 month parts and labour guarantee as well as free replacement parts for the first 5 years (except microwaves, selected integrated appliances and cooker hoods, which have a one year guarantee) provided that they are fitted by our engineer.

### Guarantee terms and conditions

Your guarantee is only applicable in the United Kingdom or Republic of Ireland and is subject to the following provisions that your appliance:

- Has been installed and used correctly in accordance with this instruction booklet.
- Has been used solely for domestic purposes and is located on domestic premises (ie. not for commercial or trade use).
- Has been properly connected to a suitable electrical supply voltage as stated on the appliance rating plate.
- Has not been subject to misuse, accident, modified or repaired by anyone other than one of our own service engineers.



For pre purchase information on any other product call: 08701 50 60 70  
or visit: [www.hotpoint.co.uk](http://www.hotpoint.co.uk)



## Recycling & Disposal Information

As part of our continued commitment to helping the environment, we reserve the right to use quality recycled components to keep down customer costs and minimise material wastage.

Please dispose of packaging and old appliances carefully. To minimise risk of injury to children, remove the door, plug and cut mains cable off flush with the appliance. Dispose of these parts separately to ensure that the appliance can no longer be plugged into a mains socket, and the door cannot be locked shut.

# After Sales Service

**“No company is better positioned to offer an after sales service on our appliance than us - the manufacturer”**

As part of our commitment to you, all appliances have the added benefit of a fully inclusive parts and labour guarantee for the first 12 months. In addition to this you also have the advantage of **free replacement parts for the first 5 years** when fitted by our engineer. When the 12 months parts and labour guarantee expires we offer the following after sales service options:

## ***Repair Service and Information Help Desk***

UK: 08709 066066

[www.theservicecentre.co.uk](http://www.theservicecentre.co.uk)

Republic of Ireland: 1850 302 200

Note: Our operators will require the Model number and the Serial number of your appliance.

Available 364 days a year with a fast, effective and value for money service. We have the largest white goods repair service in the UK with over 1200 of our own fully trained engineers. All repairs include a parts and labour guarantee for 12 months from the date of the repair. If you require any information or have any questions about your appliance, our operators are on hand with help and advice.

All this ensures that you will receive the best available after sales service possible.

## ***Extended Warranties***

UK: 08709 088 088

[www.theservicecentre.co.uk](http://www.theservicecentre.co.uk)

Republic of Ireland: 1850 502 200

Whether you have just one or a number of our appliances in your kitchen, we offer two service cover plans to give you total peace of mind.

- Repair Protection Plan - FREE service repairs for a single appliance during the period of cover.
- Kitchen Cover - FREE service repairs for all our appliances you own which are less than 8 years old.

## ***Genuine Parts and Accessories***

UK: 08709 077 077

[www.theservicecentre.co.uk](http://www.theservicecentre.co.uk)

Republic of Ireland: (01) 842 6836

A wide range of genuine parts and accessories are available from our hotline or through our web site.

**Genuine parts and accessories, extended warranties and service repairs are all available on our web-site at:**



[www.theservicecentre.co.uk](http://www.theservicecentre.co.uk)



## Key Contacts

### After Sales Service

Over 1200 trained specialists, directly employed by us, ensure that you can have complete confidence in both the appliances and services we offer.



### Repair Service and Information Desk

UK: 08709 066 066

(Open 8 to 8 Mon - Fri, 8 to 6 Sat and 10 to 4 Sun & Bank Holidays)

[www.theservicecentre.co.uk](http://www.theservicecentre.co.uk)

Republic of Ireland: 1850 302 200

Note: Our operators will require the following information:

Model number

Serial number

### Extended Warranties

UK: 08709 088 088

(Open 8 to 8 Mon - Fri)

[www.theservicecentre.co.uk](http://www.theservicecentre.co.uk)

Republic of Ireland: 1850 502 200

### Genuine Parts and Accessories

UK: 08709 077 077

(Open 8-30 to 5-30 Mon - Fri & 9 to 12 Sat)

[www.theservicecentre.co.uk](http://www.theservicecentre.co.uk)

Republic of Ireland: (01) 842 6836

General Domestic Appliances Limited, Morley Way, Peterborough, PE2 9JB.

Part No. FP113-01

Download from [Www.Somanuals.com](http://Www.Somanuals.com). All Manuals Search And Download.

## Free Manuals Download Website

<http://myh66.com>

<http://usermanuals.us>

<http://www.somanuals.com>

<http://www.4manuals.cc>

<http://www.manual-lib.com>

<http://www.404manual.com>

<http://www.luxmanual.com>

<http://aubethermostatmanual.com>

Golf course search by state

<http://golfingnear.com>

Email search by domain

<http://emailbydomain.com>

Auto manuals search

<http://auto.somanuals.com>

TV manuals search

<http://tv.somanuals.com>