

# HP StorageWorks Modular Smart Array 20 Maintenance and Service Guide



July 2004 (First Edition)  
Part Number 365511-001

© Copyright 2004 Hewlett-Packard Development Company, L.P.

The information contained herein is subject to change without notice. The only warranties for HP products and services are set forth in the express warranty statements accompanying such products and services. Nothing herein should be construed as constituting an additional warranty. HP shall not be liable for technical or editorial errors or omissions contained herein.

HP StorageWorks Modular Smart Array 20 Maintenance and Service Guide

July 2004 (First Edition)  
Part Number 365511-001

---

# Contents

## About This Guide

Audience Assumptions .....	v
Technician Notes .....	v
Where to Go for Additional Help .....	vi
Telephone Numbers .....	vi

## Chapter 1

### Illustrated Parts Catalog

## Chapter 2

### Identifying Enclosure and Component Features

Buttons and LEDs on Enclosure Rear .....	2-1
Disk Drives and Drive Blanks .....	2-2
Controller Module .....	2-4
Fan Assembly .....	2-5
Power Supply Unit .....	2-6

## Chapter 3

### Removing and Replacing Components

Preventing Electrostatic Damage .....	3-1
Grounding Methods .....	3-1
Replacement Procedures for Hot-Pluggable Components .....	3-2
Disk Drive or Drive Blank .....	3-2
Fan Assembly .....	3-3
Power Supply Unit .....	3-3
Controller Module .....	3-4
Battery Packs and Cache (in the Controller Module) .....	3-4
Mounting Bracket Covers .....	3-6
Replacement Procedures for Non-Hot-Pluggable Components .....	3-6
Midplane Board .....	3-7
Backplane Board .....	3-9
Ribbon Cable .....	3-9
UID Circuit Board .....	3-10
VRM Power Supply .....	3-10

**Chapter 4**

**Specifications**

Power Specifications.....4-1  
Environmental Specifications .....4-1  
Physical Specifications .....4-2

---

## About This Guide

This maintenance and service guide can be used for reference when servicing the HP StorageWorks Modular Smart Array 20 enclosure.



**WARNING:** To reduce the risk of personal injury from electric shock and hazardous energy levels, only authorized service technicians should attempt to repair this equipment. Improper repairs can create conditions that are hazardous.

---

## Audience Assumptions

This guide is for service technicians. HP assumes you are qualified in the servicing of computer equipment and trained in recognizing hazard in products with hazardous energy levels and are familiar with weight and stability precautions for rack installations.

## Technician Notes



**WARNING:** Only authorized technicians trained by HP should attempt to repair this equipment. All troubleshooting and repair procedures are detailed to allow only subassembly/module-level repair. Because of the complexity of the individual boards and subassemblies, no one should attempt to make repairs at the component level or to make modifications to any printed wiring board. Improper repairs can create a safety hazard.

---



**WARNING:** To reduce the risk of personal injury from electric shock and hazardous energy levels, do not exceed the level of repairs specified in these procedures. Because of the complexity of the individual boards and subassemblies, do not attempt to make repairs at the component level or to make modifications to any printed wiring board. Improper repairs can create conditions that are hazardous.

---



**WARNING:** To reduce the risk of electric shock or damage to the equipment:

- Disconnect power from the system by unplugging all power cords from the power supplies.
  - Do not disable the power cord grounding plug. The grounding plug is an important safety feature.
  - Plug the power cord into a grounded (earthed) electrical outlet that is easily accessible at all times.
-



**CAUTION:** To properly ventilate the system, you must provide at least 7.6 cm (3.0 in.) of clearance at the front and back of the enclosure.

---



**CAUTION:** The enclosure is designed to be electrically grounded (earthed). To ensure proper operation, plug the AC power cord into a properly grounded AC outlet only.

---

**NOTE:** Any indications of component replacement or printed wiring board modifications may void any warranty.

## Where to Go for Additional Help

In addition to this guide, the following information sources are available:

- User documentation
- *Service Quick Reference Guide*
- Service training guides
- Service advisories and bulletins
- QuickFind information services
- Systems Insight Manager software

## Telephone Numbers

For the name of the nearest HP authorized reseller:

- In the United States, call 1-800-345-1518.
- In Canada, call 1-800-263-5868.

For HP technical support:

- In the United States and Canada, call 1-800-633-3600.
- Outside the United States and Canada, refer to <http://www.hp.com>.

---

## Illustrated Parts Catalog

The spare parts for the enclosure are illustrated on the following page.

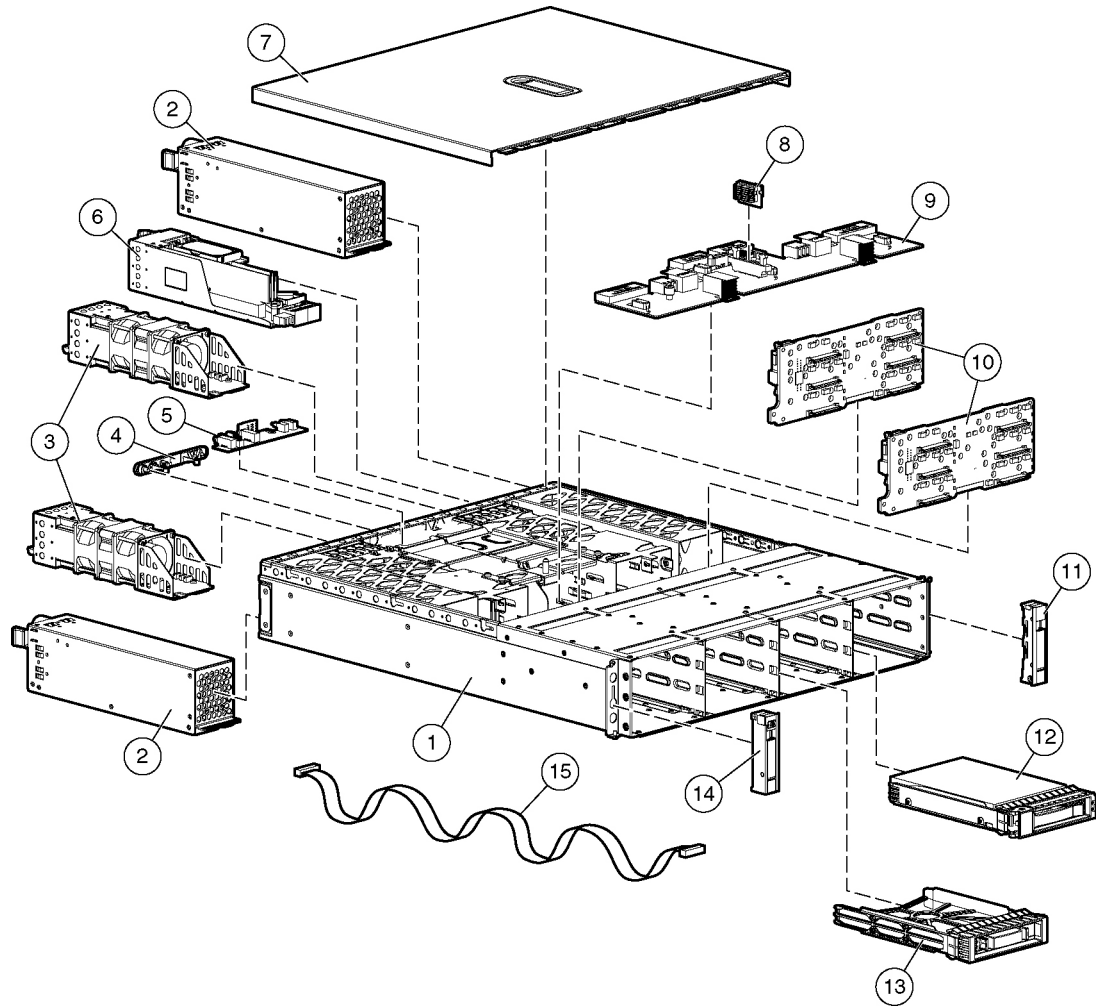

Figure 1-1: Enclosure parts



<b>Item</b>	<b>Description</b>	<b>Spare part number</b>
1	Chassis	Not spared
2	Power supply unit	349800-001
3	Fan assembly	349798-001
4	Button and LED panel	Not spared
5	UID circuit board	361183-001
6	Controller module	Module shell (sheet metal) with controller board, 349797-001 Upper battery pack with cable, 349799-001 Lower battery pack, 307132-001 Cache board with battery, 309521-001
7	Enclosure lid	Not spared
8	VRM power supply	361741-001
9	Midplane	349795-001
10	Backplanes (two identical boards per enclosure)	361740-001
11	Mounting bracket cover (bezel ear)	349801-001 (supplied in a kit with item 14)
12	Hard drive	Not spared as part of enclosure
13	Drive blank	Not spared as part of enclosure
14	Mounting bracket cover (bezel ear)	349801-001 (supplied in a kit with item 11)
15	Ribbon cable (connects item 5 to item 9)	361739-001
Not shown	Return kit	349803-001

## Identifying Enclosure and Component Features

### Buttons and LEDs on Enclosure Rear

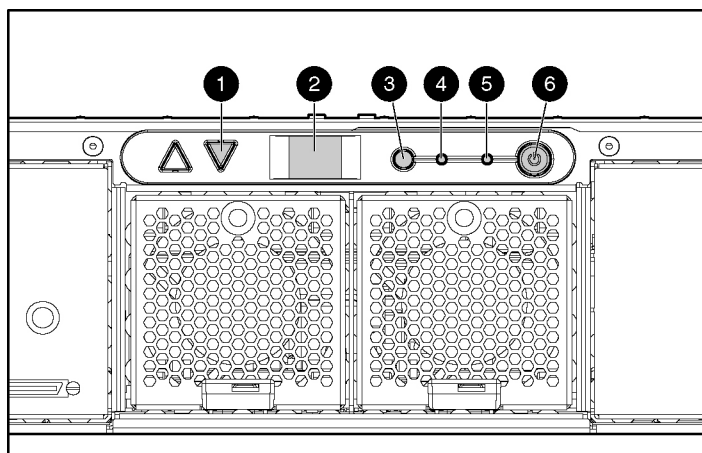

**Figure 2-1: Enclosure buttons and LEDs**

Item	Description
1	Arrow buttons (for future use)
2	Enclosure ID display—Indicates the ID number assigned to the enclosure during drive configuration
3	Unit identification button—Causes the blue LED on all drives in the enclosure to be illuminated
4	Enclosure monitor status LED—Illuminates green to indicate that the enclosure monitor (Global Service Indicator, or GSI) is functional
5	Enclosure fault LED—Illuminates amber when any other LED in the enclosure is amber, if the GSI is functional
6	Enclosure power button

## Disk Drives and Drive Blanks

The drive bays on the front of the enclosure are numbered as follows:

1	4	7	10
2	5	8	11
3	6	9	12

The features of the drives and blanks are illustrated in Figure 2-2.

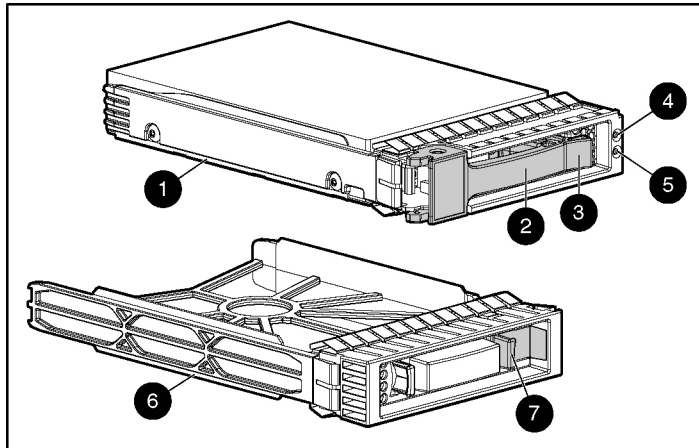

**Figure 2-2: Drive (in carrier) and drive blank**

Item	Description
1	Drive carrier
2	Release lever
3	Release button
4	Fault/ID bicolor LED (amber or blue)
5	Online LED (green)
6	Drive blank
7	Release latch

The blue ID LED illuminates when you press the unit identification button on the rear of the enclosure. This LED also illuminates when the drive or an array containing the drive is selected in a management application, such as the HP Array Configuration Utility (ACU).

The amber LED on a drive illuminates when the drive has failed or when a management application predicts that it will fail in the near future.

For more information about the meaning of various drive LED illumination patterns, refer to Table 2-1.

**Table 2-1: Interpreting the Drive Status LEDs**

<b>Online LED (green)</b>	<b>Fault/ID LED (amber/blue)</b>	<b>Meaning</b>
On, off, or flashing	Alternating between amber and blue	The drive has failed, or a predictive failure alert* has been received for this drive. It has also been selected by a management application.
On, off, or flashing	Steadily blue	The drive is operating normally, and it has been selected by a management application.
On	Amber, flashing regularly (1 Hz)	A predictive failure alert* has been received for this drive. Replace the drive as soon as possible.
On	Off	The drive is online, but it is not currently active.
Flashing regularly (1 Hz)	Amber, flashing regularly (1 Hz)	The drive is part of an array that is undergoing capacity expansion or stripe migration, but a predictive failure alert* has been received for this drive. To minimize the risk of data loss, do not replace the drive until the expansion or migration is complete.
Flashing regularly (1 Hz)	Off	The drive is rebuilding, or it is part of an array that is undergoing capacity expansion or stripe migration.
Flashing irregularly	Amber, flashing regularly (1 Hz)	The drive is active, but a predictive failure alert* has been received for this drive. Replace the drive as soon as possible.
Flashing irregularly	Off	The drive is active, and it is operating normally.
Off	Steadily amber	A critical fault condition has been identified for this drive, and the controller has placed it offline. Replace the drive as soon as possible.
Off	Amber, flashing regularly (1 Hz)	A predictive failure alert* has been received for this drive. Replace the drive as soon as possible.
Off	Off	The drive is either offline, a spare, or not configured as part of an array.

\*Predictive failure alerts can occur only when the MSA20 is connected to a Smart Array controller. For information about interpreting the drive fault LED when the MSA20 is connected to an MSA1500 cs, refer to the release notes at <http://www.hp.com/go/msa1500cs>.

## Controller Module

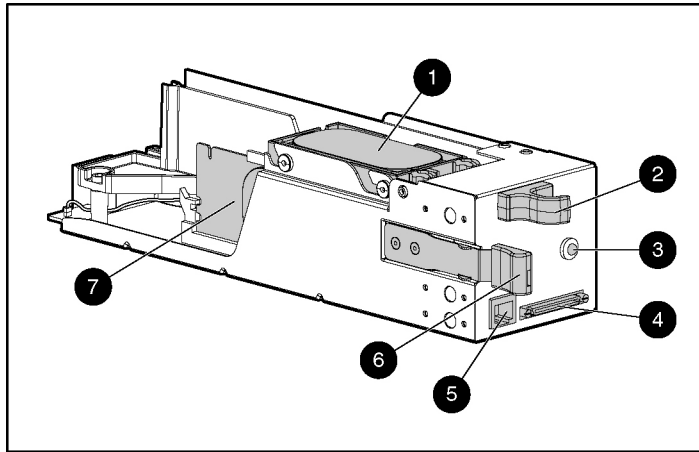

**Figure 2-3: Controller module**

Item	Description
1	Upper cache battery
2	Finger hook
3	Bicolor status LED (green or amber)
4	VHDCI connector (for connecting to a sixth-generation Smart Array controller or an MSA1500 cs enclosure)
5	Service port
6	Release lever
7	Controller cache (lower cache battery just visible)

## Fan Assembly

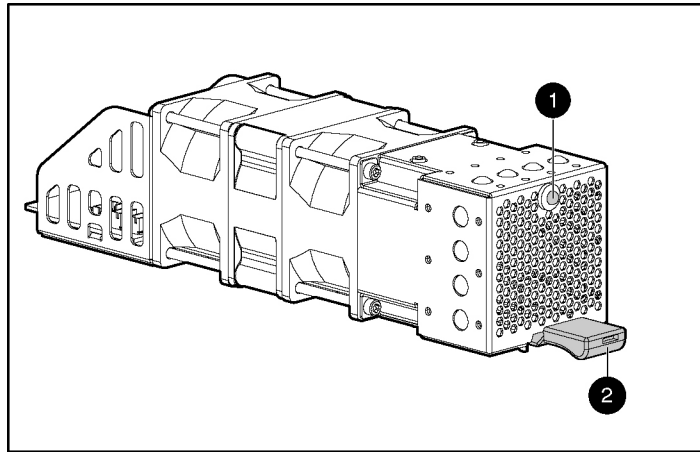

**Figure 2-4: Fan assembly**

Item	Description
1	Bicolor status LED (green or amber)
2	Release lever

## Power Supply Unit

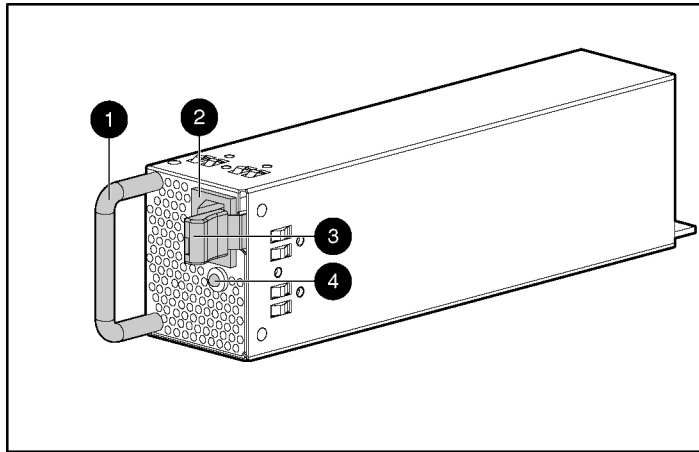

**Figure 2-5: Power supply unit**

Item	Description
1	Handle
2	AC power inlet
3	Release lever
4	Bicolor status LED (green or amber)



**WARNING:** Do not use the handles on the power supply units to lift or hold the enclosure. These handles are designed only for holding the power supply units or removing them from the enclosure, not for supporting the weight of the enclosure.

---

---

## Removing and Replacing Components

Some enclosure components are hot-pluggable, while others should be replaced only after you have disconnected the enclosure from the AC power source.

**Table 3-1: Classification of Components**

Hot-pluggable	Not hot-pluggable
Mounting bracket covers (bezel ears)	Midplane board
Hard drive or drive blank	Backplane board
Power supply unit	UID circuit board
Fan assembly	VRM power supply
Controller module	

### Preventing Electrostatic Damage

A discharge of static electricity from a finger or other conductor might damage system boards or other static-sensitive devices. This type of damage can reduce the life expectancy of the device.

To prevent electrostatic damage when setting up the system or handling parts:

- Avoid hand contact by transporting and storing products in static-safe containers.
- Keep electrostatic-sensitive parts in their containers until they arrive at static-free workstations.
- Place parts on a grounded surface before removing them from their containers.
- Avoid touching pins, leads, or circuitry.
- Always be properly grounded when touching a static-sensitive component or assembly.

### Grounding Methods

There are several methods for grounding. Use one or more of the following methods when handling or installing electrostatic-sensitive parts:



- Use a wrist strap connected by a ground cord to a grounded workstation or computer chassis. Wrist straps are flexible straps with a minimum of 1 megohm  $\pm$  10 percent resistance in the ground cords. To provide proper ground, wear the strap snug against the skin.
- Use heel straps, toe straps, or boot straps at standing workstations. Wear the straps on both feet when standing on conductive floors or dissipating floor mats.
- Use conductive field service tools.
- Use a portable field service kit with a folding static-dissipating work mat.

## Replacement Procedures for Hot-Pluggable Components

Removing a hot-pluggable component causes a significant change in the airflow within the enclosure, and the enclosure could overheat if a replacement component is not installed within a relatively short time.

- Before removing a component from the enclosure, be sure that a replacement component is immediately available.
- If removing a drive, replace it with another drive or a drive blank to maintain the correct airflow in the enclosure.



**CAUTION:** Be careful when replacing a drive. The drives in the enclosure are fragile.

---

The following general steps apply to all components. Detailed procedures for removing individual components are given in the appropriate section of this chapter.

1. Remove the replacement component from its static-free container.
2. Check the label on the replacement component to be sure that it is of the correct type.
3. Remove the defective component from the enclosure.
4. Install the replacement component in the enclosure.
5. Observe the status LED of the replacement to confirm that the new component is operating properly.
6. Place the defective component in the static-free container for shipment.

## Disk Drive or Drive Blank

### Removing a Drive Blank

Squeeze the release latch and hold it in while pulling the blank out of the enclosure.

### Removing a Disk Drive

1. Press the release button.

2. Pull the drive out of the enclosure by about 3 cm (1 inch) so that it is disconnected from the backplane connector.



**CAUTION:** A drive with a rapidly spinning disk can be difficult to hold securely. To decrease the chance of dropping the drive, do not remove it completely from the enclosure until the disk has stopped rotating. This usually takes a few seconds.

---

3. When the disk is no longer spinning, remove the drive from the enclosure.

### Installing a Drive Blank

Insert the drive blank into the enclosure, and push it in until it is firmly seated in the enclosure.

### Installing a Replacement Drive



**CAUTION:** Take care when installing a drive. The drives in the enclosure are fragile.

---

1. Pull out the release lever on the drive as far as it can go.
2. Insert the replacement drive into the bay until it can go no further. About 1 cm (0.5 inch) of the drive protrudes from the bay.
3. Push the release lever all the way in. This action installs the drive completely in the bay and seats it firmly against the connector in the enclosure.
4. Observe the drive status LEDs to confirm that the replacement drive is functioning correctly.

### Fan Assembly

1. Lift the release lever and pull the fan assembly out of the enclosure.
2. Slide the replacement fan assembly into the enclosure until it is firmly seated in the enclosure.
3. Confirm that the fan starts operating immediately and that the status LED is illuminated green.

### Power Supply Unit

1. Disconnect the AC power cord from the defective power supply unit.
2. Squeeze the handle and the release lever together while pulling the defective power supply unit out of the enclosure.
3. Insert the replacement power supply unit into the empty bay until it is firmly seated in the enclosure.
4. Connect the AC power cord.
5. Confirm that the status LED on the replacement unit is illuminated green.

## Controller Module

1. Back up the data on the system.
2. Stop data transfers.
3. Disconnect the VHDCI cable.
4. Squeeze the release lever and the finger hook together while pulling the controller module out of the enclosure.
5. Transfer the cache and batteries from the degraded controller module to the replacement controller module.
6. Insert the replacement controller module into the enclosure until it is firmly seated in the enclosure.
7. Connect the VHDCI cable to the connector on the new controller module.



**CAUTION:** To prevent damage to the cable connector, do not use excessive force when tightening the thumbscrews on the connector.

---

8. Confirm that the status LED on the replacement module is illuminated green.

## Battery Packs and Cache (in the Controller Module)



**WARNING:** There is a risk of explosion, fire, or personal injury if the battery pack is not properly handled. To reduce this risk:

- Do not try to recharge the batteries if they are disconnected from the controller.
- Do not expose the battery pack to water, or to temperatures higher than 60°C.
- Do not abuse, disassemble, crush, or puncture the battery pack.
- Do not short the external contacts.
- Replace the battery pack only with the designated HP spare.

**Battery disposal should comply with local regulations. Alternatively, use established parts return methods to return the battery pack to HP for disposal.**

---

**IMPORTANT:** When replacing either battery, disconnect **both** batteries from the controller board as described in these instructions. This ensures that the circuitry on the controller board is reset, and the controller can then recognize the new battery.

1. Flush the cache.
2. Remove the controller module from the enclosure (for detailed instructions, refer to the Controller Module section).

3. Remove the upper battery unit (1).
  - a. Loosen the thumbscrews (2).
  - b. Disconnect the battery cable (3).

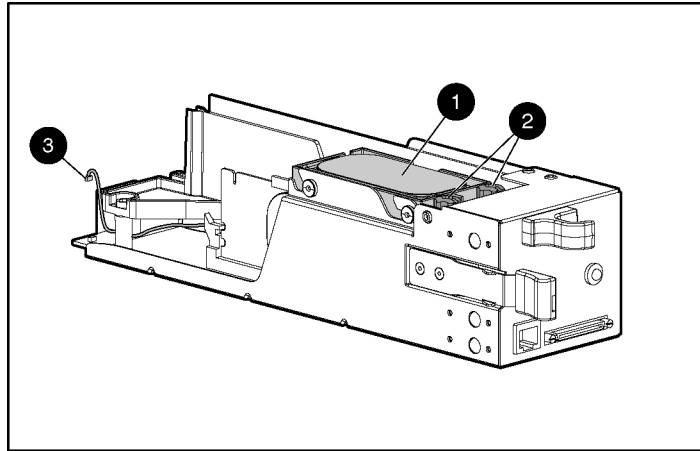

- c. Slide the upper battery unit toward the rear of the controller module and lift it out.
4. If the battery pack in the upper battery unit must be replaced, remove it as follows:
  - a. Unwind the battery cable completely from around the battery pack.
  - b. Push the two plastic retainer tabs up and through the slots in the battery case (1).
  - c. Tilt the battery pack slightly away from the battery case (2).
  - d. Press down on the battery pack to expel it from the battery case (3).

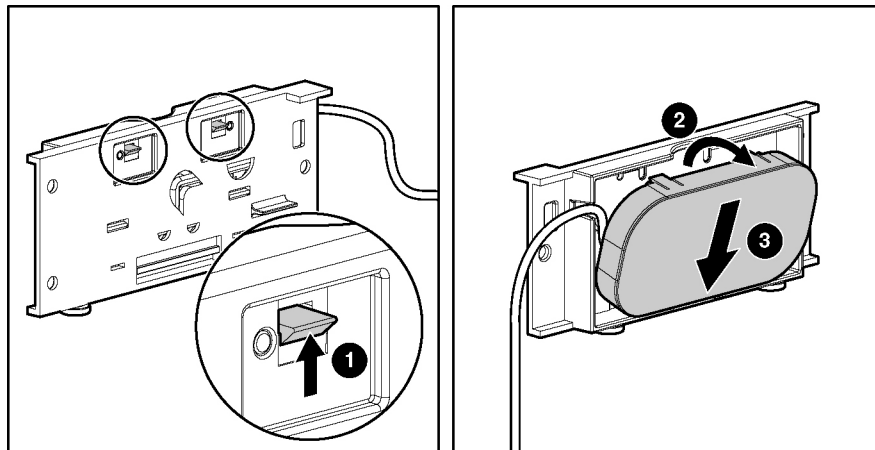

5. Remove the cache from the controller board:
  - a. Open the ejector levers on each side of the memory module socket (1).
  - b. Pull the cache board out of the socket (2).

If the cache battery must be replaced:

- a. Press down on the plastic retainer tabs and push them through to the other side of the cache board (3).

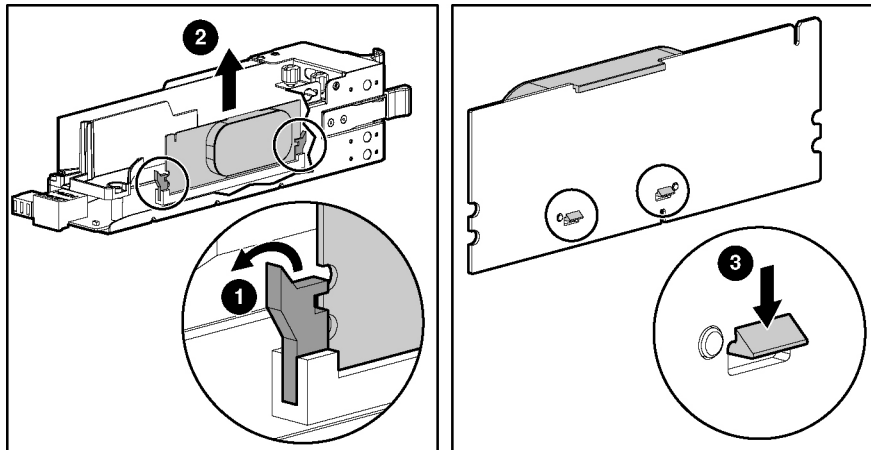

- b. Lift the battery pack off the cache board.
6. Replace whichever battery pack is degraded with the new battery pack.
7. Reinstall the cache and battery packs in the controller module.

**IMPORTANT:** After installing a new battery pack and replacing the controller module in the enclosure, it might take up to 45 minutes for the battery to recharge and the battery-backed write cache to become fully enabled.

## Mounting Bracket Covers

To remove the mounting bracket covers, pull them horizontally straight off the mounting bracket.

To install new covers, push them firmly onto the bracket until they are securely in place.

## Replacement Procedures for Non-Hot-Pluggable Components

All non-hot-pluggable components are inside the enclosure. To reach these components:

1. Disconnect the AC power cords from both power supply units on the enclosure.

2. Rotate the slot in the enclosure lid lever to the unlocked position (1), as indicated by the open padlock embossed in the lever.
3. Pull the lever toward the front of the enclosure (2).
4. Lift the lid off the enclosure (3).

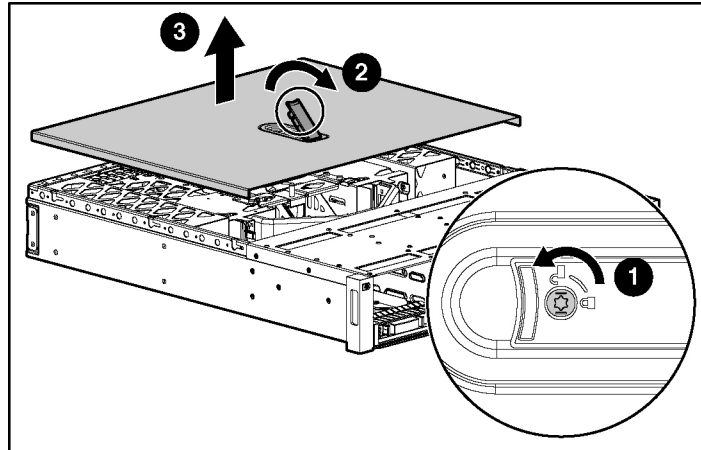

To replace the lid:

1. Position the lid on the chassis so that the peg on the chassis (1) fits into the hole under the lid lever, and the flanged pegs (2) on the inner edge of the lid fit into slots (3) on the side of the enclosure.

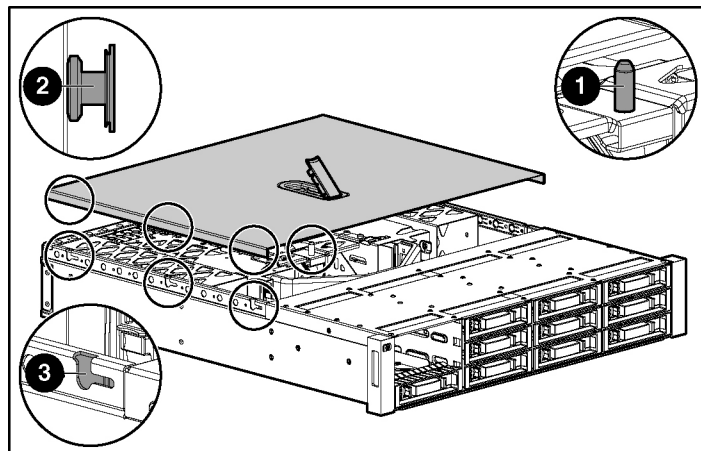

2. Press the lid lever fully down.
3. Rotate the slot in the lid lever to the locked position.

## Midplane Board

1. Remove the fan assemblies.
2. Remove the power supply units.
3. Remove the controller module.

4. Disconnect the ribbon cable from the midplane board.
5. Loosen the captive thumbscrews (1).
6. Pull or push against the captive thumbscrews to slide the midplane board toward the rear of the enclosure (2).

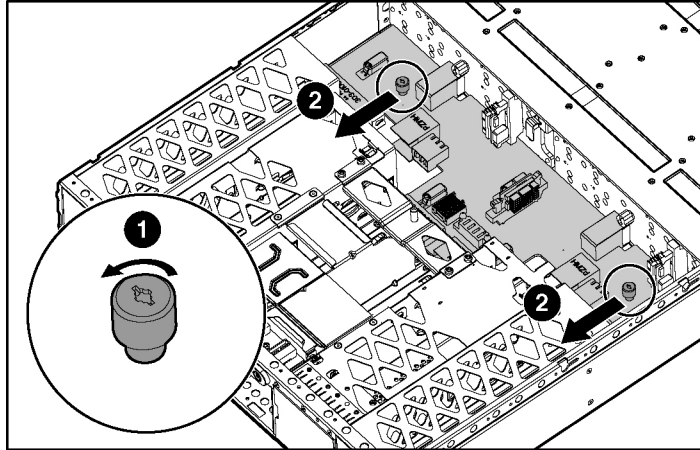

7. Tilt the board lengthwise and manipulate it to get it out of the chassis.

To replace the midplane board:

1. Manipulate the board so that it rests flat on the chassis floor, and the standoffs on the chassis floor are visible through the plastic windows in the board.
2. Push firmly against the edge of the board (1) so that the standoffs are hidden under the copper connectors in the plastic windows. The board is now grounded and the midplane is electrically connected to the backplanes.
3. Tighten the captive thumbscrews (2).

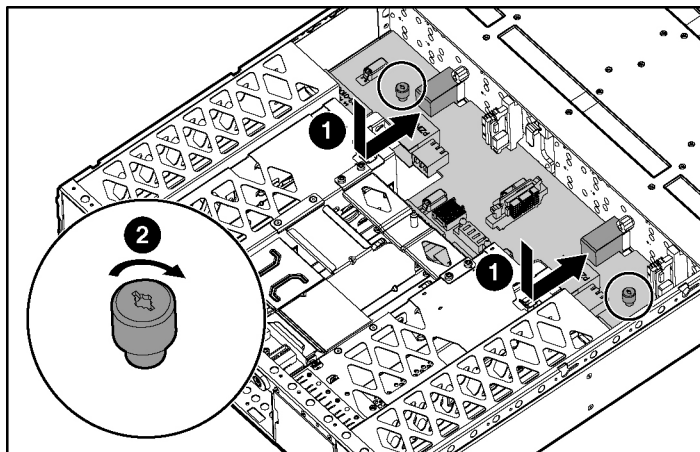

4. Replace the fan assemblies, power supply units, and controller module.

## Backplane Board

1. Remove the midplane board.
2. Remove the knurled thumbscrew on the backplane board (1).
3. Tilt the lower portion of the backplane board upward and lift the board out of the enclosure (2).

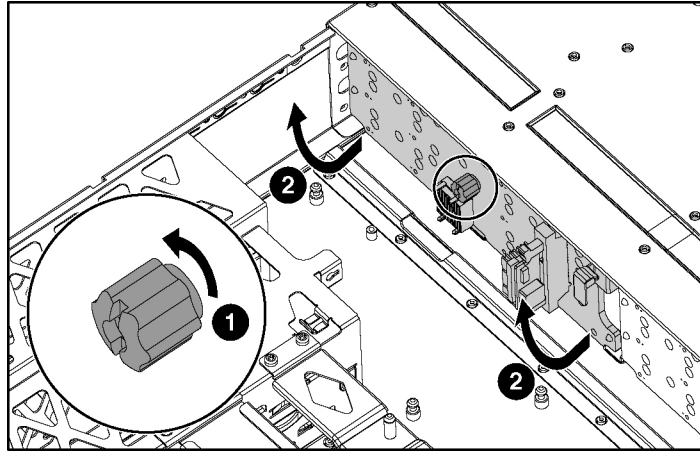

To install a backplane board:

1. Position the board against the chassis so that the three rounded prongs on the chassis engage with the corresponding holes in the board.

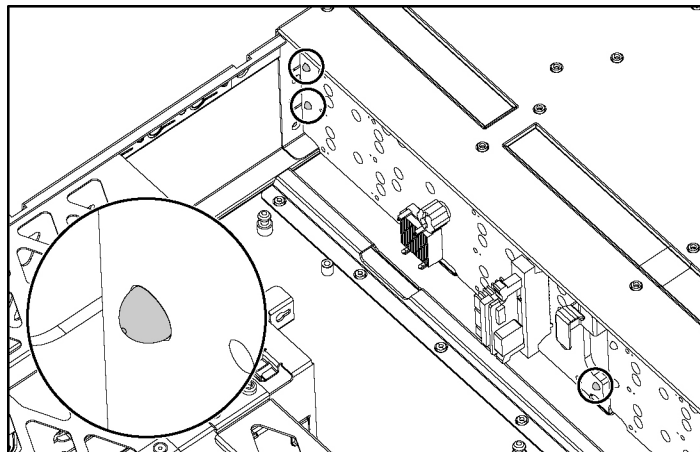

2. Tighten the thumbscrew.

## Ribbon Cable

To remove the ribbon cable, hold the cable connector and pull it directly out of the socket.

When replacing the cable, note that the connector is keyed so that it can fit in the socket in only one orientation.



## UID Circuit Board

1. Disconnect the ribbon cable from the UID circuit board.
2. Remove the two screws (1).
3. Remove the UID LED and button panel (2).

**NOTE:** Take care that the plastic window does not fall out of the panel and get lost.

4. Tilt the edge of the board upward, and pull the board out of the chassis (3).

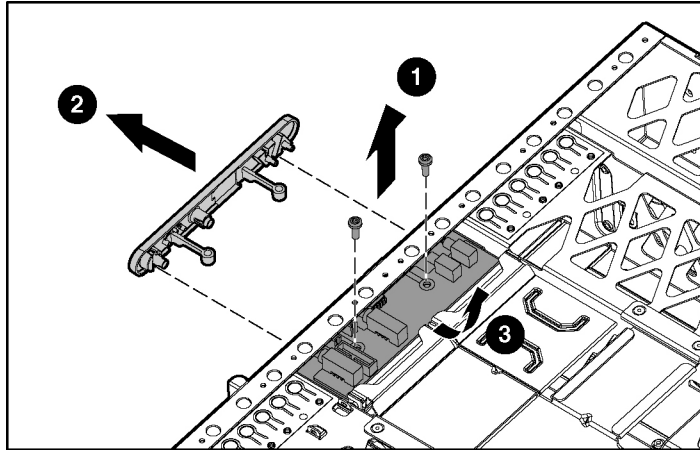

To install a UID circuit board, reverse this procedure.

## VRM Power Supply

1. Pull out the latches on both sides of the socket (1).
2. Pull the VRM power supply straight out of the socket (2).

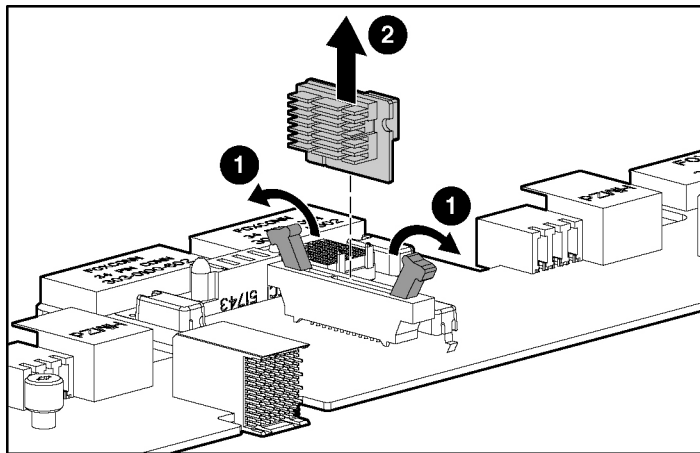

To install a VRM power supply, reverse this procedure. If the latches do not click into place, press them in manually to secure the VRM power supply module in the socket.

## Specifications

### Power Specifications

**Table 4-1: AC Input Requirements**

	Nominal Value	Range
Frequency ( $\pm 5\%$ )	50 or 60 Hz	47 to 63 Hz
Voltage	110 or 240 V	90 to 254 V RMS (autoranging)
Steady state maximum current	At 240 V: 1.8 A (one power supply) or 1.9 A (two power supplies)  At 120 V: 3.7 A (one power supply) or 3.9 A (two power supplies)	—
Standby current	0.21 A at 240 V, 60 Hz  0.15 A at 120 V, 60 Hz	—

### Environmental Specifications

**Table 4-2: Environmental Specifications**

	Operating	Shipping or Storage
Ambient temperature	10° to 35°C (50° to 95°F), with an average change of less than 1°C per hour and a step change of less than 3°C per hour	-40° to 66° C -40° to 150°F
Relative humidity (noncondensing)	40% to 60%, with a step change of less than 10%	10% to 80%
Air quality	Fewer than 500,000 particles 0.5 micron or larger per cubic foot (approximately 17,700 per liter)	—
Heat dissipation	1175 BTU/hr (345 W)	—

## Physical Specifications

**Table 4-3: Enclosure Specifications**

Form	Dimensions		Weight
	International (cm)	US (in)	
Unpacked	59.7 x 48.8 x 8.8	23.5 x 19.2 x 3.5	14 kg (32 lb) empty
			24 kg (53 lb) with components
In shipping carton	83.8 x 81.3 x 27.4	33.0 x 32.0 x 10.8	25 kg (55 lb) empty
			34 kg (75 lb) with components

**Table 4-4: Specifications of Components**

Form	Dimensions		Weight
	International (cm)	US (in)	
Fan assembly	26.8 x 6.0 x 6.0	10.6 x 2.4 x 2.4	0.50 kg (1.10 lb)
Disk drive (in carrier)	18.5 x 11.0 x 2.6	7.3 x 4.3 x 1.0	0.75 kg (1.65 lb)
Controller module	32.6 x 7.9 x 7.1	12.8 x 3.1 x 2.8	1.4 kg (3.0 lb)
Power supply unit	32.0 x 6.4 x 7.7	12.6 x 2.5 x 3.0	1.80 kg (3.96 lb)

## Free Manuals Download Website

<http://myh66.com>

<http://usermanuals.us>

<http://www.somanuals.com>

<http://www.4manuals.cc>

<http://www.manual-lib.com>

<http://www.404manual.com>

<http://www.luxmanual.com>

<http://aubethermostatmanual.com>

Golf course search by state

<http://golfingnear.com>

Email search by domain

<http://emailbydomain.com>

Auto manuals search

<http://auto.somanuals.com>

TV manuals search

<http://tv.somanuals.com>