



# **Quick Reference Guide**

## HP Mobile Remote Control

Document Part Number: 367174-001

November 2004

© Copyright 2004 Hewlett-Packard Development Company, L.P.

Microsoft and Windows are U.S. registered trademarks of Microsoft Corporation.

The information contained herein is subject to change without notice. The only warranties for HP products and services are set forth in the express warranty statements accompanying such products and services. Nothing herein should be construed as constituting an additional warranty. HP shall not be liable for technical or editorial errors or omissions contained herein.

Quick Reference Guide  
HP Mobile Remote Control  
First Edition November 2004  
Document Part Number: 367174-001

---

# Contents

Introduction . . . . .	1
Inserting the Battery . . . . .	1
Storing the HP Mobile Remote Control . . . . .	3
HP Mobile Remote Control Quick Reference . . . . .	5
HP Mobile Remote Control Component Functions . . . . .	11

# Introduction

This guide provides information on using your HP Mobile Remote Control. The HP Mobile Remote Control allows easy and comfortable control of the notebook media software from the palm of your hand.

## Inserting the Battery

To insert the battery into the HP Mobile Remote Control, complete the following steps:

1. On the back of the remote control, turn the battery compartment cover counterclockwise **1** and remove it **2**.

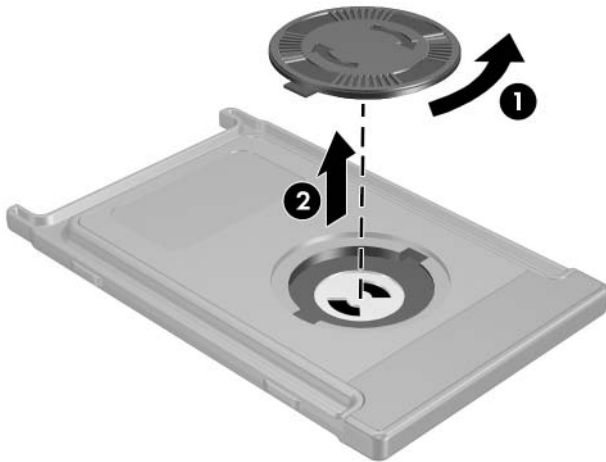

2. With the positive side of the battery facing up, insert the battery into the compartment.

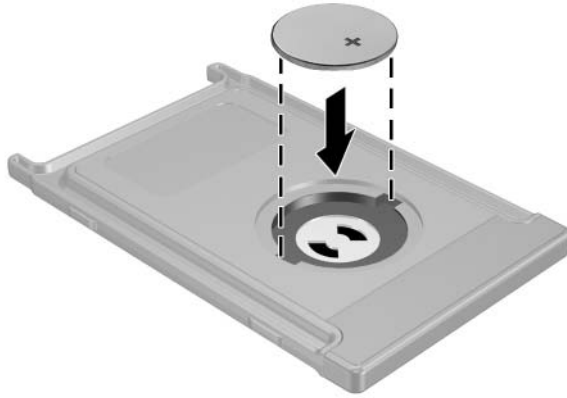

3. Insert the tabs on the battery compartment cover into the slots in the battery compartment and turn the cover clockwise to close.

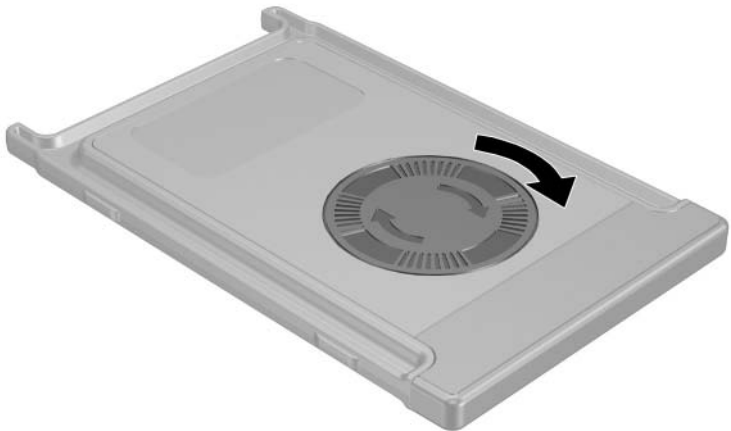

# Storing the HP Mobile Remote Control

The HP Mobile Remote Control can be stored in the PC Card slot of your notebook for convenience and safety. To store the remote control, remove the PC Card slot blank, and then insert the remote control into the PC Card slot until it is firmly in place.

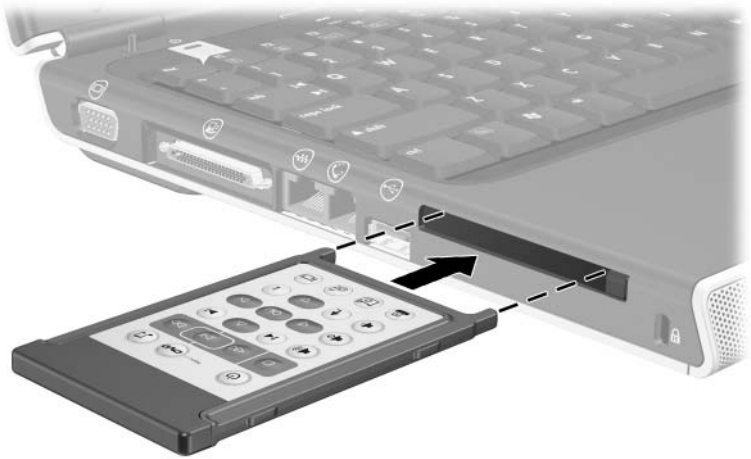

To remove the remote control:

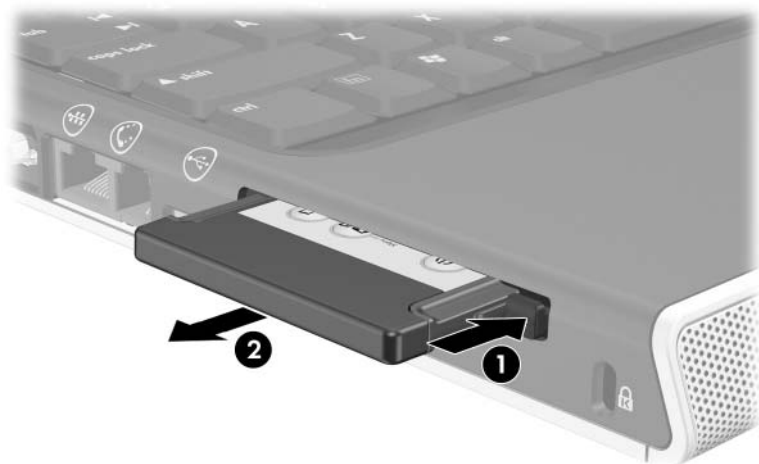

1. Press the PC Card slot eject button **1** to release the remote control from the PC Card slot.
2. Slide the remote control **2** out of the slot.







# HP Mobile Remote Control Quick Reference











<b>Button Function</b>			
<b>Button</b>	<b>When Notebook Is Off</b>	<b>In Microsoft® Windows®</b>	<b>In QuickPlay (select models only)</b>
Power  	Press to start notebook in Windows.	<ul style="list-style-type: none"> <li>■ In Windows, briefly press to initiate Hibernation.</li> <li>■ In Standby, briefly press to resume from Standby into Windows.</li> <li>■ In Hibernation, briefly press to restore from Hibernation into Windows.</li> </ul>	Press to turn QuickPlay off.
DVD Menu  	Press to open QuickPlay DVD mode (select models only).	<ul style="list-style-type: none"> <li>■ In Windows, press to open the default Windows DVD player.</li> <li>■ In Standby, press briefly to resume from Standby.</li> <li>■ In Hibernation, press to open QuickPlay DVD mode (select models only).</li> <li>■ When a DVD is playing, press to view the menu of the DVD.</li> </ul>	<ul style="list-style-type: none"> <li>■ In QuickPlay music mode, press to switch to QuickPlay DVD mode.</li> <li>■ When a DVD is playing, press to view the menu of the DVD.</li> </ul>







*(Continued)*

Button	Button Function		
	When Notebook Is Off	In Microsoft® Windows®	In QuickPlay (select models only)
Music 	Press to open QuickPlay music mode (select models only).	<ul style="list-style-type: none"> <li>■ In Windows, press to open the default Windows music player.</li> <li>■ In Standby, press briefly to resume from Standby.</li> <li>■ In Hibernation, press to open QuickPlay music mode (select models only).</li> </ul>	In QuickPlay DVD mode, press to switch to QuickPlay music mode.
Stop 	None	Press to stop the current media activity, such as playing, rewinding, etc.	Press to stop the current media activity, such as playing, rewinding, etc.
Rewind 	None	Press to rewind selected media.	Press to rewind selected media.
Play/Pause 	None	<ul style="list-style-type: none"> <li>■ Disc not playing, press to play the disc.</li> <li>■ Disc playing, press to pause the disc.</li> </ul>	<ul style="list-style-type: none"> <li>■ Disc not playing, press to play the disc.</li> <li>■ Disc playing, press to pause the disc.</li> </ul>
Fast Forward 	None	Press to fast forward selected media.	Press to fast forward selected media.



(Continued)

Button	Button Function		
	When Notebook Is Off	In Microsoft® Windows®	In QuickPlay (select models only)
Volume Up 	None	<ul style="list-style-type: none"> <li>■ Press to increase notebook volume.</li> <li>■ If muted, press to restore notebook volume.</li> </ul>	<ul style="list-style-type: none"> <li>■ Press to increase notebook volume.</li> <li>■ If muted, press to restore notebook volume.</li> </ul>
Previous 	None	Press to go back to the previous track or chapter.	Press to go back to the previous track or chapter.
Up 	None	Navigation. Press to scroll up.	Navigation. Press to scroll up.
Next 	None	Press to go to the next track or chapter.	Press to go to the next track or chapter.
Mute 	None	<ul style="list-style-type: none"> <li>■ Press to mute notebook volume.</li> <li>■ If muted, press to restore notebook volume.</li> </ul>	<ul style="list-style-type: none"> <li>■ Press to mute notebook volume.</li> <li>■ If muted, press to restore notebook volume.</li> </ul>
Left 	None	Navigation. Press to scroll left.	Navigation. Press to scroll left.
Ok 	None	Navigation. Press to select an item on the screen.	Navigation. Press to select an item on the screen.

*(Continued)*

Button	Button Function		
	When Notebook Is Off	In Microsoft® Windows®	In QuickPlay (select models only)
Right 	None	Navigation. Press to scroll right.	Navigation. Press to scroll right.
Volume Down 	None	<ul style="list-style-type: none"> <li>■ Press to decrease notebook volume.</li> <li>■ If muted, press to restore notebook volume.</li> </ul>	<ul style="list-style-type: none"> <li>■ Press to decrease notebook volume.</li> <li>■ If muted, press to restore notebook volume.</li> </ul>
Back 	None	Press to emulate the "back" function of the <b>alt+left</b> arrow command in the active application.	<ul style="list-style-type: none"> <li>■ In music mode, press to move up one directory level in the My Music display.</li> <li>■ In DVD mode, this button is inactive.</li> </ul>
Down 	None	Navigation. Press to scroll down.	Navigation. Press to scroll down.
Information 	None	Press to view information about a selected item in an application (if available).	<p>Press to display battery and volume status.</p> <p>If playing a DVD, the DVD title, chapter, and time information is also displayed.</p>
Print 	None	Press to open the print options window of the active application.	None

(Continued)

Button	Button Function		
	When Notebook Is Off	In Microsoft® Windows®	In QuickPlay (select models only)
Photo 	None	Press to open default Windows picture application.	None
Video 	None	Press to open default Windows media application.	None
Switch Screens 	None	Press to switch the notebook image between the notebook display and an external display.	Press to switch the notebook image between the notebook display and an external display.

# HP Mobile Remote Control Component Functions

The infrared lens on the remote control links the remote control to the notebook. The link requires a line-of-sight path between the infrared lens on the remote control and the infrared lens on the notebook.

Things to remember:

- The HP Mobile Remote Control operates within Microsoft® Windows®, QuickPlay (select models only), and InterVideo Home Theater software (select models only). Each button responds according to which application is active.



Refer to the InterVideo Home Theater on-screen help for remote control information.

- Some remote control buttons perform the same functions as notebook buttons. For example, the DVD button on the remote control and the DVD button on the notebook have the same functions and can be used interchangeably.
- Some remote control buttons perform the same functions as notebook key combinations. For example, the Information button on the remote control and the **fn+end** key combination on the notebook have the same function and can be used interchangeably.
- Other remote control buttons, such as the Photo button, provide functions which are not duplicated by notebook buttons or preset key combinations.

## Free Manuals Download Website

<http://myh66.com>

<http://usermanuals.us>

<http://www.somanuals.com>

<http://www.4manuals.cc>

<http://www.manual-lib.com>

<http://www.404manual.com>

<http://www.luxmanual.com>

<http://aubethermostatmanual.com>

Golf course search by state

<http://golfingnear.com>

Email search by domain

<http://emailbydomain.com>

Auto manuals search

<http://auto.somanuals.com>

TV manuals search

<http://tv.somanuals.com>