

### Overview

### Introduction

The HP t5630w Thin Client delivers great value with a familiar Windows experience at the right performance level. Microsoft Windows Embedded Standard operating system combined with a full-featured browser, HP Remote Graphics Software (RGS), HP Remote Desktop Protocol (RDP) Enhancements Software, Add/Remove Programs utility, Enhanced Write Filter, Symantec Endpoint Protection, terminal emulation, native dual monitor and widescreen support make the t5630w the optimum choice for business environments requiring a cost-effective thin client with flexibility and power.

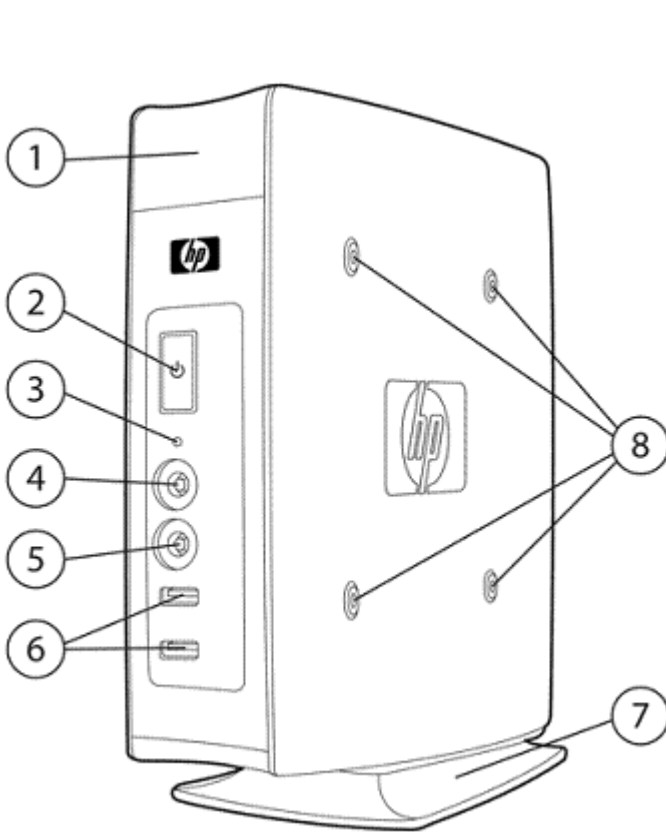

Front

1. Secure USB compartment (2 USB connectors)
2. Power button with LED
3. Flash storage activity indicator
4. Audio connector (mic in)
5. Audio connector (headphone out)
6. USB connectors (2)
7. Vertical stand (removable)
8. VESA mounting points (4)

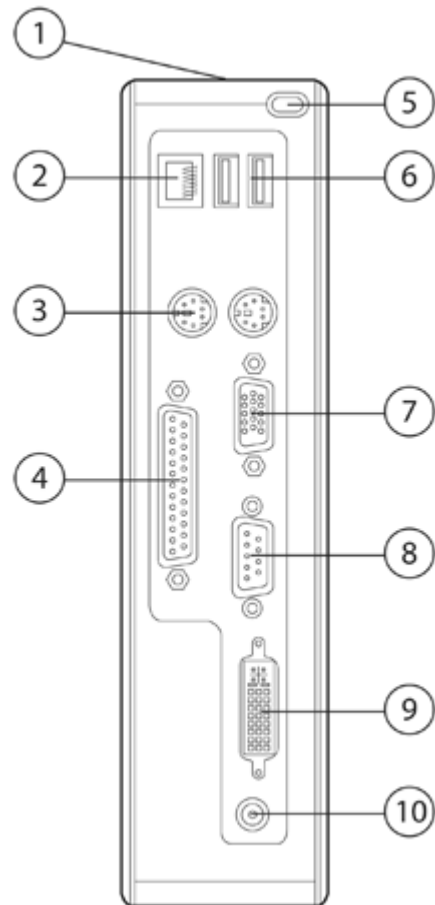

Back

1. Cable lock slot
2. 10/100/1000 Ethernet RJ-45 connector
3. PS/2 connectors (2)
4. Parallel port
5. Cable management feature
6. USB connectors (2)
7. VGA connector
8. Serial port
9. DVI-D connector
10. +12V DC power input

## Overview

### At A Glance

- VIA Eden 1 GHz processor for great performance
- 2 GB Flash memory provides ample storage for applications and drivers
- 1 GB System memory (64 MB reserved for video)
- Built in dual monitor support (VGA and DVI-D native)
- Highly extensible Windows Embedded Standard OS with support for local applications
- Excellent rich multimedia experience and enhanced USB device support in blade PC and VDI environments
- ENERGY STAR® qualified
- Enhanced Write Filter and Symantec Endpoint Protection Agent for enhanced data security
- Enterprise class HP Device Manager, lets you remotely manage devices from a central location.
- Altiris Deployment Solution helps reduce the costs of deploying, updating, and maintaining your thin clients. A free client license is included with each HP thin client.
- Exclusive HP ThinState Tools offers in-box, easy-to-use image deployment and recovery tools.
- Support for HP Client Automation (available separately) for quick and easy deployment of images and thin client management. For more details visit: <http://www.hp.com>.
- HP Universal Print Driver (available as add-on) for HP PCL5 printers
- Includes one parallel, one serial, two PS/2, and six USB 2.0 ports (two in back, two in front, and two in secure USB compartment)
- MIC in and Audio out ports in front
- HP Total Care Warranty and Services: limited three-year hardware warranty in most regions. HP Care Pack Services extend service contracts beyond your standard warranties. For more details visit: <http://www.hp.com/go/lookuptool>.

## Models

VC069AA#ABA	Model Name	HP t5630w Thin Client
VC069AT#ABA (SmartBuy or Promo)	Processor	VIA Eden 1 GHz
	Flash	2 GB
	System Memory	1 GB (64 MB reserved for video)
	Operating System	Microsoft Windows Embedded Standard
	Keyboard	Keyboard (USB or PS/2) varies by region
	Mouse	Mouse (USB or PS/2) varies by region
	Panels	VESA standard mounting holes

## Options

	<b>NOTE:</b> Optional accessories are available as separate purchase.	<b>Part Number</b>
<b>Accessories</b>	HP Quick Release Kit	EM870AA
	HP Quick Release/VESA Panels Kit (for mounting models that ship with non-VESA panels)	FV248AA
	HP Integrated Work Centre Stand	GN783AA
	50 Watt External Power Supply	FJ851AA
<b>Third-party Communications</b>	Belkin USB Wireless 802.11b/g <sup>1,2</sup> (Security: WEP, WPA & WPA2 Only) North America, Singapore, Hong Kong, Malaysia, Philippines, India, Korea, China, Taiwan, Australia, New Zealand) To order, visit: <a href="http://www.belkin.com">www.belkin.com</a> , search for HP4050, and order online	Belkin part number: HP4050
	Belkin USB Wireless 802.11b/g <sup>1,2</sup> (Security: WEP, WPA & WPA2 Only) (Germany, Netherlands, Spain, Italy, France, Poland, Hungary, Czech, Russia, Bulgaria, Romania, United Kingdom, Sweden/Scandinavia) To order, visit: <a href="http://www.belkin.com">www.belkin.com</a> , search for HP4050ea, and order online	Belkin part number: HP4050ea
<b>Touch Screens</b>	ELO Touch 1529L Flat Panel - USB /serial combo <sup>1</sup>	E926109
	HP L5006tm LCD Touchscreen - USB/serial combo	RB146AA
<b>Security</b>	HP USB Smartcard Keyboard	ED707AA
	SCM USB Smart Card Reader SCR331 <sup>1</sup>	904622
	HP/Kensington Cable Lock	PC766A
<b>Input Devices</b>	HP PS/2 Standard Keyboard	DT527A
	HP USB Standard Keyboard	DT528A
	HP USB Smartcard Keyboard	ED707AA
	HP PS/2 2-Button Optical Scroll Mouse	EY703AA
	HP USB 2-Button Optical Scroll Mouse	DC172B
<b>Care Pack Services</b>	9x5 Next-Business-Day3Advanced Exchange - 3 Years	331653-001; U4847E <sup>4</sup>
	9x5 Next-Business-Day3 On-Site Coverage - 3 Years	331655-001; U4849E <sup>4</sup>

<sup>1</sup>This is a third party option. Option, warranty and support available directly from third party vendor.

<sup>2</sup> A standard WLAN (Wi-Fi) infrastructure with wireless access points is required and is not included. Roaming not supported. See Administrator's Guide for supported wireless features.

<sup>3</sup>Service levels and response times for HP Care Pack Services may vary depending on your geographic location. Restrictions and limitations apply. For details, visit: <http://www.hp.com/go/carepack>.

<sup>4</sup>U4847E is available in all regions; U4849E is available in Americas and Asia-Pacific/Japan.

## Technical Specifications

<b>Processor</b>	VIA Eden 1 GHz		
<b>Chipsets</b>	VIA VX800 north/south bridge unified chip		
<b>Memory</b>	<b>Flash</b>	2 GB	
	<b>System Memory</b>	1 GB (64 MB reserved for video)	
<b>Graphics</b>	VIA Chrome9 HC3 DX9 Graphics		
	<b>Mode</b>	<b>Refresh Rates (Single Monitor)</b>	<b>Colour Depth</b>
	640 x 480	60, 72, 75, 85 Hz	8, 16, 32 bit
	800 x 600	60, 70, 72, 75, 85 Hz	8, 16, 32 bit
	848 x 480	60, 75, 85 Hz	8, 16, 32 bit
	1024 x 480	60 Hz	8, 16, 32 bit
	1024 x 768	60, 70, 72, 75, 85 Hz	8, 16, 32 bit
	1280 x 720	60, 75, 85 Hz	8, 16, 32 bit
	1280 x 768	60 Hz	8, 16, 32 bit
	1280 x 1024	60, 70, 75, 85 Hz	8, 16, 32 bit
	1360 x 768	60 Hz	8, 16, 32 bit
	1368 x 768	60, 75, 85 Hz	8, 16, 32 bit
	1400 x 1050	60 Hz	8, 16, 32 bit
	1440 x 900	60, 75, 85 Hz	8, 16, 32 bit
	1600 x 1200	60, 75, 85 Hz	8, 16, 32 bit
1680 x 1050	60, 75 Hz	8, 16, 32 bit	
1920 x 1080	60, 75 Hz	8, 16, 32 bit	
1920 x 1200	60, 75, 85 Hz	8, 16, 32 bit	

**NOTE:** The table represents a sample of possible modes that this controller is capable of displaying but various factors such as the capability and EDID info returned by the attached monitor, the interface used (D-SUB/DVI-D), and dual monitor mode may limit the availability of modes, colour depth, and or refresh rate.

<b>Input/Output/ Peripheral Support</b>	<b>Keyboard</b>	Keyboard (USB or PS/2) varies by region.
	<b>Mouse</b>	Mouse (USB or PS/2) varies by region.
	<b>Printer</b>	Local and/or network printers (RDP, ICA, LPD)
	<b>Video</b>	VGA-type video output (DB-15) DVI-D digital video output
<b>Audio</b>	<b>Output</b>	Internal amplified speaker 1/8-inch mini-jack, 24-bit stereo, 192-kHz sample rate
	<b>Input</b>	1/8-inch microphone mini-jack, 20-bit stereo, 96-kHz sample rate
<b>Hardware Security</b>	Security lock slot (cable lock sold separately) Secure USB compartment with 2 USB 2.0 ports	
<b>Networking</b>	10/100/1000 Ethernet (RJ-45) TCP/IP with DNS and DHCP	
	Point-to-Point Protocol (PPP), Point-to-Point over Ethernet (PPPoE), Point-to-Point Tunneling Protocol (PPTP), Layer-2 Tunneling Protocol (L2TP), Wake on LAN (WOL), PXE	

## Technical Specifications

	Server Network Time Protocol (SNTP)
	Simple Network Management Protocol (SNMP)
<b>I/O ports and connectors</b>	6 USB 2.0 ports , 1 Serial, 1 Parallel, 2 PS/2, RJ45
<b>Languages (MUI)</b>	English, French, German, Spanish, Dutch, Norwegian, Korean, Simplified Chinese, Traditional Chinese, and Japanese
<b>Server OS Compatibility/Support</b>	Citrix XenApp 4.5 Citrix XenDesktop 2.x and 3 Citrix Presentation Server 4.0 Windows Server 2008 Terminal Services Windows 2000/2003 Server families; Windows 2000/2003 Server Terminal Services
<b>Software Included</b>	<b>Operating System/Protocols/Components</b> Windows Embedded Standard Citrix ICA 11.0 (XenApp Plugin for Hosted Apps 11.0) Microsoft RDP 6.1 Microsoft Internet Explorer 7 Windows Media Player 11 HP TeemTalk Terminal Emulator 7.1 Citrix ICA 11.1 (Desktop Receiver 11.1) available as an add-on
	<b>Security</b> Enhanced Write Filter Symantec Endpoint Protection
	<b>Session Allocation Managers/Session Brokers</b> Preinstalled: HP Session Allocation Manager (SAM) 2.3 Citrix Desktop Delivery Controller enabled through web browser VMware View Manager 3.0 (previously known as VDM broker) 3rd Party Add-on: Leostream Desktop Connection Broker (contact vendor directly for broker sale and support) Provision Networks (Quest) broker (contact vendor directly for broker sale and support)
	<b>Multimedia and USB solutions</b> HP Remote Graphics Software Receiver 5.2 for VMware View and Microsoft Terminal Services HP RDP Multimedia and USB Redirection software enhancements for VMWare View Citrix HD-X support for XenApp Citrix HD-X support for XenDesktop
	<b>Management</b> HP Device Manager agent 4.0 Altiris Deployment Solution (full client license). Management console available as free download from Altiris at: <a href="http://www.altiris.com/hptc">www.altiris.com/hptc</a> HP ThinState for rapid deployment HP Client Automation agent
	Other add-on software available (see: <a href="http://www.hp.com/support">www.hp.com/support</a> for latest list of available add-ons)
<b>Emulations</b>	HP TeemTalk Terminal Emulator supports these emulations. SSH is supported in terminal emulation mode allowing users to secure their connections to the host.
	<b>Emulation Terminal ID</b>
	ADDS Viewpoint A2 ADDS-A2
	AIXTerm aixterm
	ANSI BBS ansi
	AT&T AT 386 at386-m



## Technical Specifications

AT&T Dataspeed 4410	att4410
Bull BQ3107	VIP7700, VIP7760
Data General Dasher 410/412	dg410
Hewlett Packard HP700- 92/96	2392A, 2622A, 70092, 70094, 70096
Hazeltine 1500	HZ1500
IBM 3151	11, 11-28, 31, 31-28
IBM 3270	3278-2 (24x80 Mono), 3278-3 (32x80 Mono), 3278-4 (43x80 Mono), 3278-5 (27x132 Mono), 3278-2-E (24x80 Colour), 3278-3-E (32x80 Colour), 3278-4-E (43x80 Colour), 3278-5-E (27x132 Colour), 3279-2 (24x80 Colour), 3279-3 (32x80 Colour), 3279-4 (43x80 Colour), 3279-5 (27x132 Colour), 3287-1 (Printer)
IBM 5250	3179-2 (24x80 Colour), 3180-2 (27x132 Mono Msg), 3196-A1 (24x80 Mono), 3477-FC (27x132 Colour Msg), 3477-FG (27x132 Mono Msg), 3486-BA (24x80 Mono), 3487-HA (27x132 Mono), 3487-HC (27x132 Colour), 3812-1 (Printer), 5251-11 (24x80 Mono), 5291-1 (24x80 Mono), 5292-2 (24x80 Colour), 5553-B01 (DBCS Printer), 5555-B01 (DBCS 24x80 Mono), 5555-C01 (DBCS 24x80 Colour)
McDonnell Douglas Prism- ty 8, Prism-12	
McDonnell Douglas Prism- ty 9	
Prime PT250	pt250
SCO Console	ansi
Siemens 97801	97801
Stratus V102	v102
Tandem TA6526, TA6530	tn6530-8
Televideo 910	TVI910
Televideo 920	TVI920

## Technical Specifications

	Televideo 925	TVI925
	Televideo 950	TVI950
	Televideo 955	TVI955
	Unisys T27	UNISYS-TD830
	Viewdata 40	VIEWDATA - 40
	Viewdata 80	VIEWDATA - 80
	Viewdata Split	VIEWDATA - SPLIT
	DEC VT PCTerm	VT-PCTERM
	DEC VT100	m2200, vt100, vt101, vt102, vt125, vt131, vt132, vt220, vt240, vt320, vt340, vt420, vt510, vt520, vt525
	DEC VT100+	VT100+
	DEC VT500 7-bit	m2200, vt100, vt101, vt102, vt125, vt131, vt132, vt220, vt240, vt320, vt340, vt420, vt510, vt520, vt525
	DEC VT500 8-bit	m2200, vt100, vt101, vt102, vt125, vt131, vt132, vt220, vt240, vt320, vt340, vt420, vt510, vt520, vt525
	DEC VT 52	m2200, vt100, vt101, vt102, vt125, vt131, vt132, vt220, vt240, vt320, vt340, vt420, vt510, vt520, vt525
	VT HP220	vt220
	VT UTF8	VT-UTF8
	Wyse WY370	WYSE-370
	Wyse WY50	WYSE-50
	Wyse WY50+	WYSE-50
	Wyse WY60	WYSE-60
	Wyse PCTerm	WYSE-PCTERM
<b>Dimensions H x W x D</b>	<b>Without stand</b>	8.25 x 2.05 x 8.5 in (209.55 x 52.07 x 215.90 mm)
	<b>With stand</b>	8.65 x 2.05 x 8.5 in (219.70 x 52.07 x 215.90 mm)
<b>Weight (approximate)</b>	<b>With stand</b>	3.40 lbs (1.54 kg)
<b>Power*</b>	<b>Operating voltage range</b>	100-240 VAC
	<b>Rated line frequency</b>	50-60 Hz
	<b>Power output (max)</b>	50W
	<b>Rated output current (max)</b>	4.16A
	<b>Output voltage</b>	+12V DC
	<b>Power consumption</b>	Average power consumption of this thin client in a typical setup is 14.0 W.
		<i>* The actual power consumption at your location could vary and is dependent on many factors including but not limited to software load on the thin client, attached peripherals, and environmental factors.</i>
<b>Environmental</b>	<b>Operating temperature range</b>	50° to 104° F (10° to 40° C)
	<b>Non-operating temperature range</b>	-22° to 140° F (-30 to 60° C)
	<b>Humidity (non-condensing)</b>	10% to 90% operating/5% to 95% non-operating
<b>Regulatory Compliances</b>	<b>Product Safety</b>	International: IEC60950-1, 12:2005, with CB Certificate and all National





## Technical Specifications

### Deviations

US and Canada: UL 60950-1 / CAN/CSA 22.2 No. 60950-1-03, 07:2006, Bi-National Standard for ITE Safety in the US and Canada and is published jointly by UL and CSA.

Europe: EN 60950-1, 06:2003, Information Technology Equipment

### Ergonomics

The product has been tested and found to comply with all applicable GS ergonomic requirements.

### RF Interference

FCC Class B, CE Mark, VCCI

### Warranty

Three-year limited hardware warranty.

**NOTE:** Certain restrictions apply. [Consult the HP Customer Support Centre for details.](#)

## Technical Specifications – Environmental Data

**Eco-Label Certifications & Declarations** This product has received or is in the process of being certified to the following approvals and may be labeled with one or more of these marks:

- ENERGY STAR® Category B

**Additional Compliance** This product is in compliance with:

- Restrictions of Hazardous Substances (RoHS) directive - 2002/95/EC.
- Waste Electrical and Electronic Equipment (WEEE) Directive - 2002/96/EC.
- California Proposition 65 (State of California; Safe Drinking Water and Toxic Enforcement Act of 1986).
- Plastics parts weighing over 25 grams used in the product are marked per ISO 11469 and ISO1043.

Energy Consumption	115 VAC	230 VAC	100 VAC
Idle State:	13.90 W	14.32 W	13.70 W
Off Mode:	1.95 W	1.93 W	1.94 W

**NOTE:** This product is in compliance with US executive order 13221, WOL (wake on LAN) disabled.

**NOTE:** The actual power consumption at your location could vary and is dependent on many factors including, but not limited to, software load on the thin client, attached peripherals, and environmental factors.

Heat Dissipation	Idle State:	47.43 BTU/hr	48.86 BTU/hr	46.75 BTU/hr
	Off Mode:	6.66 BTU/hr	6.57 BTU/hr	6.62 BTU/hr

**NOTE:** Heat dissipation is calculated based on the measured watts, assuming the service level is attained for one hour.

**Batteries** This product complies with ISO standards:

- EU Directive 91/ 157/ EEC
- EU Directive 93/ 86/ EEC
- EU Directive 98/ 101/ EEC

Batteries used in the product do not contain:

- Mercury greater the 5ppm by weight
- Cadmium greater than 10ppm by weight
- Lead greater than 4000ppm by weight.

Battery size: CR2032 (coin cell)

Battery type: Lithium

**Recycled material**

**Product**

- This product contains 0% recycled materials (by weight).
- This product is 98.1% (by weight) recyclable when disposed of properly at end of life.

**Packaging**

- The EPE foam packaging material contains at least 5% (by weight) post-consumer recycled content.
- The corrugated paper packaging materials contains at least 80% (by weight) post-consumer recycled content.
- The packaging for this product is 94% (by weight) recyclable when disposed of properly.

## Technical Specifications – Environmental Data

### RoHS Compliance

Hewlett-Packard is committed to compliance with all applicable environmental laws and regulations, including the European Union Restriction of Hazardous Substances (RoHS) Directive. HP's goal is to exceed compliance obligations by meeting the requirements of the RoHS Directive on a worldwide basis. From July 1, 2006, RoHS substances will be virtually eliminated (virtually = to levels below legal limits) for all HP electronic products subject to the RoHS Directive, except where it is widely recognized that there is no technically feasible alternative (as indicated by an exemption under the EU RoHS Directive).

### Material Usage

This product does not contain any of the following substances in excess of regulatory limits (refer to the HP General Specification for the Environment at:

[http://www.hp.com/hpinfo/globalcitizenship/environment/supplychain/gen\\_specifications.html](http://www.hp.com/hpinfo/globalcitizenship/environment/supplychain/gen_specifications.html)):

- Asbestos
- Certain Azo Colorants
- Certain Brominated Flame Retardants - may not be used as flame retardants in plastics
- Cadmium
- Chlorinated Hydrocarbons
- Chlorinated Paraffins
- Formaldehyde
- Halogenated Diphenyl Methanes
- Lead carbonates and sulfates
- Lead and Lead compounds
- Mercuric Oxide Batteries
- Nickel - finishes must not be used on the external surface designed to be frequently handled or carried by the user.
- Ozone Depleting Substances
- Polybrominated Biphenyls (PBBs)
- Polybrominated Biphenyl Ethers (PBBEs)
- Polybrominated Biphenyl Oxides (PBBOs)
- Polychlorinated Biphenyl (PCB)
- Polychlorinated Terphenyls (PCT)
- Polyvinyl Chloride (PVC) - except for wires and cables, and certain retail packaging has been voluntarily removed from most applications.
- Radioactive Substances
- Tributyl Tin (TBT), Triphenyl Tin (TPT), Tributyl Tin Oxide (TBTO)

### Packaging

HP follows these guidelines to decrease the environmental impact of product packaging:

- Eliminate the use of heavy metals such as lead, chromium, mercury and cadmium in packaging materials.
- Eliminate the use of ozone-depleting substances (ODS) in packaging materials.
- Design packaging materials for ease of disassembly.
- Maximize the use of post-consumer recycled content materials in packaging materials.
- Use readily recyclable packaging materials such as paper and corrugated materials.
- Reduce size and weight of packages to improve transportation fuel efficiency.
- Plastic packaging materials are marked according to ISO 11469 and DIN 6120 standards.

### End-of-life Management and Recycling

Hewlett-Packard offers end-of-life HP product return and recycling programs in many geographic areas. To recycle your product, please go to: <http://www.hp.com/recycle> or contact your nearest HP sales office. Products returned to HP will be recycled, recovered or disposed of in a responsible manner.

The EU WEEE directive (2002/95/EC) requires manufacturers to provide treatment information for each product type for use by treatment facilities. This information (product disassembly instructions) is posted on the Hewlett Packard web site at: <http://www.hp.com/go/recyclers>. These instructions may be used by recyclers and other WEEE treatment facilities as well as HP OEM customers who integrate and re-sell HP

## Technical Specifications – Environmental Data

equipment.

### Hewlett-Packard

For more information about HP's commitment to the environment:

### Corporate Environmental Information

[link to new HP white paper now in progress]

Global Citizenship Report

<http://www.hp.com/hpinfo/globalcitizenship/gcreport/index.html>

Eco-label certifications

<http://www.hp.com/hpinfo/globalcitizenship/environment/productdesign/ecolabels.html>

ISO 14001 certificates:

<http://www.hp.com/hpinfo/globalcitizenship/environment/operations/envmanagement.html>

---

©Copyright 2009 Hewlett-Packard Development Company, L.P. The information contained herein is subject to change without notice and is provided "as is" without warranty of any kind. The warranties for HP products and services are set forth in the express limited warranty statements accompanying such products and services. Nothing herein should be construed as constituting an additional warranty. HP shall not be liable for technical or editorial errors or omissions contained herein. Microsoft and Windows are trademarks of the Microsoft group of companies. . ENERGY STAR is a U.S. registered mark of the United States Environmental Protection Agency.

## Free Manuals Download Website

<http://myh66.com>

<http://usermanuals.us>

<http://www.somanuals.com>

<http://www.4manuals.cc>

<http://www.manual-lib.com>

<http://www.404manual.com>

<http://www.luxmanual.com>

<http://aubethermostatmanual.com>

Golf course search by state

<http://golfingnear.com>

Email search by domain

<http://emailbydomain.com>

Auto manuals search

<http://auto.somanuals.com>

TV manuals search

<http://tv.somanuals.com>